

Reimu Hakurei

page 1 – Head and Body

page 2 – Hair

page 3 – Sarashi, Shirt, and Collar

page 4 – Sleeves and Skirt

page 5 – Legs and Shoes

page 6 – Arms, Gohei, Ofuda, and Stand

page 7 – Complete Assembly

Refer to pepakura file while assembling

Print the stand page on thicker paper

Head



Body

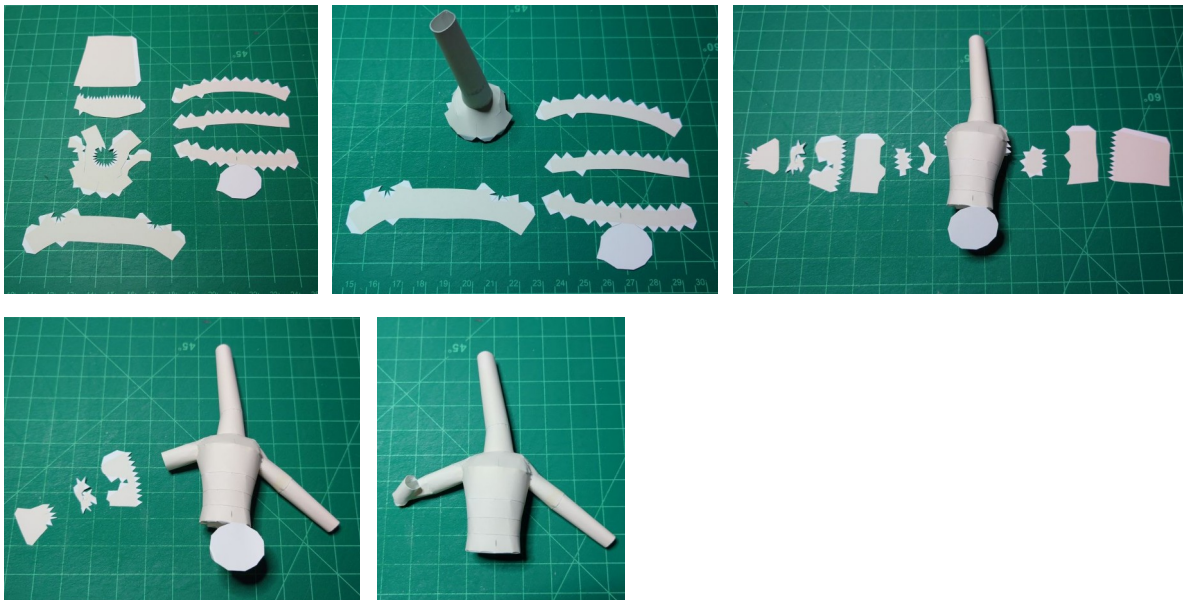

The image is a 5x5 grid of 25 photographs documenting the creation of a paper craft. The background for all photos is a green cutting mat with a white grid.

- Row 1:** Shows the initial cutting of purple paper into various shapes, including long strips and pointed pieces. A 45-degree angle is marked in the third photo.
- Row 2:** Continues the preparation of purple paper strips. The fourth photo shows two long purple strips with small red and white rectangular pieces attached near their ends.
- Row 3:** The purple strips are being joined together. The fourth photo shows a single curved purple shape with two red and white pieces. The fifth photo shows a more complex assembly of purple paper.
- Row 4:** Focuses on the red paper components. The first three photos show the cutting and gluing of red paper into bow-like shapes. The fourth photo shows a red bow attached to a long purple strip.
- Row 5:** The final assembly steps. The first photo shows a purple head shape with two long purple hair-like extensions. The second photo shows the completed craft, featuring a large red bow on top of a purple head with long purple hair.

Sarashi

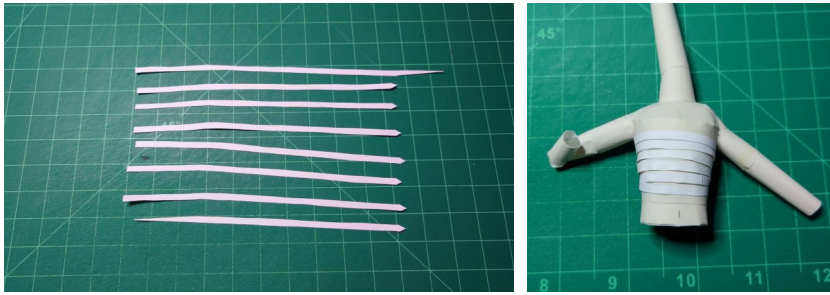

Wrap each strand around the chest until the front and sides are covered.

Shirt

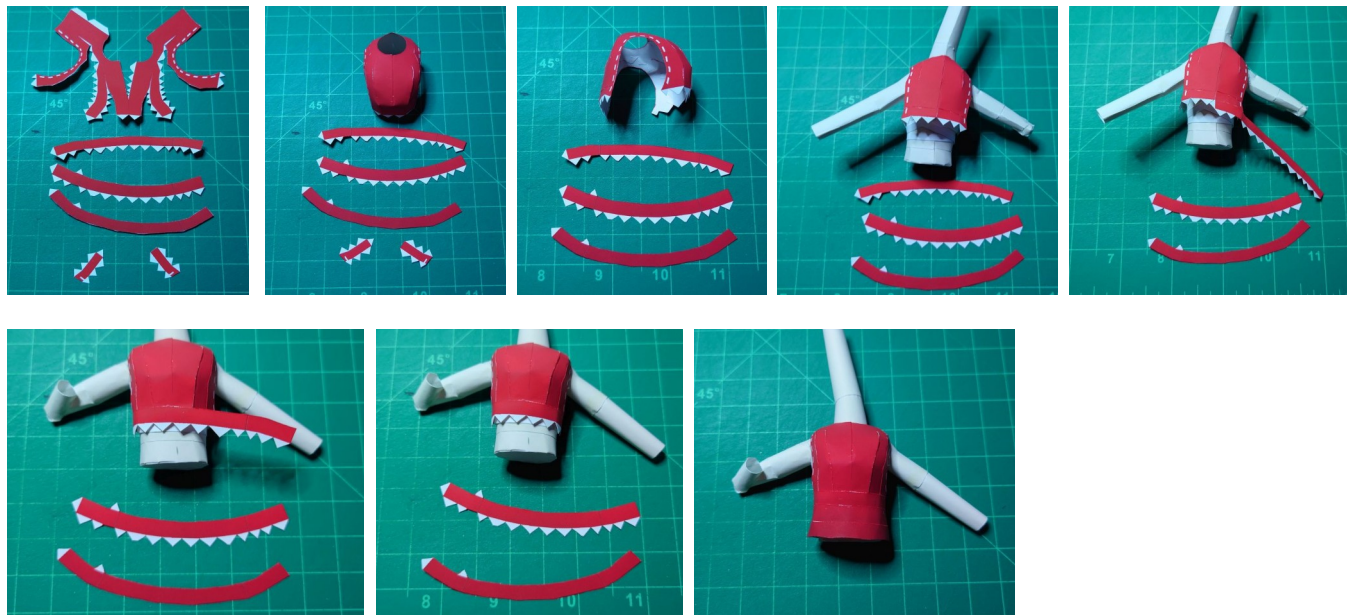

Collar

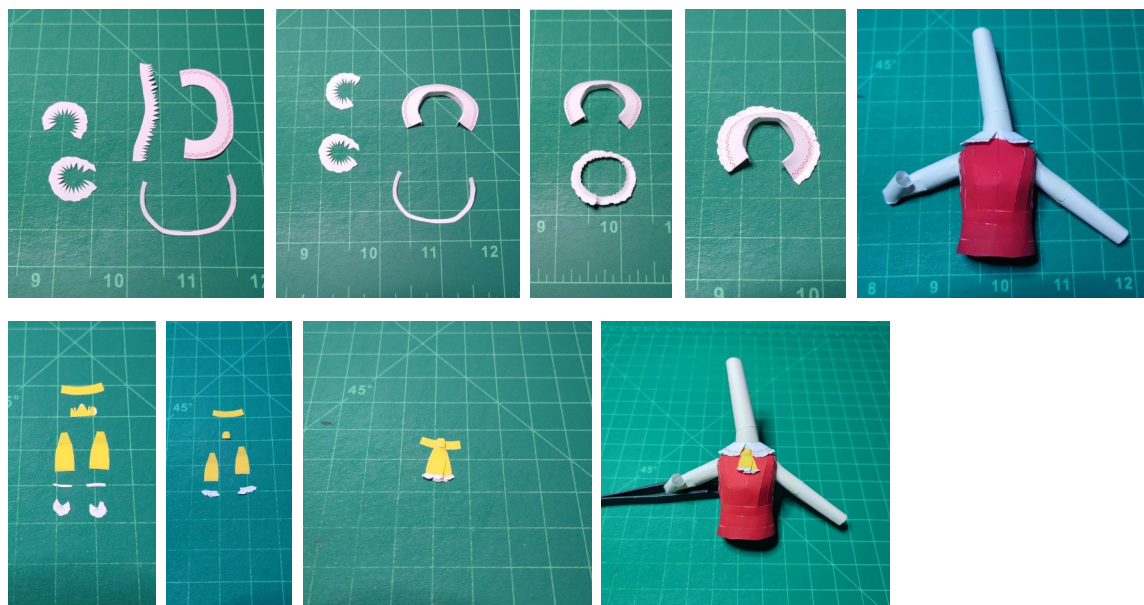

Sleeves

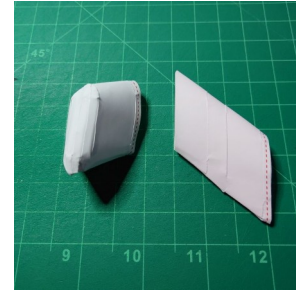
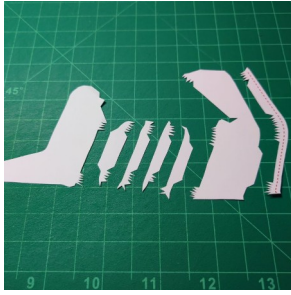

Skirt

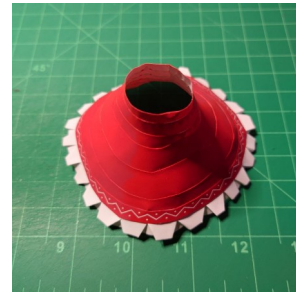
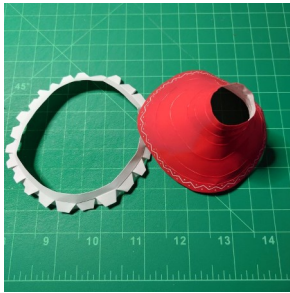

Legs



Shoes

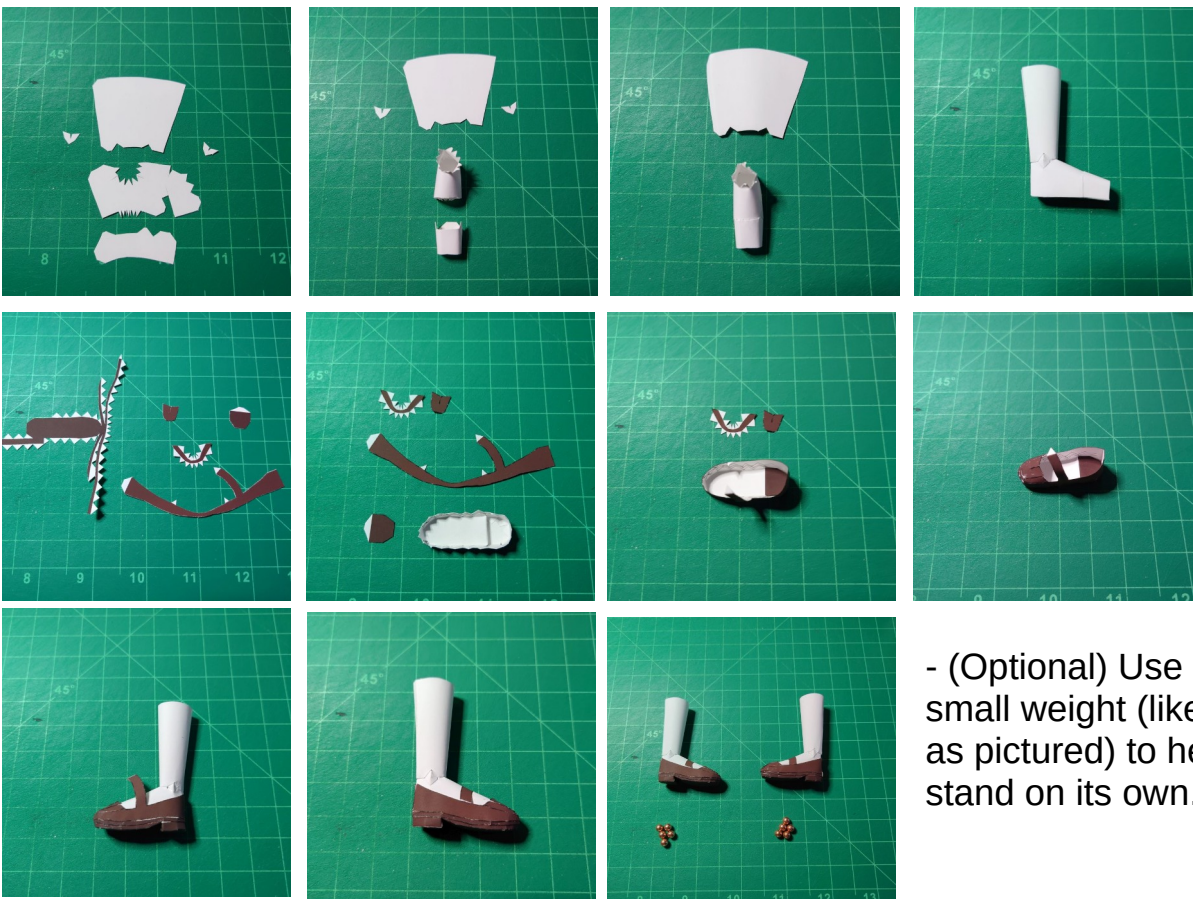

- (Optional) Use some sort of small weight (like copper pellets as pictured) to help let the model stand on its own.

Arms

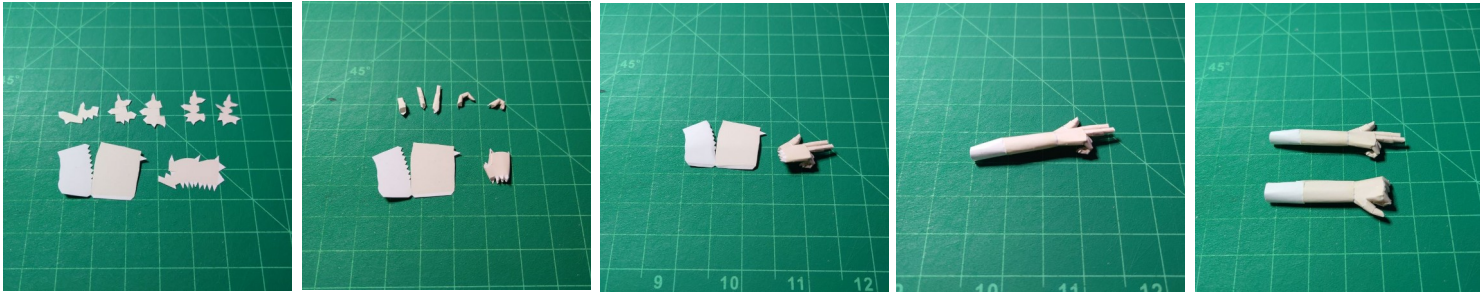

Gohei and Ofuda



- There are two versions of paper streamers for the gohei, the folded one (pictured) and a flat version, choose the one you prefer.

- I used 26 gauge floral wire to strengthen the rod, but you can also use the rod on the stand page.

Stand



Complete Assembly

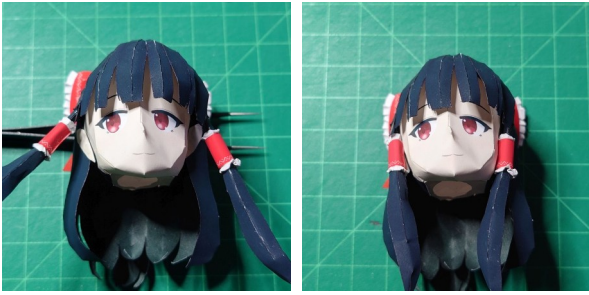

Align the head with the hair and glue the back of the ears to the hair and then glue the tubs to the side.



Insert the upper body into the skirt like in the second picture, then once you have attached the upper and lower body together, pull the skirt down.

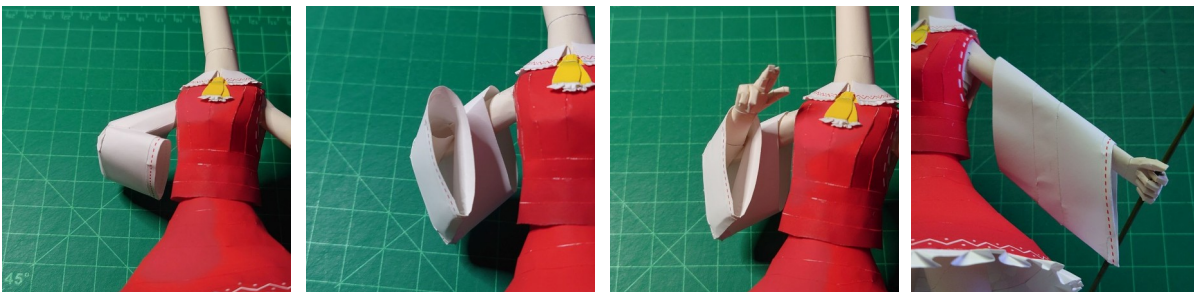

Insert the right sleeve at an angle, then rotate it forward.

