

Canon

CANON SLR 50th ANNIVERSARY

Paper Craft Camera

EOS 5D Mark II 2008

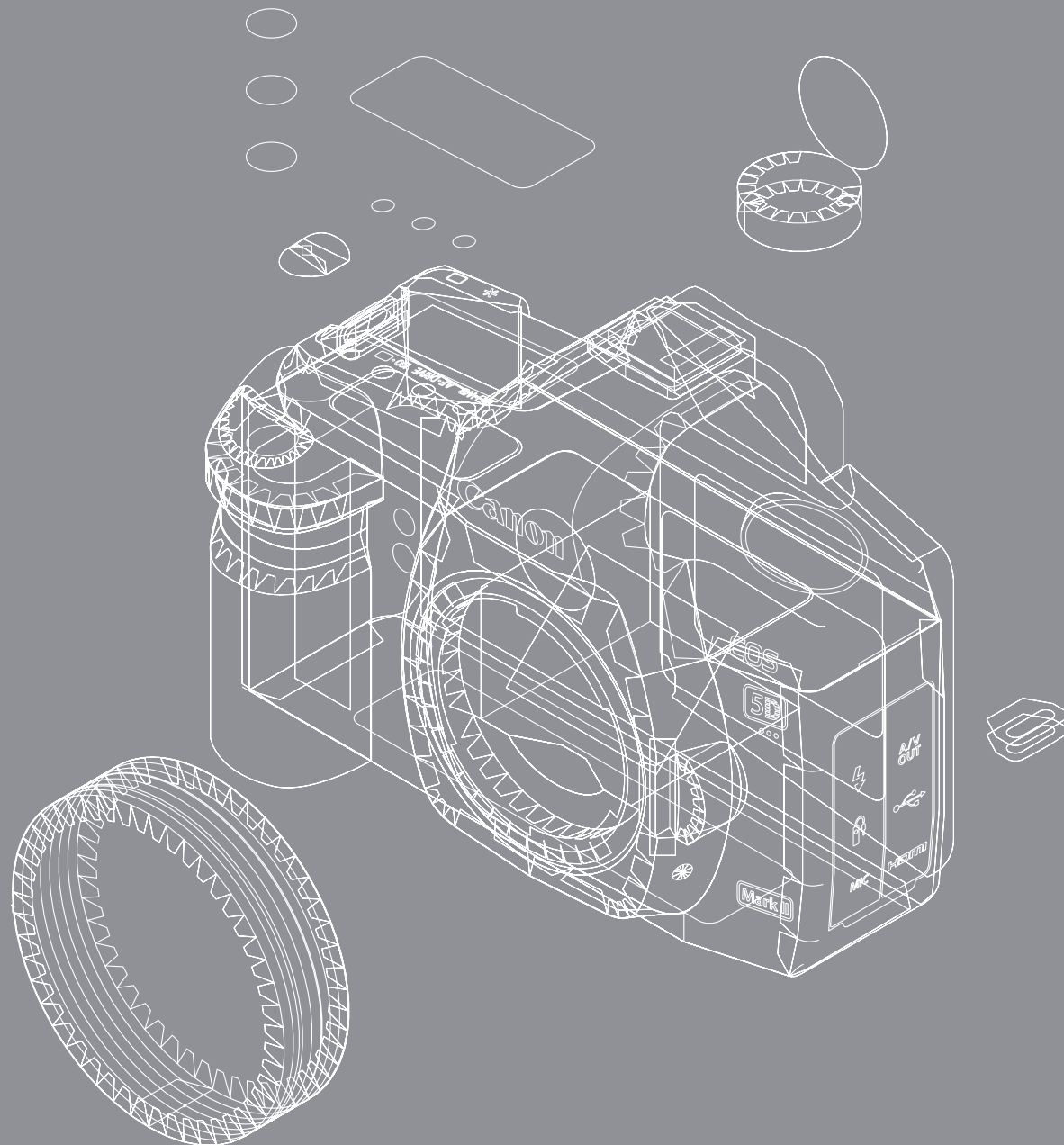

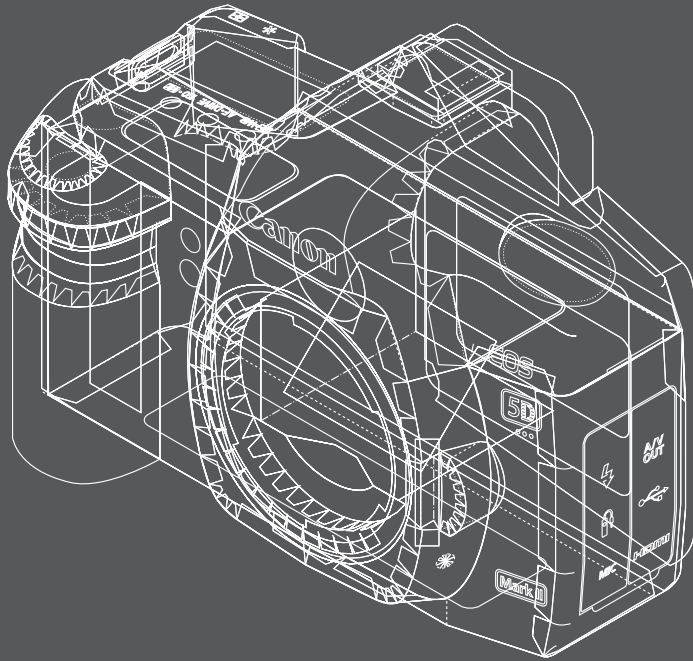

EOS 5D Mark II

What you need

○Scissors ○a craft knife ○a rule ○a pointed instrument (ball-point pen that no longer works, pencil, awl, etc.) ○toothpicks ○wood glue or other adhesive ○a round stick (knitting needle or pencil) ○ink markers ○tweezers ○a cutting mat

How to make this paper craft

1. Trace the mountain fold lines (- - - - -) and valley fold lines (— — — —) with a pointed instrument to make them easier to fold later. **(Fig. A)**
2. Cut out the parts carefully along the cutting lines (solid lines) with a pair of scissors or a knife. If you move the paper rather than the scissors, you can cut them cleanly. **(Fig. B)**
3. For parts you need to curl (roundness), put the parts you have cut out on your palm or thigh, and stroke them with a round stick to curl them **(Fig. C)**. For small parts, use a toothpick.
4. Bend firmly along the folding lines once to make it easier to fold them later. **(Fig. D)**
5. If the edges (where the paper was cut off) stand out white, color them with an ink marker of the same color.
6. Before you start to glue, carefully check the assembly illustrations and photos and perform a temporary assembly to see what shape it will form. Also check for places you forgot to cut or fold. If everything is all right, apply glue thinly on the tabs (surfaces with red ★ and green ★ should have glue applied on the rear side) with a toothpick **(Fig. E)**, hold the two surface together with your fingers until the glue dries. For smaller parts, a pair of tweezers will come in handy **(Fig. F)**. The trick is to wait until the glue has completely dried and hardened before going on to the next step.
7. Look at the assembling illustration and photos of the finished image, and work slowly, steadily and carefully.

* When using a knife, be careful not to cut your fingers.

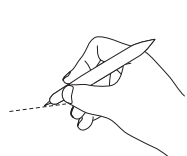

(Fig. A)

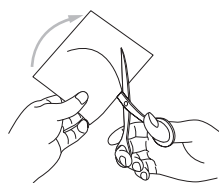

(Fig. B)

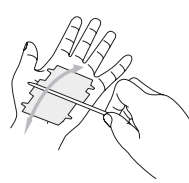

(Fig. C)

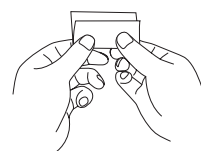

(Fig. D)

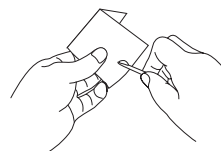

(Fig. E)

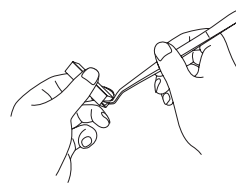

(Fig. F)



[Photo of the finished model: Front view]



[Photo of the finished model: Rear view]

EOS 5D Mark II [How to make the model 2 / 18]

① How to build the body -1-

A

Carefully curl the parts as shown in the illustration and the finished image, and form the shape as you glue.

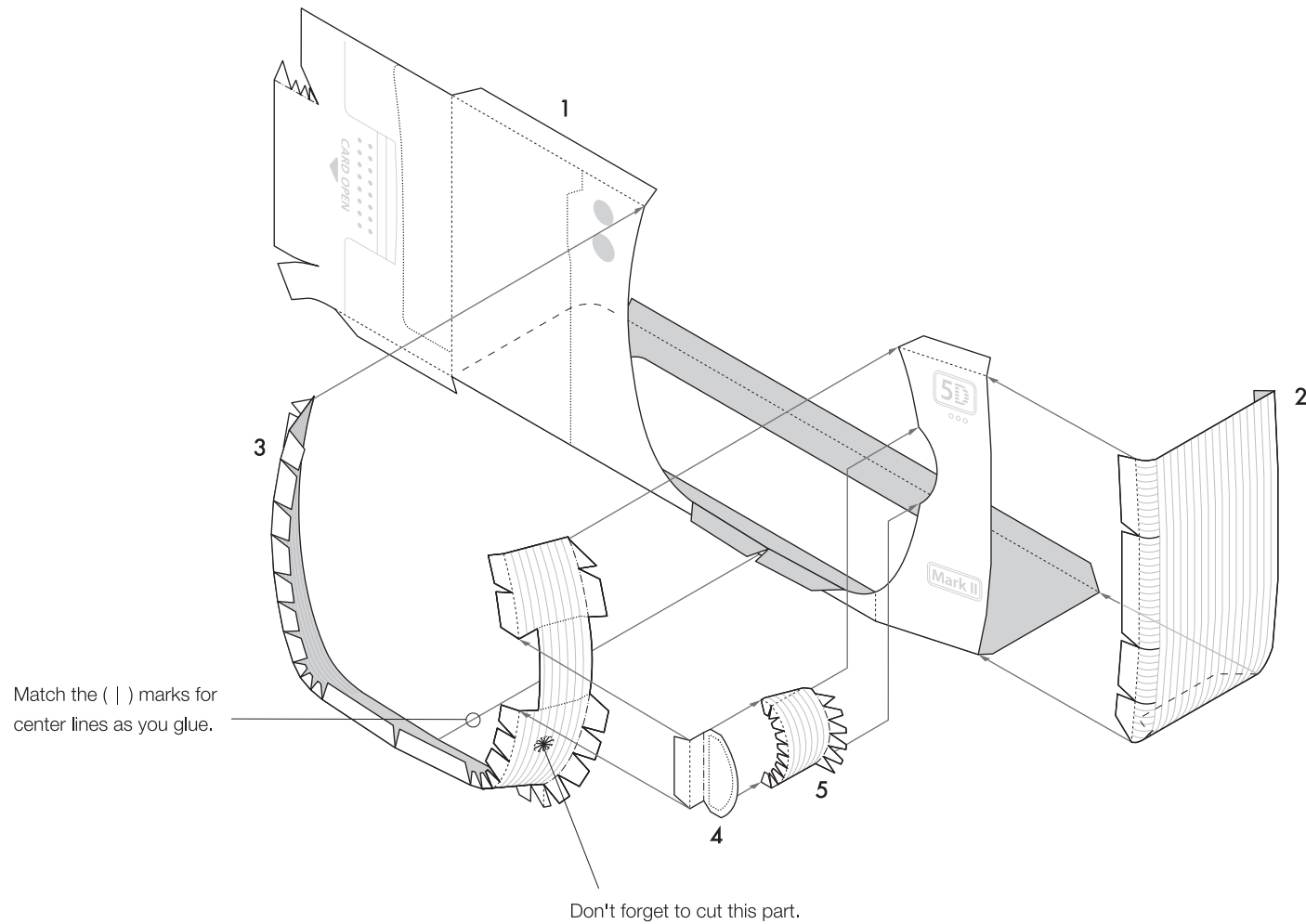

The parts shaded [solid gray] in the illustrations indicate the rear side of the paper.
The parts shaded [horizontal lines] in the illustrations indicate where curling is required.

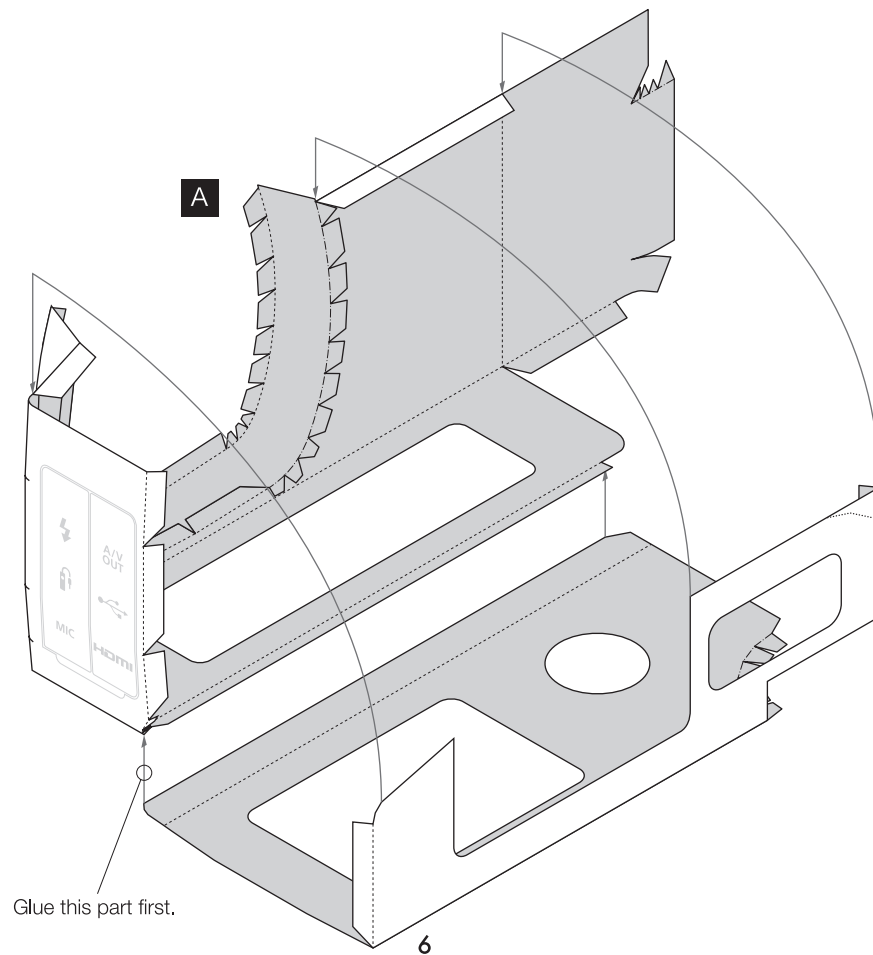

① How to build the body -2-

Glue the pasting margins on the bottom part and carefully assemble into the shape.
Position precisely to prevent gaps or shifting as you glue.
Insert your hand or a pallet from the opening and firmly hold the glued parts.

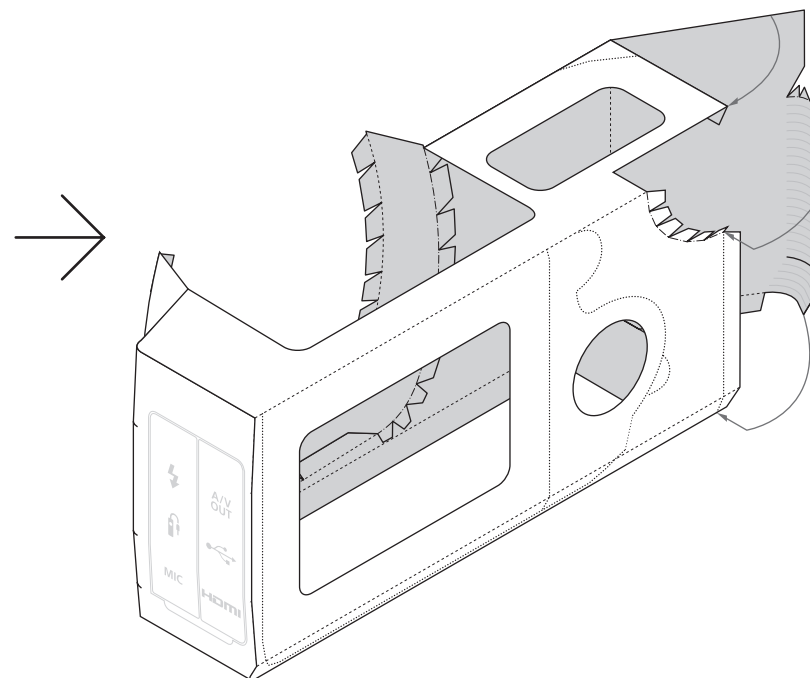

Carefully arch the assemble into the shape and glue.



The parts shaded  in the illustrations indicate the rear side of the paper.
The parts shaded  in the illustrations indicate where curling is required.

① How to build the body -3-

Carefully curl the parts as shown in the illustration and the finished image,
and form the shape as you glue.
The trick is to apply sufficiently firm curling in advance.

Carefully arch each piece
and assemble into the shape.

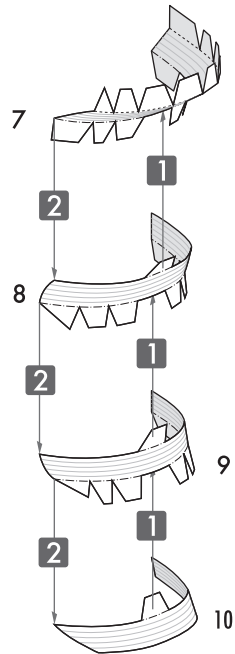

Assemble in order: **1** to **2**.

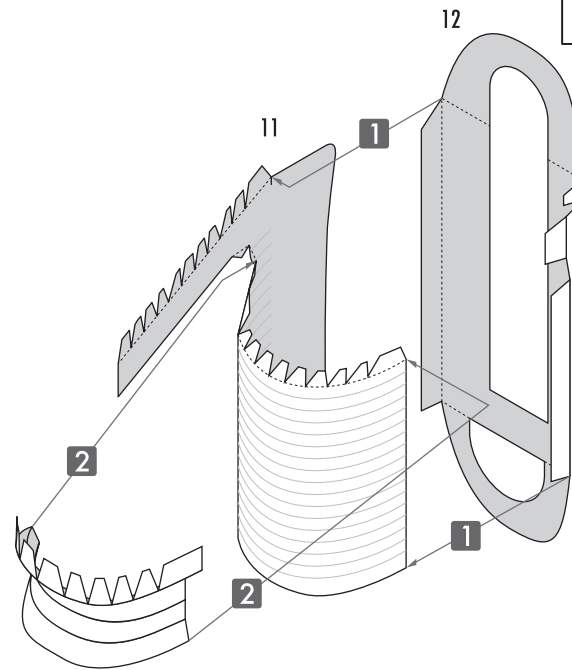

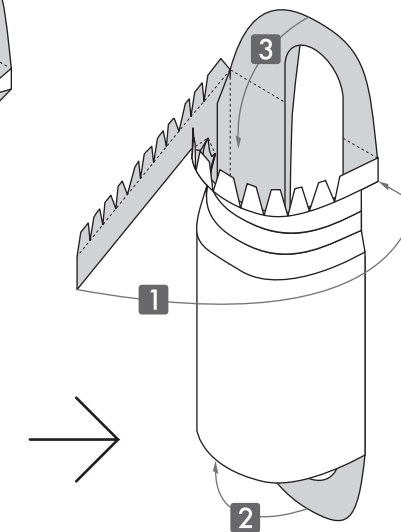
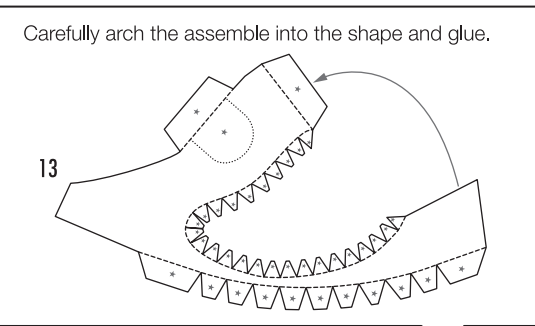

Assemble in order: **1** to **2**.

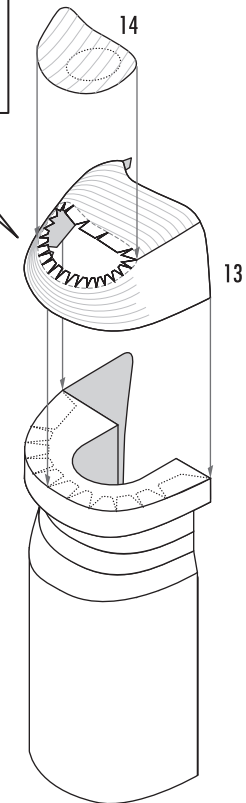

Assemble in order: **1** to **3**.



The parts shaded  in the illustrations indicate the rear side of the paper.
The parts shaded  in the illustrations indicate where curling is required.

② How to assemble the head -1-

Carefully curl the parts as shown in the illustration and the finished image, and form the shape as you glue.
The trick is to apply sufficiently firm curling in advance.

D

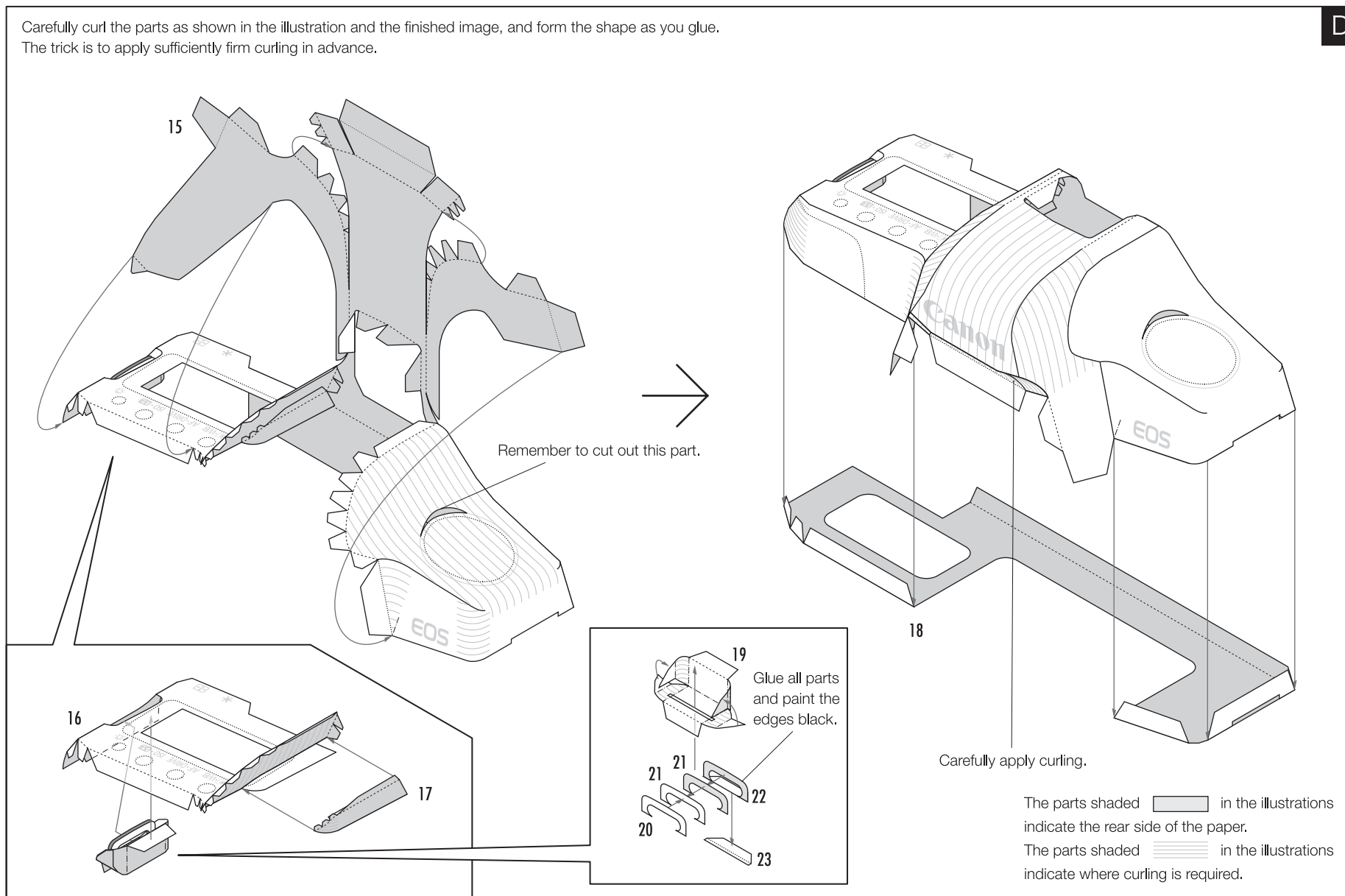

② How to assemble the head -2-

Carefully curl the parts as shown in the illustration and the finished image, and form the shape as you glue.
The trick is to apply sufficiently firm curling in advance.

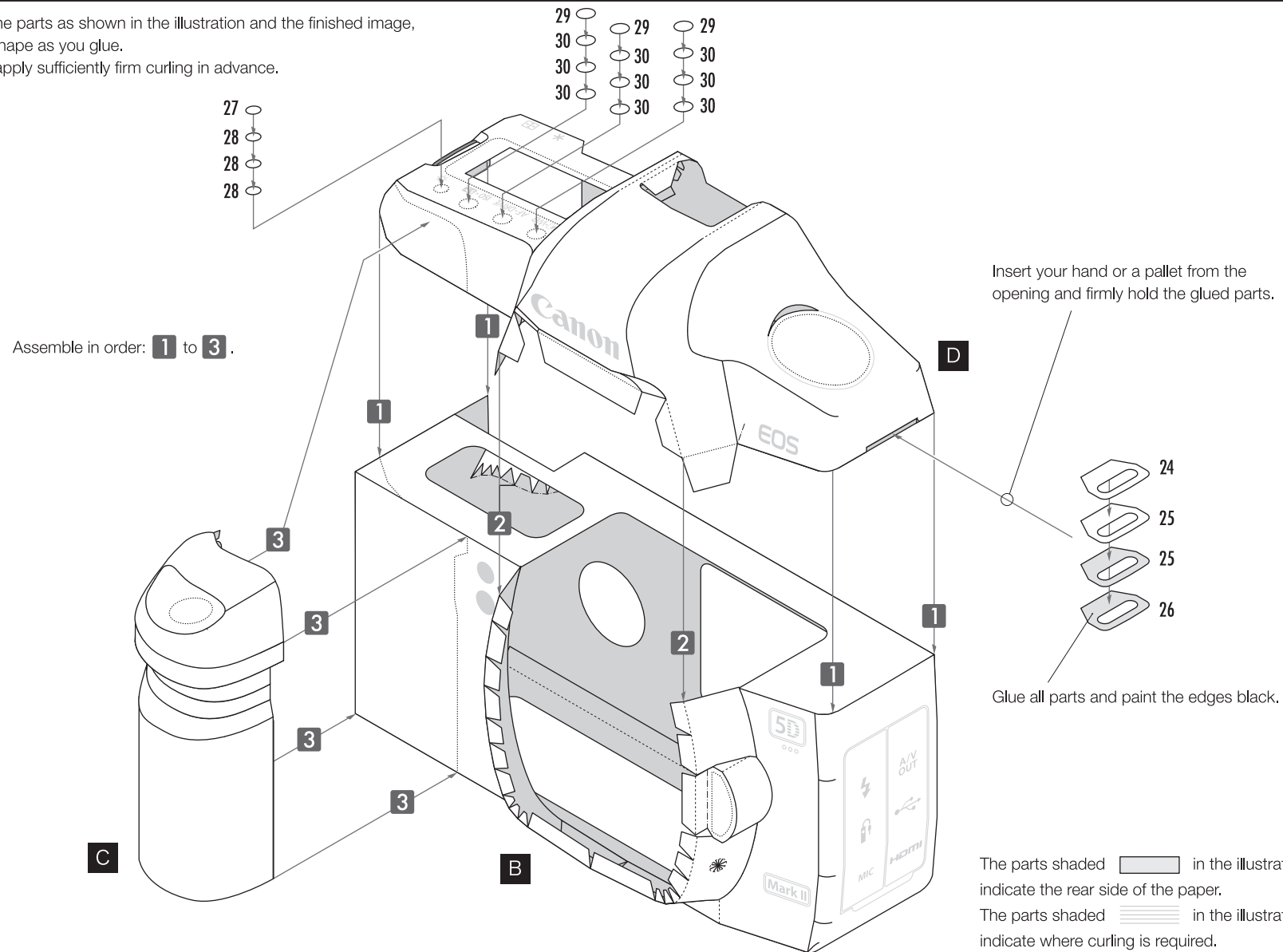

③ How to assemble the operation panel -1-

F

Carefully curl the parts as shown in the illustration and the finished image, and form the shape as you glue. The trick is to apply sufficiently firm curling in advance.

Insert your hand or a pallet from the opening and firmly hold the glued parts.

E

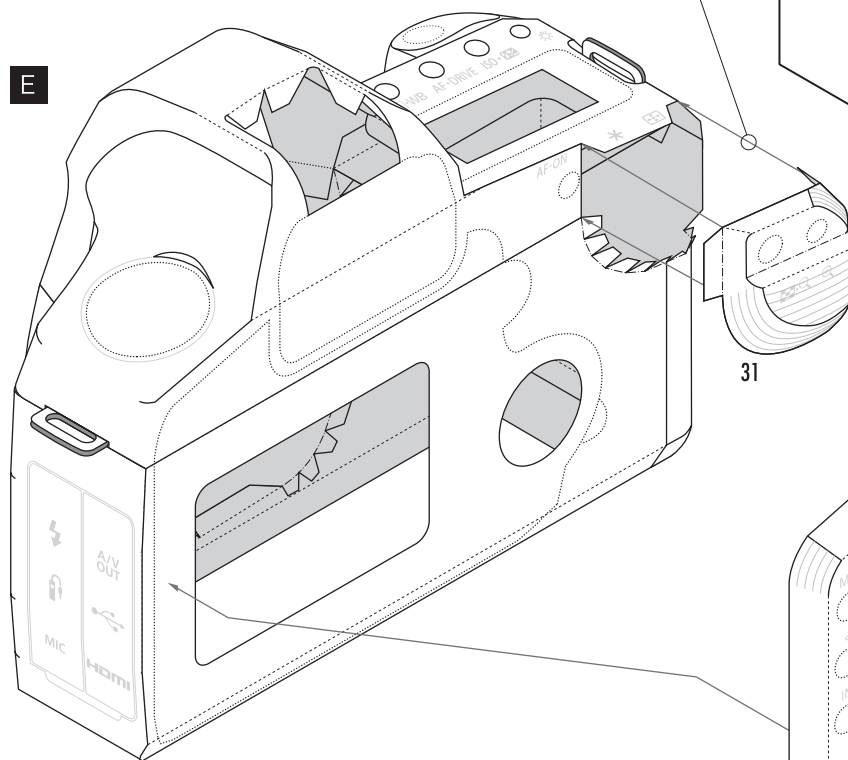

Carefully apply curling and assemble into the shape.

Cut this part.

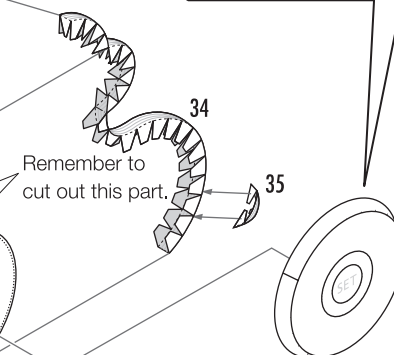
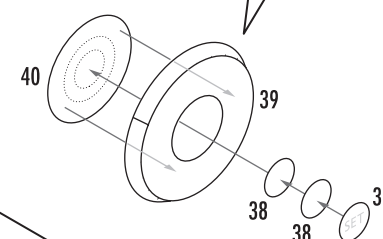
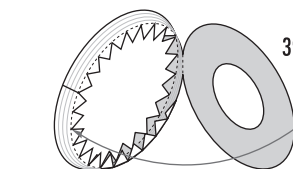
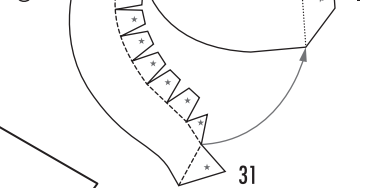

32

The parts shaded  in the illustrations indicate the rear side of the paper.
The parts shaded  in the illustrations indicate where curling is required.

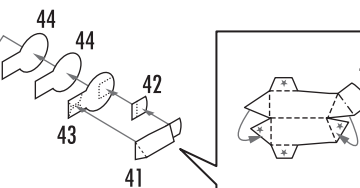

③ How to assemble the operation panel -2-

G

Carefully curl the parts as shown in the illustration and the finished image, and form the shape as you glue.

The trick is to apply sufficiently firm curling in advance.

Match the (|) line of each part and glue.

F

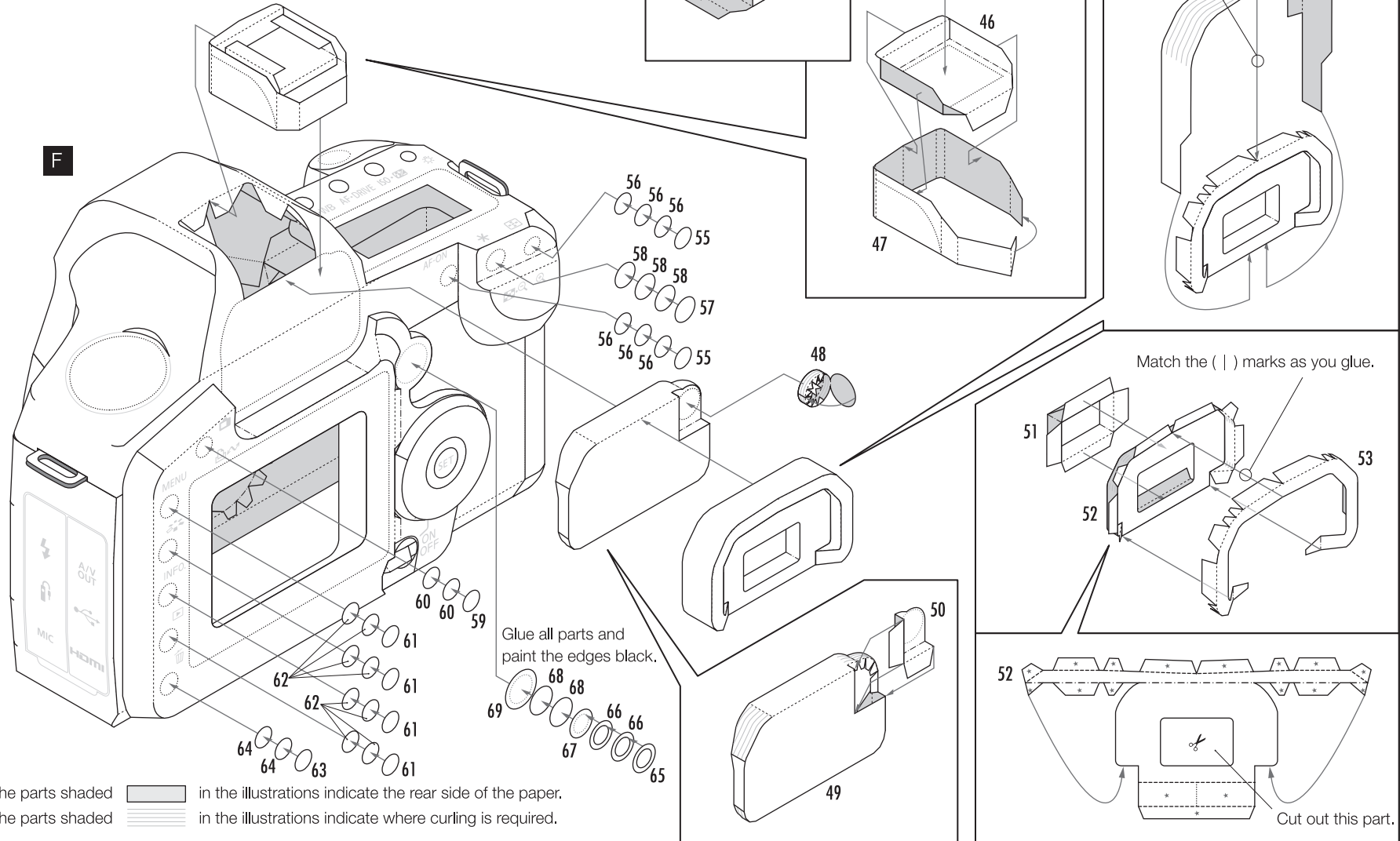

EOS 5D Mark II [How to make the model 9 / 18]

④ How to assemble the mirror box

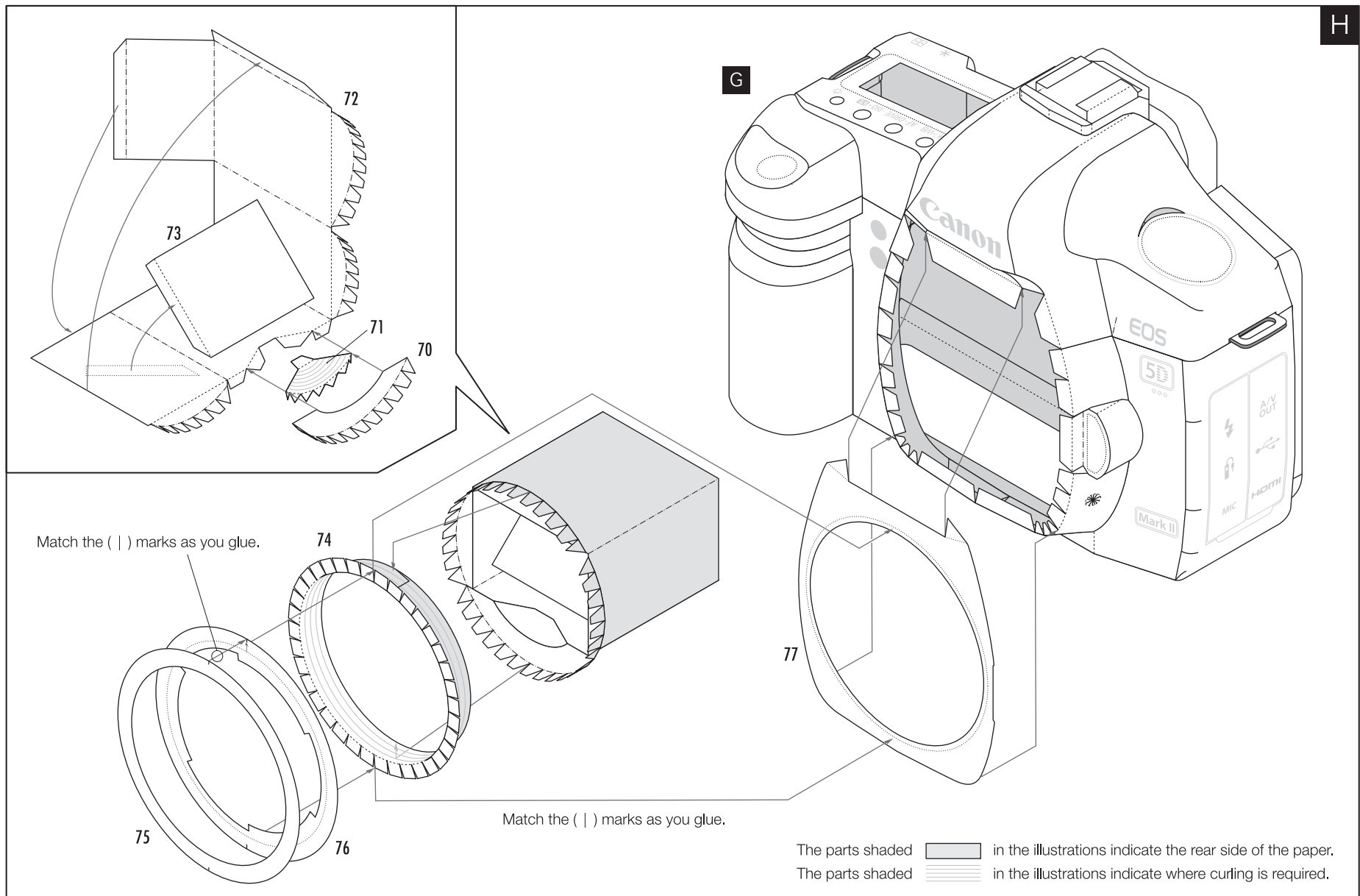

EOS 5D Mark II [How to make the model 10 / 18]

⑤ How to assemble the bottom

After you have assembled all parts, attach the bottom and display panels as covers to complete the main body.

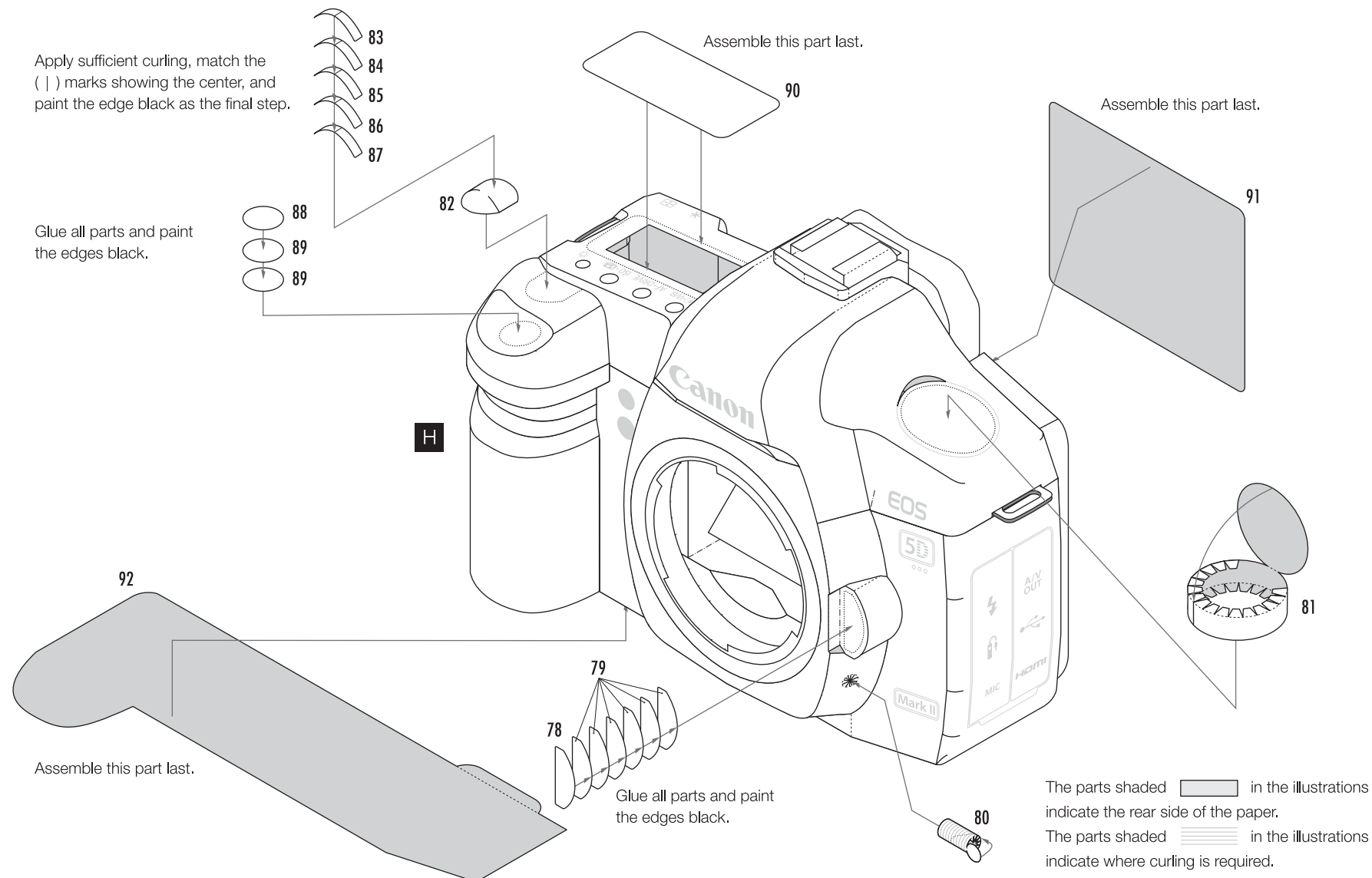

⑥ How to assemble the lens body -1-

Carefully curl the parts as shown in the illustration and the finished image, and form the shape as you glue.

Match the (|) marks for center lines as you glue.

Match the (|) marks for center lines as you glue.
The arrows ↑ indicate the top.

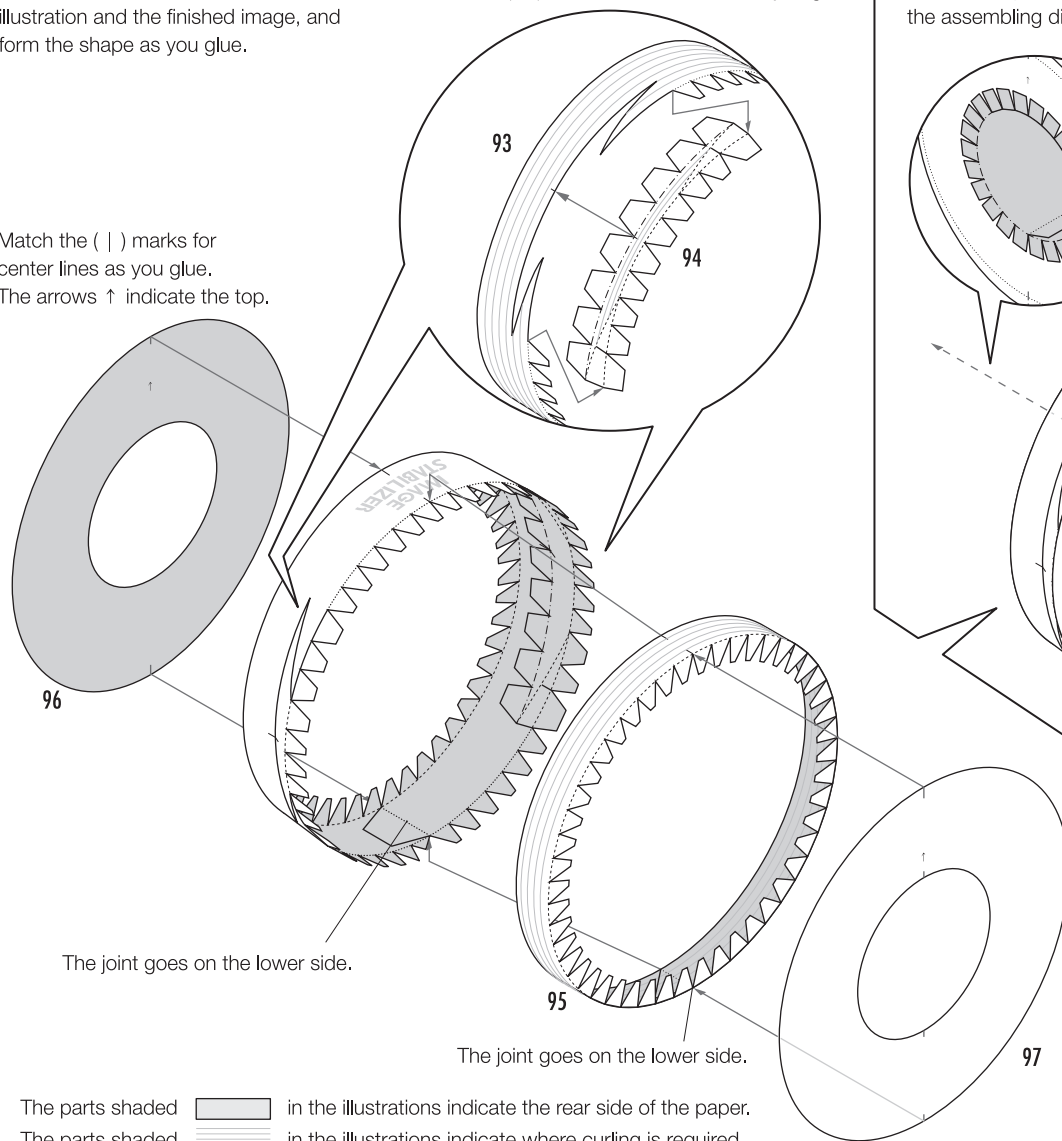

Before you glue them, try assembling them temporarily to check the assembling directions and positions.

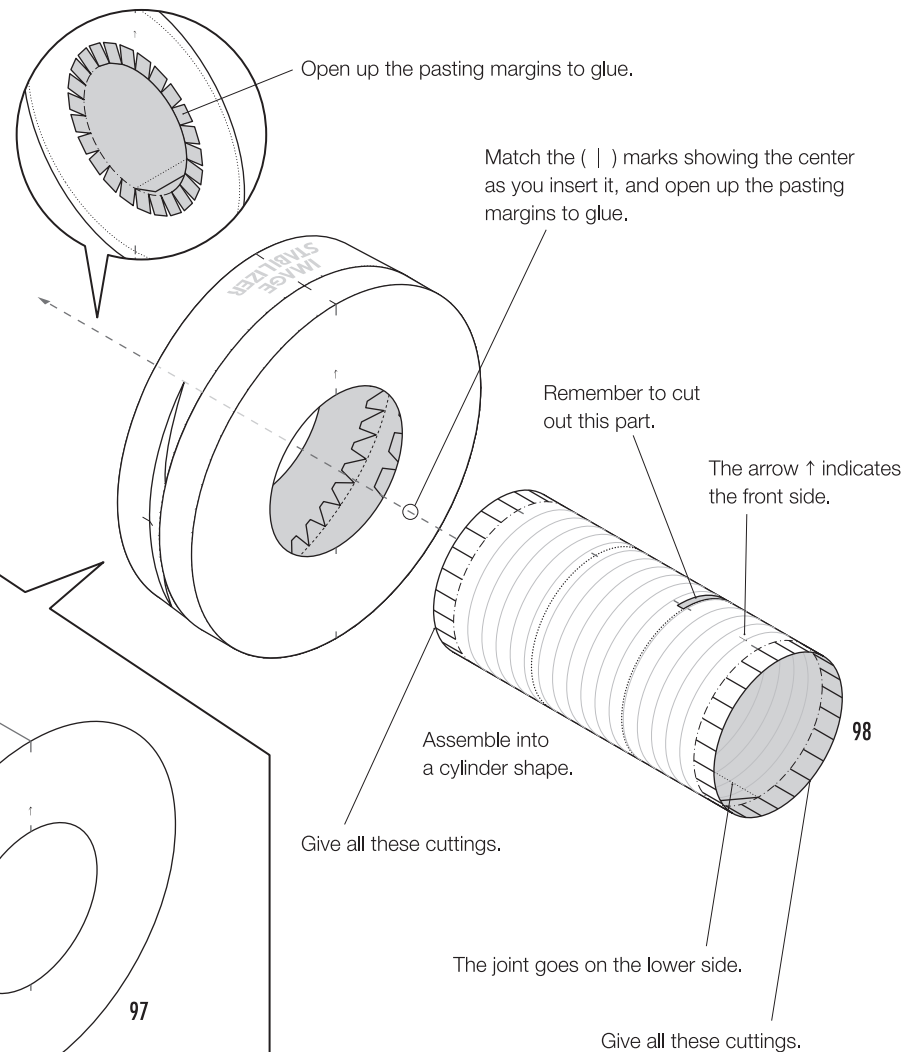

7 How to assemble the zoom ring

J

The parts shaded  in the illustrations indicate the rear side of the paper.

The parts shaded  in the illustrations indicate where curling is required.

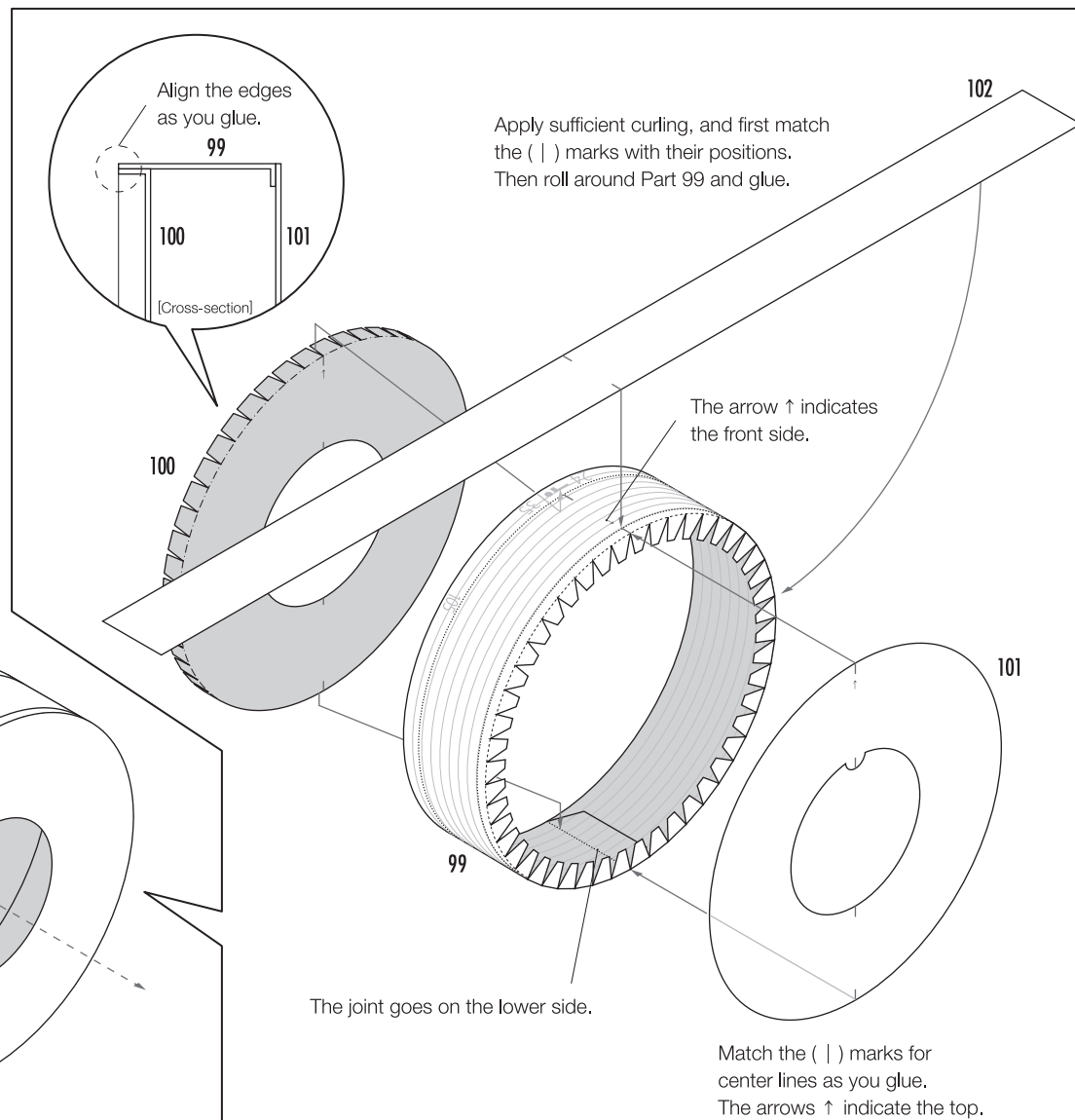
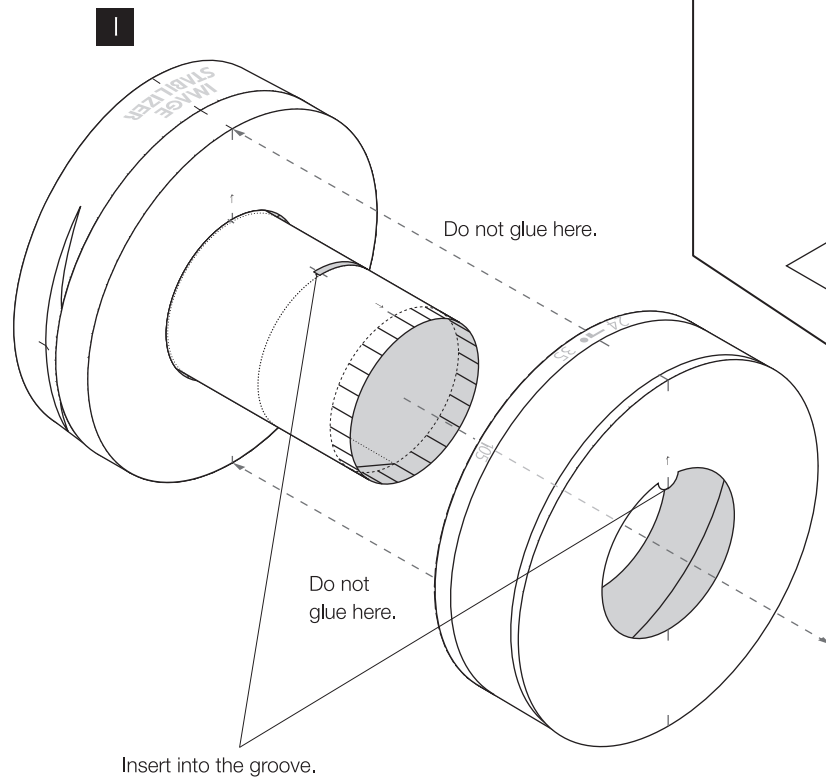

EOS 5D Mark II [How to make the model 13 / 18]



⑥ How to assemble the lens body -2-

K

Assemble in order: 1 to 7.

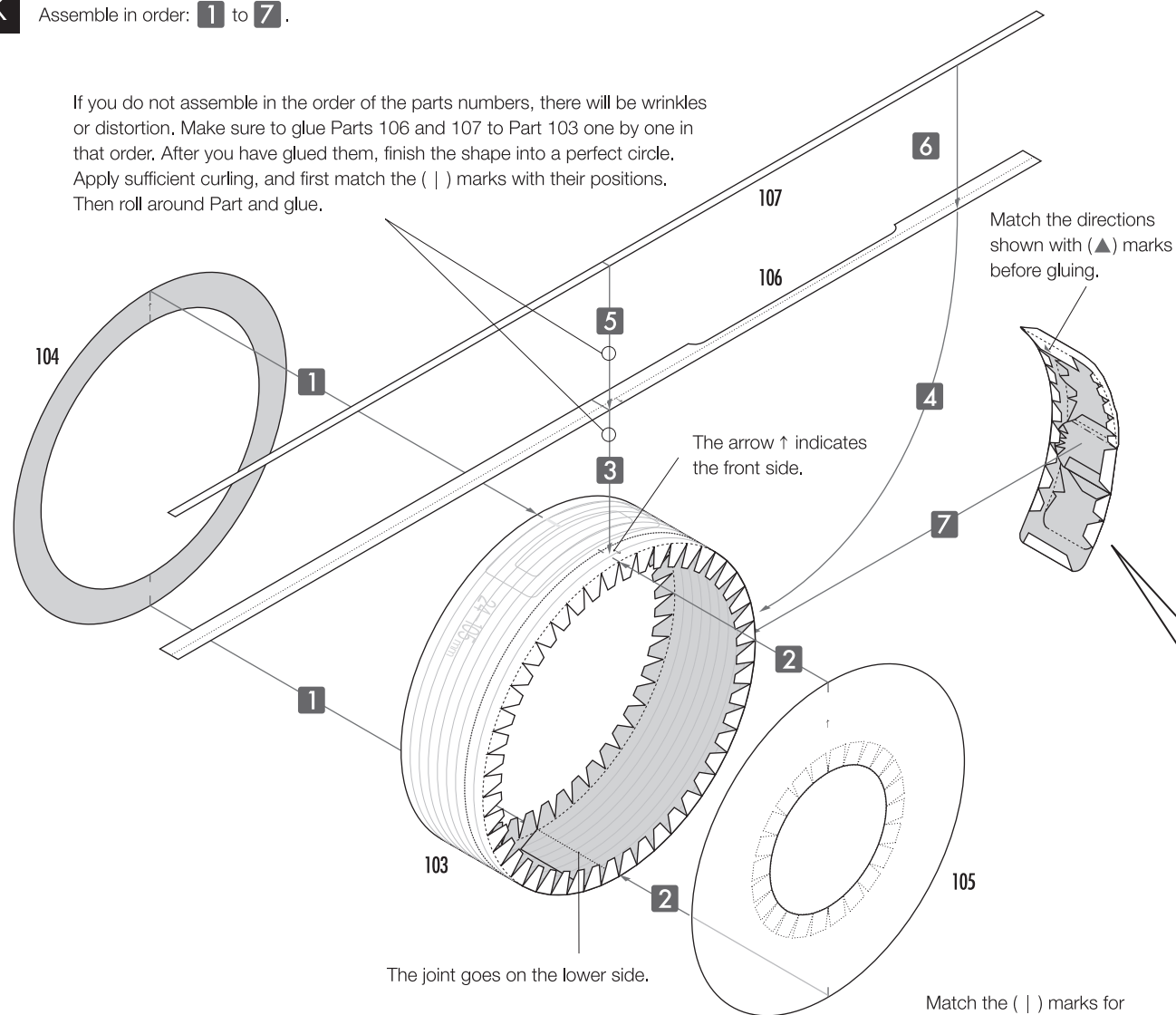
If you do not assemble in the order of the parts numbers, there will be wrinkles or distortion. Make sure to glue Parts 106 and 107 to Part 103 one by one in that order. After you have glued them, finish the shape into a perfect circle. Apply sufficient curling, and first match the (|) marks with their positions. Then roll around Part and glue.



The parts shaded  in the illustrations indicate the rear side of the paper.
The parts shaded  in the illustrations indicate where curling is required.

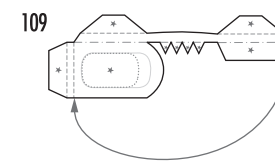
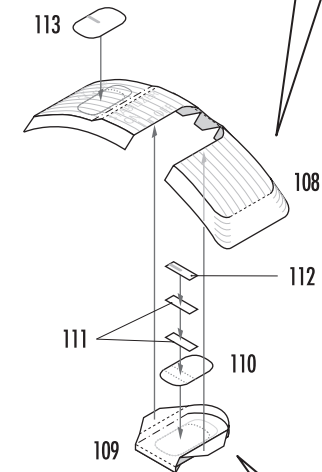
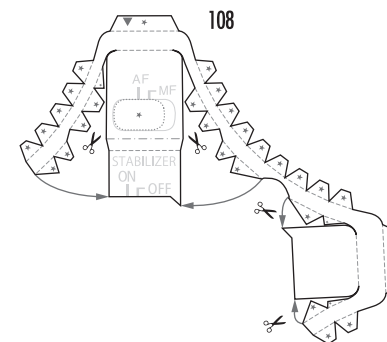

⑥ How to assemble the lens body -3-

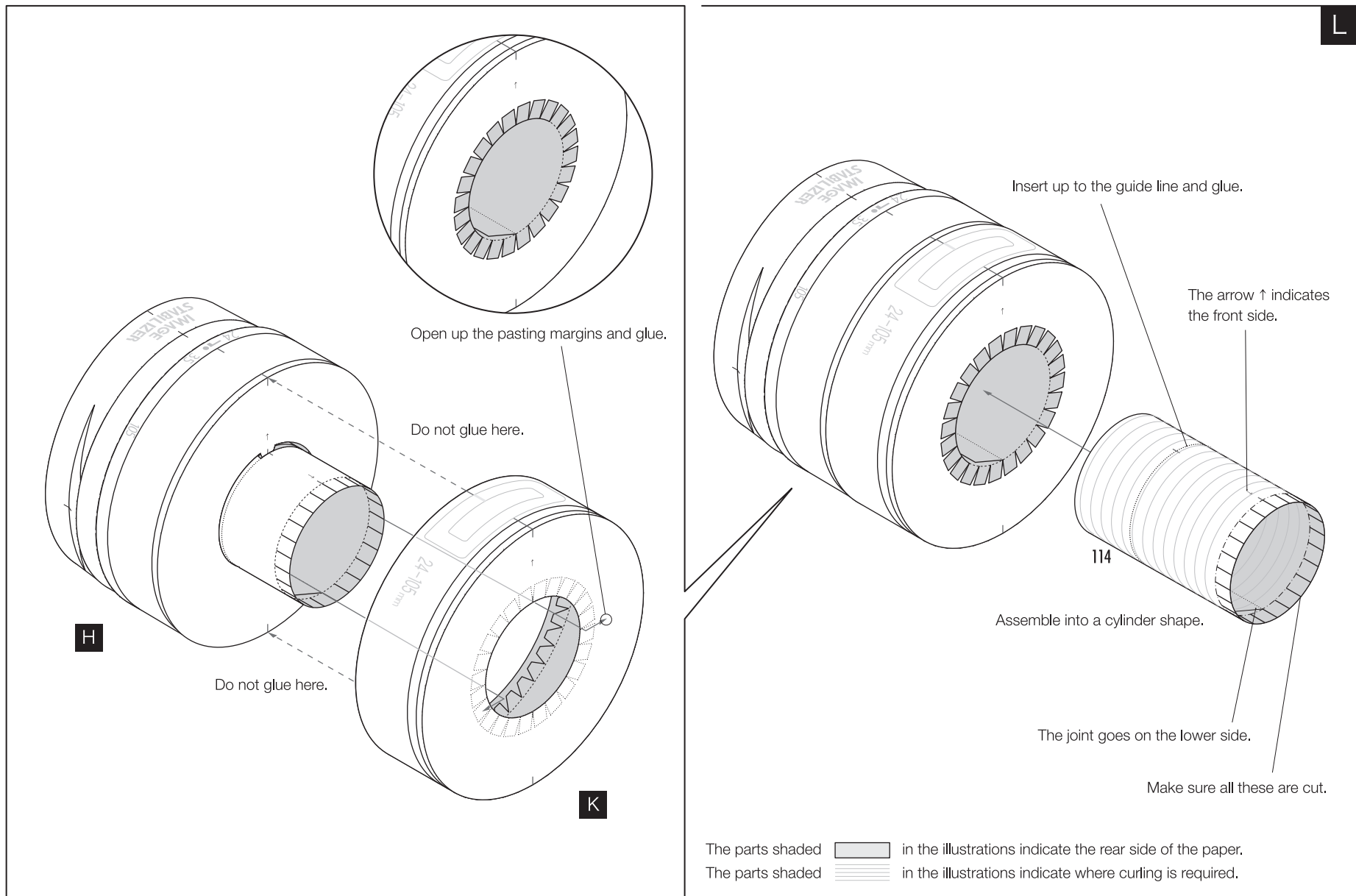

⑧ How to assemble the focus ring

M Assemble in order: **1** to **8**.

* If you do not assemble in the order of the parts numbers, there will be wrinkles or distortion. Make sure to glue Parts 118 - 124 to Part 115 one by one in that order. After you have glued them, finish the shape into a perfect circle.

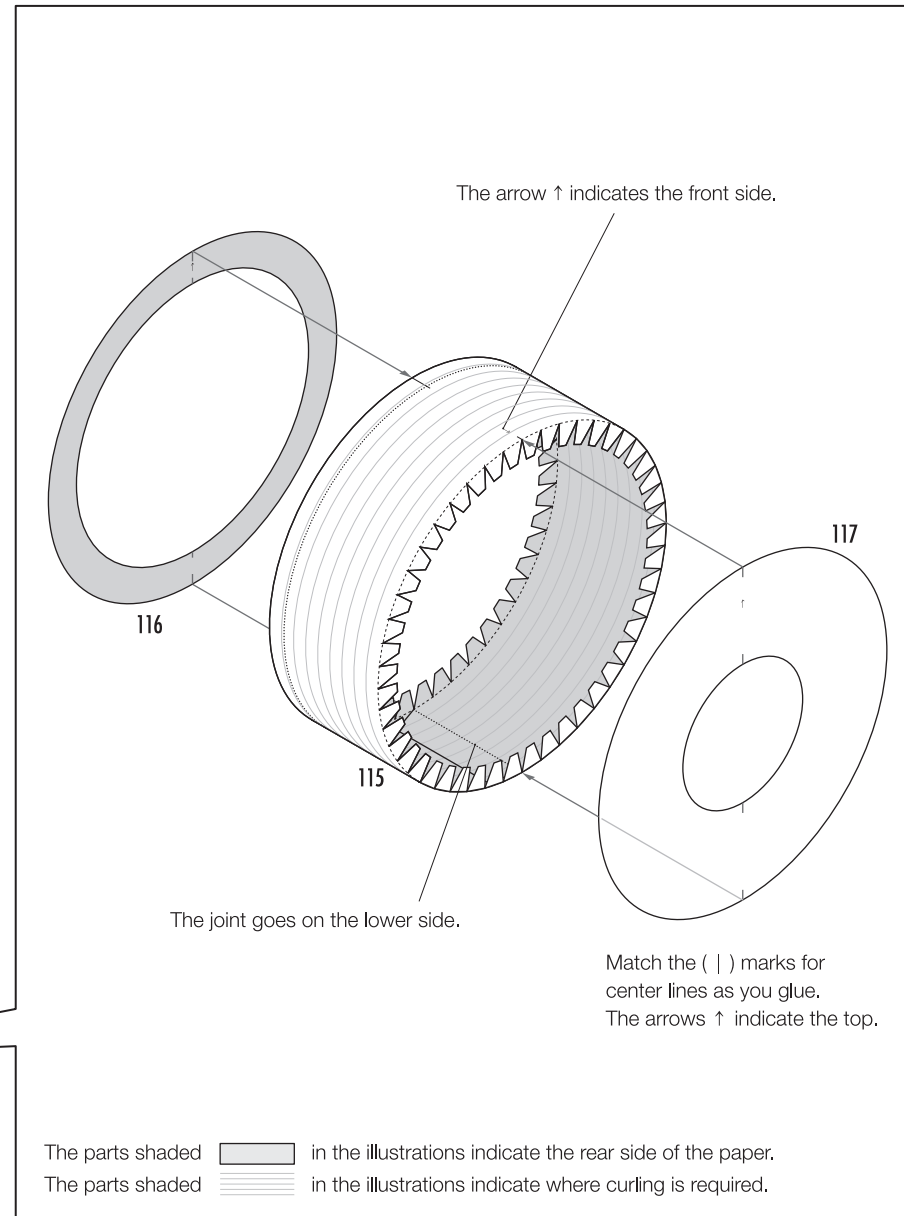
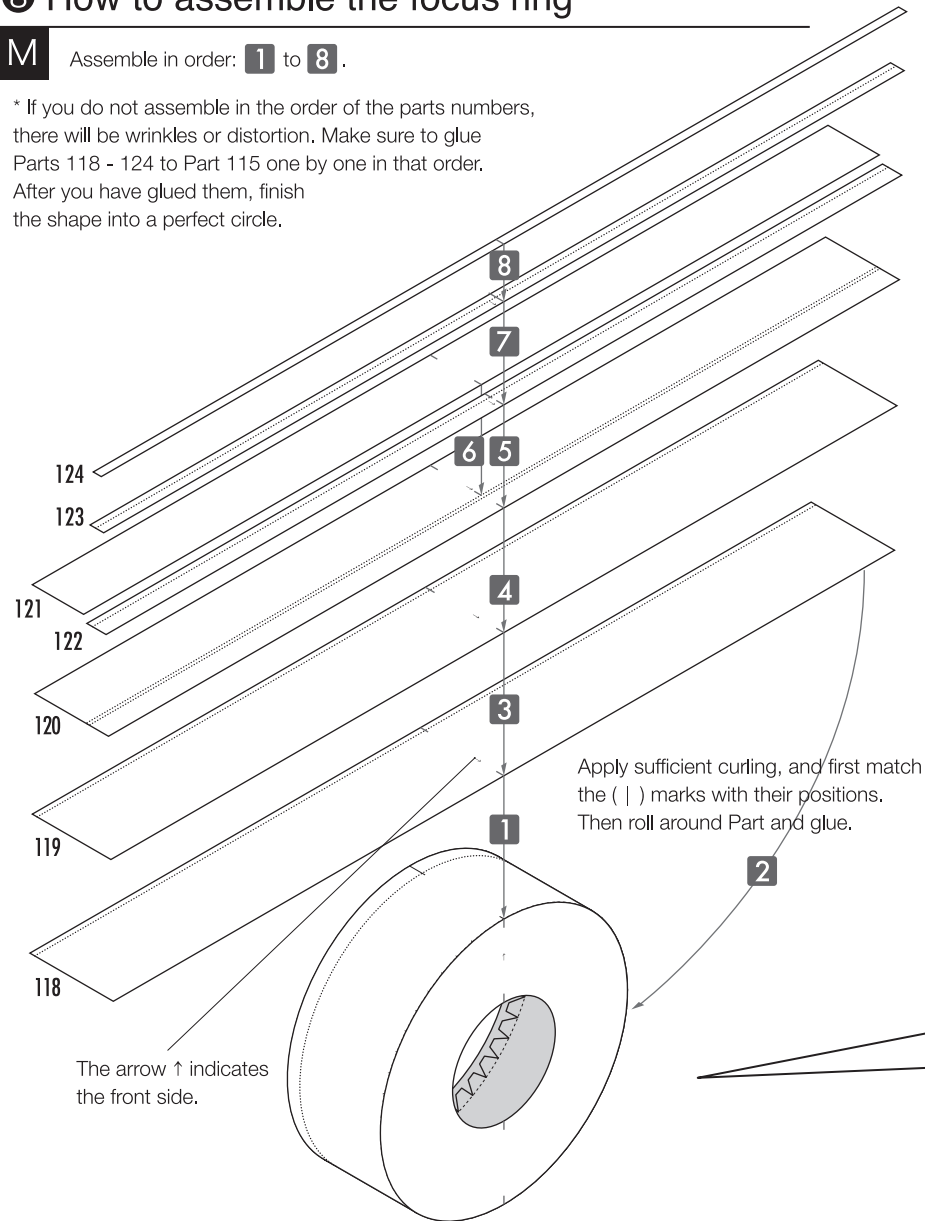

⑥ How to assemble the lens body -4-

N

The parts shaded  in the illustrations indicate the rear side of the paper.

The parts shaded  in the illustrations indicate where curling is required.

Match the (|) marks for center lines as you glue.
The arrows ↑ indicate the top.

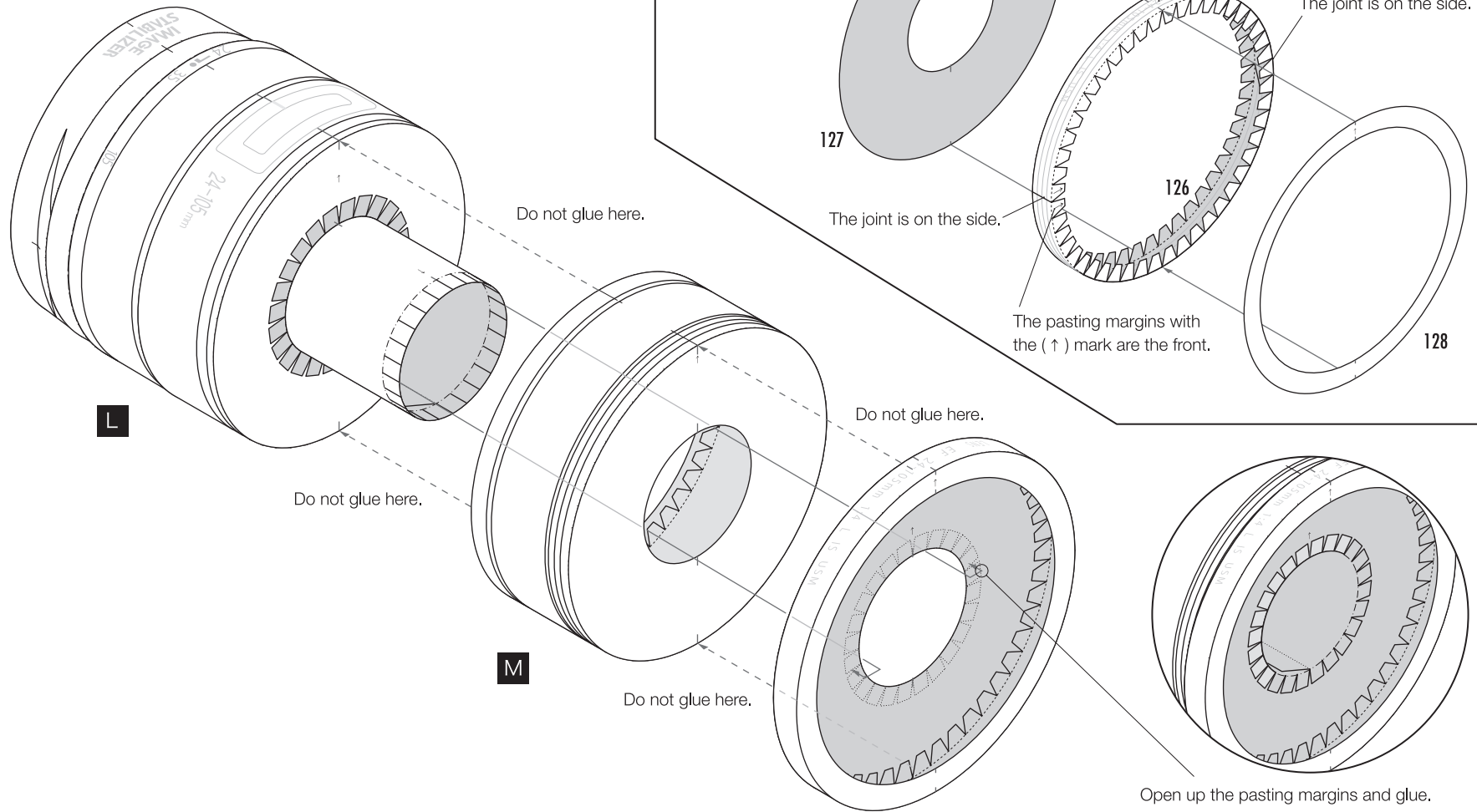

EOS 5D Mark II [How to make the model 17 / 18]

⑨ How to assemble the front lens

○

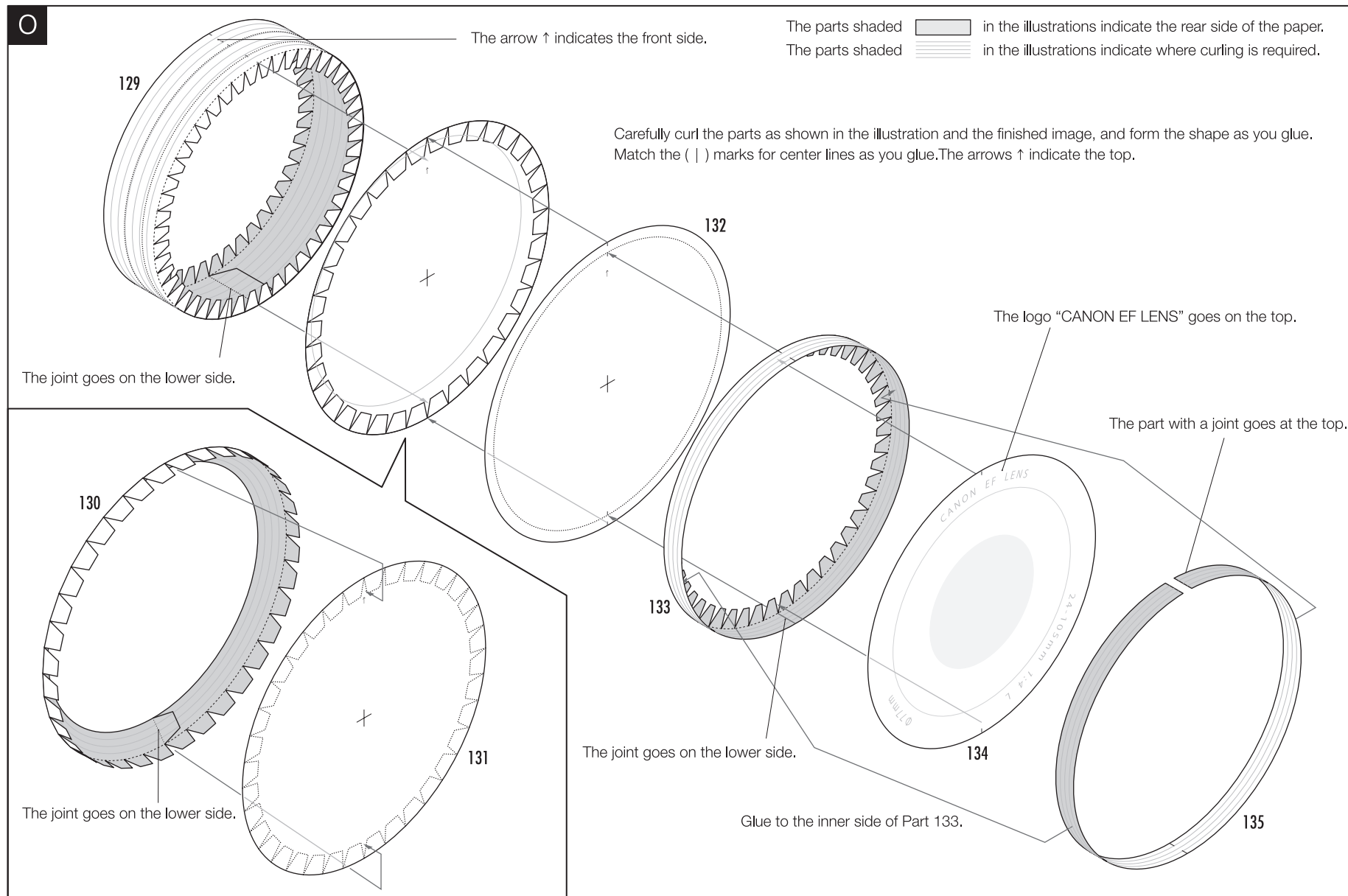

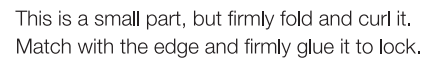

Canon