

Papercraft "Skull Keeta" instructions

step 1

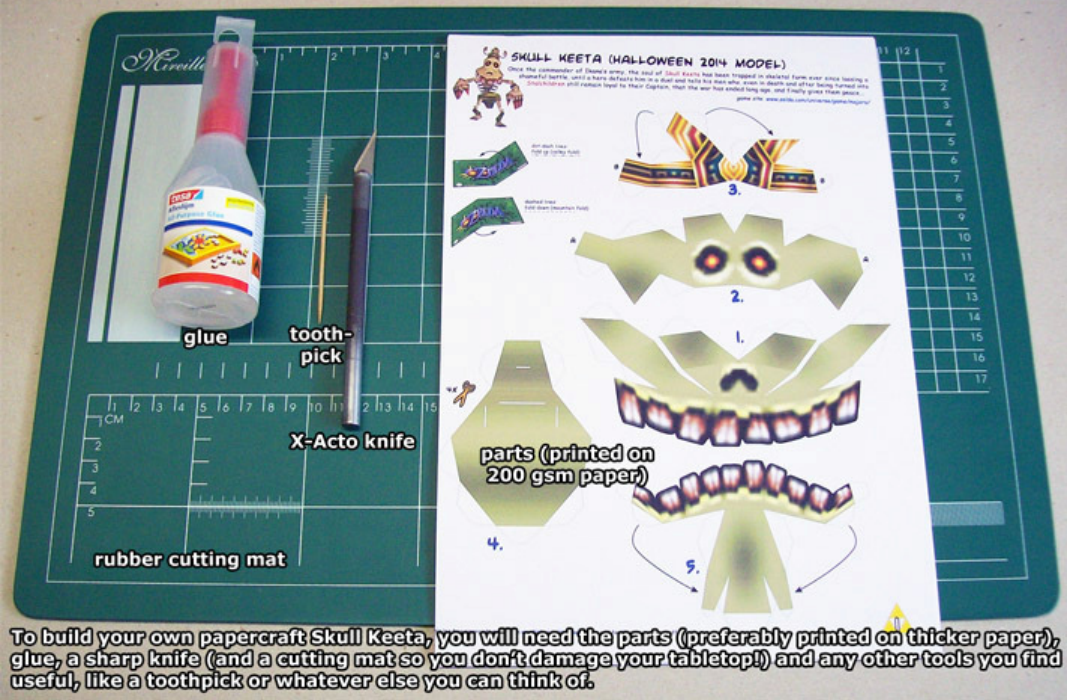

To build your own papercraft Skull Keeta, you will need the parts (preferably printed on thicker paper), glue, a sharp knife (and a cutting mat so you don't damage your tabletop!) and any other tools you find useful, like a toothpick or whatever else you can think of.

step 2

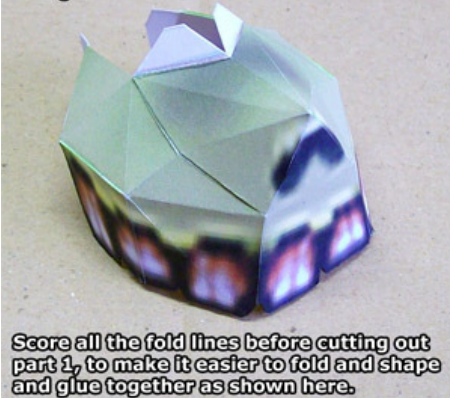

step 3

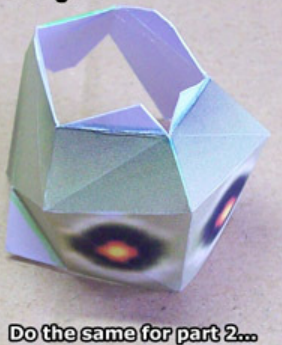

step 4



step 5

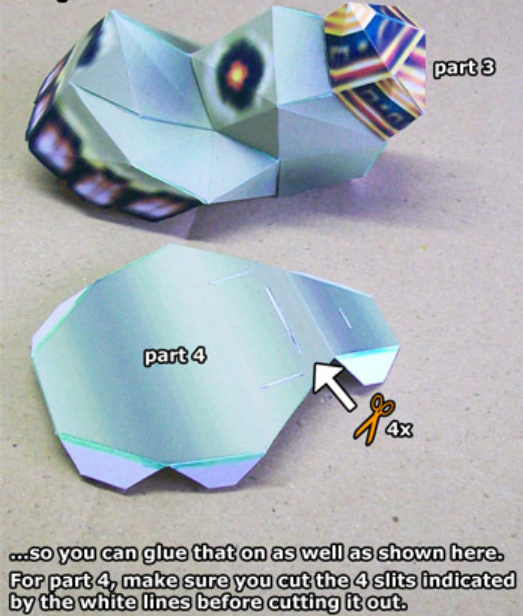

step 6

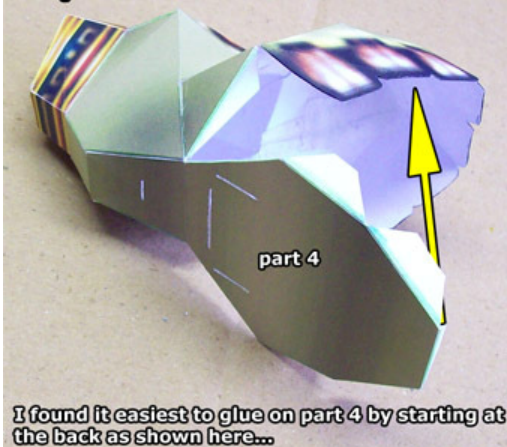

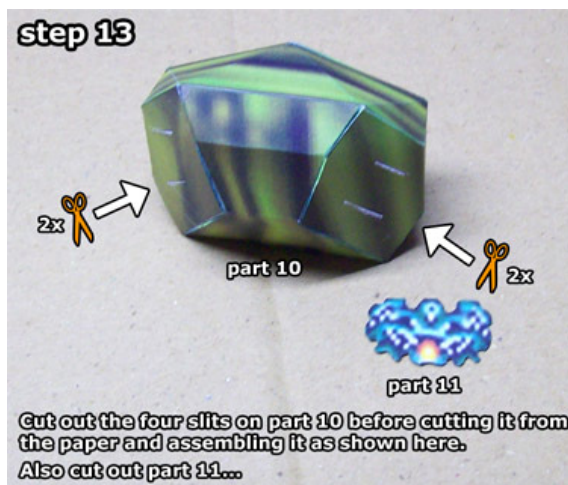
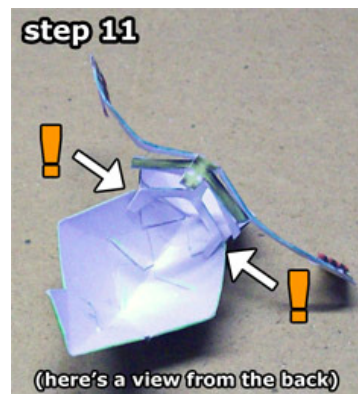
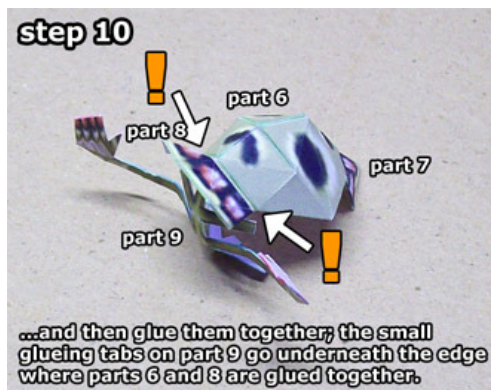
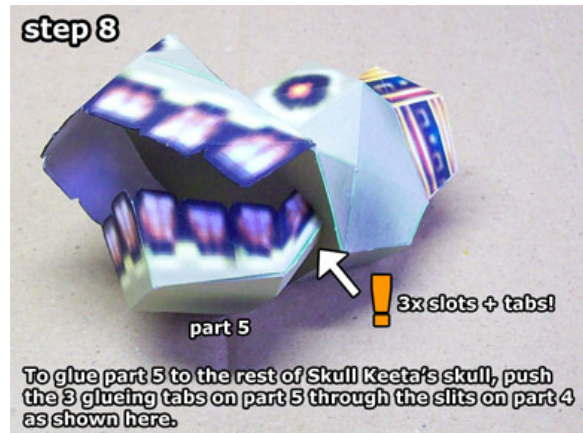
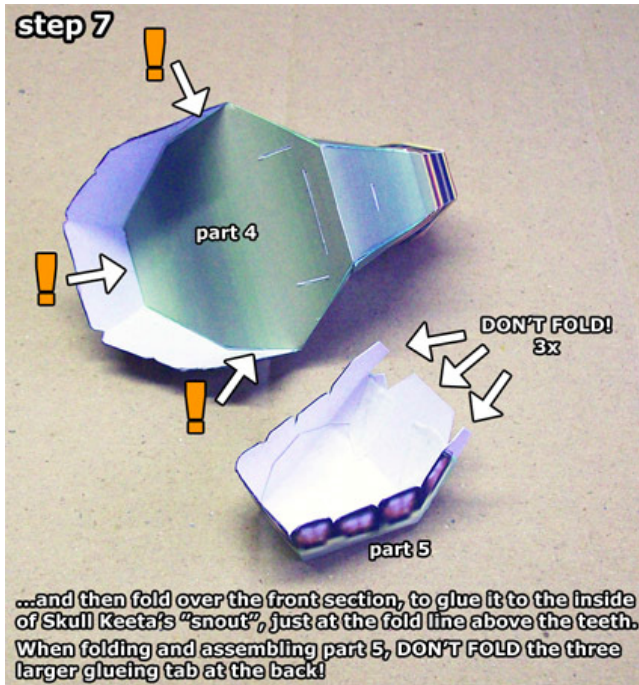

step 14



...and then glue it to the back (flat) side of part 10 (I think the orange jewel should be at the top, though...? ;o)

step 15

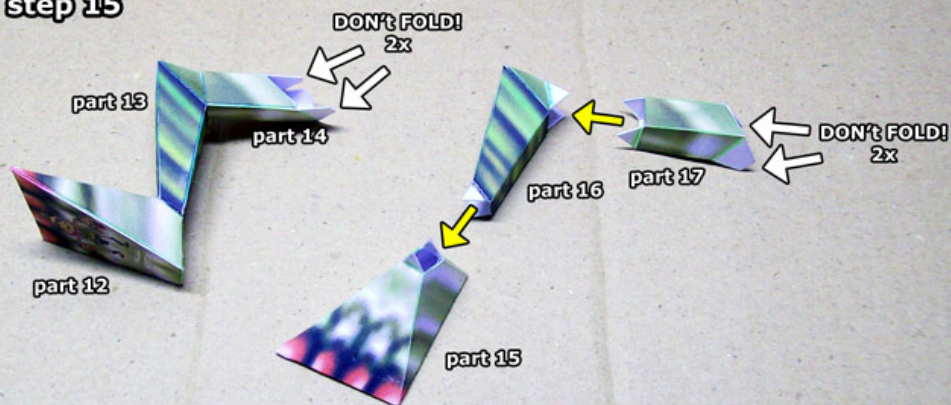

Next, cut out and assemble the legs as shown here (parts 12-14 and 15-17). DON'T fold the larger glueing tabs on parts 14 and 17!

step 16

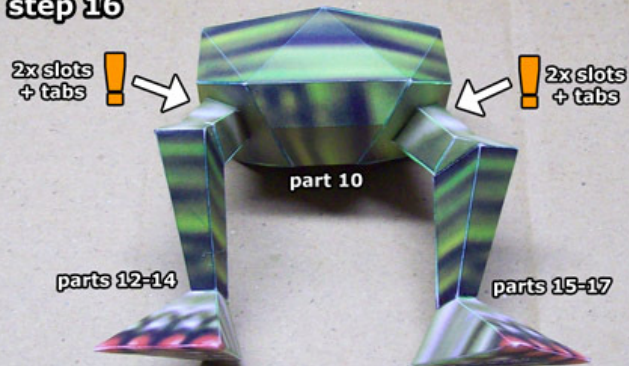

Now glue the legs to Skull Keeta's "butt" by pushing the larger glueing tabs through the slits on part 10.

step 17

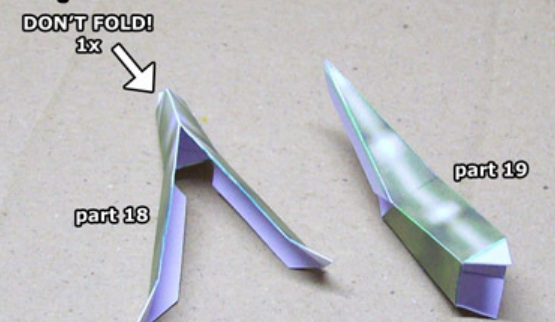

Cut out and assemble parts 18 (DON'T fold the larger glueing tab at the top!) and 19...

step 18



step 19

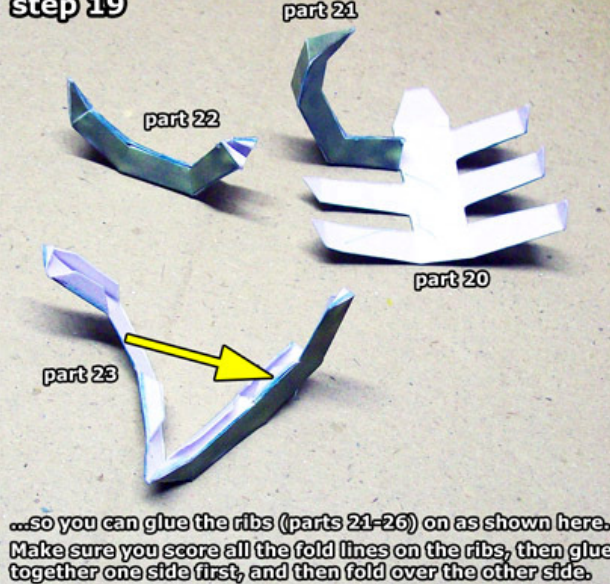

step 20



Once you've glued all the ribs (parts 21-26) to part 20 as shown here...

step 21

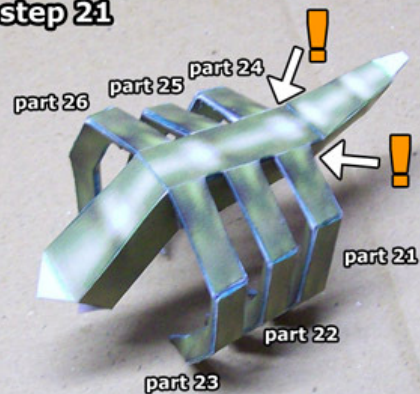

...glue the whole assemble to the back of parts 18+19. Make sure to properly glue the sides of the ribs to part 19!

step 22



Now glue the whole spine and ribs (parts 18-26) to Skull Keeta's "butt".
Next, cut out part 27 and glue it to the two top ribs (again, I think the orange jewel should be at the top, though...?)

step 23

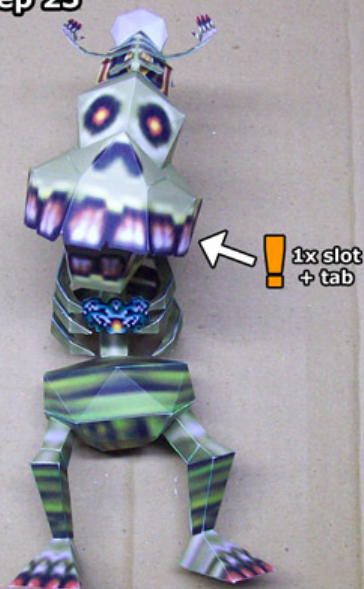

You can also glue the Skull Keeta's head to his spine, by pushing the larger glueing tab on part 18 through the last slit on part 4.

step 24

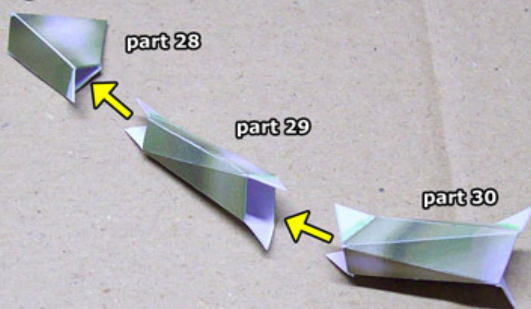

Cut out and assemble parts 28-30...

step 25



...and then glue them together as shown here.

step 26

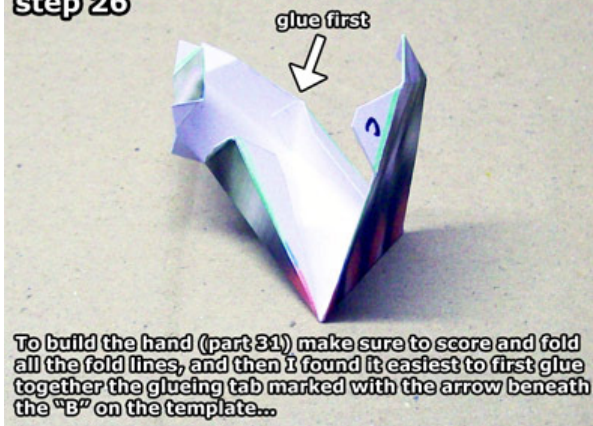

step 27



step 28

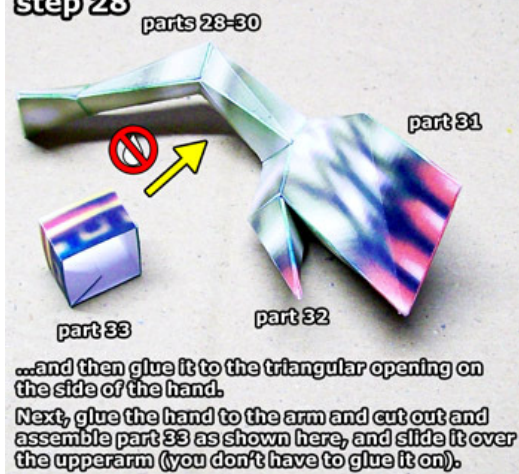

step 29



step 30

