

# LEGO 6009 Black Knight instructions

## step 1

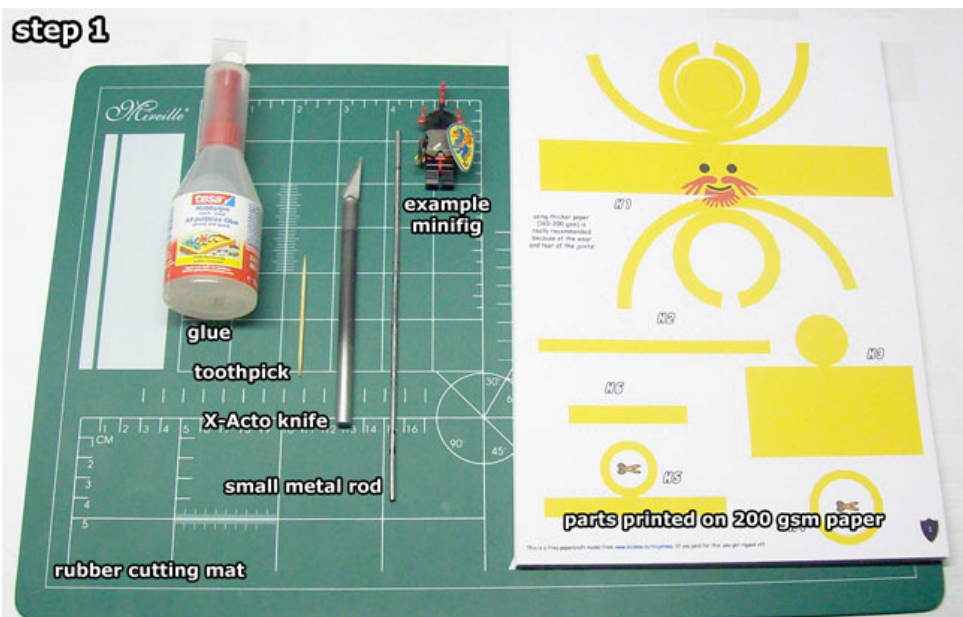

Print the parts on strong, thicker paper and gather your papercraft tools. For the best results, you can use markers or coloured pencils to colour the white edges of the cut paper.\*

\*[www.tinyurl.com/edgecolouring](http://www.tinyurl.com/edgecolouring)

## step 2



Cut out part H1 (don't forget the three slits on top!) and then assemble it as shown here.

## step 3



Glue part H2 into a ring, and then glue it to the bottom of part H1.

## step 4

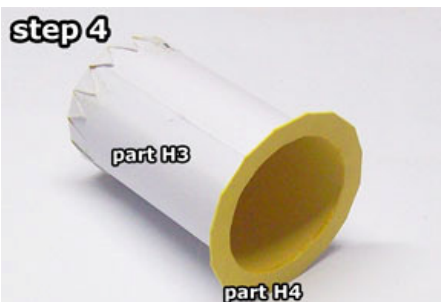

Glue part H3 into a hollow cylinder (with the coloured side in) and then glue part H4 to the open end as shown here.

## step 5



Next, glue parts H3+H4 inside the bottom of part the head.

## step 6

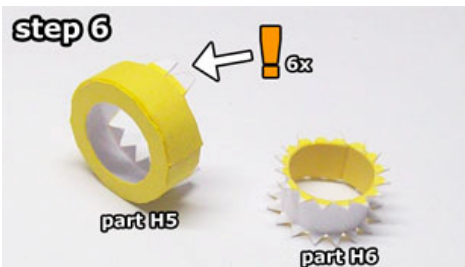

DON'T score or fold the 6 bigger glueing tabs on part H5, and assemble part H6 with the coloured side in as shown here.

## step 7



Glue part H6 underneath the hole of part H5, and then glue both parts on top of the head by pushing the 6 glueing tabs through the slits.

## step 8

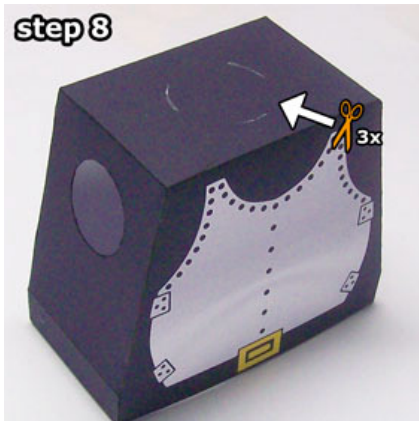

Cut out and assemble part T1 as shown here (don't forget the 3 slits on top!)

### step 9

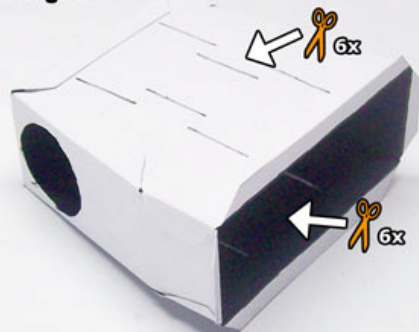

Glue together part T2 with the coloured side in, and don't forget to cut the 12 slits on the front and back.

### step 10

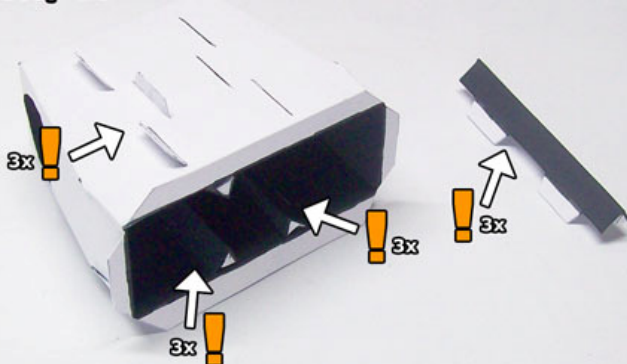

Fold parts T3-T6 (but NOT the 3 larger glueing tabs on each of them!) and then glue them inside part T2 by pushing the glueing tabs through the slits.

### step 11

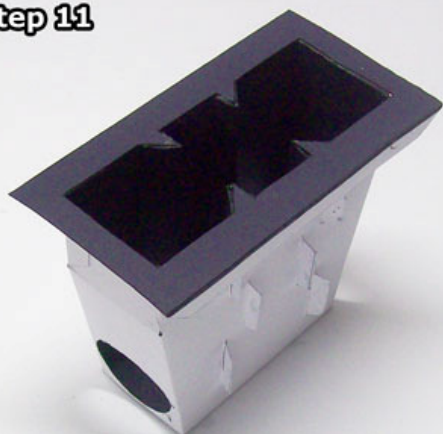

Once parts T3-T6 are glued in place, glue part T7 to the bottom as shown here.

### step 12



Glue parts T8 and T9 into rings (with the coloured sides in!) and then glue them over the holes on the sides of part T2.

### step 13

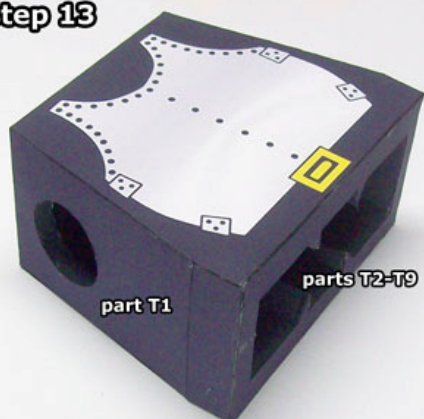

Glue parts T2-T9 inside part T1 as shown here; take your time to align the holes on the sides.

### step 14

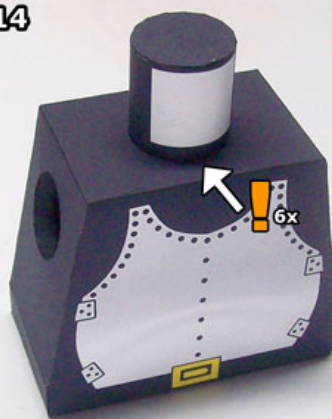

Glue together part T10 (DON'T fold or fold the 6 bigger glueing tabs!) and then glue it on top of the torso by pushing the 6 glueing tabs through the slits.

### step 15



Cut out and assemble part LA1.

### step 16



Next, assemble part LA2...

### step 17



...and then glue it to part LA1 as shown here.

### step 18



Cut out the three slits on part LA3, and then glue it to the rest of the arm.

### step 19



Glue part LA4 into a hollow cylinder (with the coloured side in!) and then glue part LA5 to the open end.



### step 20



parts LA4+LA5

Next, glue parts LA4+LA5 into the open end of the arm.

### step 21

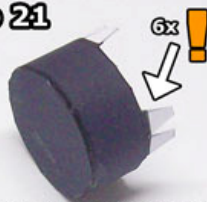

Cut out and assemble part LA6, but DON'T score or fold the 6 bigger glueing tabs!

### step 22



Glue part LA6 to the rest of the arm, by pushing the 6 glueing tabs through the slits.

### step 23



parts LA1-LA6

parts RA1-RA6

The right arm (parts RA1-RA6) goes together the same way as the left arm (parts LA1-LA6).

### step 24

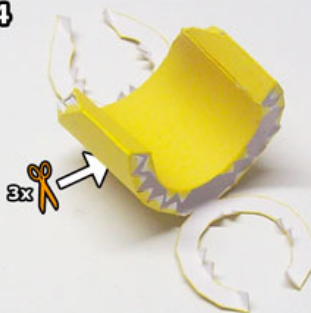

To assemble the hands, it's very important to pre-shape the inside and the outside of the hand into a "C" shape ((don't forget to cut the three slits on the back!))

Then start by glueing together the sides of the hand...

### step 25



...then fold back the flat bottom of the hand...

### step 26



...and then the bevelled top.

### step 27



part RH2

Glue together part RH2 (but DON'T score or fold the 6 larger glueing tabs!) and then glue it to the back of part RH1 by pushing the 6 larger glueing tabs through the slits.

### step 28



parts RH1+RH2

parts LH1+LH2

The left hand (parts LH1+LH2) goes together the same way as the right hand (parts RH1+RH2).

### step 29

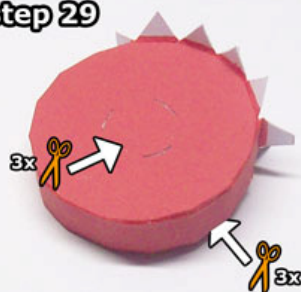

Cut out the 6 slits on part HI1 and then glue it together as shown here.

### step 30

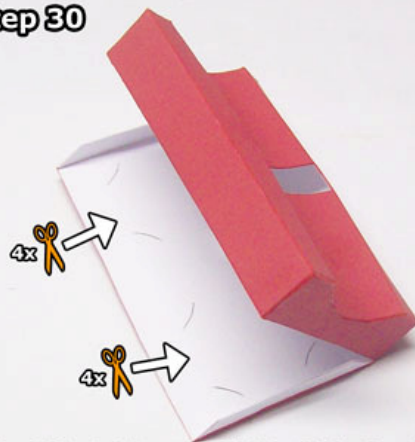

Cut out the 8 slits on part HI2 and glue together the bottom as shown here, but DON'T close the top yet!

### step 31

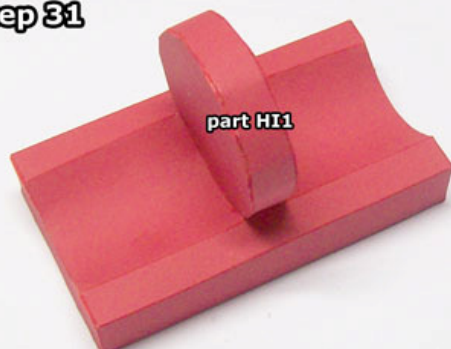

Glue part HI1 over the hole before closing part HI2!

### step 32

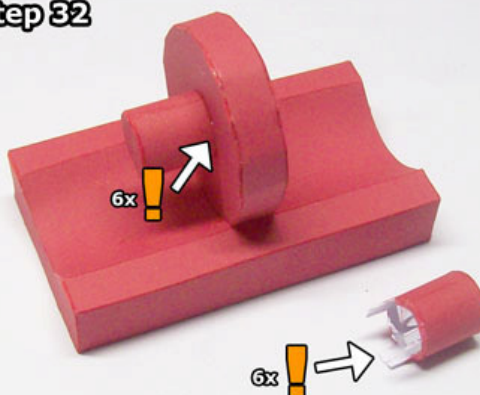

Cut out and glue together parts HI3 and HI4, but DON'T score or fold the bigger glueing tabs!

Then glue parts HI3 and HI4 to part HI1 by pushing the glueing tabs through the slits.

### step 33

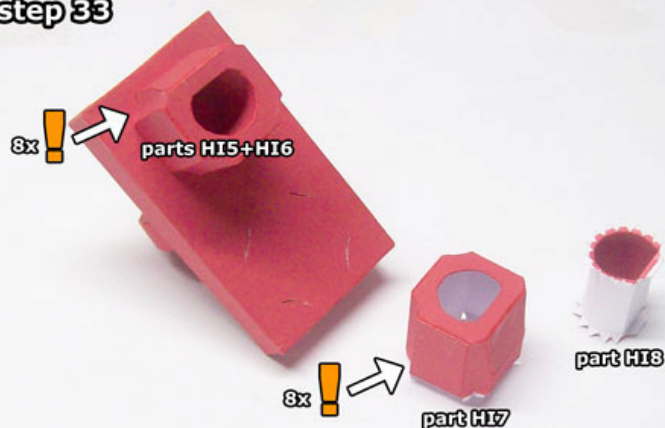

Cut out and assemble parts HI5 and HI6 (DON'T score or fold the 8 bigger glueing tabs on part HI5!), glue part HI6 underneath part HI5 and then glue them on top of part HI2 by pushing the glueing tabs through the slits.

### step 34

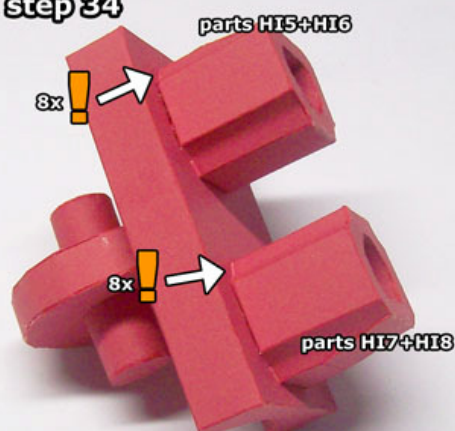

Do the same for parts HI7 and HI8.

### step 35



Cut out all the holes on part RL1, and then glue it together as shown here.

### step 36



Pre-shape all the curved parts of part RL2, and then glue it together (first edge A, then edge B).

### step 37



Carefully pre-shape and assemble part RL3...

### step 38

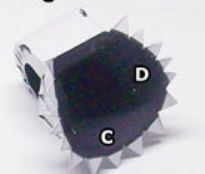

...and then glue it to the front of part RL2.



### step 39

part RL4

Glue part RL4 into a cylinder (with the coloured side in!) and glue it over the hole on the side of part RL1.

### step 40

parts RL2-RL4

Now glue parts RL2-RL4 to the inside of part RL1. Take your time to align the holes on the back and the side.

### step 41

Glue together part RL5 with the coloured side in.

### step 42

part RL6

part RL7

Glue on parts RL6 and RL7 (with the coloured side in!)

### step 43

parts RL5-RL7

Glue parts RL5-RL7 to the bottom of part RL1.

### step 44

part RL8

Close the side of the leg with part RL8.

### step 45

parts RL1-RL8

parts LL1-LL8

The left leg (parts LL1-LL8) goes together the same way as the right leg (parts RL1-RL8).

### step 46

Cut out part BP1 and glue it together the sides as shown here (with the coloured side in!)

### step 47

part BP3

part BP2

Pre-shape and glue part BP2 to the bottom front and part BP3 over the hole as shown here (with the coloured side in!)

### step 48

part BP4

Pre-shape part BP4 and score and fold the glueing tabs, so you can easily glue it around the edge of the breastplate.

### step 49

Cut out the 8 slits on part BP5, pre-shape and assemble it as shown here.

### step 50

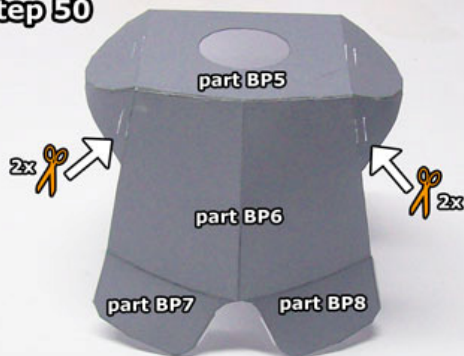

Cut out the 4 slits on part BP6, glue it to part BP5 and then glue on parts BP7 and BP8 as shown here.

### step 51

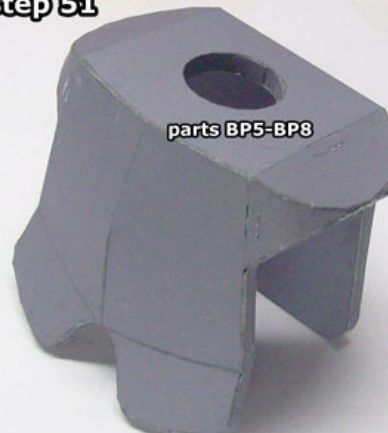

Take your time to glue parts BP5-BP8 over the inside of the breastplate as shown here.

### step 52



Carefully cut out and assemble part PL9 (DON'T score or fold the 6 larger glueing tabs!)

### step 53

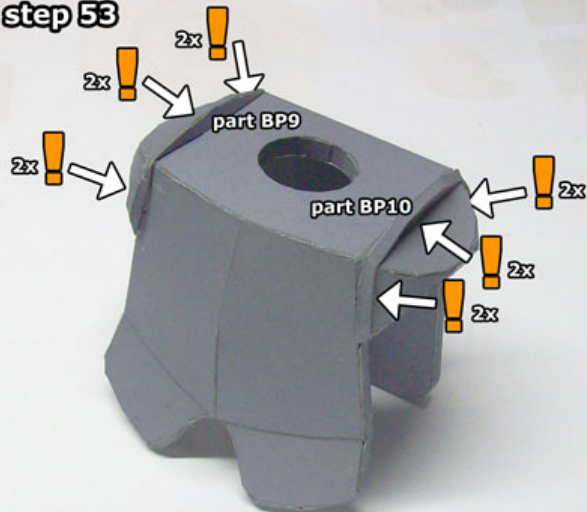

Do the same for part BP10 and then glue both parts to the shoulders of the breastplate, by pushing the glueing tabs through the slits.

### step 54



Pre-shape and assemble part HE1.

### step 55



Assemble and glue on part HE2.

### step 56



Assemble parts HE3 and HE4 (with the coloured side in!) and then glue them underneath the holes on either side of part HE2.

### step 57



Cut out and assemble part HE5 with the coloured side in (don't forget to cut out the 4 slits on top!)



### step 58

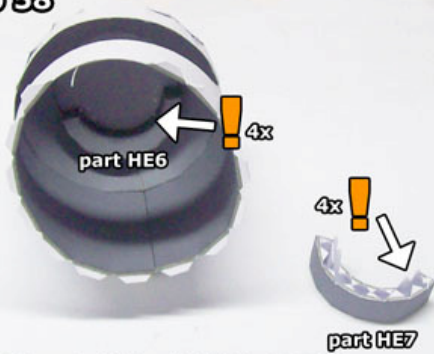

Assemble parts HE6 and HE7, but DON'T score or fold the 4 larger glueing tabs on those parts. Then glue them inside part HE5 by pushing the glueing tabs through the slits.

### step 59



Glue parts HE5-HE7 to the inside of the large hole on the front of the helmet as shown here.

### step 60

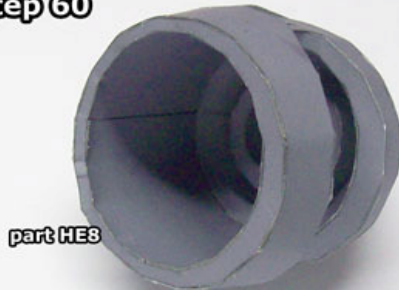

Take your time to glue part HE8 to the bottom of the helmet. Make sure you properly pre-shaped the inside and outside of the helmet to make this much easier!

### step 61

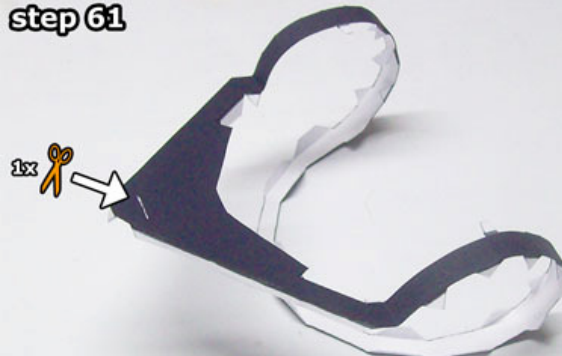

Fold and pre-shape part VI1 as shown here and cut out the small slit.

### step 62



Glue part VI2 to the backside bottom of part VI1 as shown here.

### step 63



Pre-shape and glue together the front of part VI3 and then glue on parts VI4 and VI5.

### step 64



Take your time to glue parts VI3-VI5 to the rest of the visor as shown here.

### step 65



Glue part VI6 to the backside of the helmet as shown here (don't forget to cut out the 6 slits!)

### step 66



Take your time assembling parts VI8-VI12 (with the coloured side in!) and then glue them underneath the holes of part VI7 as shown here (don't forget to cut out the 6 slits as well!)

### step 67



Do the same on parts VI13-VI17 on the other side of part VI7 and then fit to the front of the visor as shown here.

### step 68



Cut out and assemble parts VI18 and VI19 (DON'T score or fold the 6 larger glueing tabs!) and then glue them to the inside of the visor by pushing the glueing tabs through the slits.

### step 69

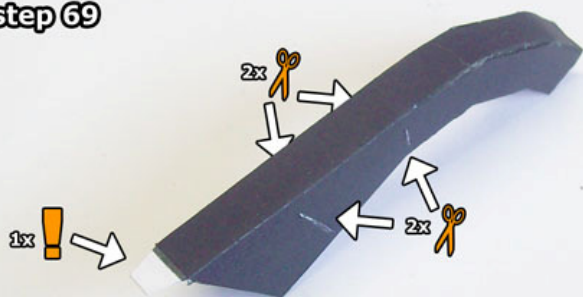

Cut out and glue together part VI20. Don't forget to cut out the 4 slits on the sides, and DON'T score or fold the larger glueing tab at the bottom.

### step 70



Assemble part VI21...

### step 71



...and then glue it to part VI20 as shown here.

### step 72



Glue part VI22 into a cylinder (with the coloured side in!) and then glue it underneath the hole on part VI21.

### step 73



Glue on part VI23 to close the bottom (DON'T score or fold the glueing tab on the end!)



### step 74

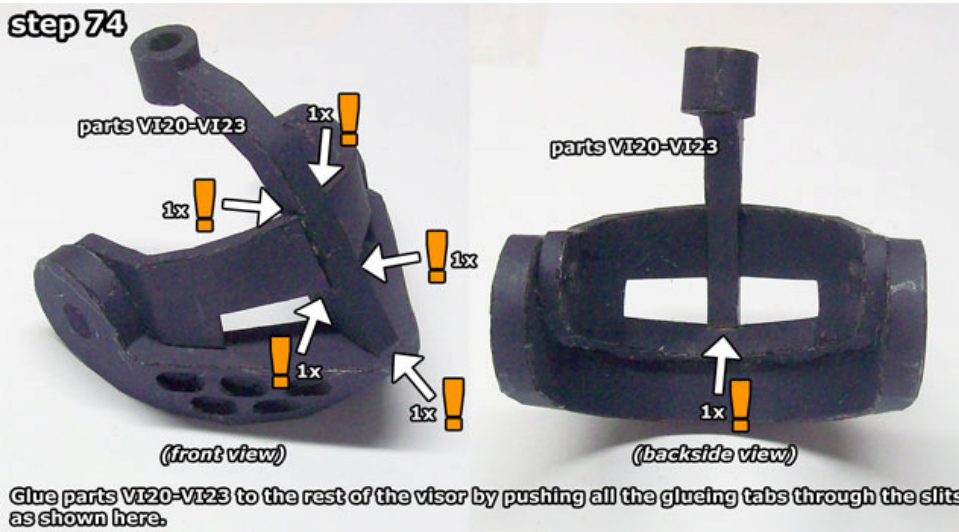

### step 75

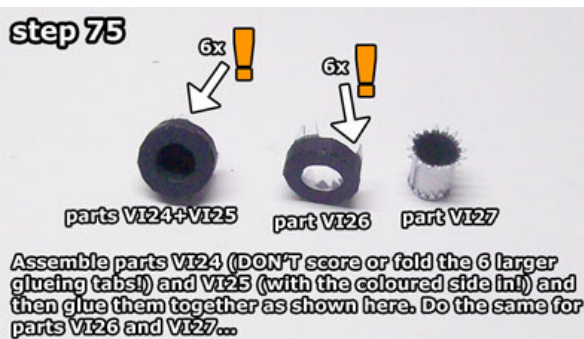

### step 76



### step 77



### step 78



### step 79

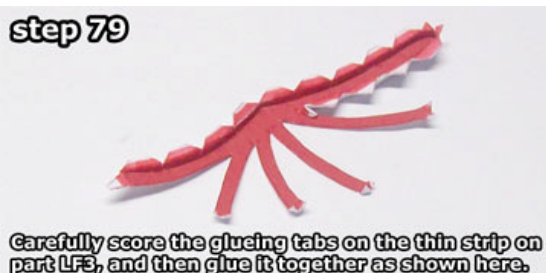

### step 80

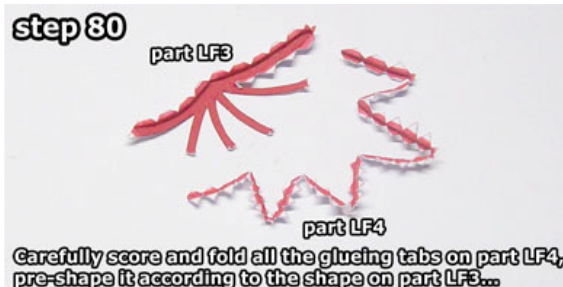

### step 81



...and then glue the two parts together as shown here.

### step 82



Glue parts LF3+LF4 underneath part LF2.

### step 83



Glue part LF5 into a hollow cylinder (with the coloured side in!)

### step 84



Glue part LF5 underneath the hole on part LF1.

### step 85



Glue together parts LF6 and LF7 like parts LF2 and LF3 earlier...

### step 86

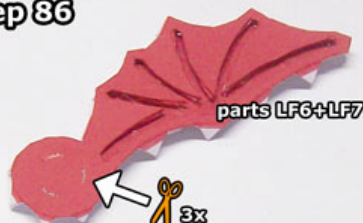

...and then glue them underneath part LF8 ((don't forget to cut out the 3 slits!))

### step 87



Now glue parts LF6-LF8 to the rest of the dragon wing feather.

### step 88

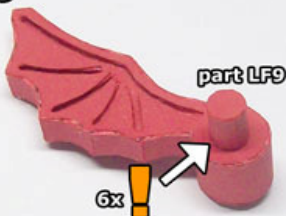

Glue together part LF9 (DON'T score or fold the 6 larger glueing tabs!) and then glue it to the rest of the dragon wing feather by pushing the glueing tabs through the slits.

### step 89

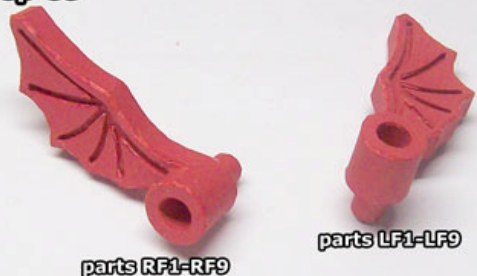

The right dragon wing plume (parts RF1-RF9) goes together the same way as the left dragon wing plume (parts LF1-LF9).

### step 90

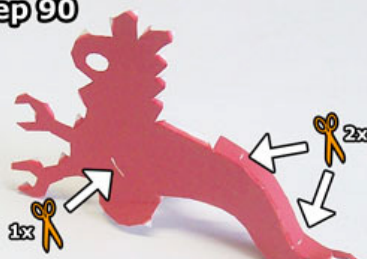

Cut out the 3 slits on part CF1 and carefully assemble the tail as shown here.

### step 91

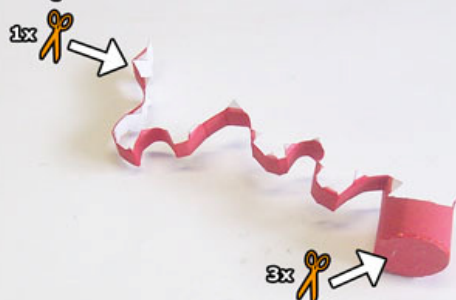

Cut out the 4 slits on part CF2, glue together the cylinder at the bottom and then fold and pre-shape the long strip as shown here.

### step 92



Properly folding and pre-shaping part CF2 makes it much easier to glue it to part CF1.

### step 93

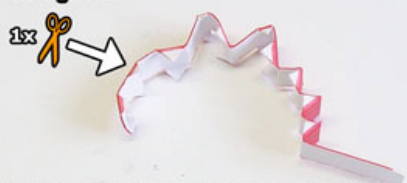

Take your time to fold and pre-shape part CF3...



## step 94



...so you can easily glue it to part CF1. Then assemble part CF4 (with the coloured side in!) and glue it underneath the small hole on part CF1 as shown here.

## step 95

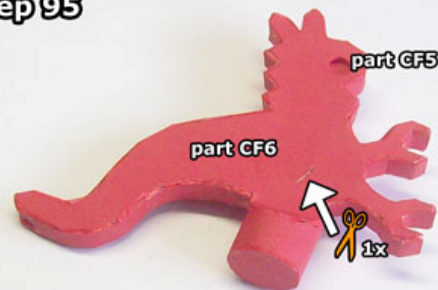

Glue together part CF5 with the coloured side in, then glue it underneath the hole on part CF6 (don't forget to cut the small slit as well!) and then glue part CF6 to the rest of the dragon feather.

## step 96



Pre-shape and glue together parts CF7-CF10 (DON'T score or fold the larger glueing tabs on these parts!)

## step 97

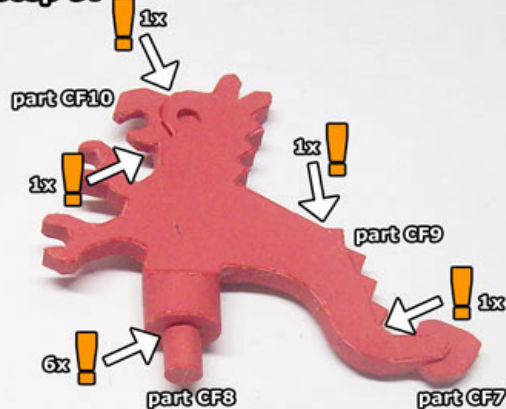

Glue parts CF7-CF10 to the rest of the dragon feather by pushing the glueing tabs through the slits (except on part CF7 of course).

## step 98

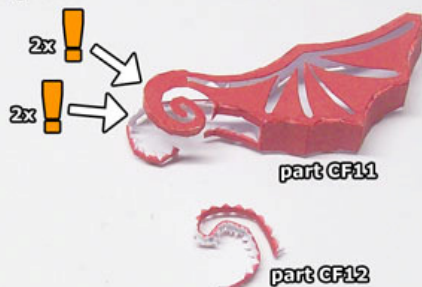

Cut out and glue together part CF11 (DON'T score or fold the 4 larger glueing tabs) and pre-shape part CF12 to fit the spiral part of part CF11.

## step 99



Glueing part CF12 to the spiral is *\*very\** fiddly, so take your time, and use a toothpick to glue it on piece by piece, following the spiral.

## step 100



Score all the glueing tabs on part CF13 and then glue it together as shown here.

## step 101



Carefully fold and pre-shape part CF14 and the glueing tabs, and then glue it to part CF13 as shown here.

## step 102



Glue parts CF13+CF14 underneath part CF13.

## step 103



part CF17  
Do the same for parts CF15-CF17.

### step 104

parts CF15-CF17

Glue parts CF15-CF17 to the rest of the dragon wing feather...

### step 105

parts CF18

...and then pre-shape and glue on part CF18 to the spiral part like part CF12 before.

### step 106

2x  
2x

Glue the dragon wing to the dragon body as shown here by pushing the larger glueing tabs through the slits.

### step 107

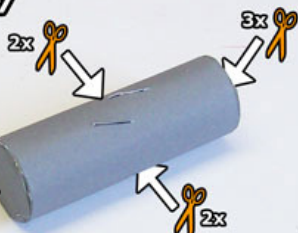

Cut out the 10 small slits on part SW1 and then glue it together as shown here.

### step 108

part SW2

6x

part SW3

6x

Assemble parts SW2 and SW3 (DON'T score or fold the larger glueing tabs!) and glue them to the ends of part SW1 by pushing the glueing tabs through the slits.

### step 109

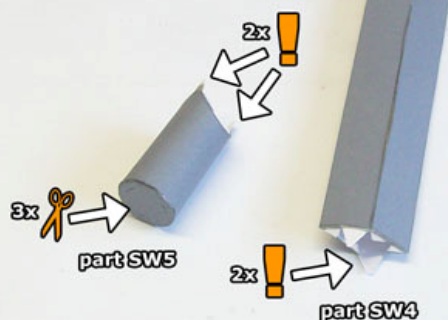

Assemble parts SW4 (DON'T score or fold the 2 bigger glueing tabs!) and SW5 (DON'T score or fold the two larger glueing top on the top and don't forget to cut the 3 slits on the bottom!)

### step 110

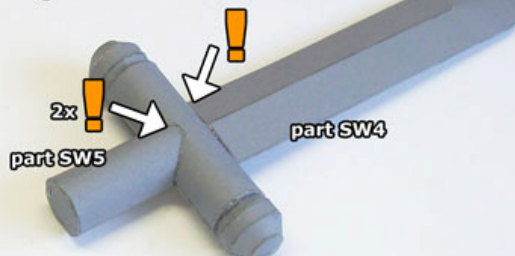

Now glue parts SW4 and SW5 to part SW1 by pushing the glueing tabs through the slits

### step 111

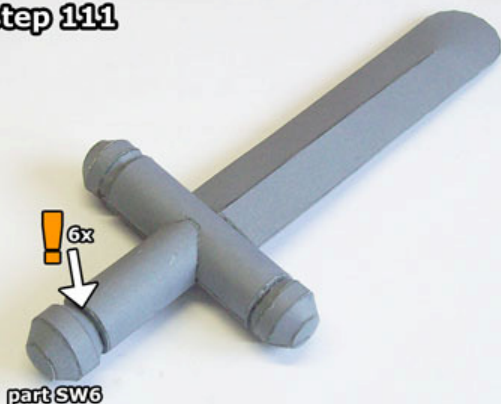

Assemble part SW6 (DON'T score or fold the 6 larger glueing tabs!) and then glue it to the bottom of part SW5 by pushing the glueing tabs through the slits.

### step 112



Cut out and glue together part SW1 as shown here.



### step 113



Cut out the 2 slits on part SH2, and then glue it to the back of part SH1.

### step 114

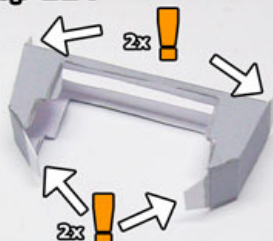

Cut out and assemble part SH3 (DON'T score or fold the 4 larger glueing tabs...

### step 115



...and glue on part SH4.

### step 116

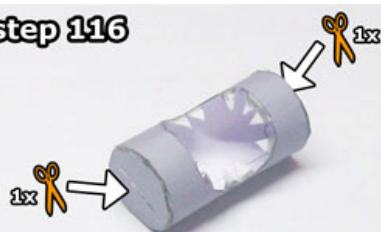

Cut out the 2 slits on part SH5 and then glue it into a cylinder as shown here.

### step 117



Glue on part SH6...

### step 118

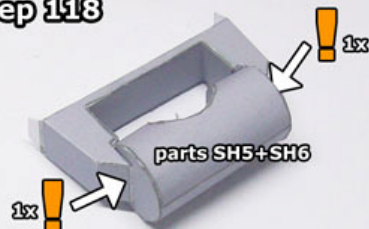

...and then glue them to part SH3 (with the hollow side in) by pushing the glueing tabs through the slits.

### step 119

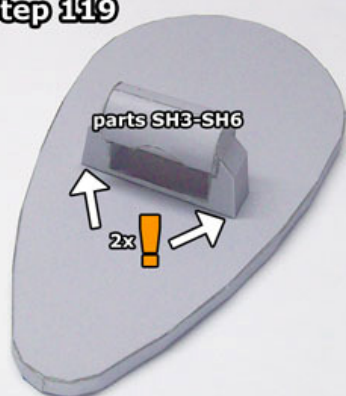

Lastly, glue parts SH3-SH6 to the back of the shield by pushing the glueing tabs through the slits.

### step 120



Now you can assemble your papercraft Black Knight! Don't use any glue, so you can move and take off the parts as you like.

Thank you for downloading and building a Ninjatoes' papercraft model!  
[www.kickme.to/ninjatoes](http://www.kickme.to/ninjatoes)