

step 1

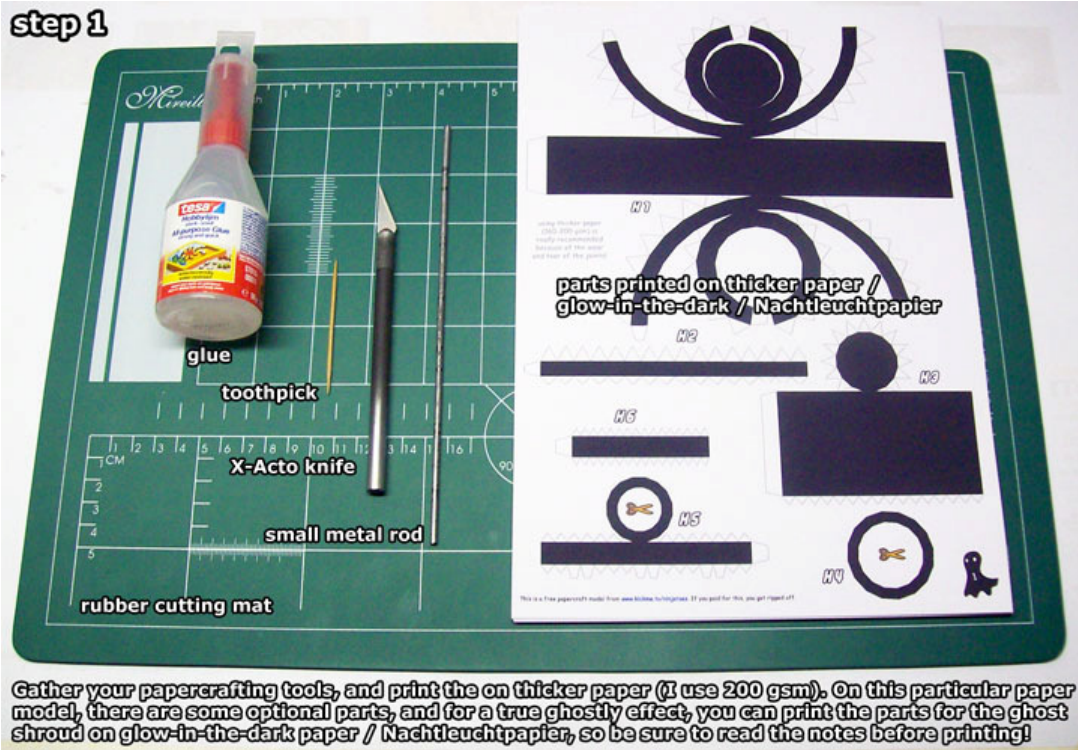

Gather your papercrafting tools, and print the on thicker paper (I use 200 gsm). On this particular paper model, there are some optional parts, and for a true ghostly effect, you can print the parts for the ghost shroud on glow-in-the-dark paper / Nachtleuchtpapier, so be sure to read the notes before printing!

step 2



step 3



step 4



step 5



step 6



step 7



Glue parts H5+H6 on top of the minifig's head, by pushing the 6 glueing tabs through the slits.

step 8

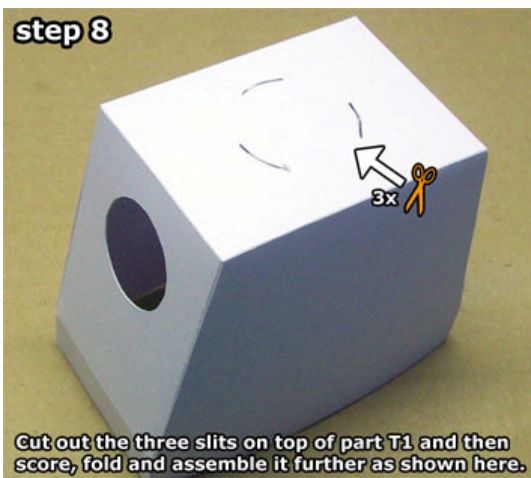

Cut out the three slits on top of part T1 and then score, fold and assemble it further as shown here.

step 9

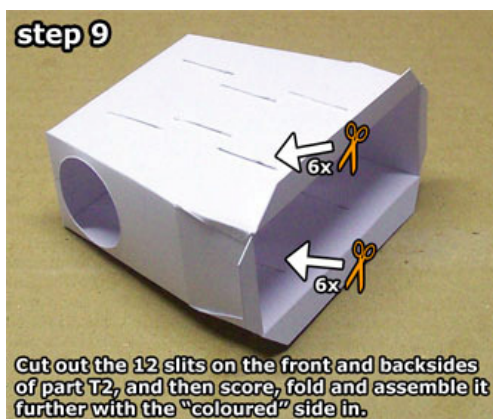

Cut out the 12 slits on the front and backsides of part T2, and then score, fold and assemble it further with the "coloured" side in.

step 10

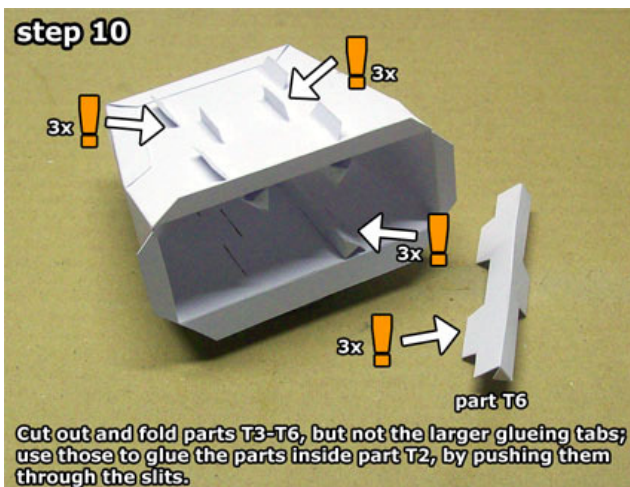

Cut out and fold parts T3-T6, but not the larger glueing tabs; use those to glue the parts inside part T2, by pushing them through the slits.

step 11

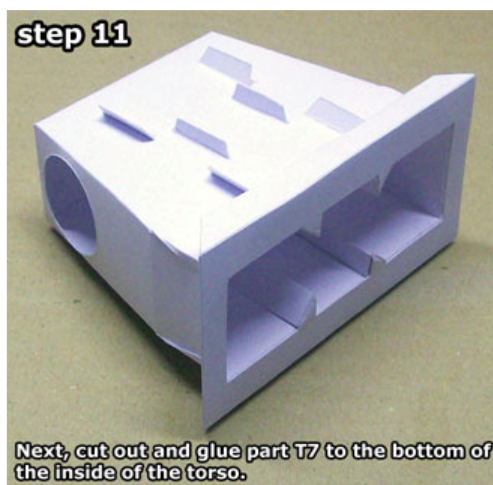

Next, cut out and glue part T7 to the bottom of the inside of the torso.

step 12

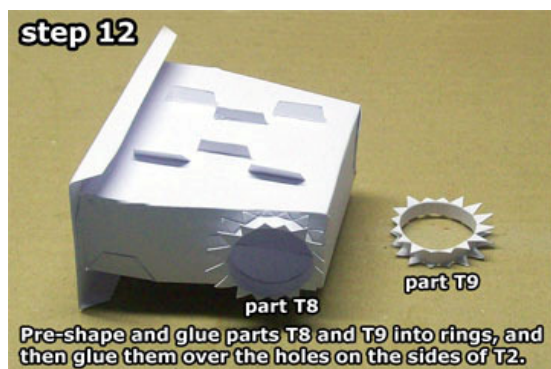

Pre-shape and glue parts T8 and T9 into rings, and then glue them over the holes on the sides of T2.

step 13

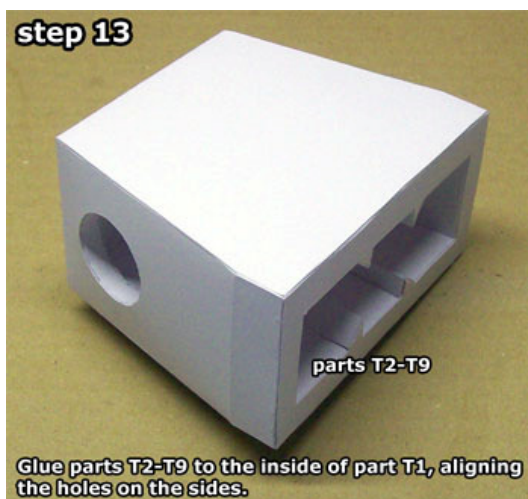

Glue parts T2-T9 to the inside of part T1, aligning the holes on the sides.

step 14

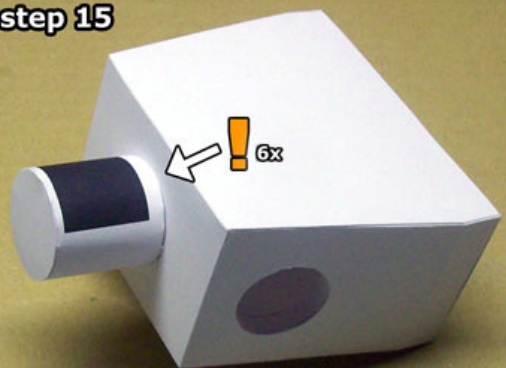

Pre-shape and assemble part T10 but don't score and fold the 6 larger glueing tabs on the bottom!

step 15

Glue part T10 on top of the torso, by pushing the 6 glueing tabs through the slits on part T1.

step 16

Pre-shape and assemble part LA1 as shown here.

step 17

Pre-shape and assemble part LA2.

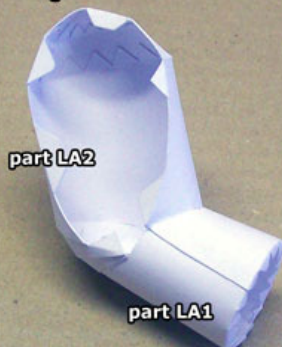
step 18

Next, glue parts LA1 and LA2 together as shown here.

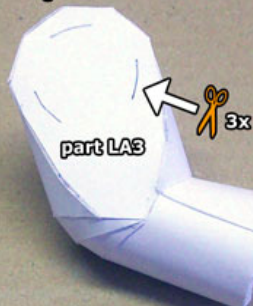
step 19

Cut out the 3 slits on part LA3, and glue it to the rest of the minifig's arm.

step 20

Pre-shape and assemble part LA4 with the "coloured" side in, and then glue part LA5 to the open end.

step 21

Glue parts LA4 and LA5 to the open end of the arm.

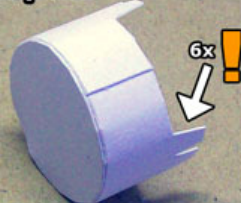
step 22

Pre-shape and glue together part LA6, but don't score and fold the 6 larger glueing tabs!

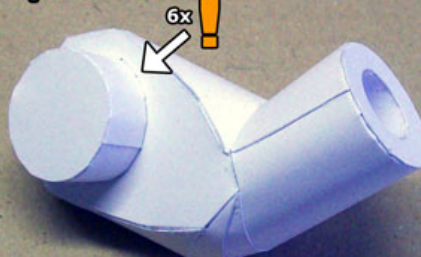
step 23

Glue part LA6 to the rest of the arm by pushing the glueing tabs through the slits on part LA3.

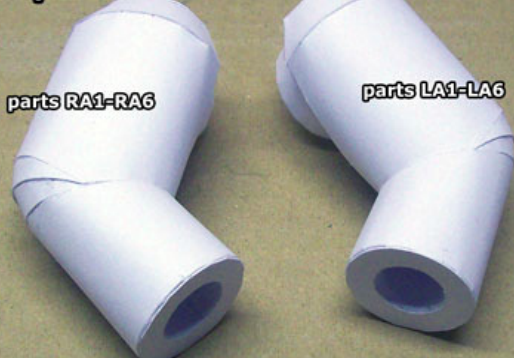
step 24

The right arm (parts RA1-RA6) is a mirror image of the left arm (LA1-LA6) and goes together the same way.

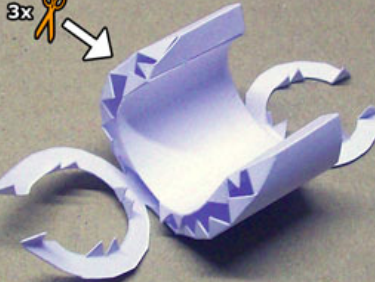
step 25

To assemble the right hand (don't forget to cut out the 3 slits on the backside!) take your time to thoroughly pre-shape the outside (convex) and inside (concave) and then start by glueing together the two ends of the sides.

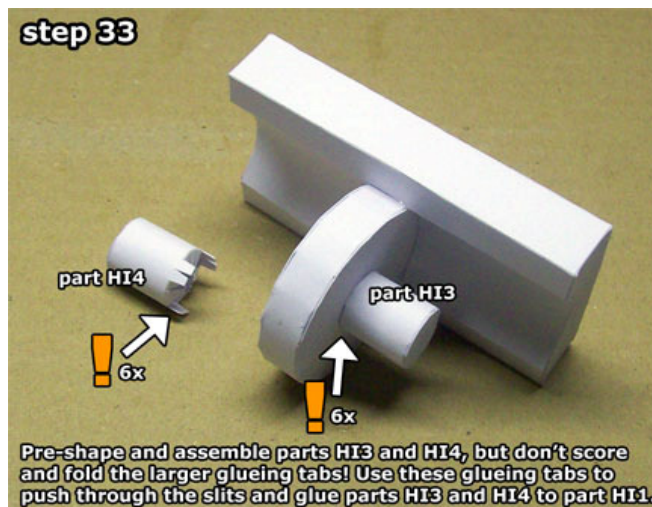
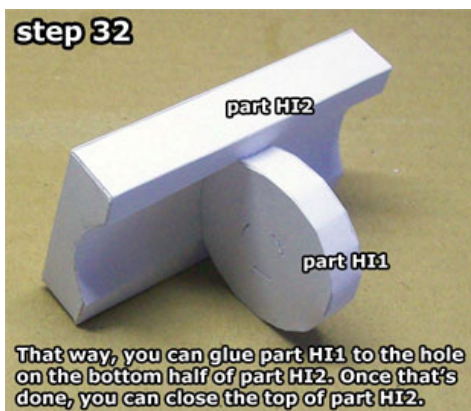
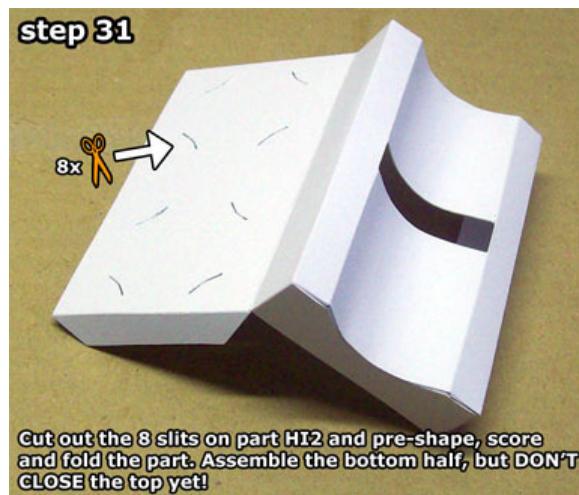
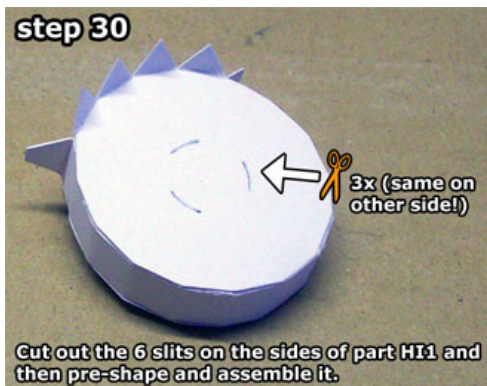
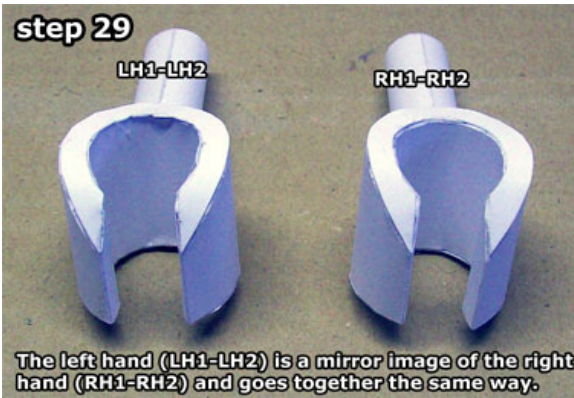
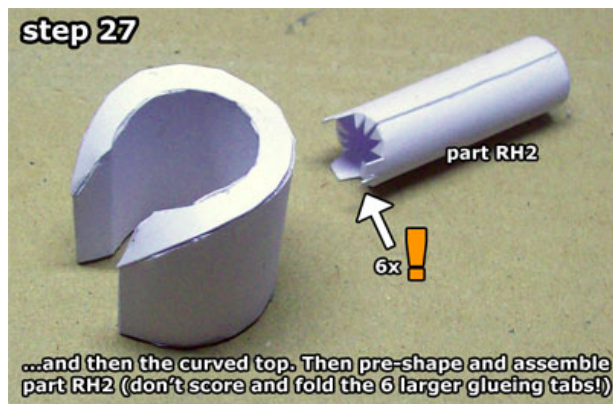

step 34

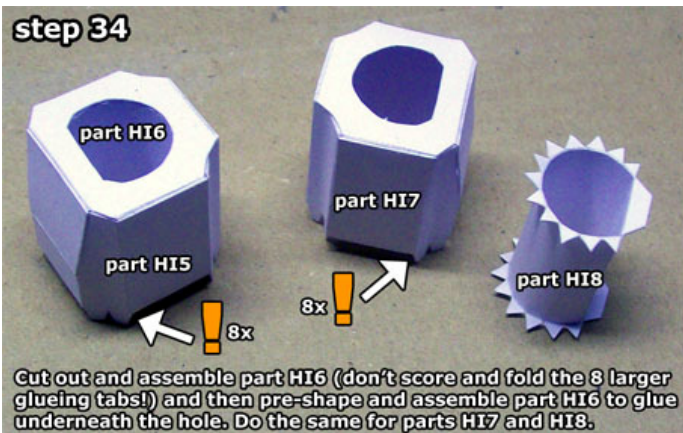

Cut out and assemble part HI6 (don't score and fold the 8 larger glueing tabs!) and then pre-shape and assemble part HI6 to glue underneath the hole. Do the same for parts HI7 and HI8.

step 35

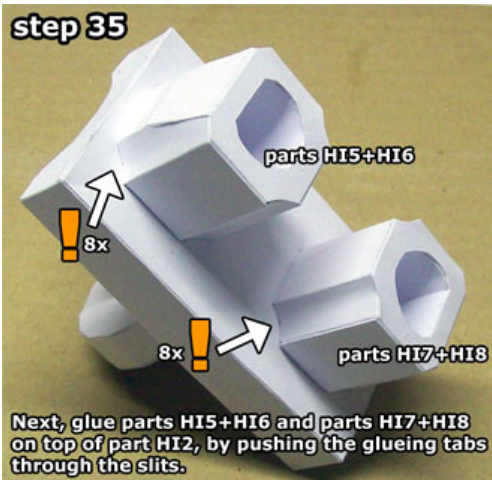

Next, glue parts HI5+HI6 and parts HI7+HI8 on top of part HI2, by pushing the glueing tabs through the slits.

step 36



step 37



step 38

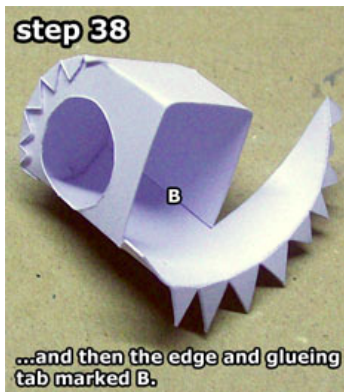

step 39

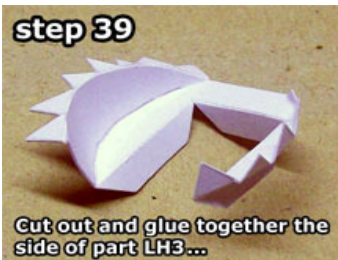

step 40

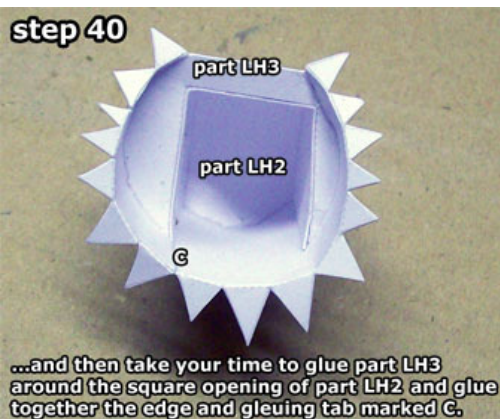

step 41



step 42



Glue parts RL2-RL4 inside part RL1, aligning it with the holes at the back and the side.

step 43

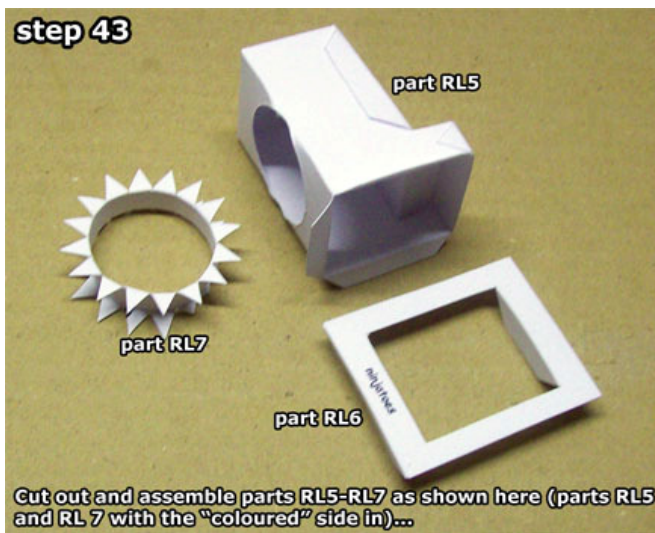

Cut out and assemble parts RL5-RL7 as shown here (parts RL5 and RL 7 with the "coloured" side in)...

step 44



...and then glue these parts together as shown here.

step 45

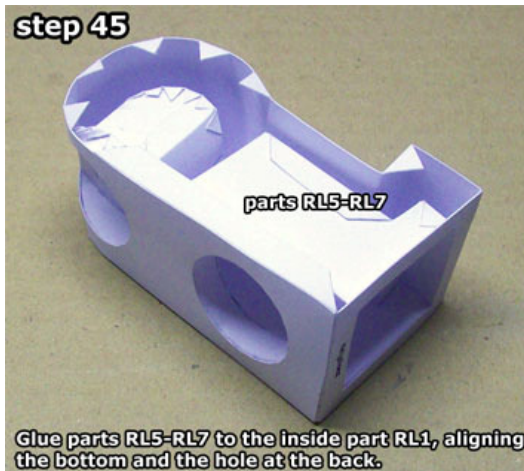

Glue parts RL5-RL7 to the inside part RL1, aligning the bottom and the hole at the back.

step 46



Use part part RL8 to close the side of the leg.

step 47

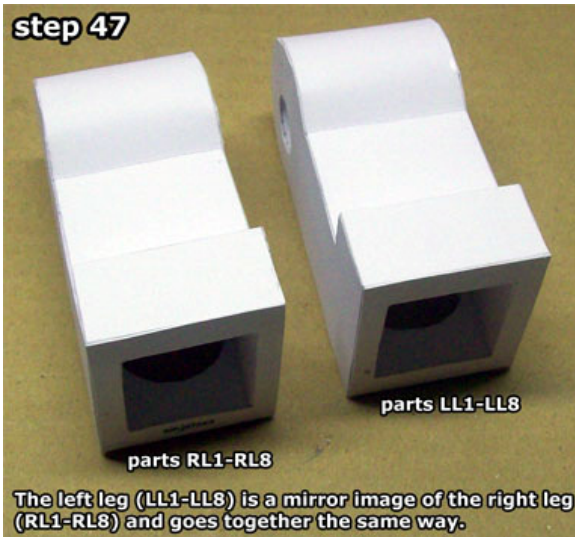

The left leg (LL1-LL8) is a mirror image of the right leg (RL1-RL8) and goes together the same way.

step 48

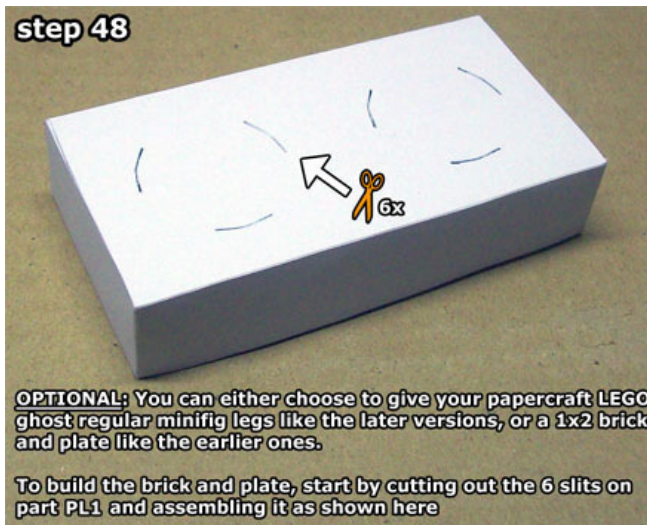

OPTIONAL: You can either choose to give your papercraft LEGO ghost regular minifig legs like the later versions, or a 1x2 brick and plate like the earlier ones.

To build the brick and plate, start by cutting out the 6 slits on part PL1 and assembling it as shown here

step 49



Cut out and assemble parts PL2 and PL3, but don't score and fold the larger glueing tabs. Push them through the slits to glue parts PL2 and PL3 on top of part PL1.

step 50



Assemble parts PL4 (with the "coloured" side in) and PL5 (don't score or fold the 6 larger glueing tabs) as shown here.

step 51

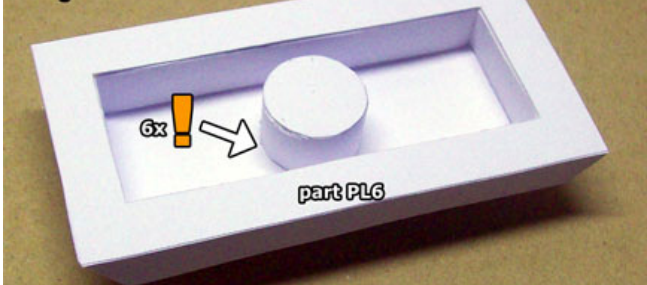

Glue part PL5 to part PL4 by pushing the glueing tabs through the slits, and glue part PL6 to the bottom of part PL5 as well.

step 52



Then glue parts PL4-PL6 to the bottom of part PL1.

step 53

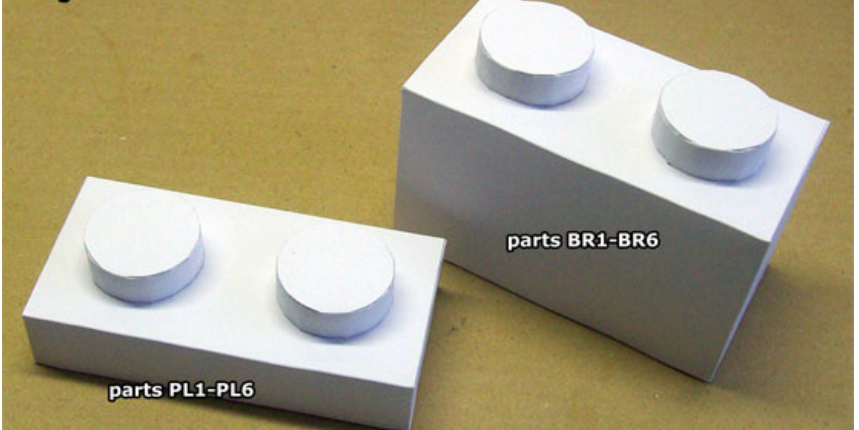

The brick (BR1-BR6) goes together the same way as the plate (PL1-PL6) except that it's 3 times taller. ;o)

step 54



NOTE: For a true ghostly effect, print the ghost shroud pieces (GS1-GS28) on glow-in-the-dark paper / Nachtleuchtpapier.

Then, start by cutting out the 3 slits on part GS1, and then glue it together with the "coloured" side in as shown here.

step 55

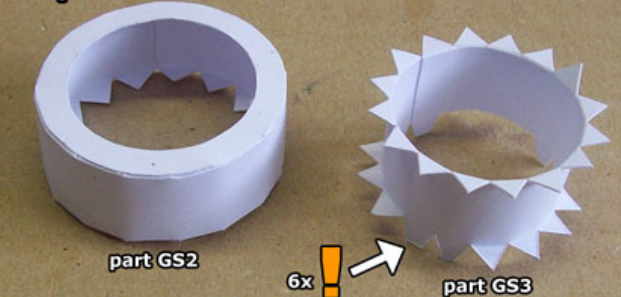

Cut out and assemble parts GS2 and GS3 (part GS3 with the "coloured" side in, and don't score and fold the 6 larger glueing tabs!

step 56

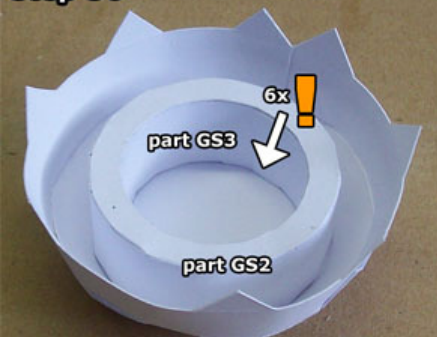

Glue part GS3 to GS2, and then glue both parts to part GS1 by pushing the glueing tabs through the slits.

step 57



Cut out the holes and pre-shape part GS4, and then glue it to the bottom of part GS1 as shown here (the "coloured" side goes on the inside of the ghost shroud).

step 58



Glue parts GS5 and GS6 to the sides of part GS4 as shown here.

step 59

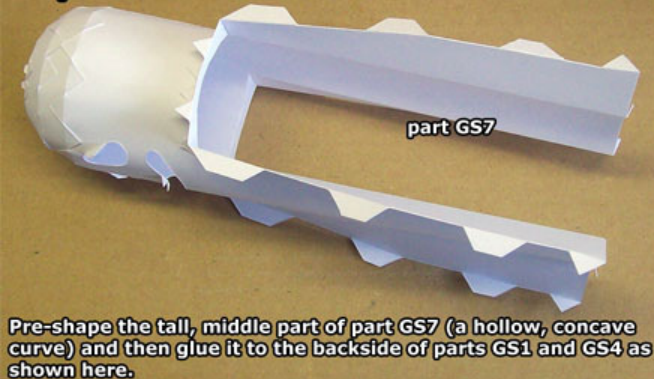

Pre-shape the tall, middle part of part GS7 (a hollow, concave curve) and then glue it to the backside of parts GS1 and GS4 as shown here.

step 60



Take your time to thoroughly pre-shape parts GS8-GS10 to fit the holes on part GS4.

step 61



Glue the pre-shaped parts GS8-GS10 over the holes on part GS4.

step 62



Pre-shape and assemble part GS11, this time with the "coloured" side out.

step 63

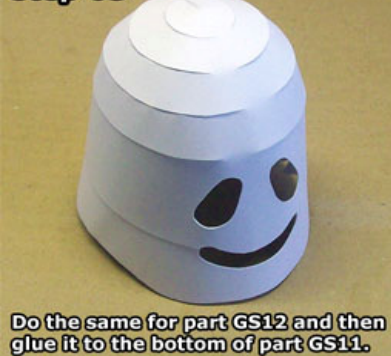

Do the same for part GS12 and then glue it to the bottom of part GS11.

step 64

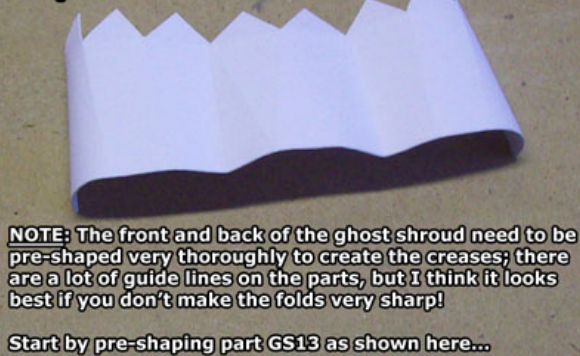

NOTE: The front and back of the ghost shroud need to be pre-shaped very thoroughly to create the creases; there are a lot of guide lines on the parts, but I think it looks best if you don't make the folds very sharp!

Start by pre-shaping part GS13 as shown here...

step 65

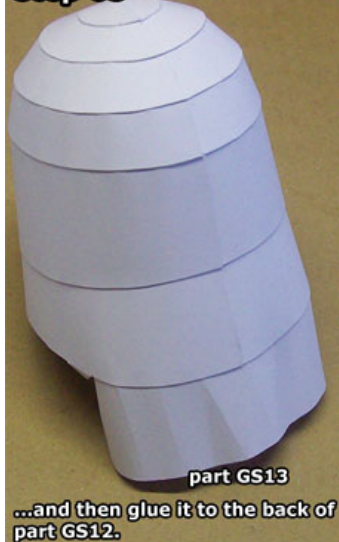

...and then glue it to the back of part GS12.

step 66

part GS14
part GS15
part GS16
part GS17

Pre-shape and glue on parts GS14-GS17 one by one as shown here.

step 67

Pre-shape part GS18...

step 68

part GS18

...and then glue it to the rest of the ghost shroud.

step 69

part GS19

Pre-shape and glue on part GS19. Take note of part GS27, because the top of that part is the shape the bottom of part GS19 should have.

step 70

Now cut out and pre-shape part 20.

step 71

part GS20

Glue the pre-shaped part GS20 to the bottom of part GS12.

step 72

part GS21

part GS22

part GS23

part GS24

Continue pre-shaping and glueing on parts GS21-GS24 one by one as shown here.

step 73

Thoroughly pre-shape part GS25...

step 74

part GS25

...and then glue it to the rest of the ghost shroud.

step 75

part GS26

Now pre-shape and glue on part GS26. Take note of part GS28, because the top of that part is the shape the bottom of part GS26 will need to be.

step 76

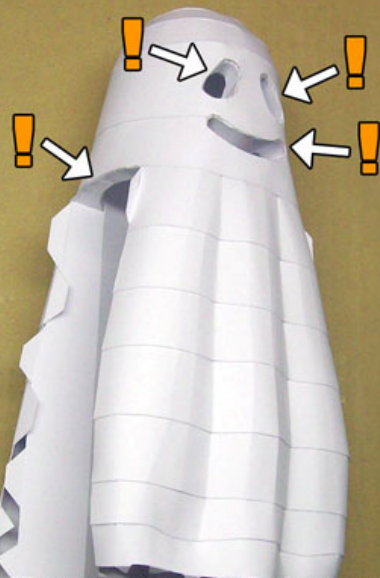

Now for the most fiddliest part, so be sure to take your time! Glue the inside of the ghost shroud (GS1-GS10) inside the outside of the ghost shroud (GS11-GS26).

I found it easiest to concentrate on aligning the holes for the eyes and the mouth and the shoulders first...

step 77

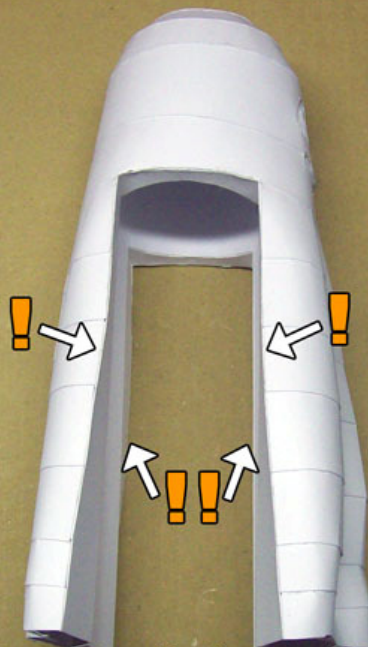

...and once those parts are aligned properly, then to do the sides separately.

You won't be able to reach inside with just your fingers anymore, so use a tool like a small, metal rod or the back end of a spoon to assist you. And again: be sure to take your time!

step 78

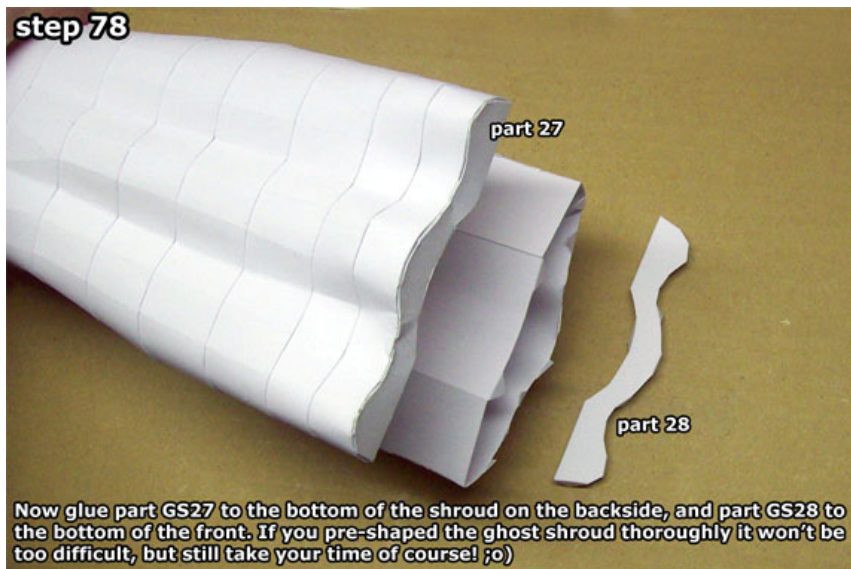

Now glue part GS27 to the bottom of the shroud on the backside, and part GS28 to the bottom of the front. If you pre-shaped the ghost shroud thoroughly it won't be too difficult, but still take your time of course! ;o)

step 79

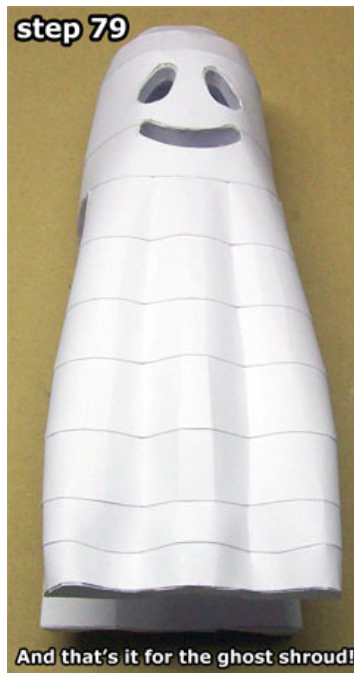

And that's it for the ghost shroud!

step 80



Now you have the choice to assemble the later version of the LEGO ghost (with regular minifig legs) or the first version, with a 1x2 brick and plate for "legs" to make it appear as if he is floating.

In the instructions, I used regular cardstock for the ghost shroud, but your papercraft ghost will look even spookier if you print those pieces on glow-in-the-dark paper! ;o)

Thank you for choosing a Ninjatoes' papercraft model, I hope you had fun building!
www.kickme.to/ninjatoes