

HOMER SIMPSON **ASSEMBLY MANUAL**

step 1

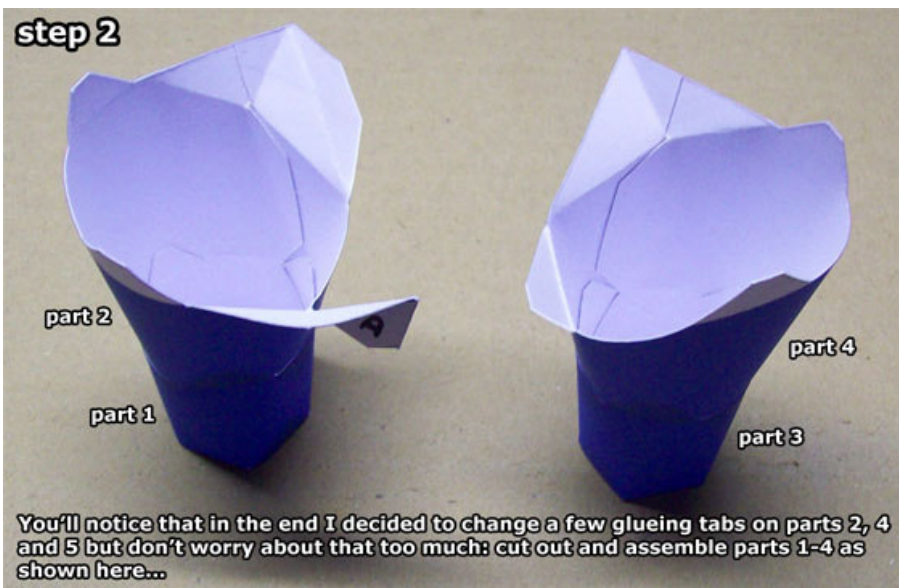

step 2



step 3

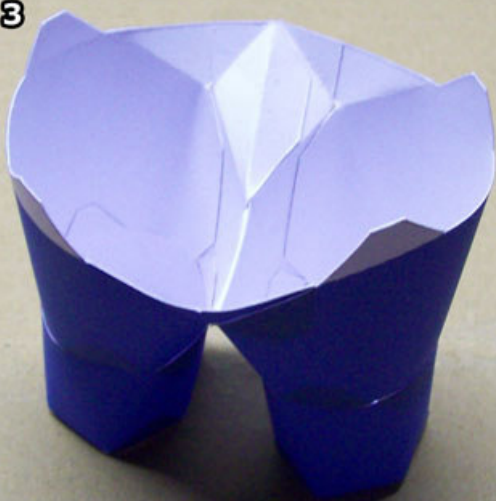

...and then glue the two legs together, by glueing the tabs marked A, B and C to their respective edges.

step 4

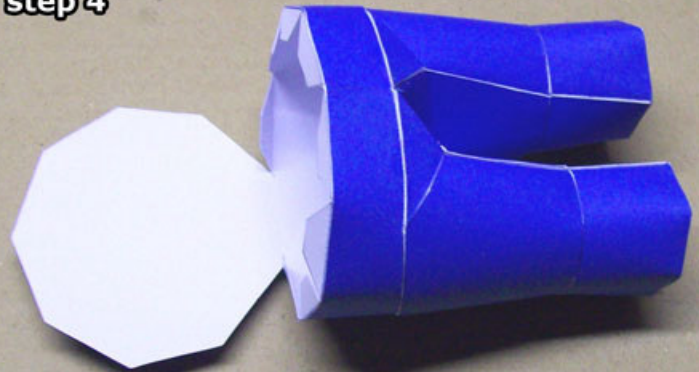

When glueing on part 5, leave the top for last, so you can reach inside when you glue the part to the rest of the pants.

step 5



Assemble the shoes (parts 6 and 7) by glueing together the sides first, and then the top.

step 6



Then simply glue them to the bottom of the pants like so.

step 7



To build the torso, first start with part 8...

step 8

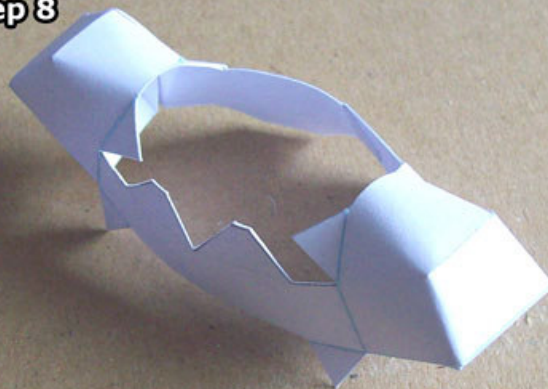

...and then part 9. Take your time folding and shaping the shoulders.

step 9



Now you can glue these parts together as shown here...

step 10

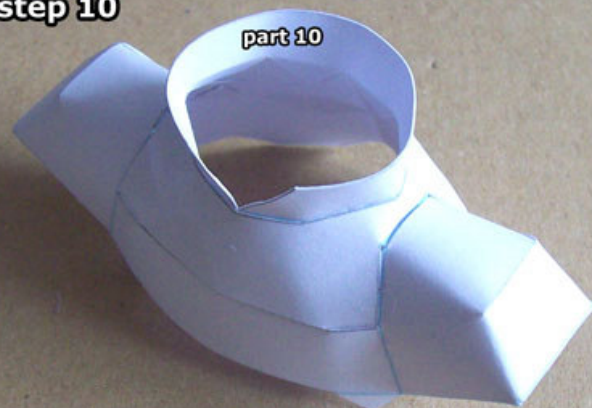

Before glueing part 10 around the edge of the neck. The open side should be at the front.

step 11

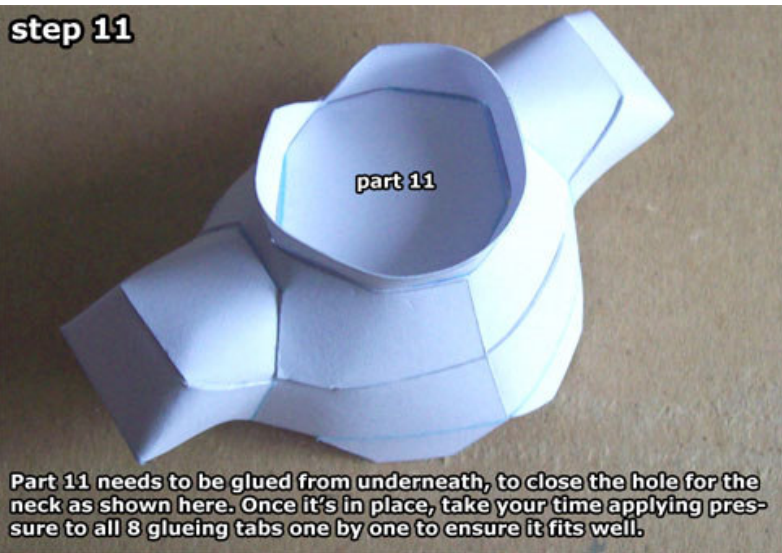

step 12

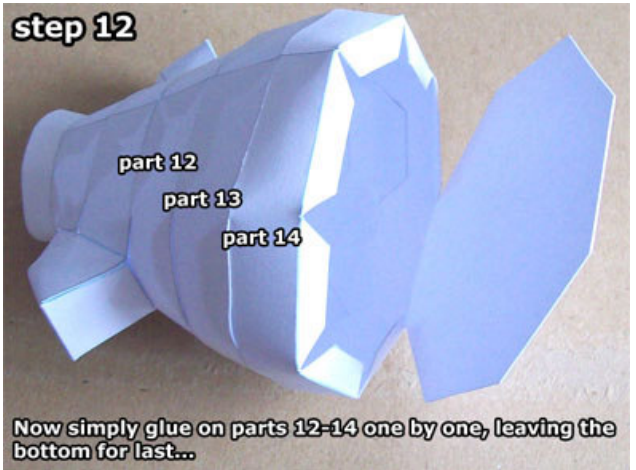

step 13



step 14

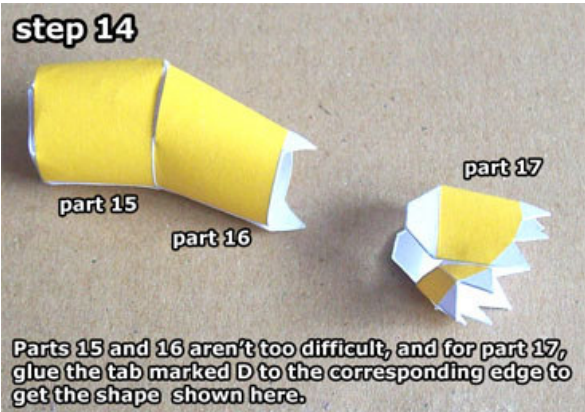

step 15

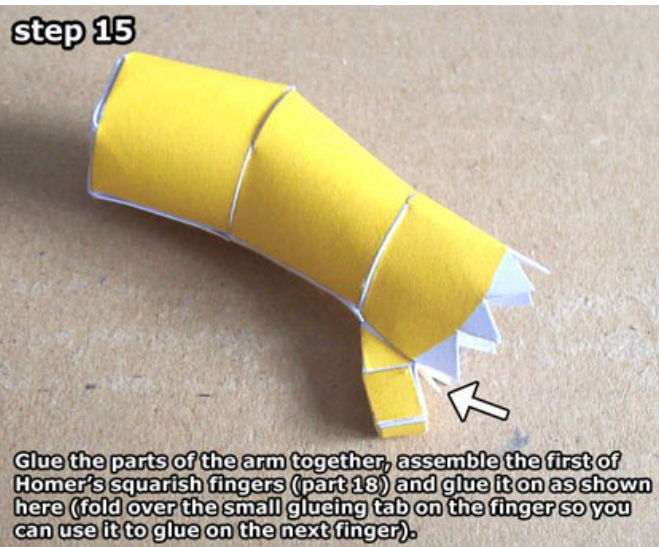

step 16



step 17



step 18



step 19

parts 22-28

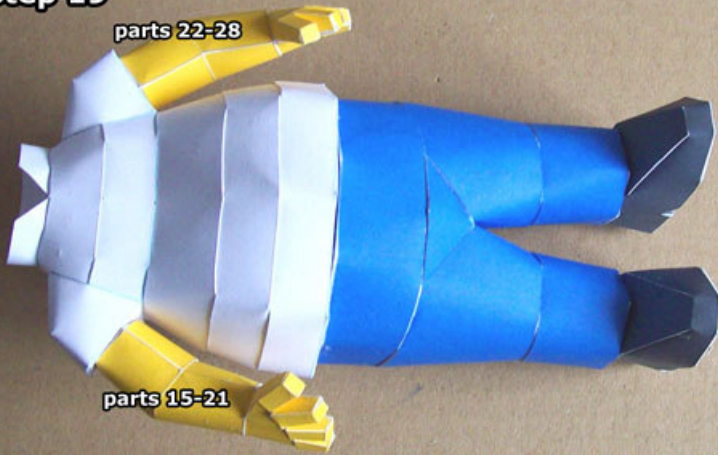

parts 15-21

Do the same for parts 22-28, and then glue the arms to the shoulders as shown here.

step 20

part 29

part 30

part 31

Glue together parts 29-31; fold the glueing tabs for the nose and ears out as shown.

step 21



Glue on part 32 around the back like so...

step 22



...and then assemble the ears (parts 33 and 34).

step 23

part 34

part 33

Glue the ears to the sides of the head.

step 24



part 35

part 36

Assemble parts 35 and 36 as shown here...

step 25

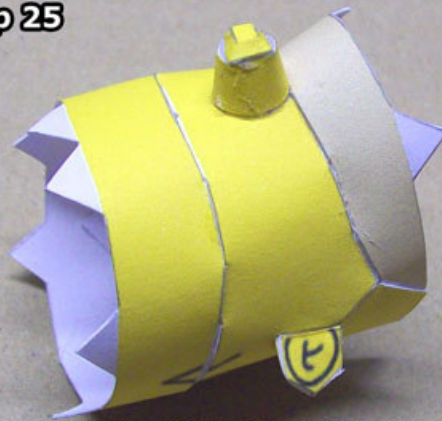

...and then glue them to the face to form the nose.

step 26

part 38

part 37

Glue on parts 37 and 38 now...

step 27

part 39

Glue on part 39 to part 37 like so.

step 28

part 40

part 41

Glue on parts 40 and 41, leaving the bottom for last.

step 29

part 42
part 43
part 44

Before closing the head with parts 42-44 you could put in a brain, but I kinda forgot...

step 30

part 45

part 46

Assemble the eyes (parts 45 and 46) and then glue them to the face.

step 31

If you want to, you can take a black marker and colour the underside of parts 47 and 48 black, before you curve them and glue them to Homer's head.

step 32

That's it, I hope you had fun building!

www.kickme.to/ninjatoes
ninjatoes.blogspot.com