

Zora armor Link assembly manual

step 1

glue

toothpick

sharp blade

cutting mat

printed parts

Zora armor Link

Every Zora gains his water-breathal dagger, requiring Link to find a way to be able to stay underwater for a longer period of time before he can stop to breathe. Over the years, the aquatic Zora have created a number of ways to help Link do just that.

In earlier games, simple Zora Fingers would allow Link to breathe underwater. In *Ocarina of Time* the Zora Tunic Link wears to magical clothing again to be able to breathe underwater.

Link acquires the Zora armor from Queen Ruto's spirit as a gift after rescuing her sick son in Kakariko Village. Using a Water Breath and the Zora armor, Link can gain access to Lakewood Temple at the bottom of Lake Hylia to continue his quest to save the kingdom of Hyrule.

game site: <http://www.zelda.com/games/ocarina/gameset/guide/guide.html>

After printing the parts (preferably on some thicker paper), gather your papercrafting tools: two things you can't do without is something to cut out the parts (either a pair of scissors or a sharp blade) and glue. A toothpick will be very useful to build the fingers on this particular model, and a cutting mat is useful when building any model.

step 2

The easiest way to assemble part 1, is to cut out the parts, and then pre-shape the sides of the flippers to mirror the shape of the sole...

step 3

...before glueing the glueing tabs to the sole like so.

step 4

Valley-fold the back of part 2, and then glue the two sides at the front together (leaving a small triangular shaped gap at the front). Doing so should automatically create the desired shape at the pointy part in the middle.

step 5

Now glue part 2 on top of part 1. It's a pretty simple step, make sure you align and glue everything properly.

step 6



After cutting out and assembling part 3, pre-shape the open top into a "roundish" shape.

step 7



After assembling and gluing on part 4, you will automatically get the right shape anyway.

step 8



It's probably easiest to completely assemble part 5 before gluing it to parts 3 and 4 as shown here.

step 9



Now you need to glue parts 3-5 to the back end of parts 1 and 2. It will look better if the surfaces are glued flat together, so take your time doing this as good as you can.

step 10



Cut out and assemble parts 6-10 the same way.

step 11



Cut out and assemble part 11 as shown here (first make the bottom, then the remaining part as shown here).

step 12



Now glue on part 12 (which is basically just a simple cylinder).

step 13

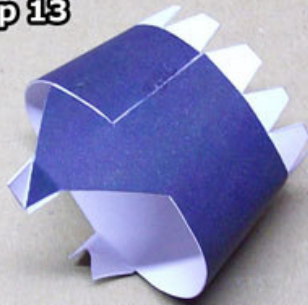

Assemble part 13 by glueing the two ends together.

step 14



Now glue on parts 11 and 12 that you glued together earlier.

step 15



Assemble and glue on parts 14 and 15 the same way. Take care joining the two legs in the center.

step 16



Now you need to glue the two flippers you made earlier to the legs*. Make sure the model can stand without falling over.

(*spoiler: the one with the logo is the right one)

step 17



Parts 16 and 17 are basically just simple cylinders that need to be glued together as shown in this picture.

step 18



To glue the "man-skirt" to the legs, you need to glue the glueing tabs of part 17 on top of the glueing parts of part 13 as shown in this picture.

step 19



Glue parts 18 and 19 to either side of the man skirt (with the glueing tabs on top of the glueing tabs of part 17 this time). Pre-shape them so they match the curve of the "man-skirt". At the front and back, there should be four glueing tabs left between the two parts...

step 20



...to glue on parts 20 and 21 the same way.

step 21



Parts 22 and 23 should be glued together as two simple rings again.

step 22

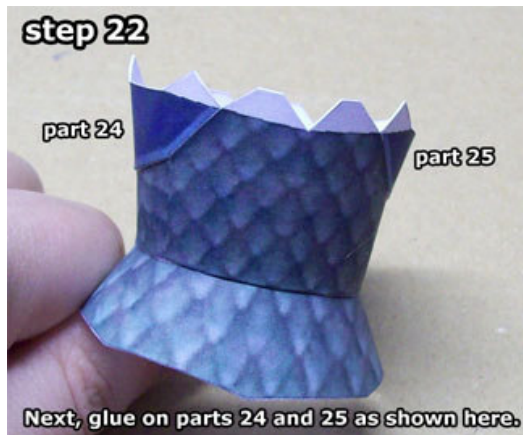

Next, glue on parts 24 and 25 as shown here.

step 23

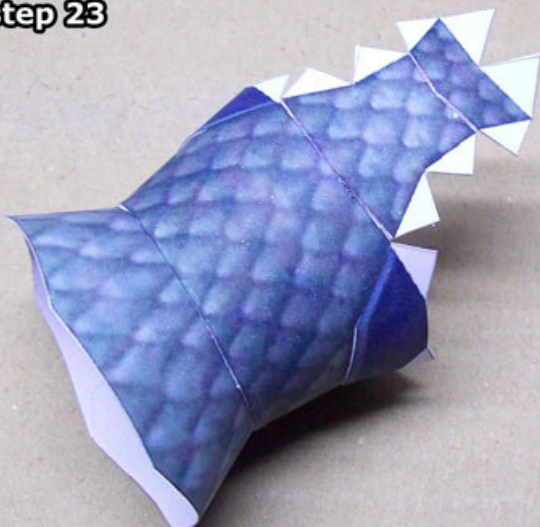

Glue parts 26 and 27 to the front like so...

step 24



...and parts 28 and 29 to the back the same way.

step 25

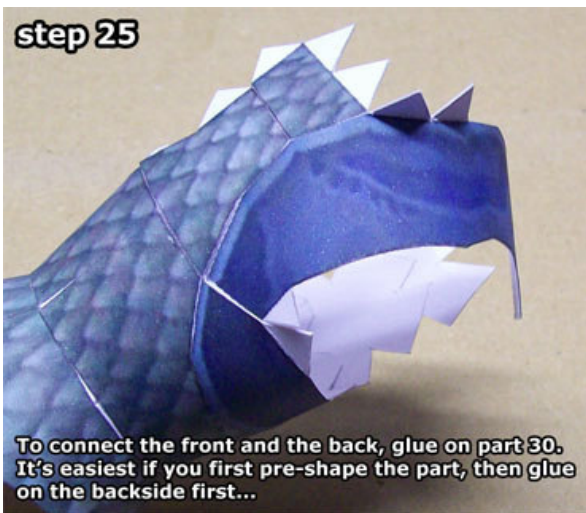

step 26



step 27



step 28



step 29



step 30



step 31

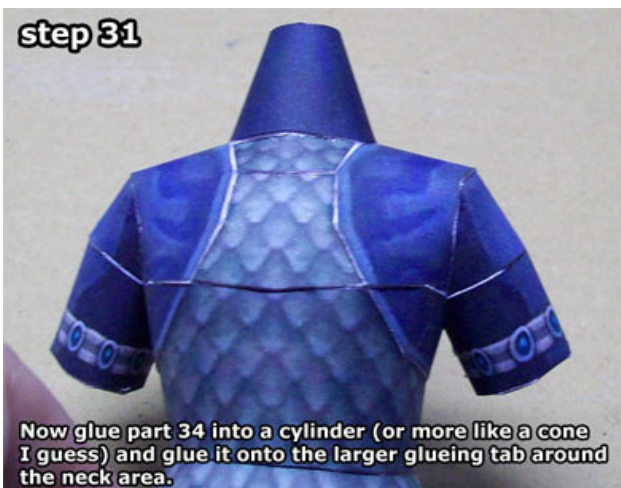

step 32



step 33



To glue the torso to the leg section, apply a fair amount of glue on top of the glueing tabs of parts 18-21 of the man-skirt. Then gently push the torso over the man skirt, until the part where Link's waist is at its thinnest.

step 34



Pre-shape and glue together parts 39 and 40 as shown here.

step 35



It's easiest to glue together part 41 seperately first...

step 36



...before glueing it to the rest of the face.

step 37



Put the head aside for now and then pre-shape and glue together parts 42 and 43 as shown here.

step 38

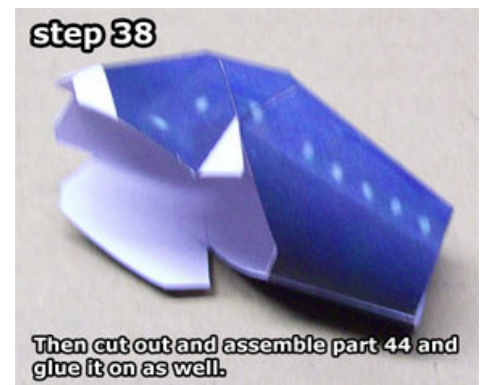

Then cut out and assemble part 44 and glue it on as well.

step 39



Glue on parts 45 and 46 as well.

step 40



Take the time to glue the cap to Link's head as shown here.

step 41



To glue the head to the torso, simply fold the glueing tabs inside, apply some glue, and slide the head over the neck until it can't go any further.

step 42



Next, the helmet. First cut out and assemble part 47 until you end up with something like this.

step 44



...and then parts 49 and 50 to the sides. Pre-shape them until the helmet looks nice, and then glue the helmet over the hole on top of Link's head. It needn't be a perfect fit, as long as the hole is covered up and it looks good! ;o)

step 43



Then pre-shape part 48 and glue it to the back...

step 45



From the backside, you can see how the helmet just fits over the head until it looks good. ;o)

step 46



Parts 51 and 52 aren't very hard to make I think, you need to glue them together and underneath Link's right arm. If you align the seams where the edges of the parts meet, it should be in the correct position.

step 47



Now for the hardest parts, the hands! Cut out part 53, and bring the two ends together (the glueing tab has a valley fold, to make the base of the thumb.

step 48



Making the thumb (part 54) and fingers may seem intimidating at first, but it's not very difficult if you pre-shape them around a toothpick (see the video tutorial at <http://www.youtube.com/watch?v=3ph7ayEs1RA>)

step 49



Glue part 54 to the hand like so...

step 50



...and then cut out and assemble part 55 much the same way as you did part 53, and glue it to part 53.

step 51



Personally, I find it easier to first glue together the two parts of each finger (in this case parts 56 and 57)...

step 52



...before glueing them to the hand. Each finger connects to three glueing tabs on the hand: one at the top, one at the bottom and one at the side, from the finger next to it.

step 53



Keep adding fingers (parts 58 and 59) the same way...

step 54



...(parts 60 and 61)...

step 55



...until the last one (parts 62 and 63; this one connects to four glueing tabs, on all sides, of course).

step 56



Now you can simply glue it to the bottom of the arm (if you align the seam that runs along the entire inside of the arm, the hand should be in the correct position).

step 57



Now the other hand (which is basically a mirror version, of course ;o) Start with parts 64 and 65.

step 58



valley fold

Next, glue together part 66 like you did part 53; don't forget to valley fold the glueing tab to create the base of the thumb!

step 59



Assemble part 67...

step 60



...and then glue it to the abse of the thumb. By now I'm sure you get the picture (a little pun intended... ;o) that the left hand is basically the same as the right hand, only the fingers are a bit more bent to hold the sword.

step 61



Glue them on one by one again and then glue the hand to the bottom of the arm. From this angle, you can see the seam running along the inside of the arm, align the seam on the hand with it.

step 62



After all that, you'll love the simplicity of part 70: just fold it double and before the glue really dries, bend it around a pencil or something similar to give it a nice curve.

step 63



Simply glue it on top of Link's gauntlet.

step 64



Part 71 isn't too difficult either; pre-shape the part and then drape it around ZaL's body, one joint goes on top of the shoulder, the other one underneath the arm.

step 65



Because you probably can't reach underneath the cap with your glue, glue the two ends of part 72 together while the necklace is rotated to the side...

step 66



...and then rotate it back. If you can't keep it to stay flat on top of ZaL's chest, use a small dab of glue. You will also need a small dab of glue to glue on part 73.

step 67



After glueing together part 74, fold the glueing tabs around the two holes inwards.

step 68



Now cut out and assemble parts 75 en 76 as shown here.

step 69



Glue them together and assemble part 77 as well.

step 70



Push these parts through the holes on part 74 (if the paper is too thick, make the holes a little bigger of course) until about halfway.

step 71



For part 78, I found it easiest to first glue the small tabs on each half so that the two halves automatically get a bit of a curve.

step 72



Apply some glue and press the two halves together. After the glue has dried, squeeze the two sides and the bottom will open up.

step 73



Glue it to the end of part 77.

step 74



Glue the sword into ZaL's hand like so.

step 75

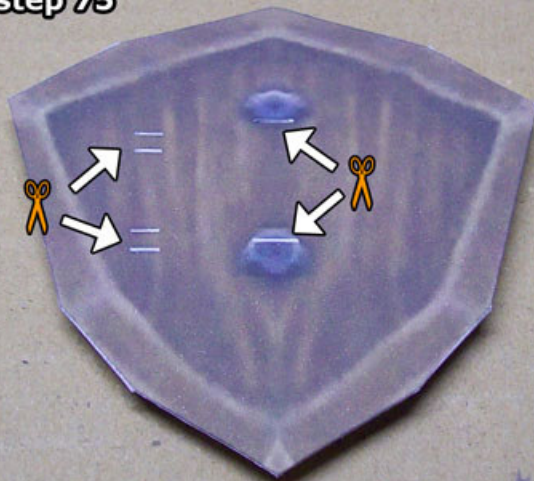

Don't forget to cut out the six slits on part 79.

step 76



Glue together parts 80 and 81 back-to-back, *except* the glueing tabs on the ends!

step 77



First, only push one end through the slits on part 79, and fold back the glueing tabs to glue them in place.

step 78

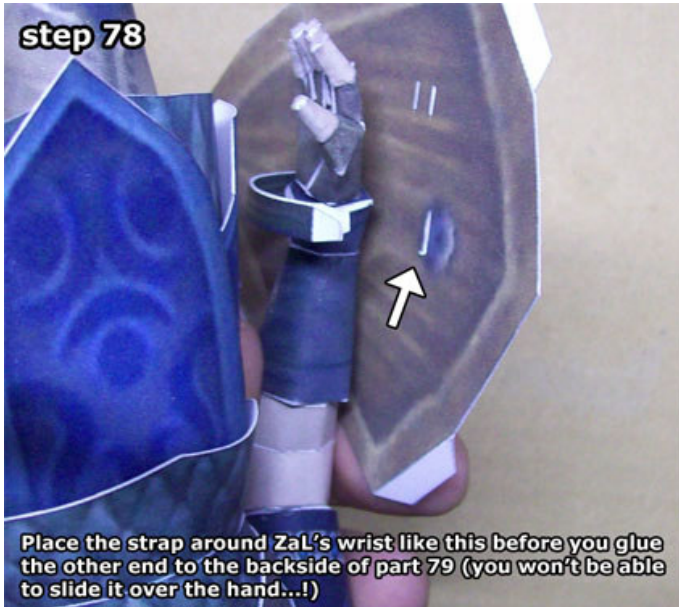

Place the strap around ZaL's wrist like this before you glue the other end to the backside of part 79 (you won't be able to slide it over the hand...!)

step 79



Next, cut out and assemble parts 82 and 83. It should be obvious where to glue part 83 after you pre-shaped it like this ;o)

step 80

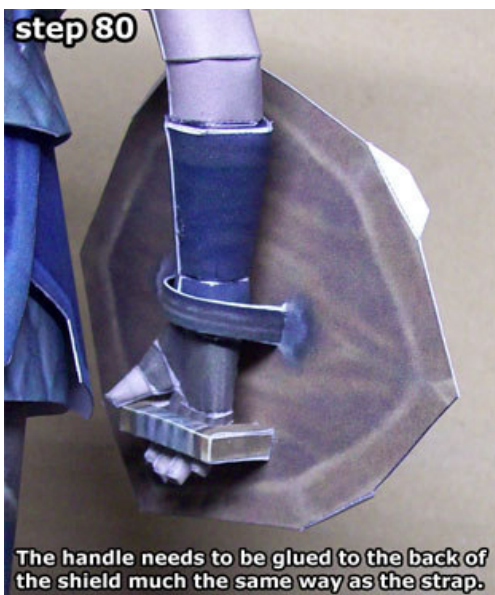

The handle needs to be glued to the back of the shield much the same way as the strap.

step 81



Assemble the final part (part 84)...

step 82



...and glue it to the rest of the shield. That's it, you're done!

step 83



I hope you had fun building your papercraft
Twilight Princess Zora armor Link!

www.kickme.to/ninjatoes
www.ninjatoes.blogspot.com