

Princess Zelda instructions

step 1

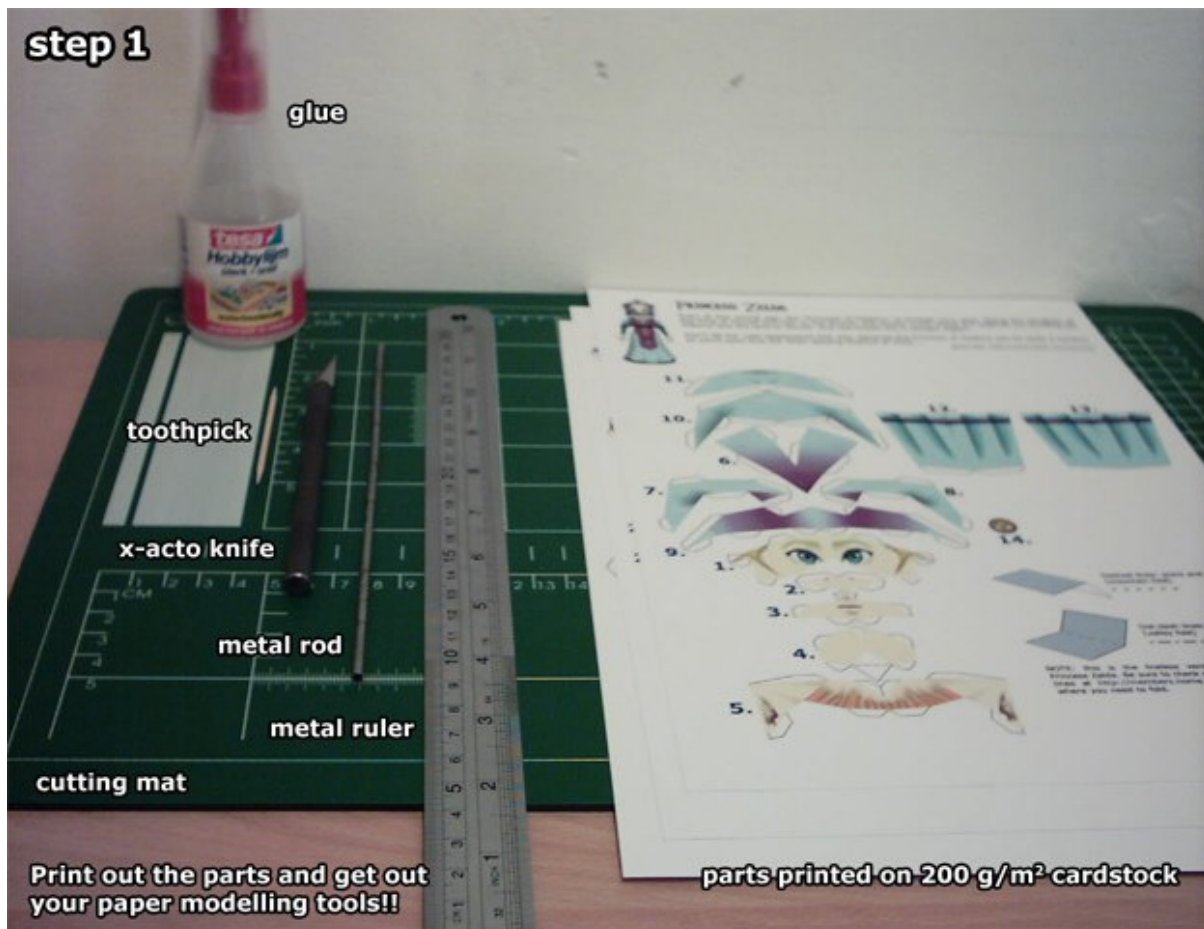

step 2

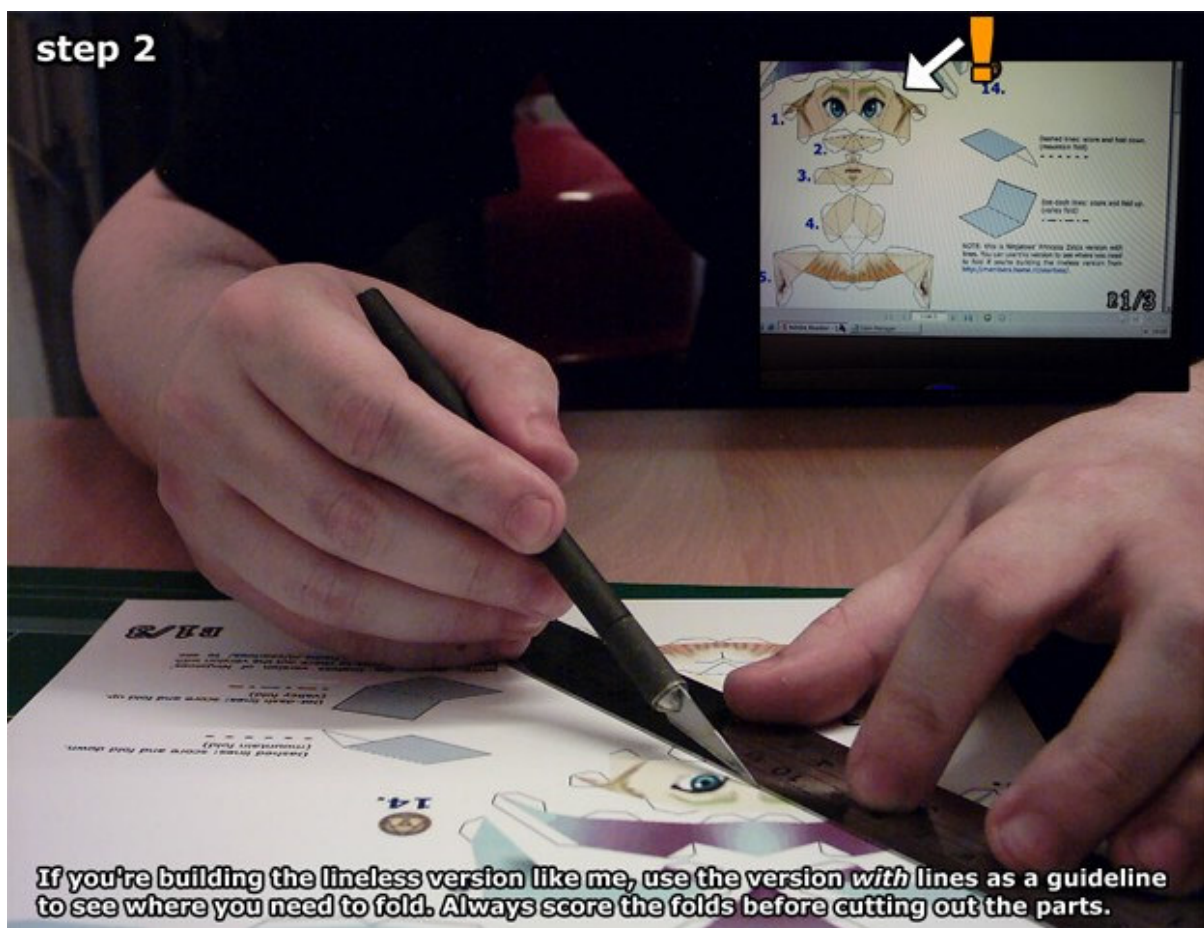

step 3

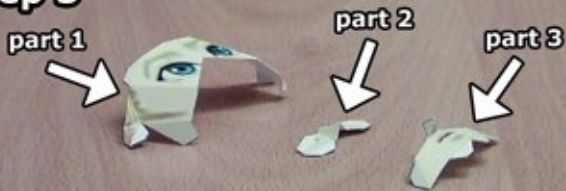

After scoring and cutting out the parts, pre-shape them and test-fit them with the other parts.

step 4



If all's well, you can glue the parts together.

step 5



Pre-shape part 4...

step 6



Glue part 4 to the rest of the face.

step 7



Pre-shape part 5 and form the ears.

step 8



Hook the ears behind the cheeks like so and assemble the back of the neck.

step 9



It'll look something like this.

step 10



Now put the face aside for a moment as you assemble the cloth hood: start by scoring and cutting out part 6.

step 11



Next, glue parts 7 and 8 to part 6; only the first tab needs to be glued though!!

step 12



Now attach part 9; pay close attention to the back, where you'll need to make valley folds instead of mountain folds.

step 13

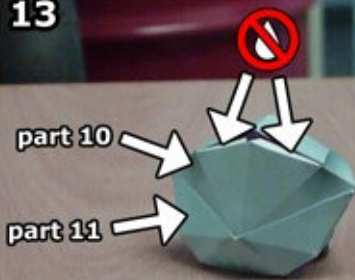

When glueing in place part 10, *DON'T* glue the two tabs in the middle yet!! Attach part 11 to the back.

step 14

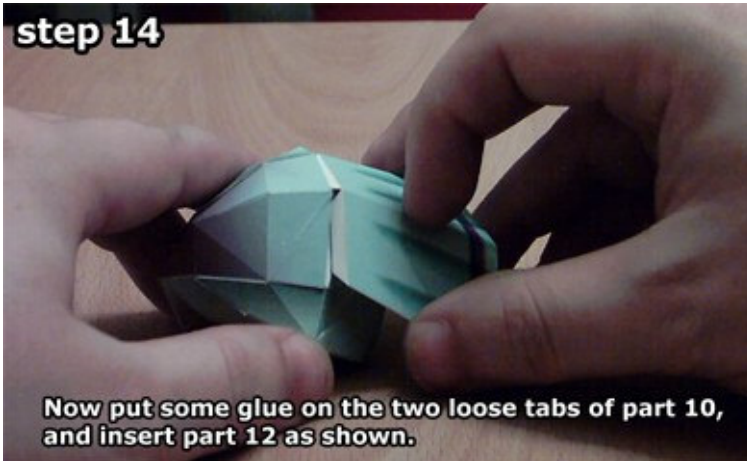

Now put some glue on the two loose tabs of part 10, and insert part 12 as shown.

step 15



Use part 13 to cover up the white backside of part 12.

step 16



Now, take some care in joining the face and the hood together before glueing the Triforce crest in place.

step 17



Now for the body. Cut out and assemble part 15.

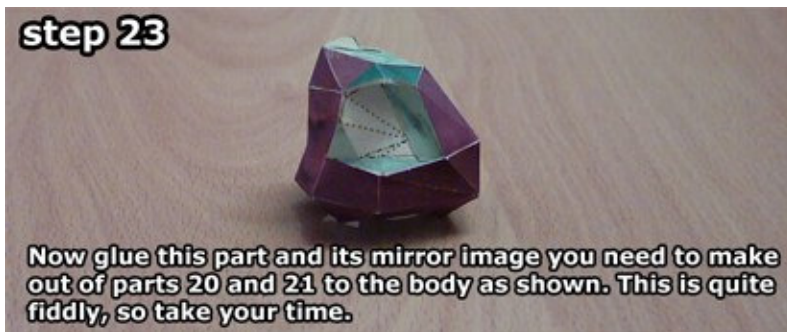
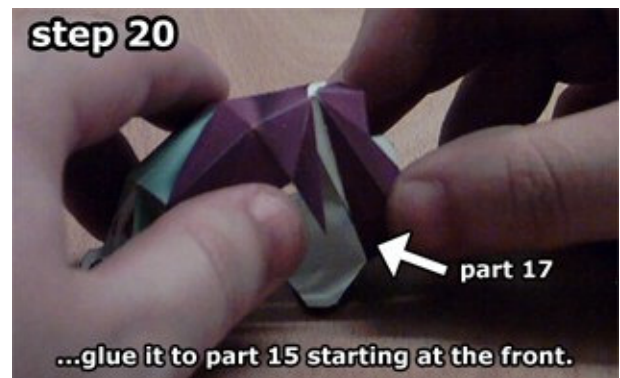

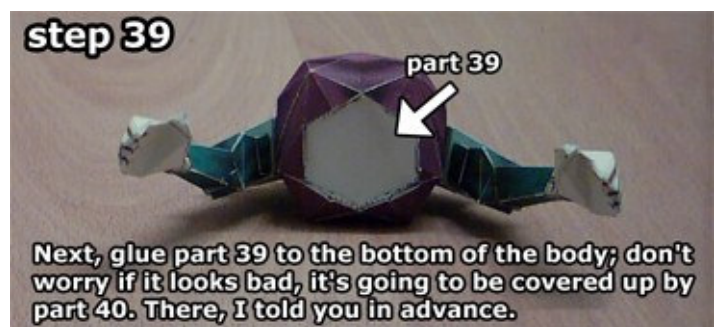
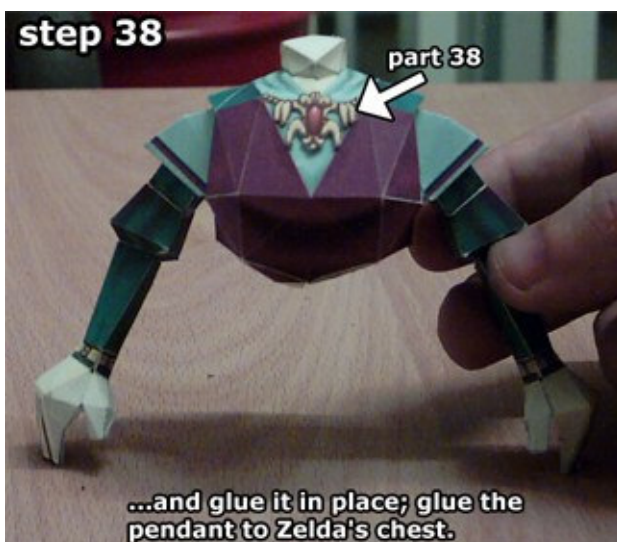
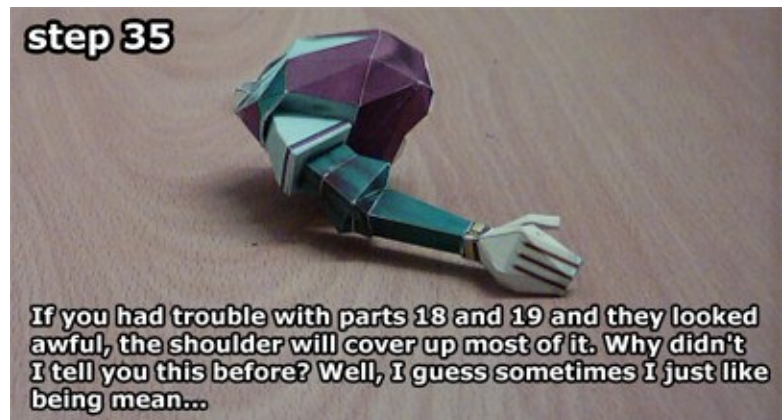

step 40



So assemble part 40...

step 41



...and glue part 41 to the back...

step 42



...and part 42 to the front.

step 43



Wrap part 43 around the back.

step 44



Part 44 goes all the way around.

step 45



Close the bottom with part 45.

step 46



Finally, put the head, body and robe together.
Thank you for downloading and building a Ninjatoes' paper model!!

<http://members.home.nl/saarloos/>