

CLOCKTOWN POSTMAN INSTRUCTIONS

step 1

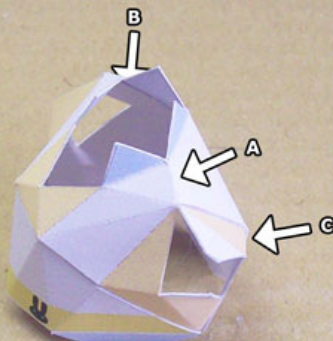

step 2



Be sure to score and pre-shape all the fold lines on part 1 properly, before using the directions on the template to glue it together as shown here.

step 3

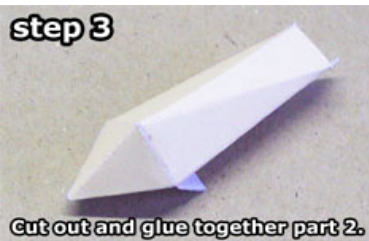

Cut out and glue together part 2.

step 4

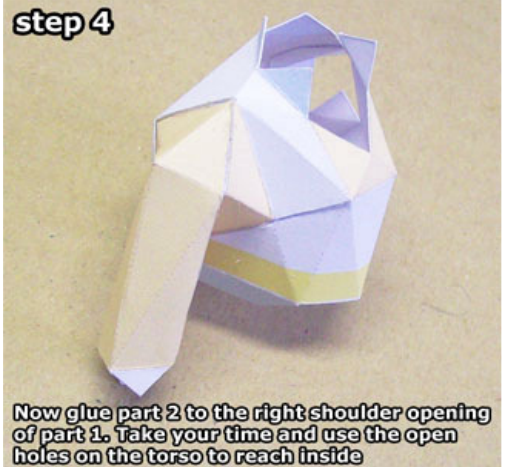

Now glue part 2 to the right shoulder opening of part 1. Take your time and use the open holes on the torso to reach inside

step 5

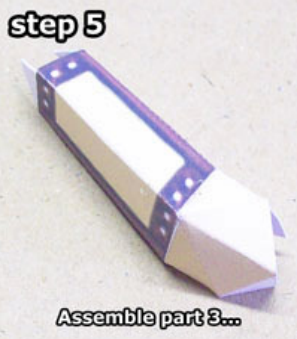

Assemble part 3...

step 6



...then glue it to the bottom of part 2.

step 7

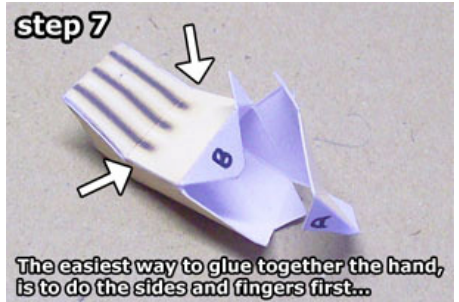

The easiest way to glue together the hand, is to do the sides and fingers first...

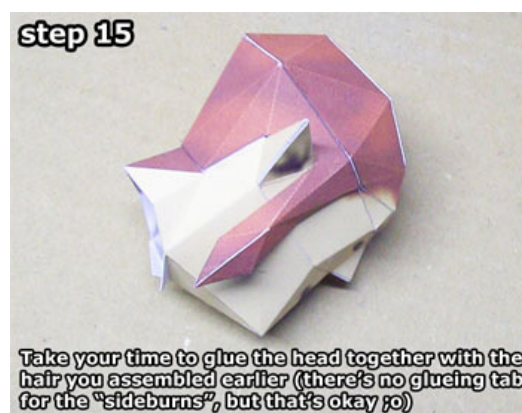
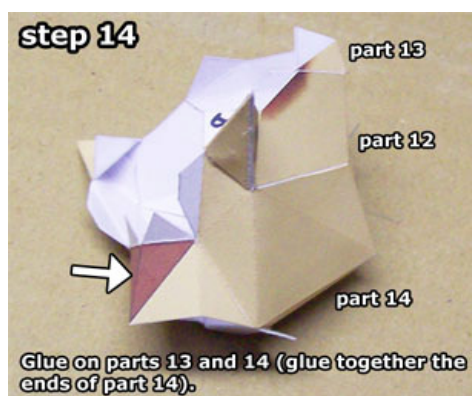
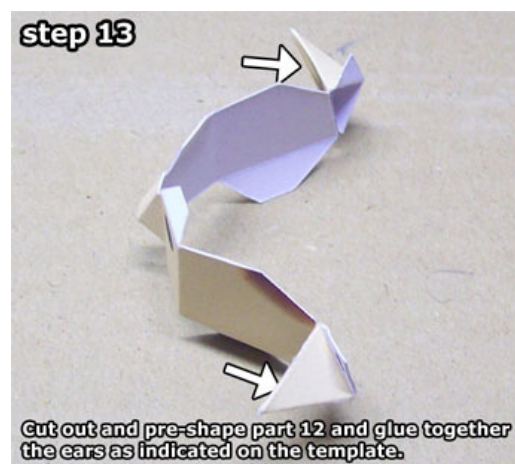
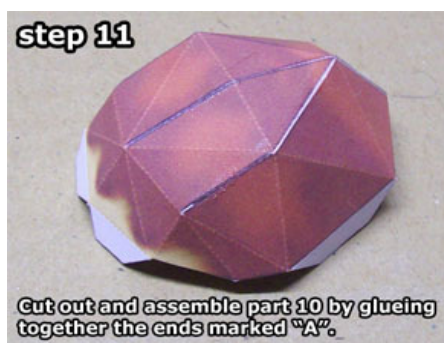
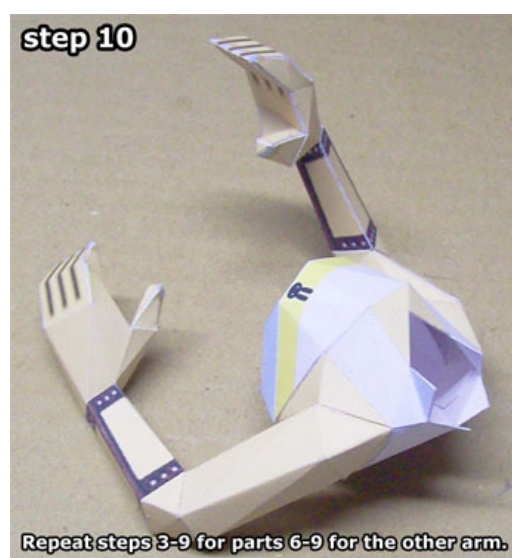
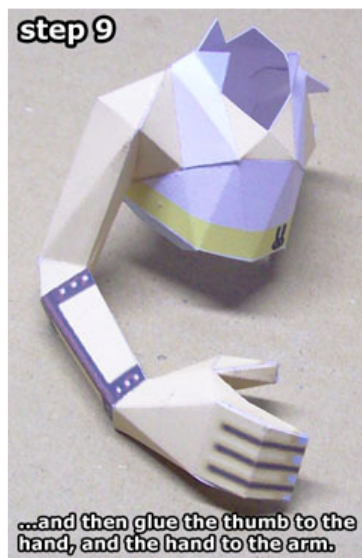
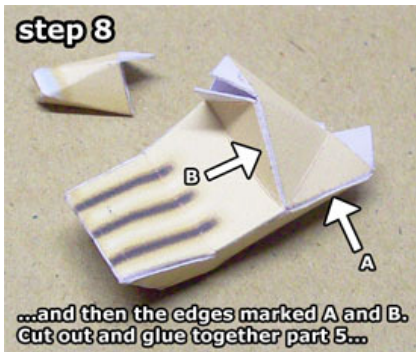

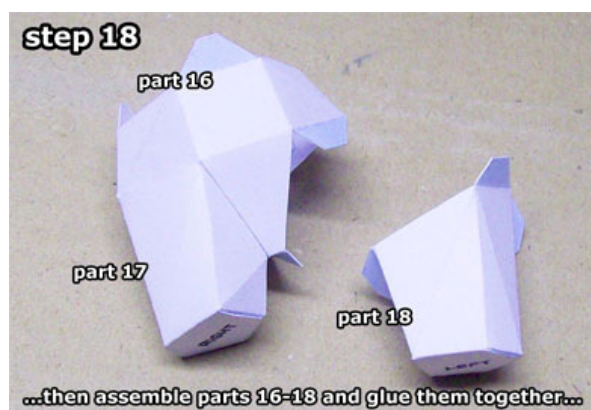
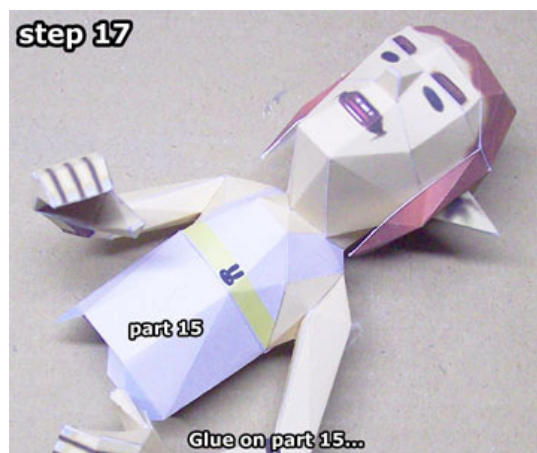

step 20

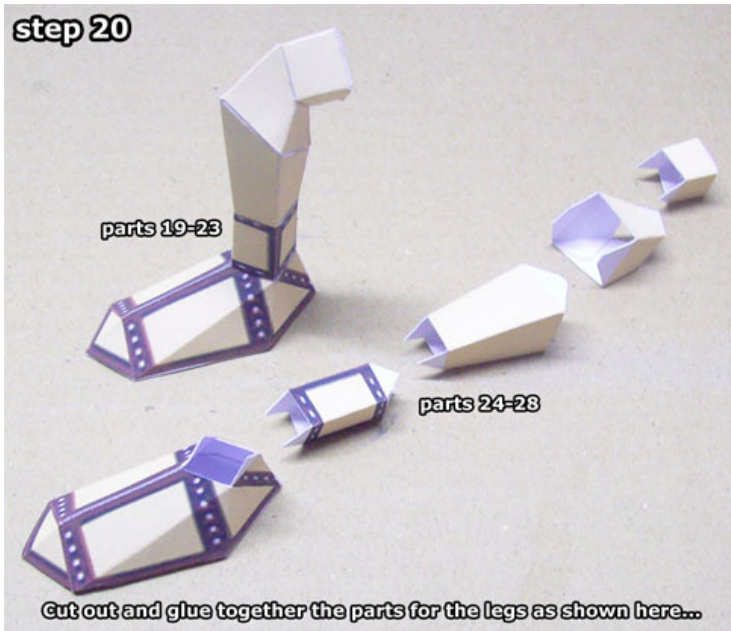

step 21



step 22

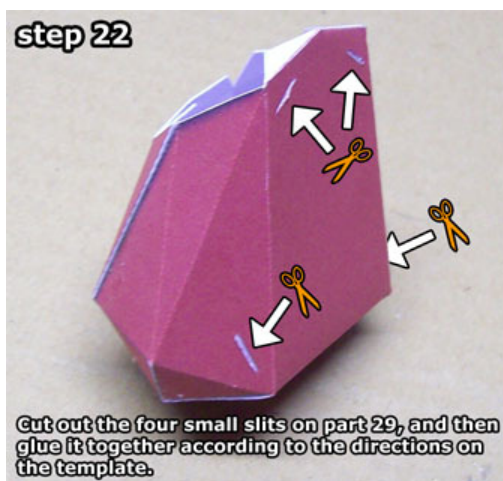

step 23

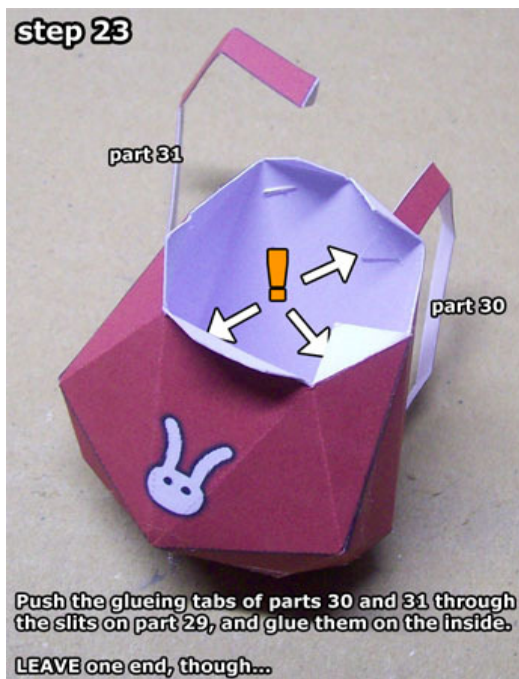

step 24

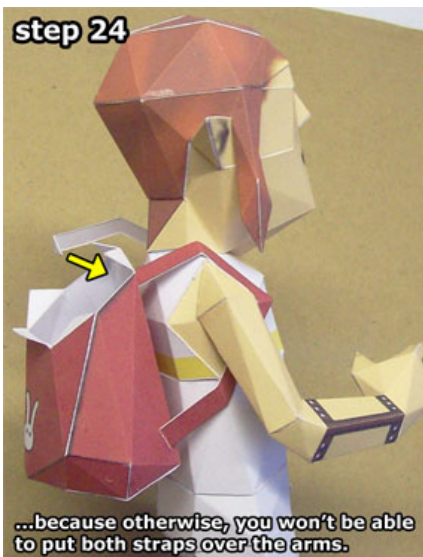

step 25

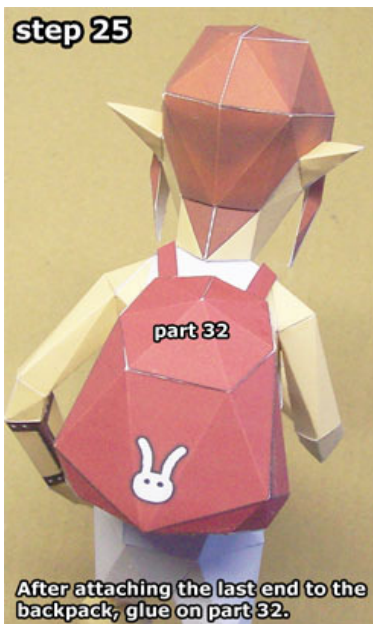

step 26



step 27



step 28

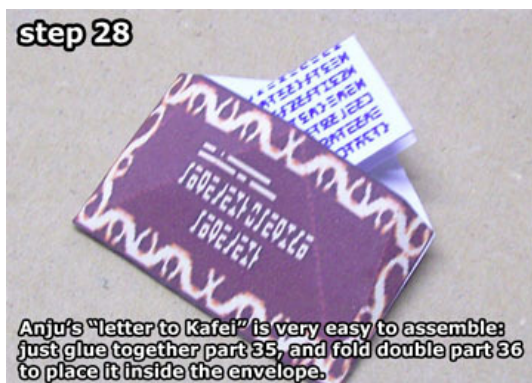

step 29

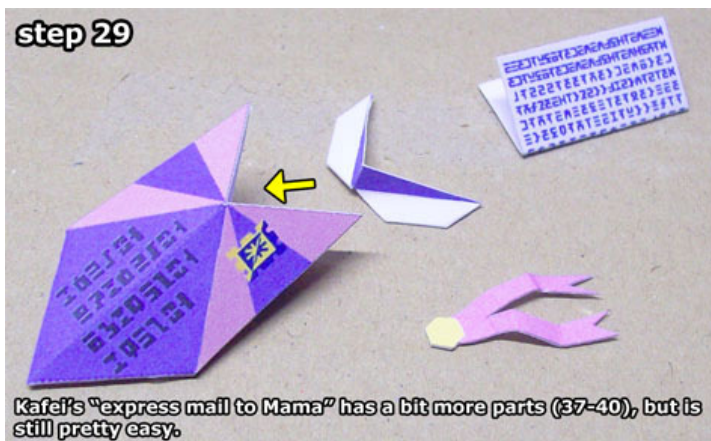

step 30



step 31



Now your Postman has some letters to deliver! Leave off the hat and backpack, and you will have "the running man" from Ocarina of Time.

Thank you for building a Ninjatoes' papercraft model!
www.kickme.to/ninjatoes