

# CAPTAIN LINEBECK INSTRUCTIONS

## step 1



Print the parts on thicker paper (I always use 200 gsm paper) and gather your papercrafting tools!

## step 2



## step 3

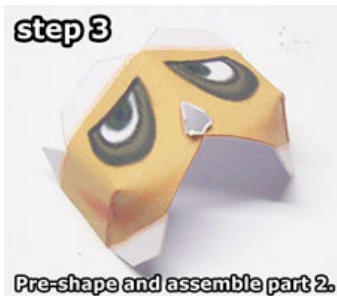

## step 4



## step 5



## step 6



## step 7



## step 8

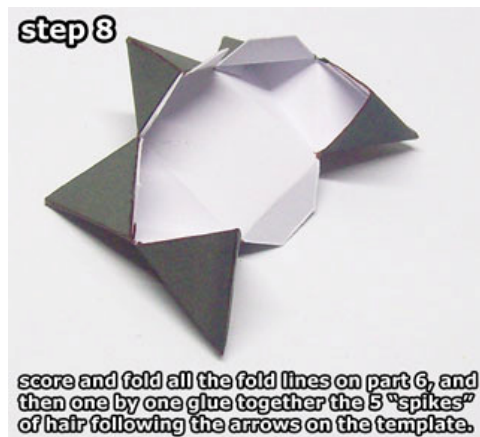

### step 9

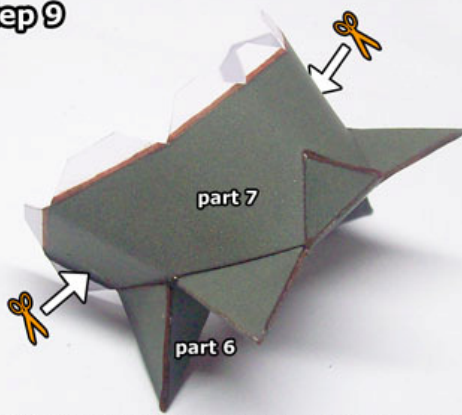

Don't forget to cut the two small slits on part 7, pre-shape it, and then glue it to part 6 as shown here.

### step 10

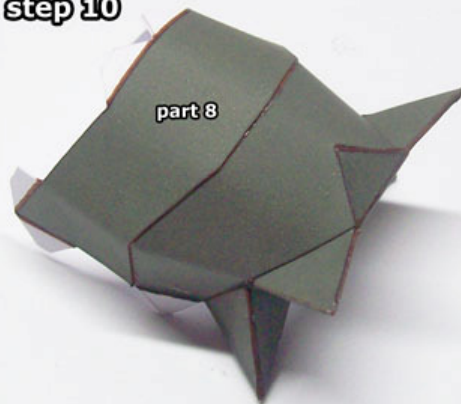

Pre-shape and glue on part 8.

### step 11



Take your time to glue the hair and the face together as shown here.

### step 12



Assemble part 9 as shown here...

### step 13



...and then take your time to glue part 9 to the rest of the head, using the natural tension in the paper.

### step 14



Glue part 10 into a small spike following the arrow on the template.

### step 15



Do the same for parts 10 and 11...



### step 16

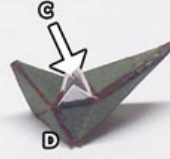

...and then glue parts 10 and 11 together using the edges marked C and D as shown here.

### step 17



Glue together part 12...

### step 18



...and then glue it to parts 10 and 11 as shown here.

### step 19



Glue the little pluck of hair on top of Linebeck's head.

### step 20



Assemble parts 13 and 14, but \*don't\* score or fold the bigger glueing tabs!

### step 21

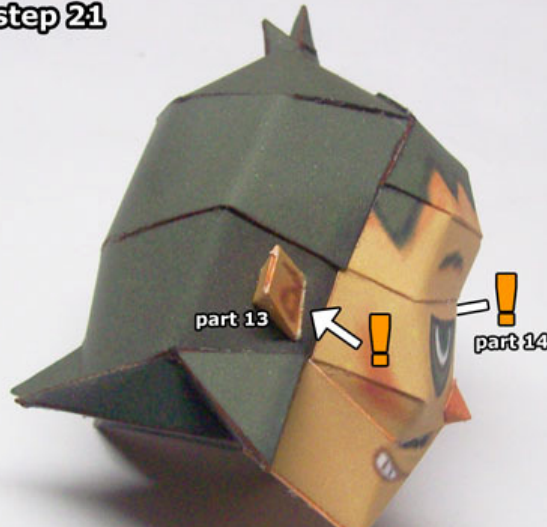

Push the glueing tabs through the slits on the side of the head to glue the ears to the head.



### step 22



### step 23

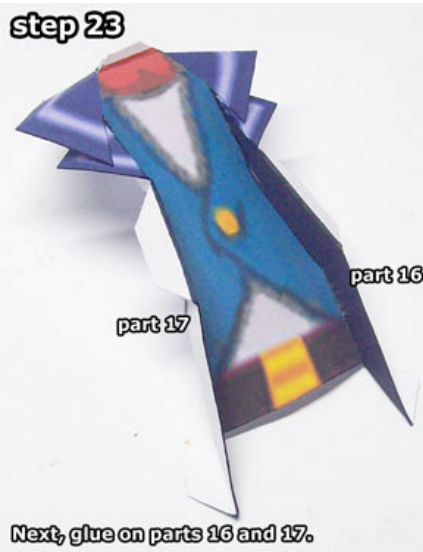

### step 24

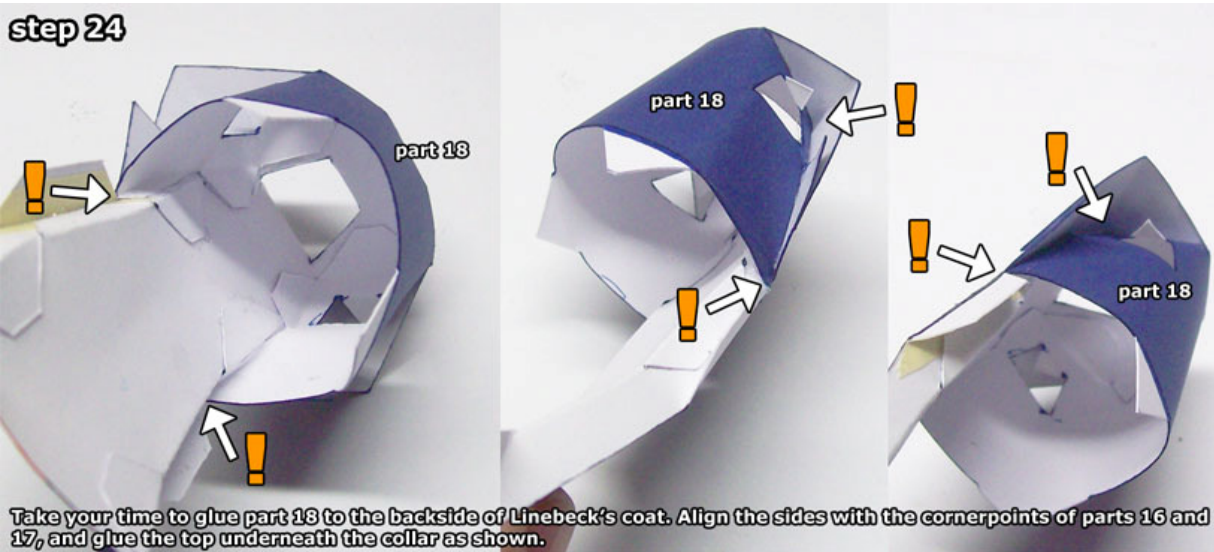

### step 25



### step 26

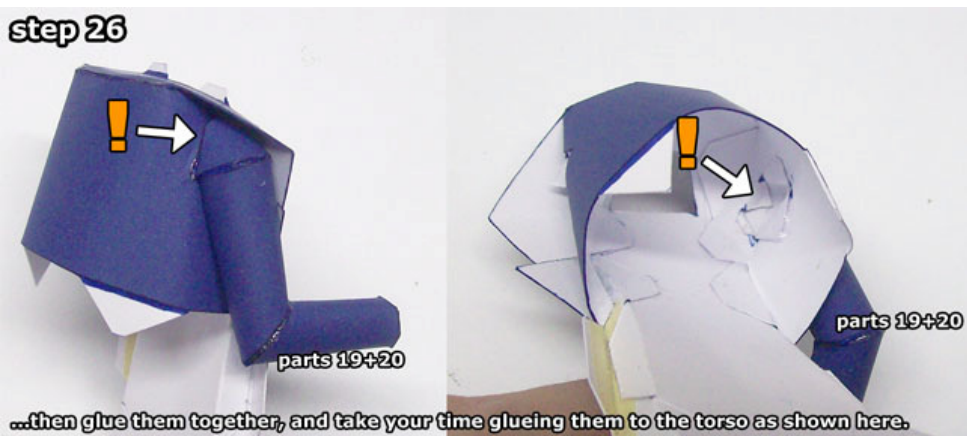

### step 27



### step 28



Glue together part 23...

### step 29



...and glue it on top of the collar as shown here.

### step 30



Glue on part 24...

### step 31

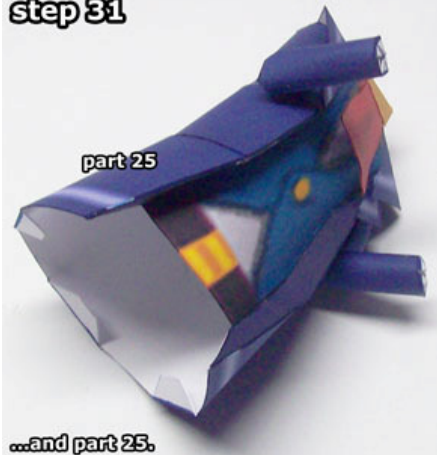

...and part 25.

### step 32

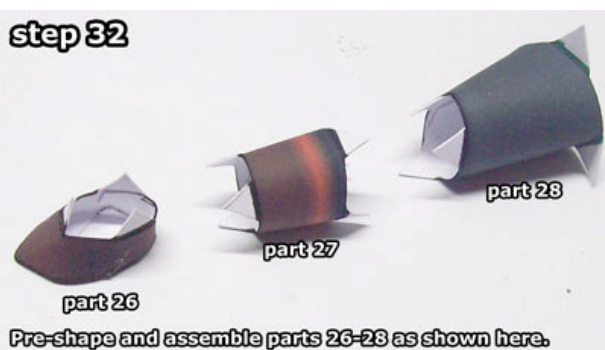

Pre-shape and assemble parts 26-28 as shown here.

### step 33



Glue them together, and then do the same for parts 29-31.

### step 34



Now pre-shape and glue together part 32 as shown here, following the directions on the template.

### step 35



Now glue the legs to part 32 as shown here. Obviously, this is a very important step for the balance of the completed paper model, so work with the parts until it can stand right!

### step 36



Glue part 33 around the back of Linebeck's trousers as shown here (with the coloured side down).



### step 37



Take your time to glue the trousers underneath Linebeck's coat as shown here.

### step 38



part 35



part 34

Now cut out and assemble parts 34 and 35. The hands are only "2.5D", so you only need to fold over and glue on the one glueing tab.

### step 39



(put a rubber band around the arms and leave it on for a while if you need the arms to "hug" the body more)



Glue these parts to the right arm as shown here, and then do the same for parts 36 and 37 on the other arm.

### step 40



Cut out parts 38 and 39 and glue them back-to-back. Then, before the glue has completely dried, shape it into a nice curve, and roll up the ends around a toothpick.

### step 41



Glue Linebeck's head onto his neck, and place the sea chart in his hands; it's possible to do this without glue, but it will very easily fall off, so it's best to put some glue on Linebeck's fingers.

If Linebeck still keeps falling over, you can try using this technique: [www.tinyurl.com/adjustbalance](http://www.tinyurl.com/adjustbalance) to adjust the balance. If it doesn't work, simply glue his feet to a big enough stand.

Thank you for downloading and building a Ninjatoes' papercraft model!  
[www.kickme.to/ninjatoes](http://www.kickme.to/ninjatoes)