

Koume & Kotake papercraft instructions

step 1



To make this paper model, all you really need are the parts, a knife, and glue. A toothpick is also a very cheap and useful tool, and a cutting mat will make your tabletop last longer. :o)

step 2

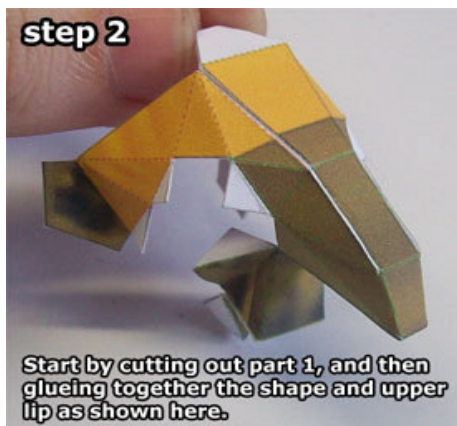

step 3



step 4

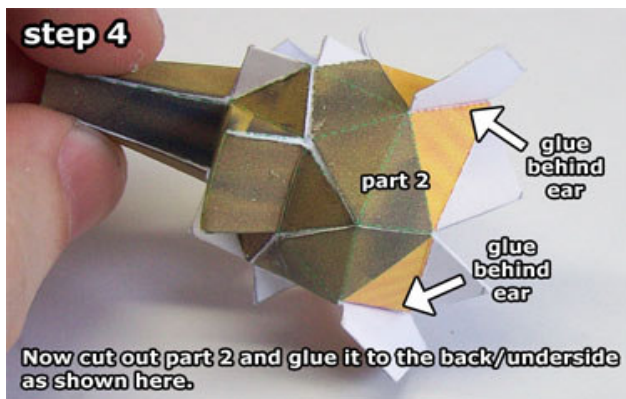

step 5

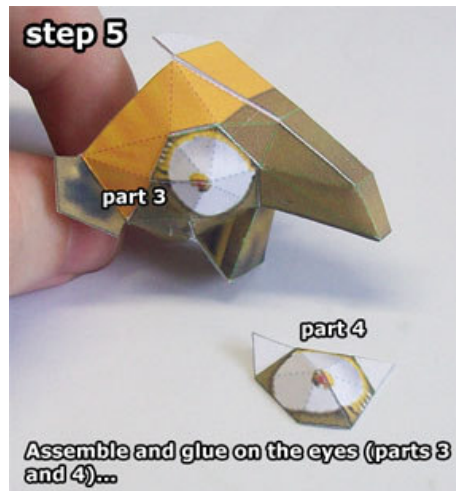

step 6



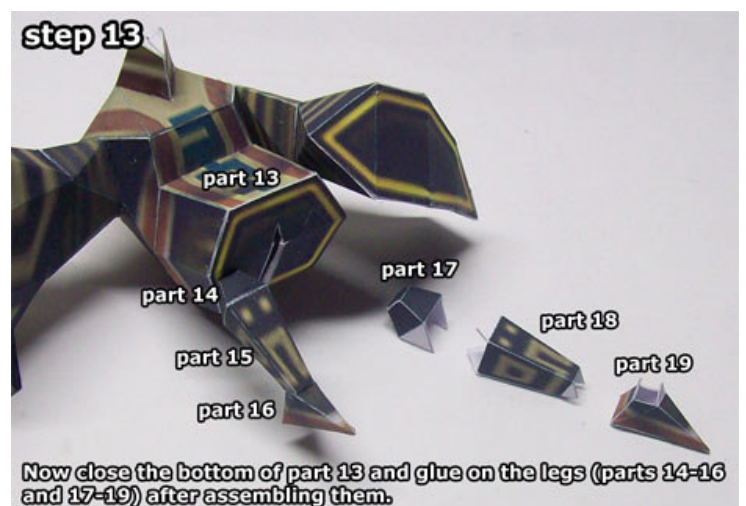
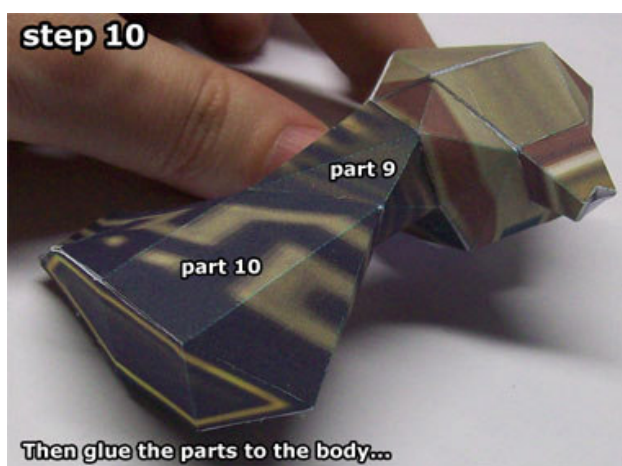
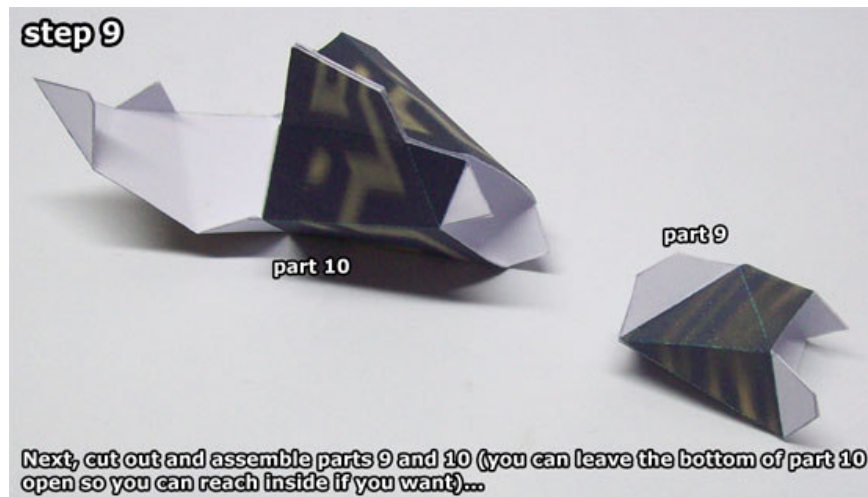
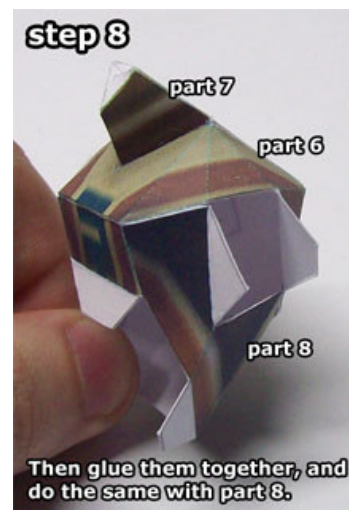
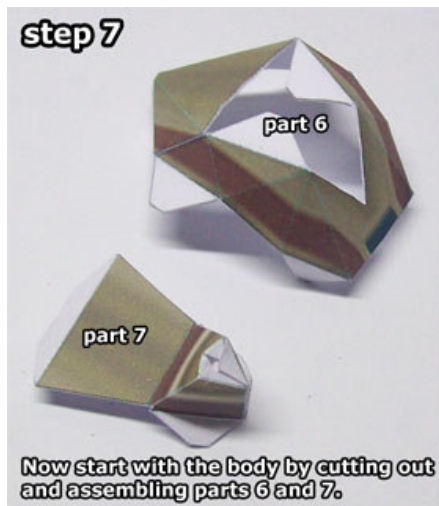

step 14



To assemble the hair, start by folding and glueing together part 20...

step 15

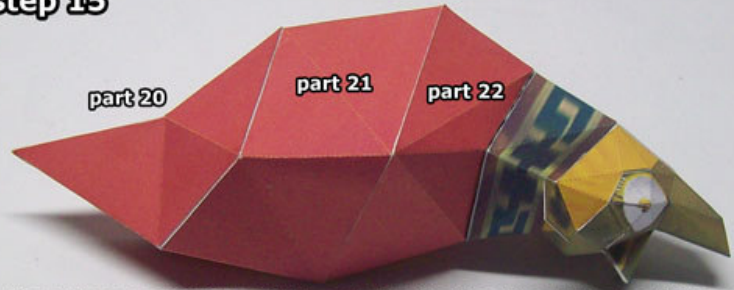

...then glue on parts 21 and 22, and glue it all on top of the head like so.

step 16



Assemble and glue together parts 23 and 24...

step 17

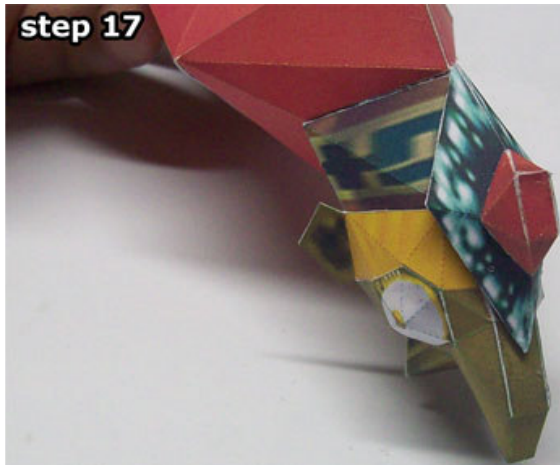

...and then glue it to the forehead. It should lay flat against the head, so gently press the parts together until the glue dries and the gem won't come loose anymore.

step 18



Now you need to glue the head (or one of the "normal" replacement heads from www.kickme.to/ninjatoes!) to the neck. Use the point of part 1 as alignment.

step 19

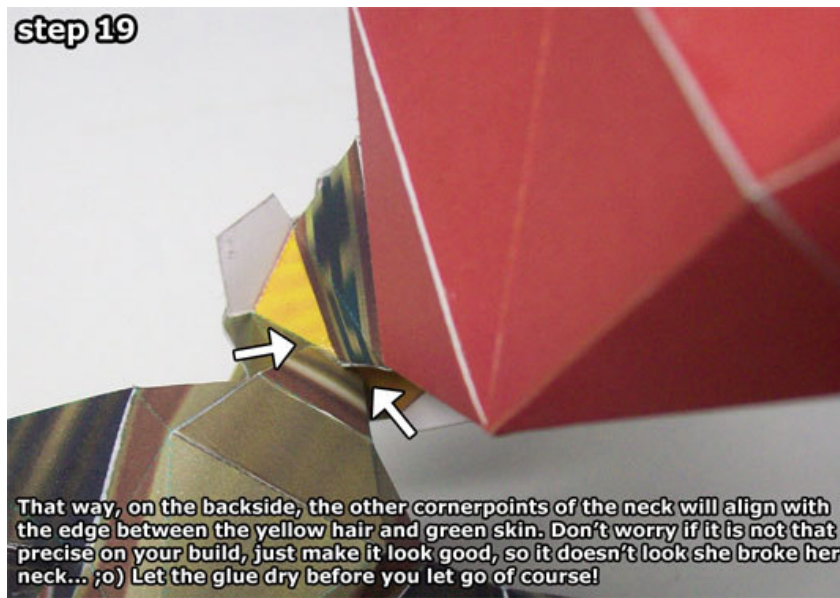

step 20

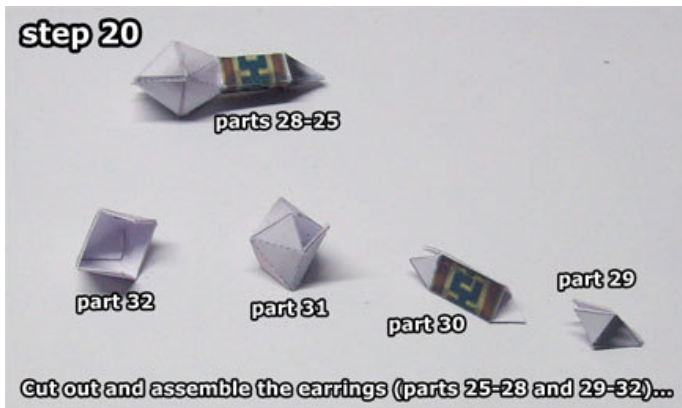

step 21



step 22



step 23



step 24

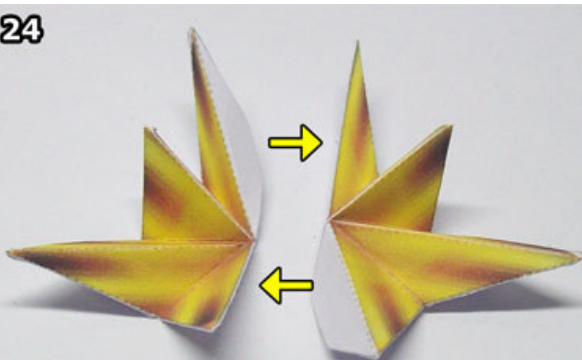

To glue on the inside of the bristles, it is very important that you fold parts 38 and 39 correctly: it is kinda like a harmonica, so the first fold is a mountain fold (up), and the next a valley fold (down), then a mountain fold again (up), and then down again and so on.

step 25

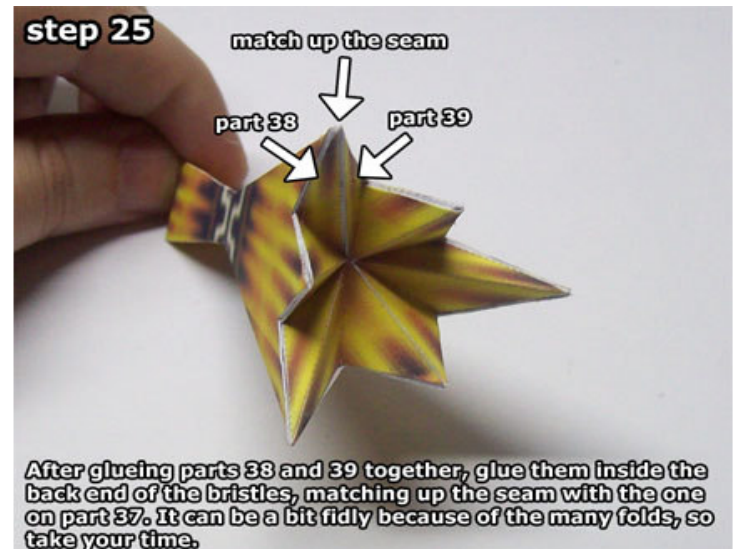

step 26



Glue the bristles and the broomstick of the broom ("besom") together with the seam on top.

step 27

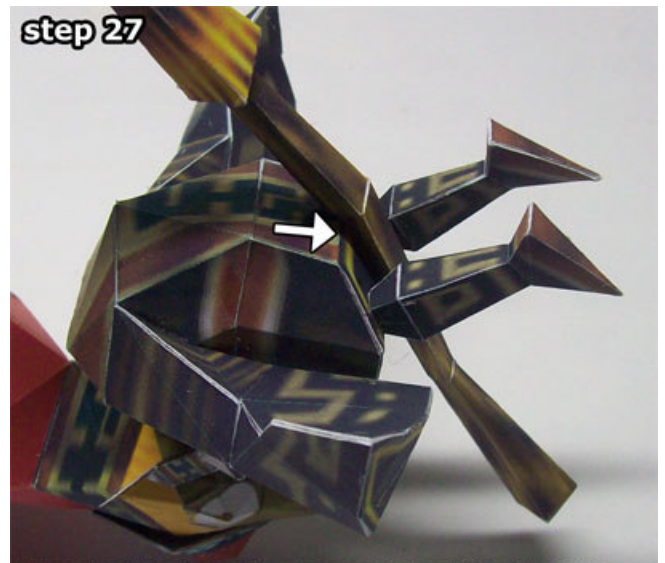

Now glue it between the legs, onto the little slit on the bottom of the body (with the seam on the besom on top!)

step 28

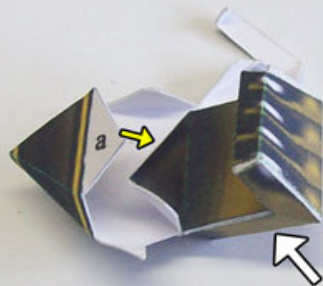

To assemble the right hand, first score and fold/pre-shape part 40, and then glue together one side of the hand first as shown here.

Then glue together the glueing tab and edge marked "a" as indicated on the template...

step 29



...and then glue together the other side of the hand, automatically glueing together the glueing tab and edge marked "b".

step 30



Now simply assemble the thumb (part 41) and glue it to the hand like so.

step 31

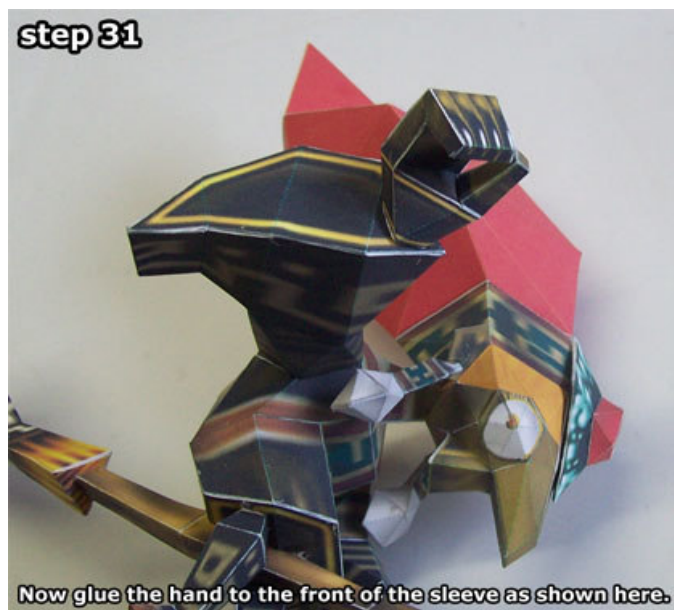

Now glue the hand to the front of the sleeve as shown here.

step 32

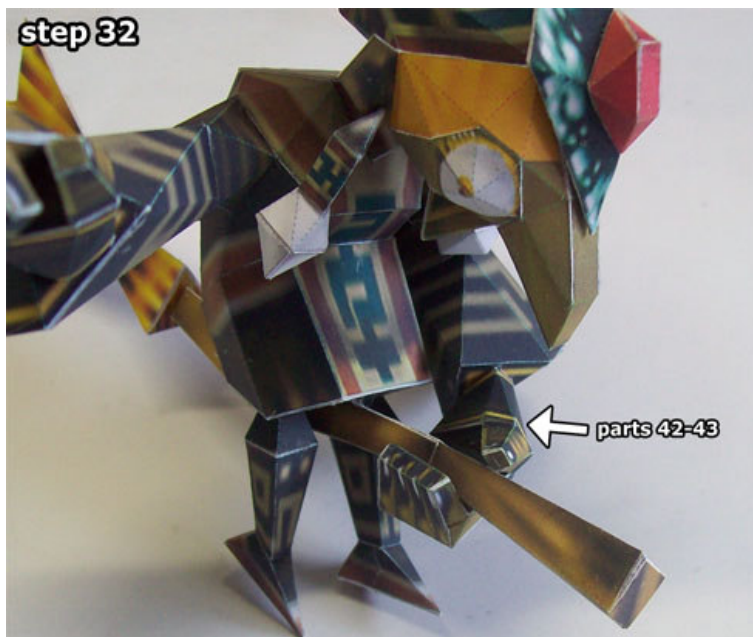

Now do the same for the left hand (parts 42-43) and if all is well, you should be able to glue it to the sleeve in such a way that she can hold the broomstick as shown here.

step 33



It's a nice effect if you hang Koume and Kotake from the ceiling using a piece of string, but you can also use this simple stand (part 44)...

step 34

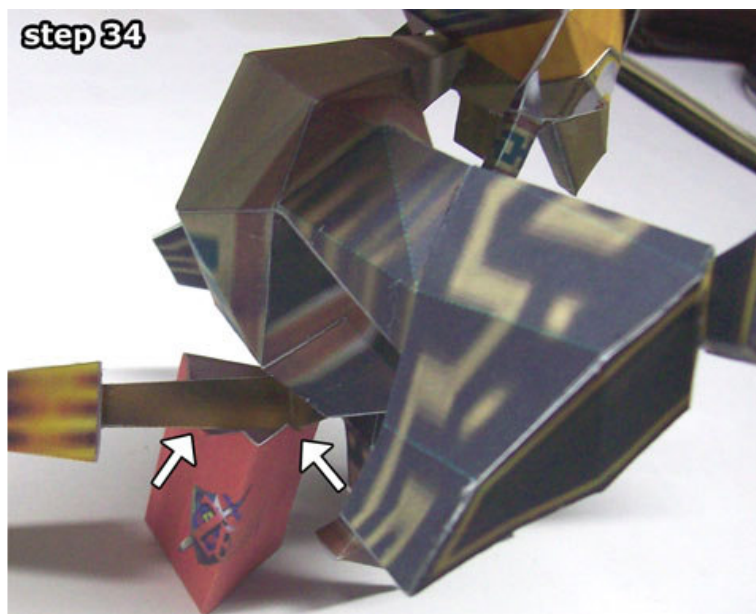

...to balance them on as shown here.

step 35



Thank you for building a Ninjatoes' papercraft model!
(if you want to build the "normal" replacement head, keep on reading ;o)

step 36

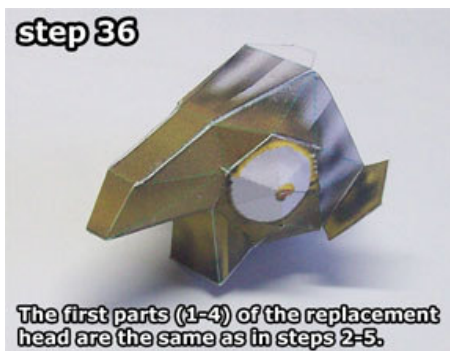

The first parts (1-4) of the replacement head are the same as in steps 2-5.

step 37

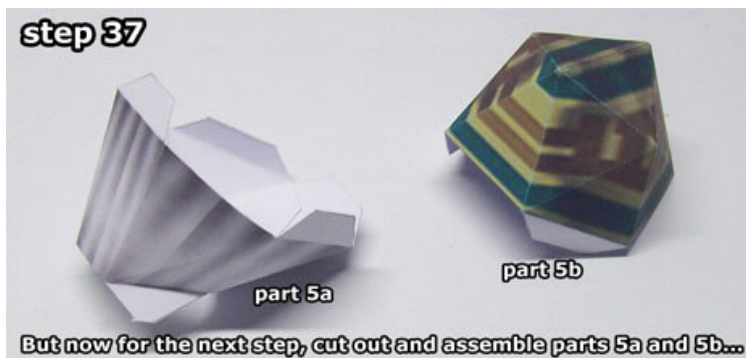

But now for the next step, cut out and assemble parts 5a and 5b...

step 38



...and then glue them to the rest of the head as shown here.

step 39



Then glue together the gem (parts 23-24) and the earrings (parts 25-28 and 29-32) as in steps 16-21...

step 40



...which will also show you how to glue the head to the neck. Thank you for building a Ninjatoes' replacement head, I hope you had fun building!