

# the King of Red Lions instructions

## step 1



This model comes on a whopping 16 pages, print them all out on 200 g/m<sup>2</sup> cardstock (or whatever works best for you) and get out your papermodelling tools!!

## step 2

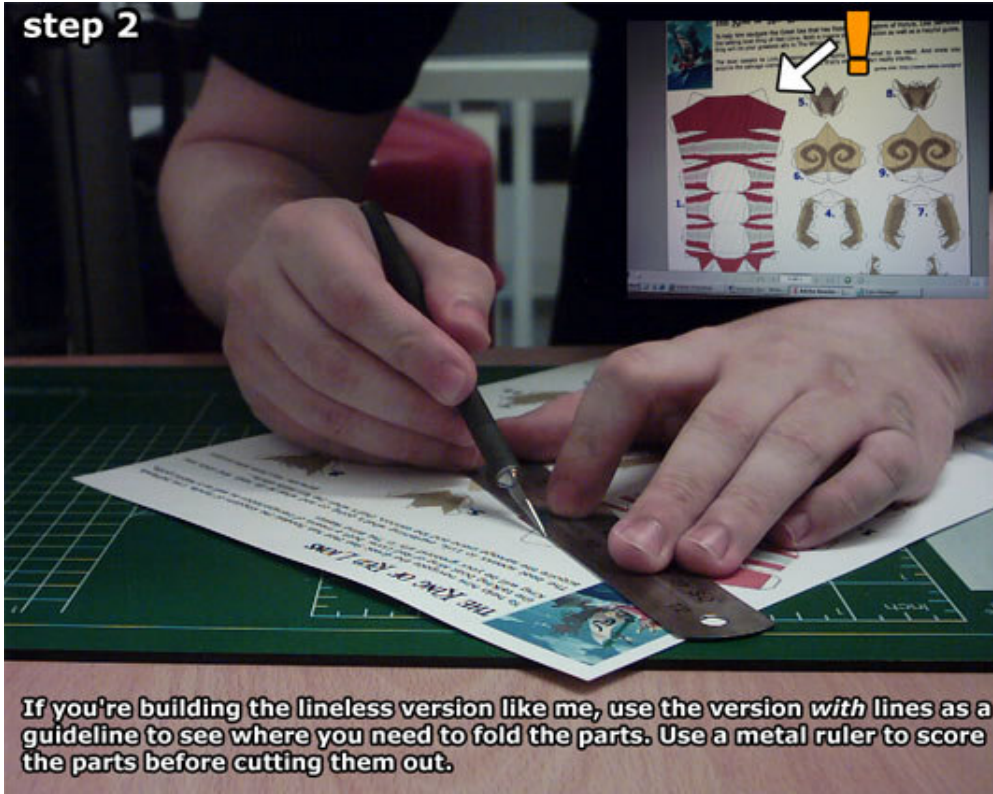

If you're building the lineless version like me, use the version *with* lines as a guideline to see where you need to fold the parts. Use a metal ruler to score the parts before cutting them out.

## step 3

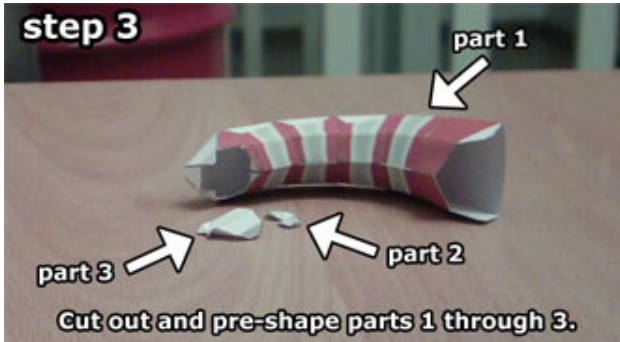

## step 4





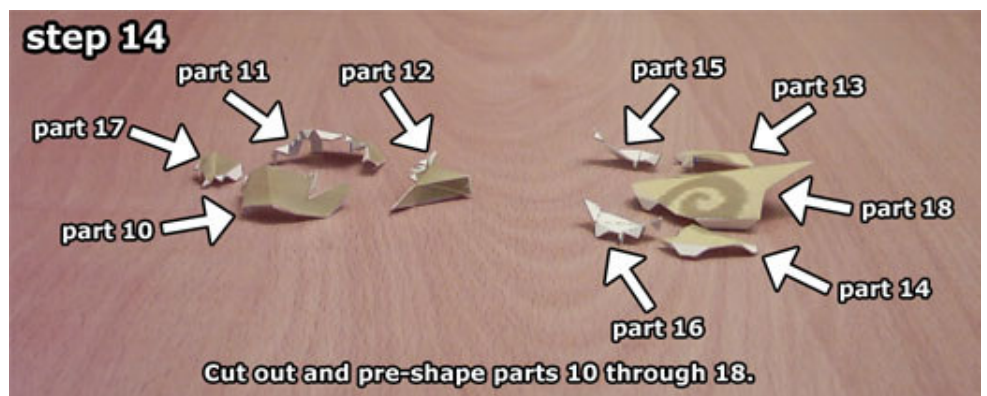
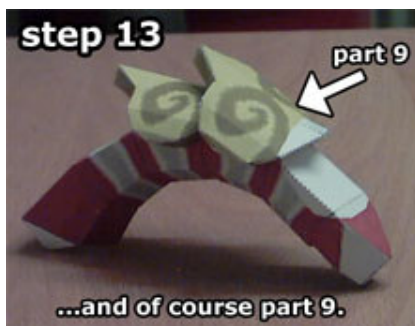
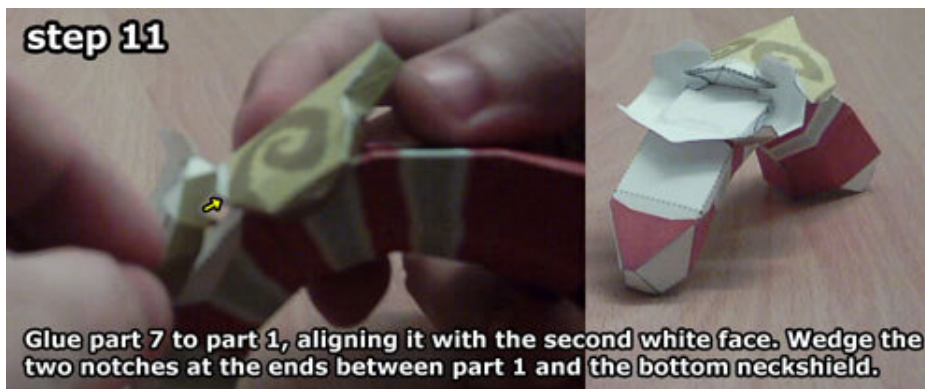
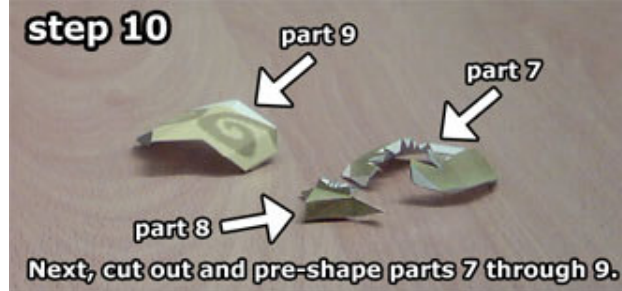
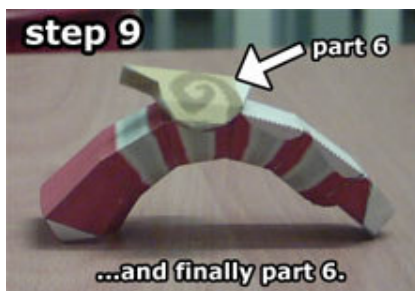
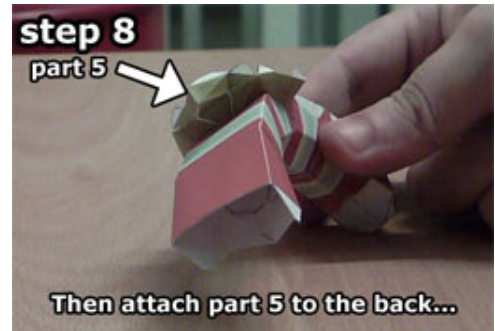
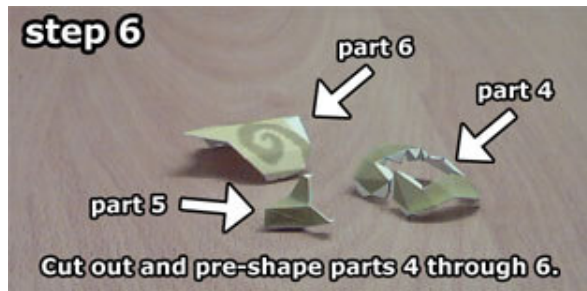
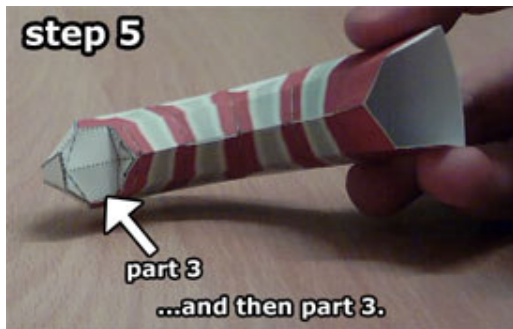



### step 15



Glue parts 10 and 11 to the sides, wedging the notches between part 1 and the middle neckshield.

### step 16

part 12



Now glue part 12 to the back...

### step 17

part 13

part 14

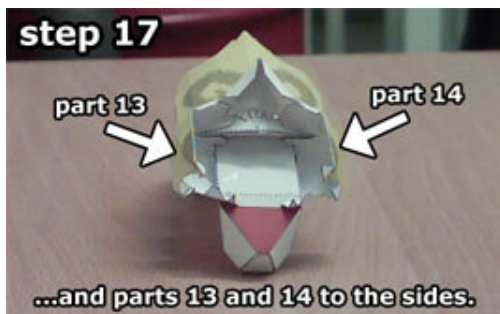

...and parts 13 and 14 to the sides.

### step 18

part 16

part 15

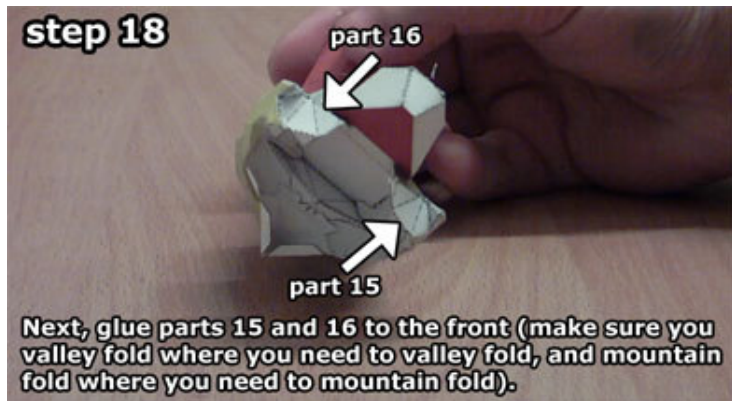

Next, glue parts 15 and 16 to the front (make sure you valley fold where you need to valley fold, and mountain fold where you need to mountain fold).

### step 19

part 17



Part 17 glues to the front as well...

### step 20

part 20



...and part 18 goes on top.  
Stage 1 complete!

### step 21

inverted folds!!

part 19

part 20

part 21



Put the neck aside for now and cut out and pre-shape parts 19 through 21.

### step 22

part 20

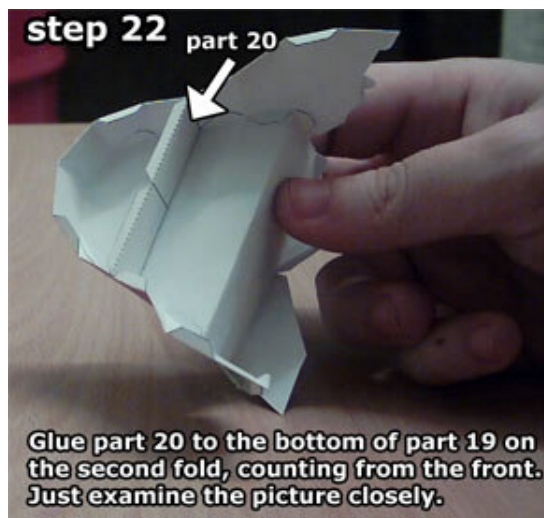

Glue part 20 to the bottom of part 19 on the second fold, counting from the front. Just examine the picture closely.



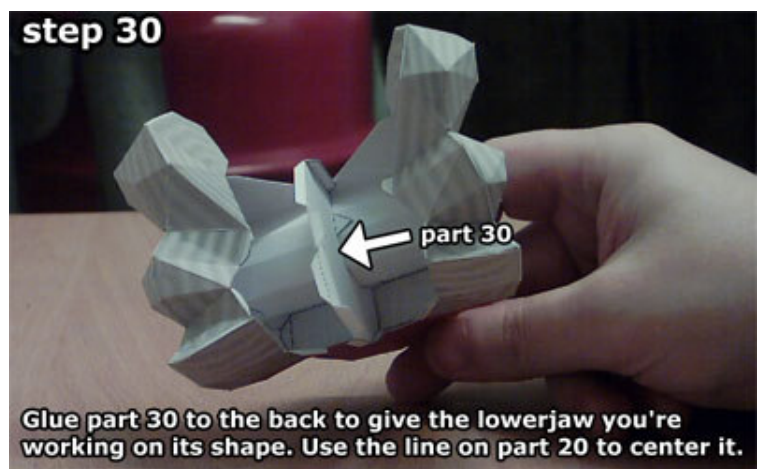
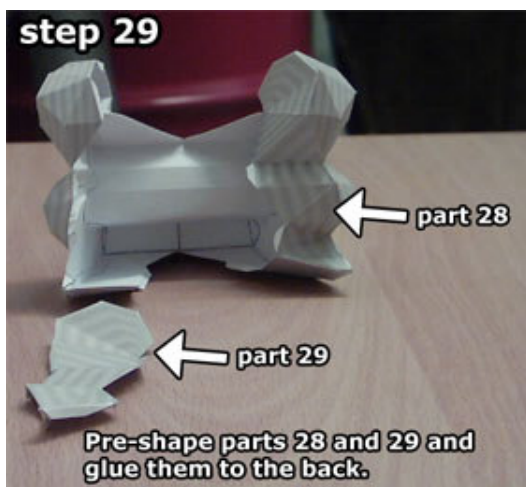
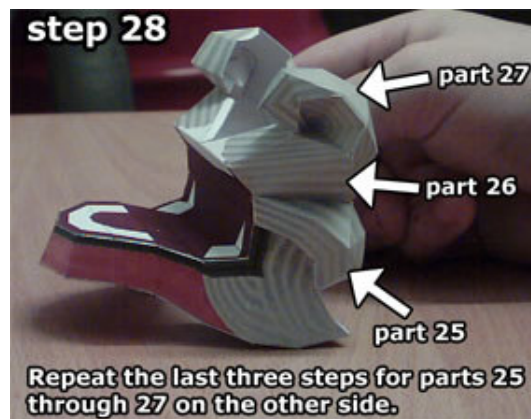
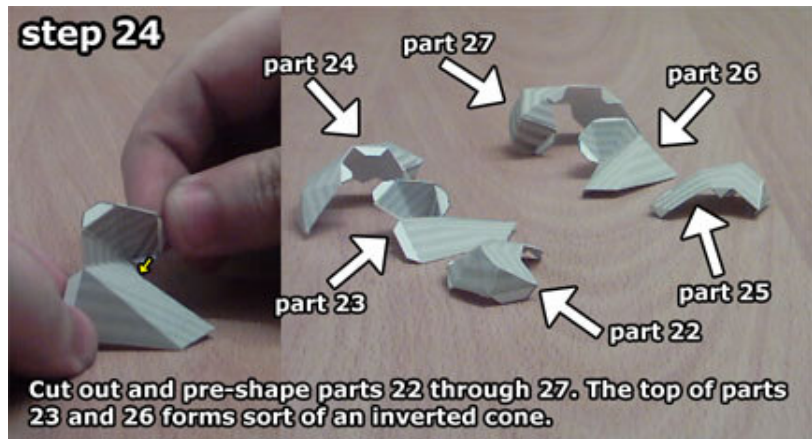



### step 31

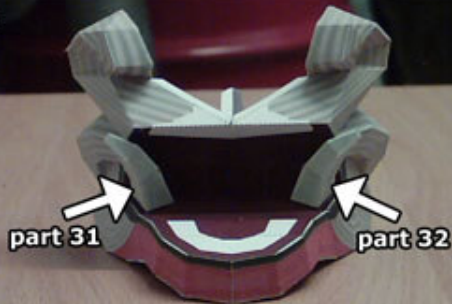

Assemble parts 31 and 32 and glue them to the white faces inside the mouth. Apply pressure from the back to ensure the tusks are also glued to the back of the mouth.

### step 32

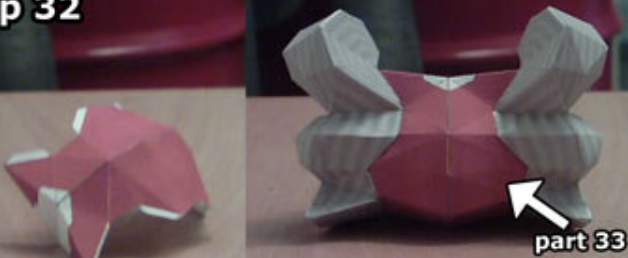

Pre-shape part 33 and glue it to close the bottom and back. Make sure you glue it to the reinforcement rib inside as well.

### step 33



Cut out and pre-shape parts 34 through 37...

### step 34



### step 35



...and glue them to the white face on the inside of the mouth. Stage 2 complete!

### step 36

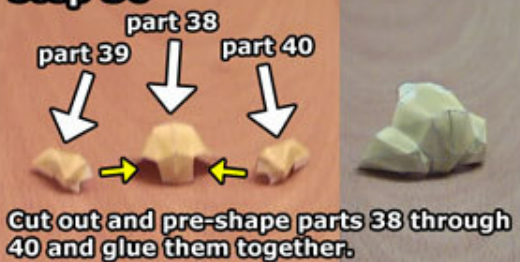

### step 37



### step 38

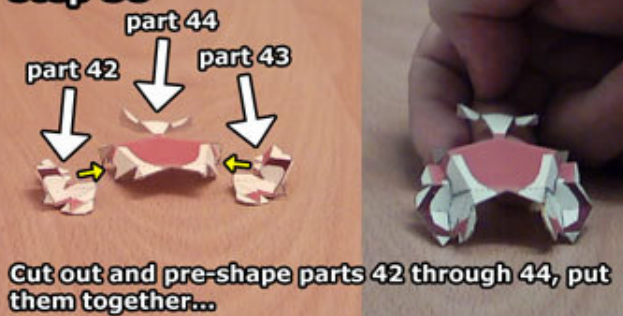

### step 39





### step 40



Cut out part 45 and glue it inside the snout. The bottom aligns with the fold on part 41, and the top aligns with the fold at the front on part 44.

### step 41



Now glue part 46 to the back, using the line on part 45 to center it. It's best not to glue the back part of part 44 down yet.

### step 42



Cut out and pre-shape part 47...

### step 43

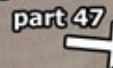

...and glue it to the rest of the face. After that, you can glue the back part of part 44 down.

### step 44

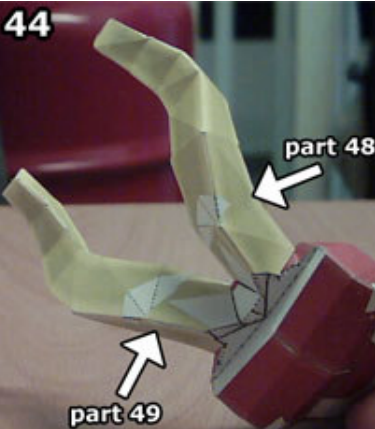

Fold parts 48 and 49 into two horns (just follow all the valley folds and mountain folds and you can't really go wrong) and glue them to the back of the face.

### step 45



Cut out and assemble parts 50 and 51 and glue them to the white faces on the bottom.

### step 46



Assemble parts 52 and 53 and glue them to the sides.

### step 47

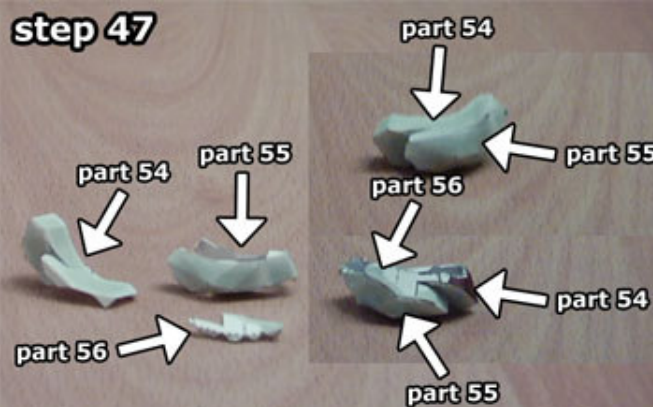

Cut out and pre-shape parts 54 through 56 and glue them together.



### step 48

parts 54-56

parts 57-59

Do the same with parts 57 through 59 and glue the eyebrows to the face. Stage 3 complete!

### step 49

Now first glue the face to the lowerjaw, using the white faces to align the parts.

### step 50

Attach the neck to the back, again using the white faces to glue the parts together.

### step 51

part 60

part 61

Now, after building the head, you'll enjoy working on the big parts of the rest of the boat! Start by cutting out and pre-shaping parts 60 and 61.

### step 52

part 61

part 60

Glue them together.

### step 53

part 62

Cut out and pre-shape part 62 and glue it to the bow.

### step 54

part 63

The next part to go on is (what a surprise) part 63.

### step 55

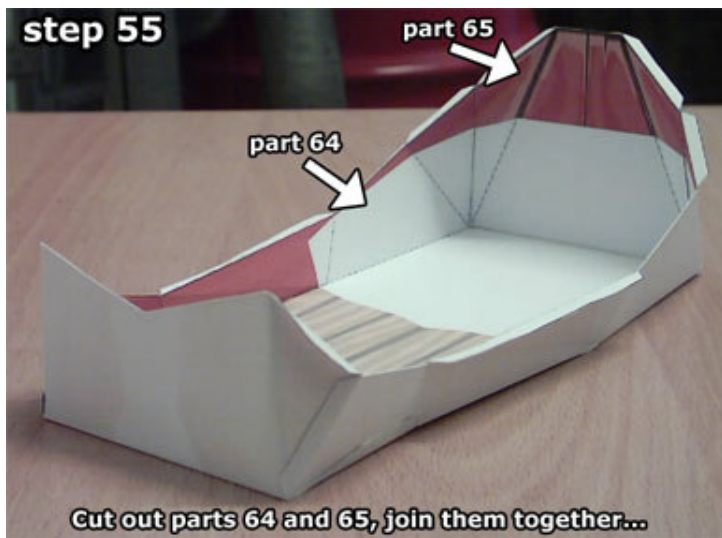

Cut out parts 64 and 65, join them together...

### step 56



...and glue them to the rest of the hull.

### step 57

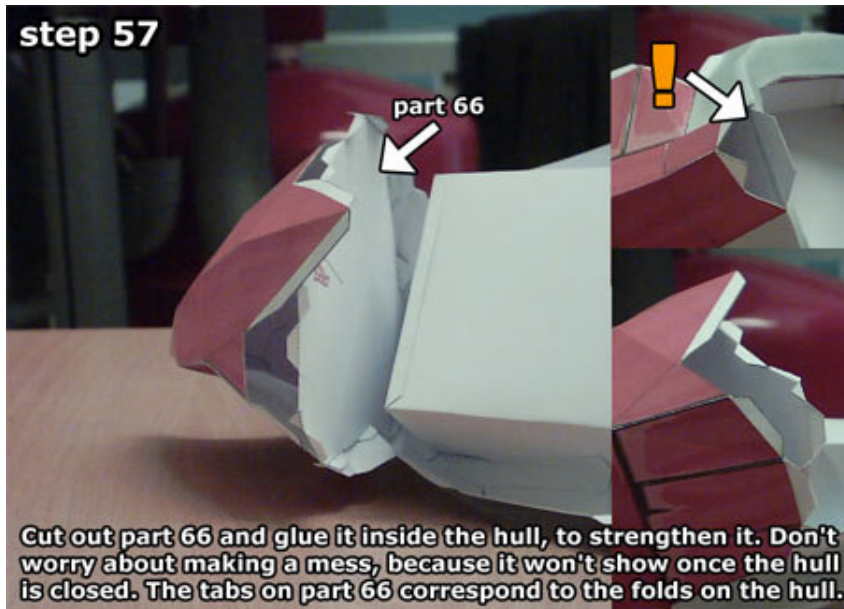

Cut out part 66 and glue it inside the hull, to strengthen it. Don't worry about making a mess, because it won't show once the hull is closed. The tabs on part 66 correspond to the folds on the hull.



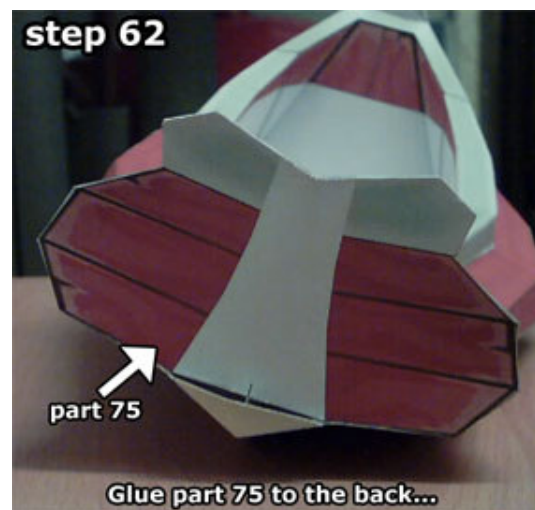
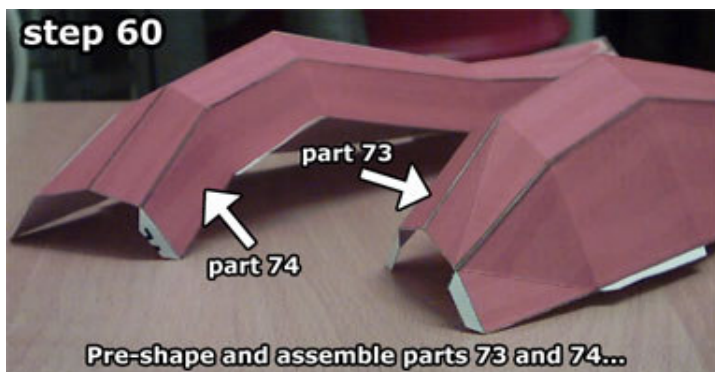
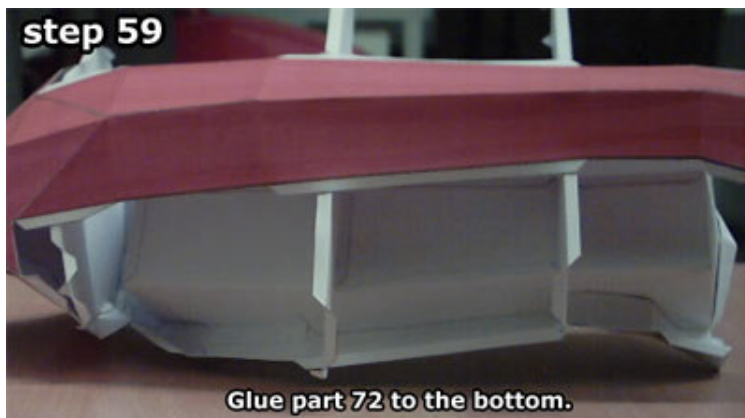
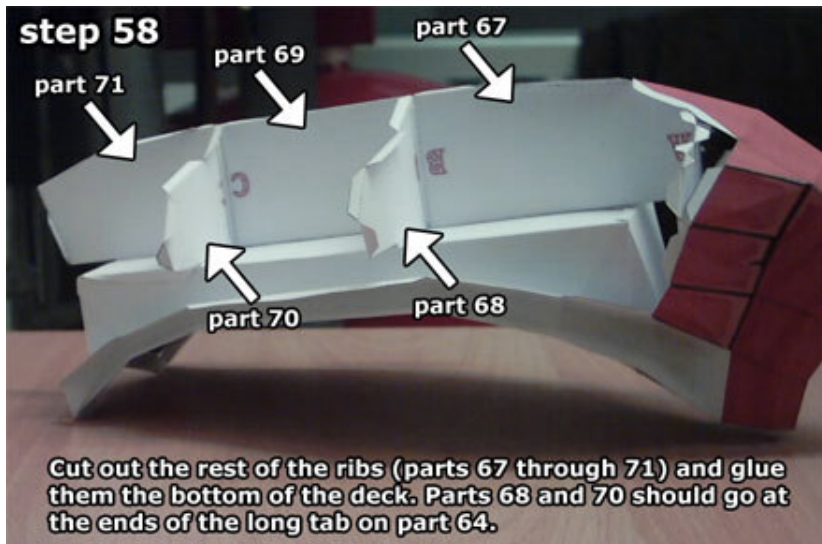

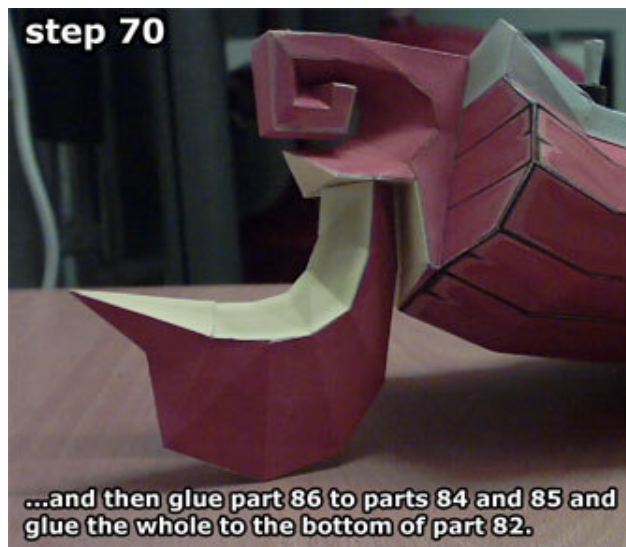
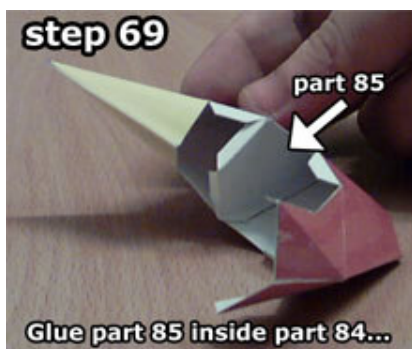
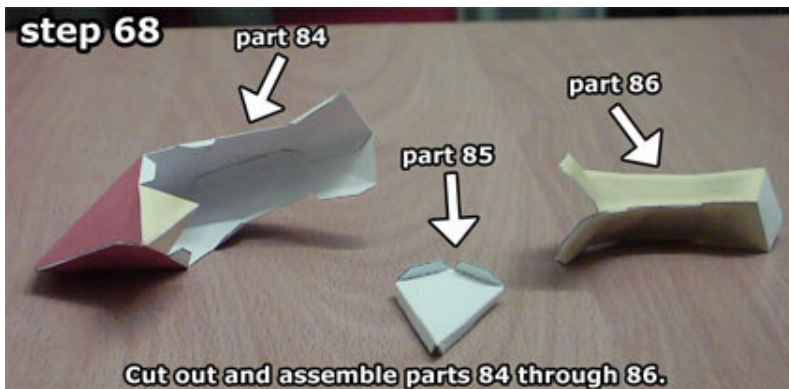
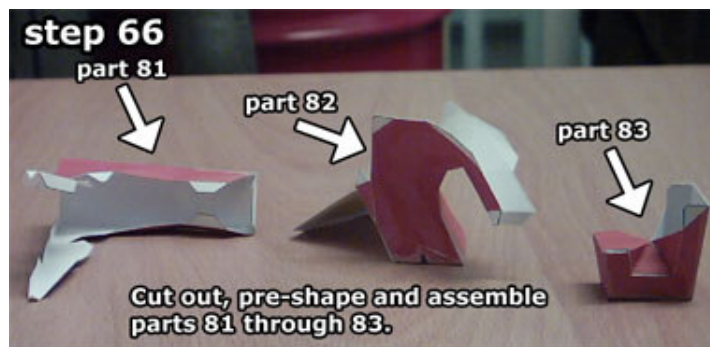
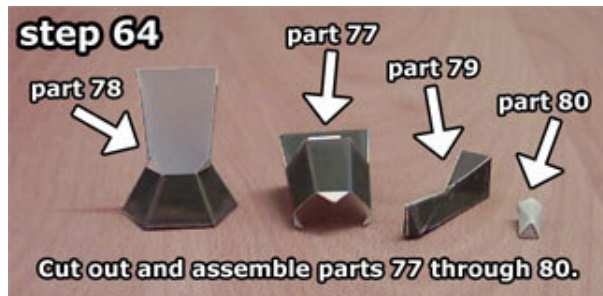
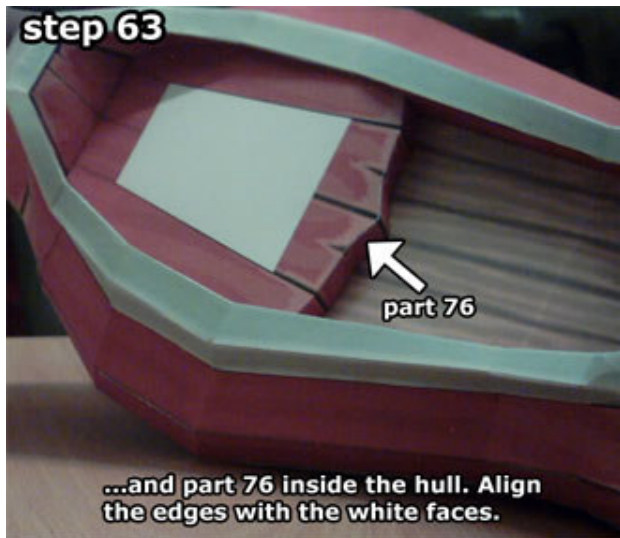



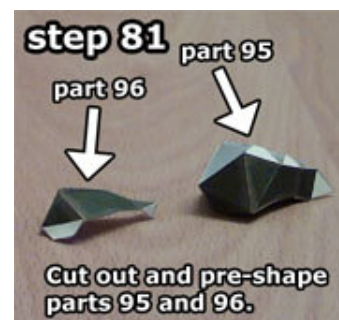
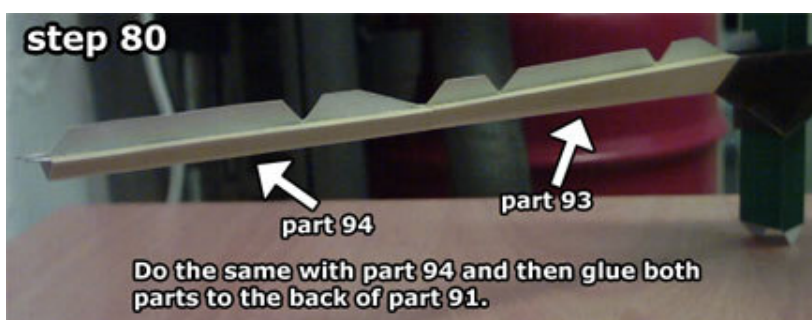
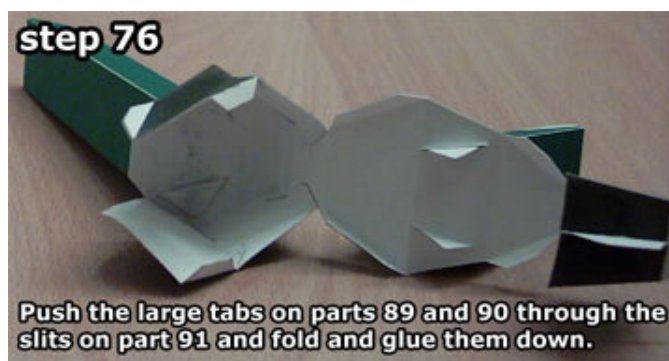
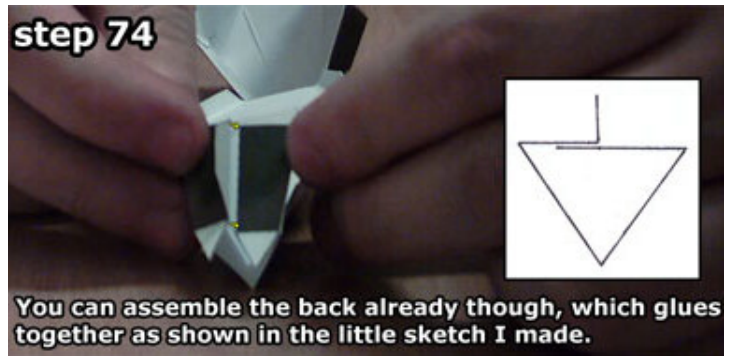
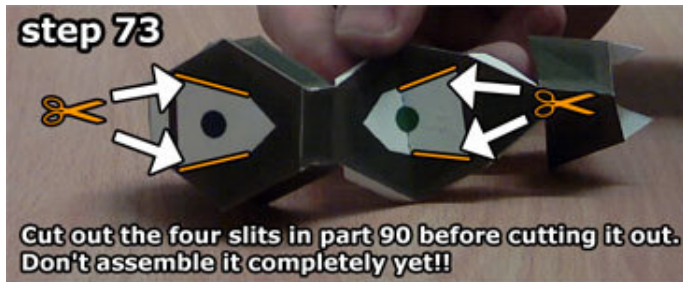
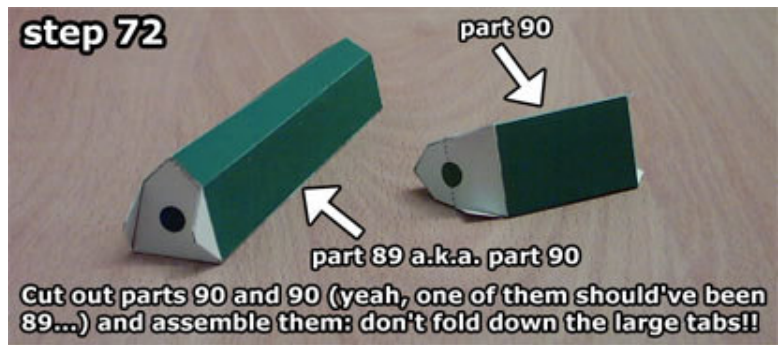
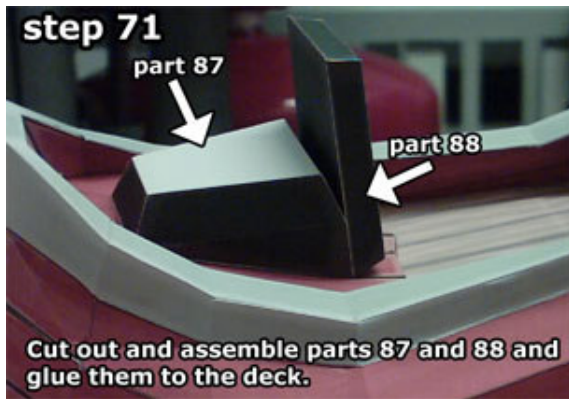

### step 82



Glue them together and glue the whole to the end of part 94.

### step 83

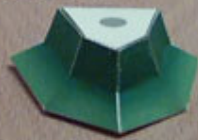

Cut out and assemble part 97.

### step 84



Slide the large tabs on part 90 through the open sides on part 97 and glue the whole together.

### step 85

part 98



part 99 (wrong side up here!!)



I accidentally glued part 99 upside down here: don't make the same mistake!! Apply some pressure (not too much of course) to the top and bottom of part 98, so they'll stick to part 99 inside.

### step 86



Now glue part 98 to the bottom of part 97.

### step 87

part 100

part 101



Now cut out parts 100 and 101 and glue them to the rest of the mast like you did with part 97. Don't forget to cut the slit on part 101 and don't close its top yet!!

### step 88



Assemble part 102 and glue it to the white faces on part 100, but don't wrap it entirely around the mast yet: leave one section for later.



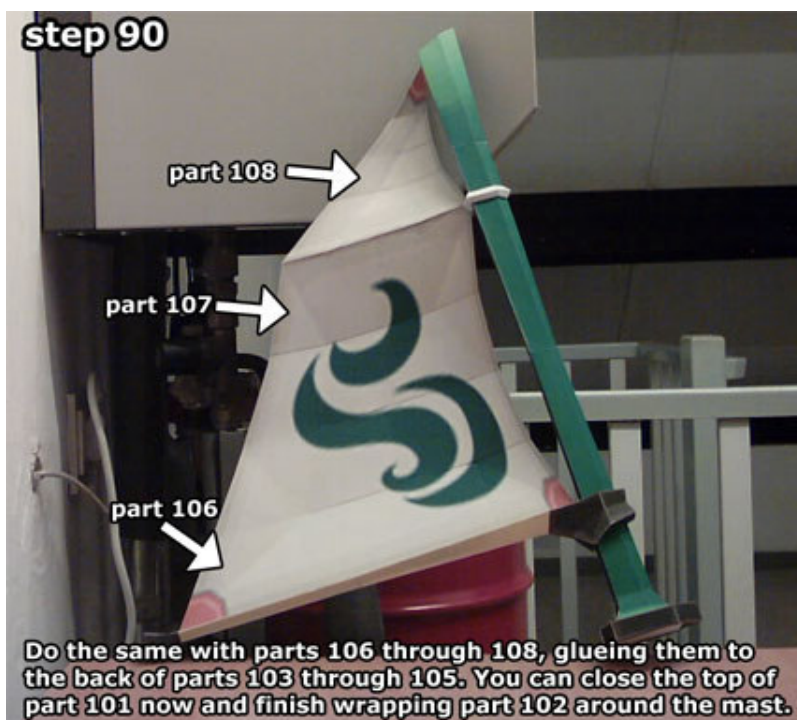
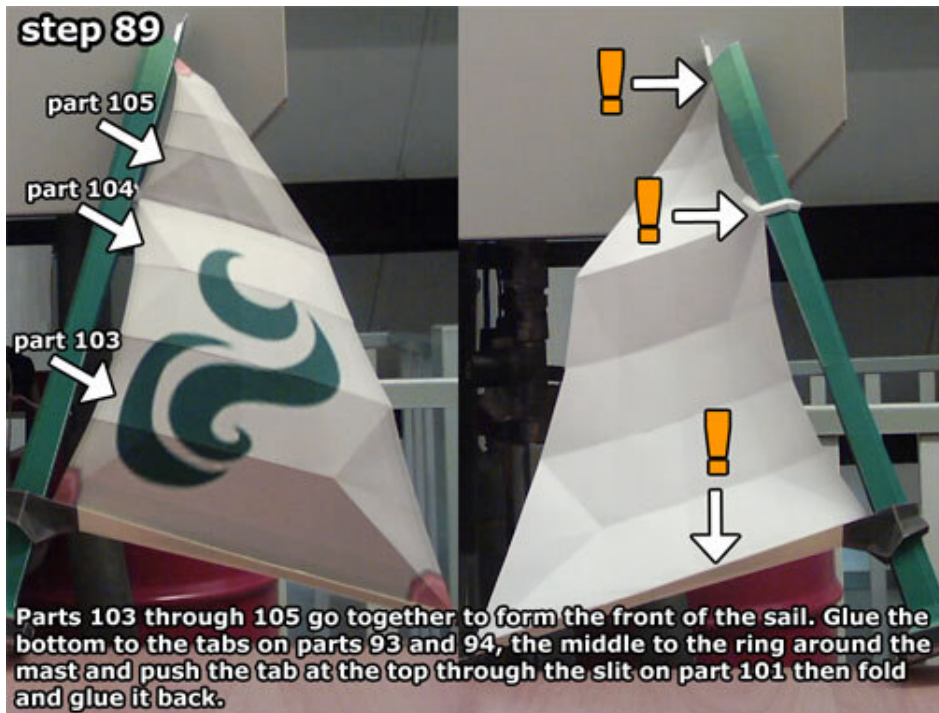

**step 93**



**Thank you for downloading and building a Ninjatoes' paper model!!**

<http://members.home.nl/saarloos/>