

CREATIVE PARK

<http://www.canon.com/c-park/>



View of completed model

Before starting assembly:

Writing the number of each section on its back side before cutting out the sections is highly recommended.
(* This way, you can be sure which section is which even after cutting out the sections.)

→ Indicates where sections should be glued together.
Indicates sections that should be glued first, then cut out.

* This model was designed for Papercraft and may differ from the original in some respects.

■ Assembly Instructions: Twenty-four US letter sheets (No. 1 to No. 24)

* Build the model by carefully reading the Assembly Instructions, in the parts sheet page order.

*Hint: Trace along the folds with a ruler and an exhausted pen (no ink) to get a sharper, easier fold.

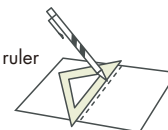

Assembly Instructions



Mountain fold (dotted line)

Make a mountain fold.



Valley fold (dashed and dotted line)

Make a valley fold.



Scissors line(solid line)

Cut along the line.



Cut in line(solid line)

Cut along the line.

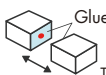

Glue

The glue spot(colored dot)
shows where to apply the glue.

● Glue spot(Red dot)

Glue parts with the same number together.

● Glue spot(Green dot)

Glue within the same part.

● Glue spot(Blue dot)

Glue to the rear of the other part.

Tools and materials



Scissors, set square, glue(We recommend stick glue), pencil, used ballpoint pen, toothpicks, tweezers, (useful for handling small parts)

Assembly tip



Before gluing, crease the paper along mountain fold and valley fold lines and make sure rounded sections are nice and stiff.

Caution



Glue, scissors and other tools may be dangerous to young children so be sure to keep them out of the reach of young children.

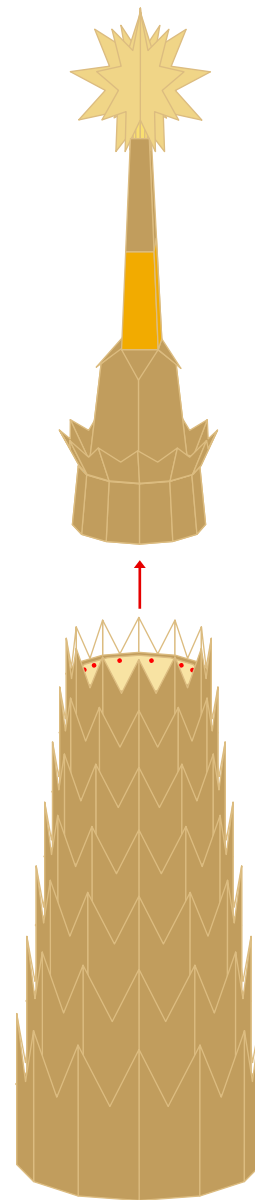
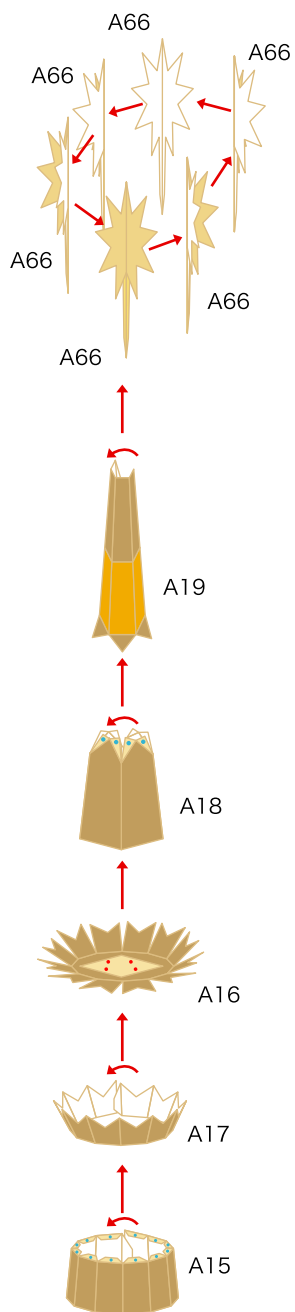
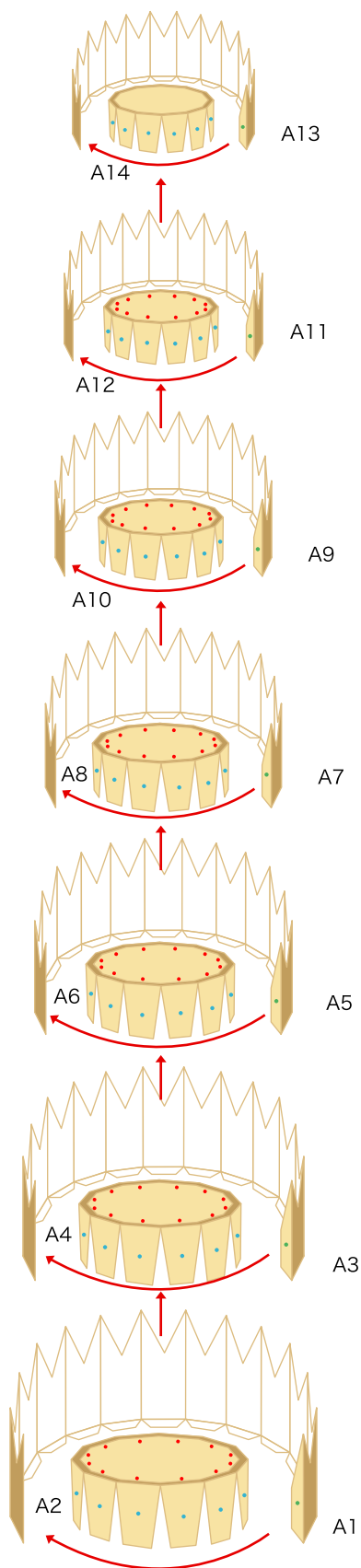

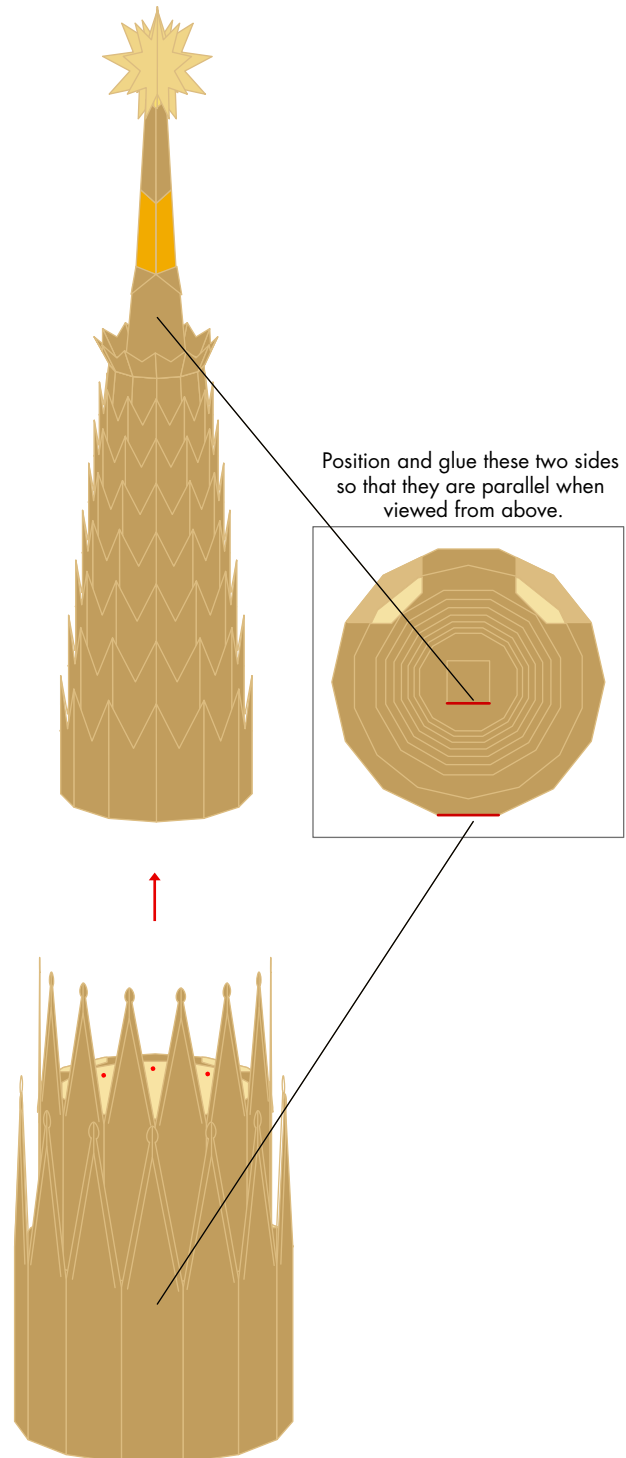
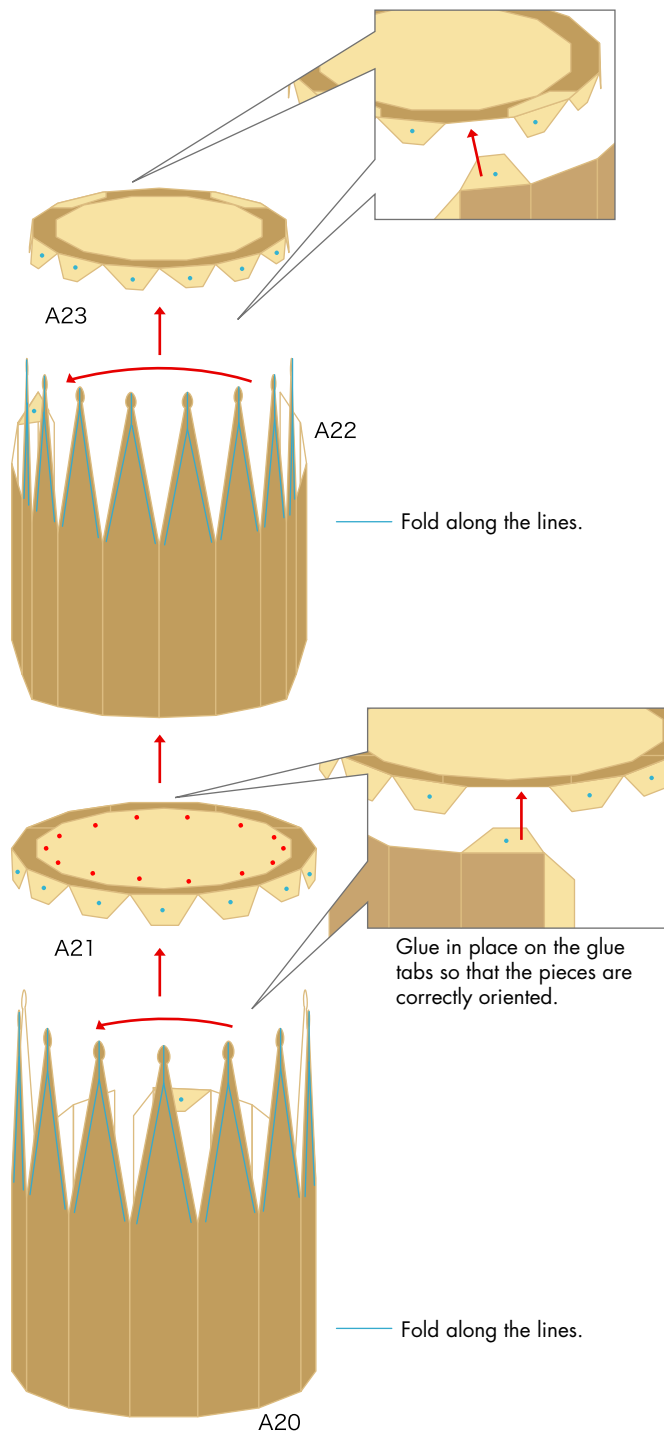

A. Tower of the Virgin Mary/Tower of Jesus Christ/Crossing

© Canon Inc. © T. Ichiyama

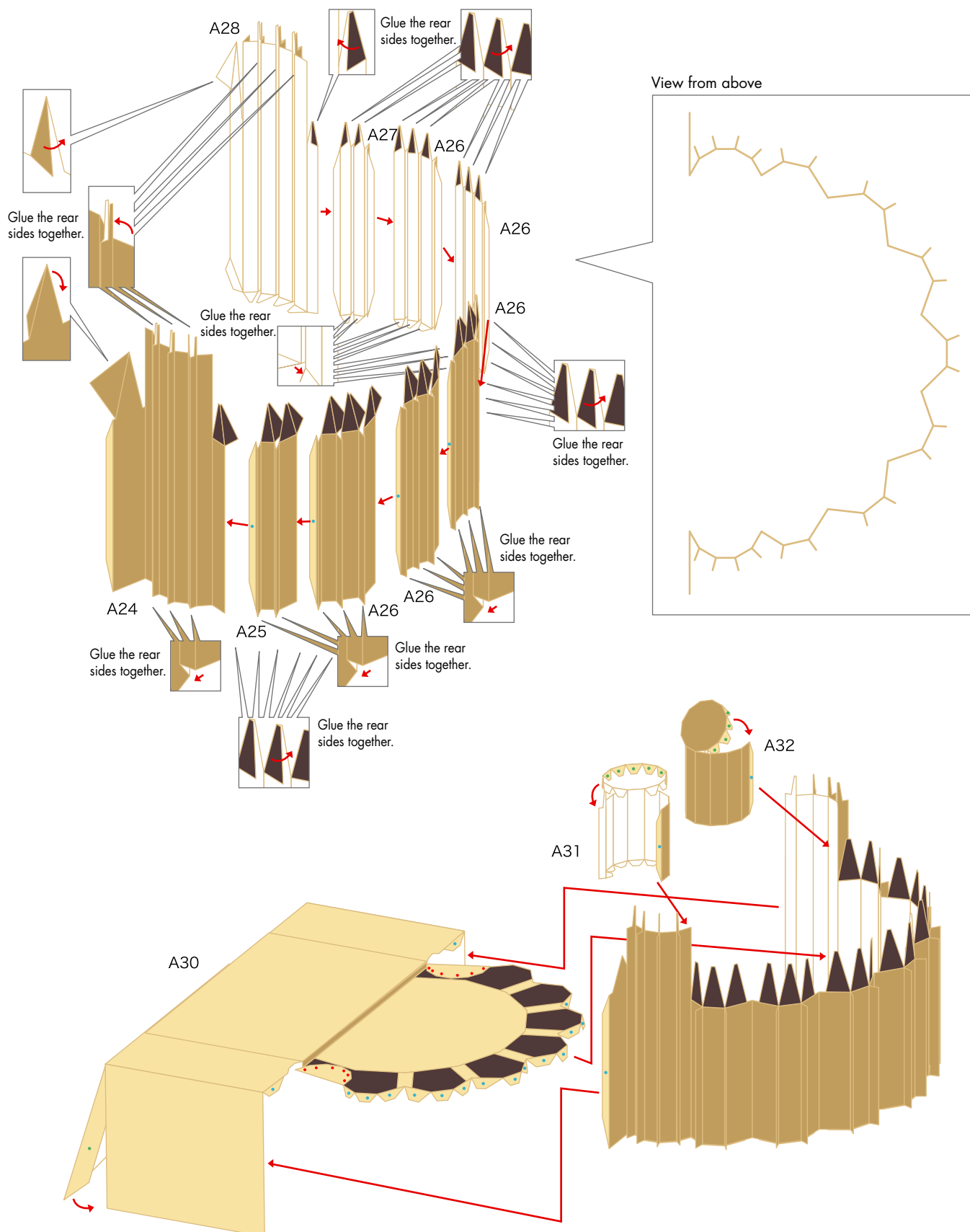

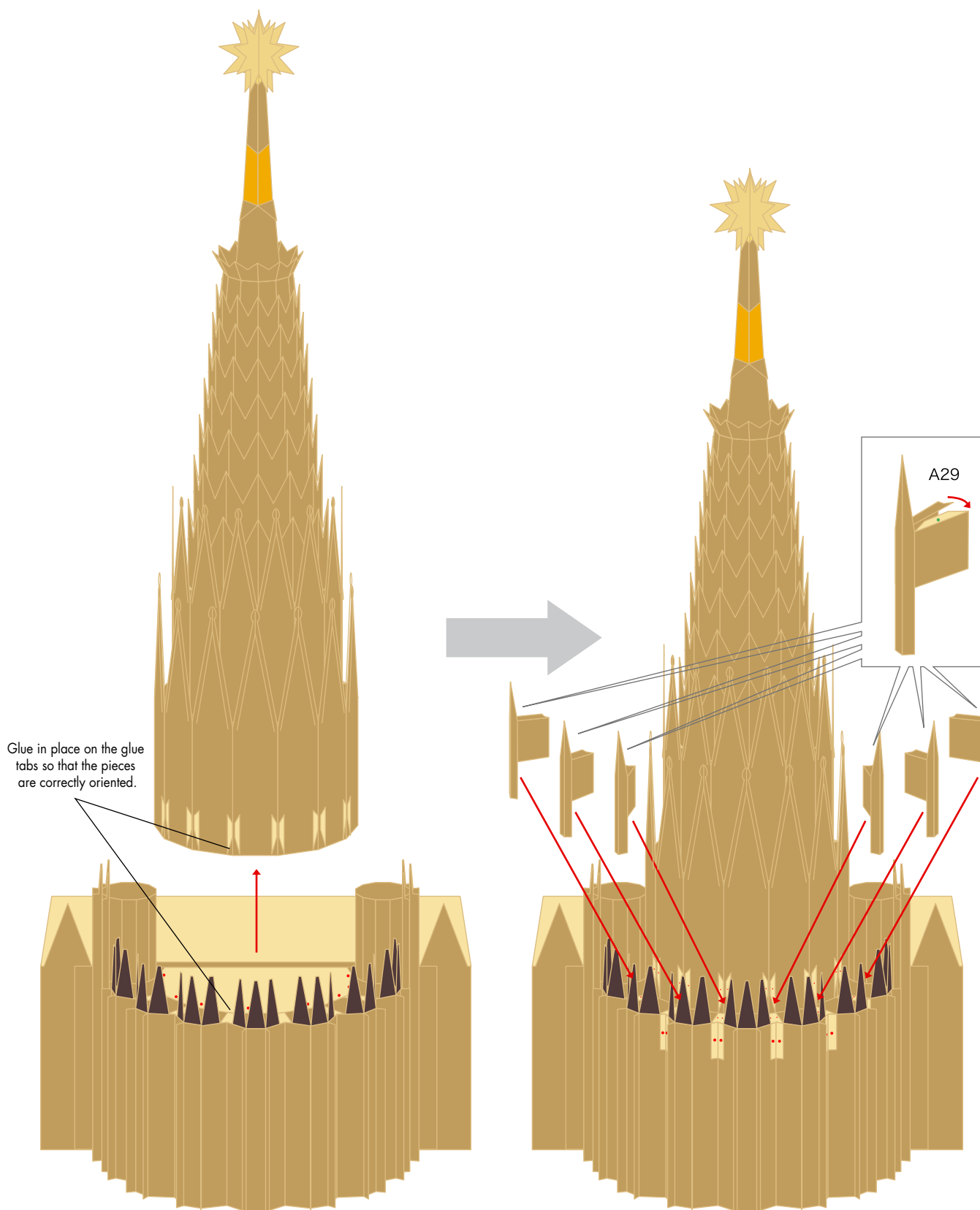

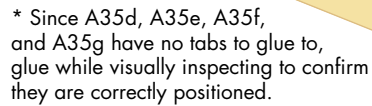

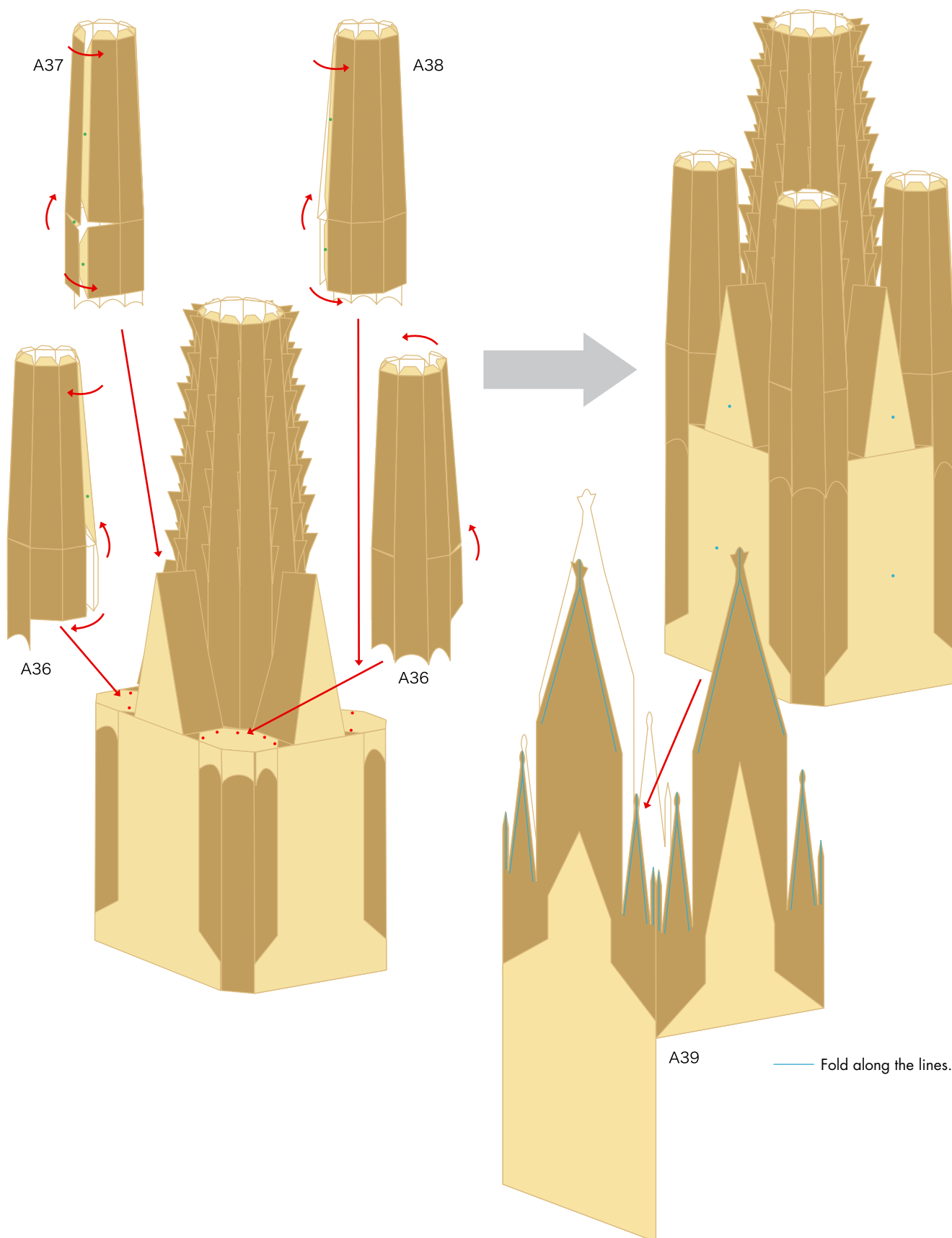

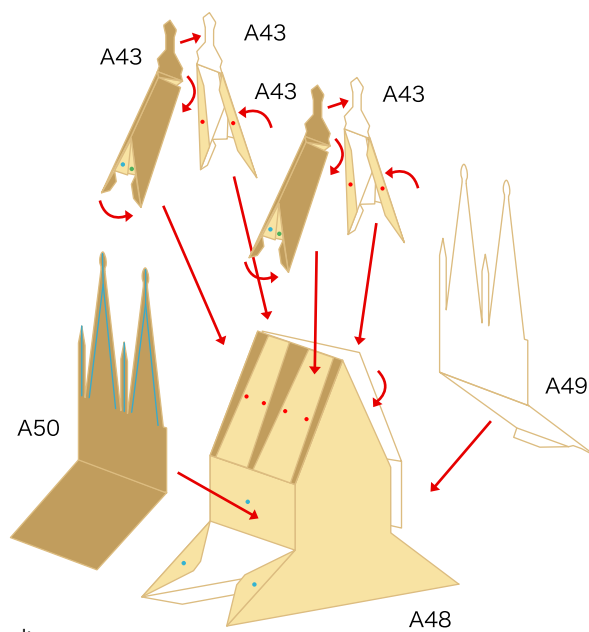
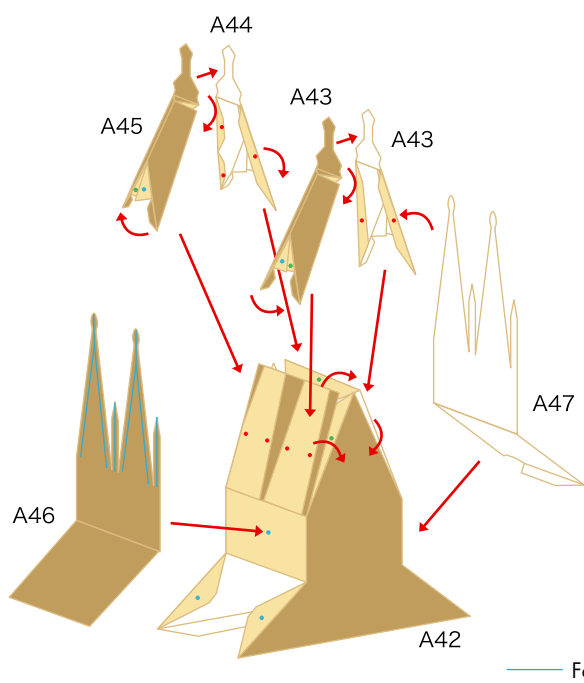
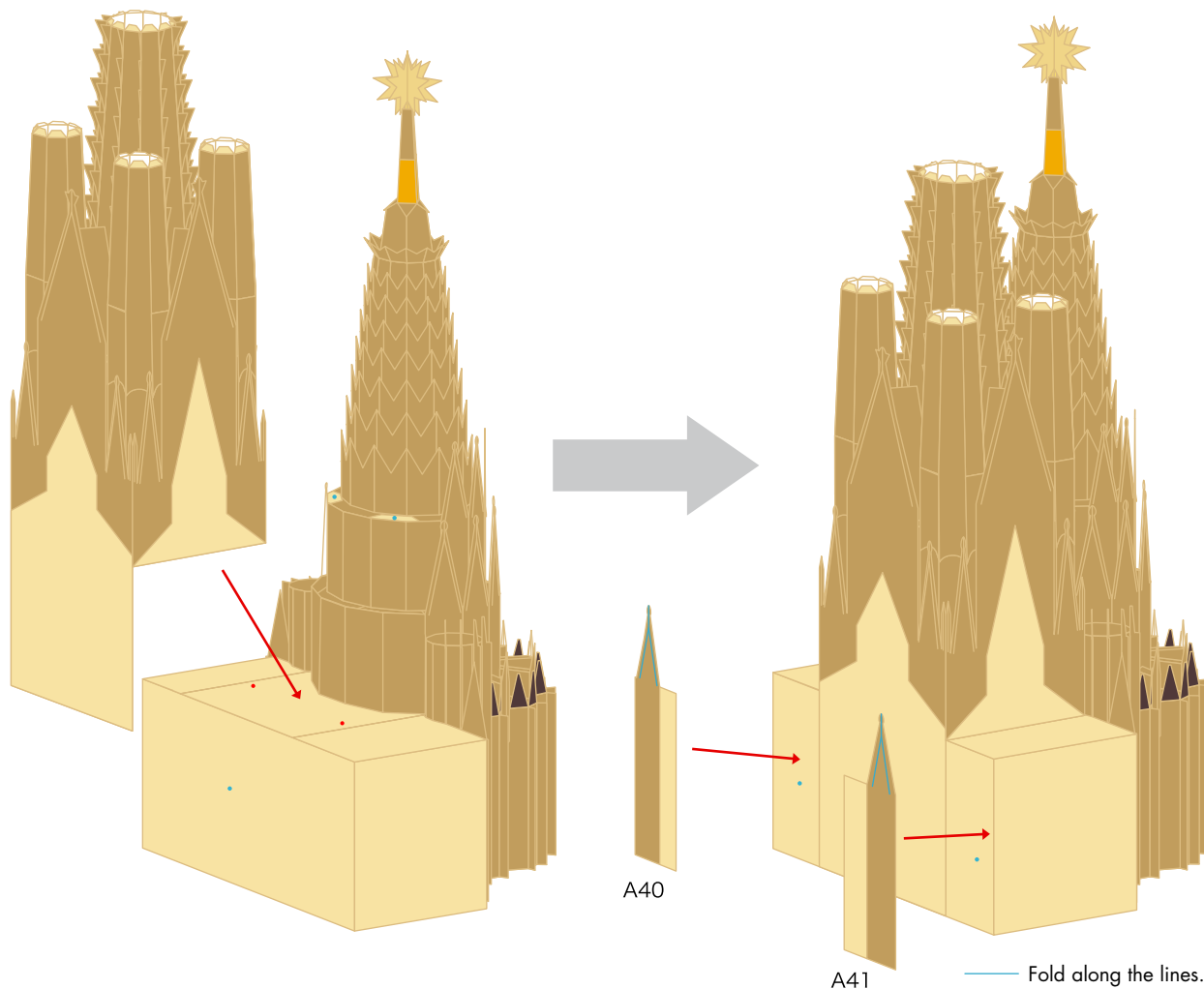

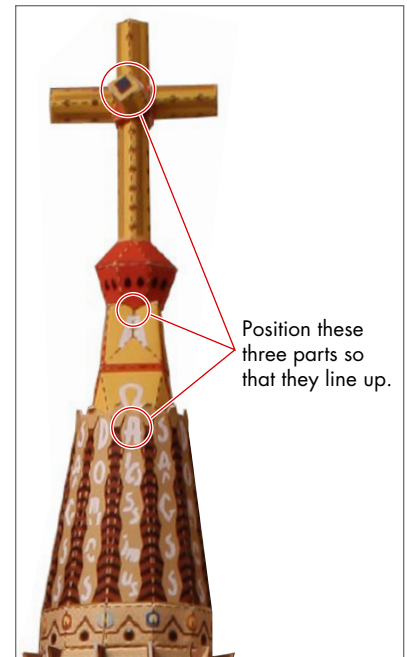
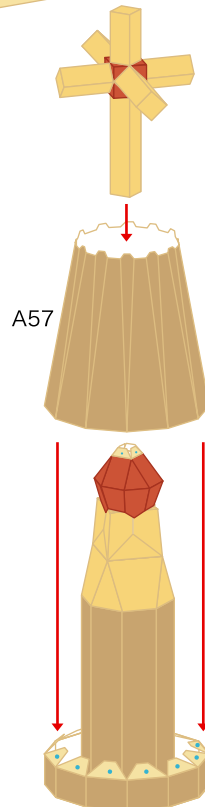
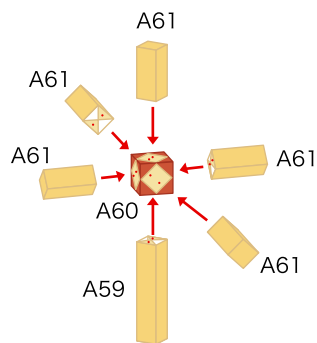
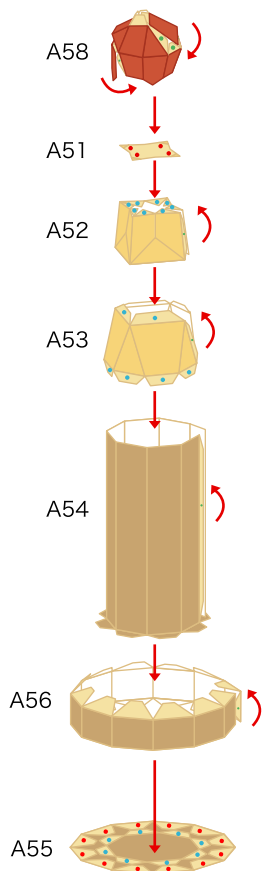
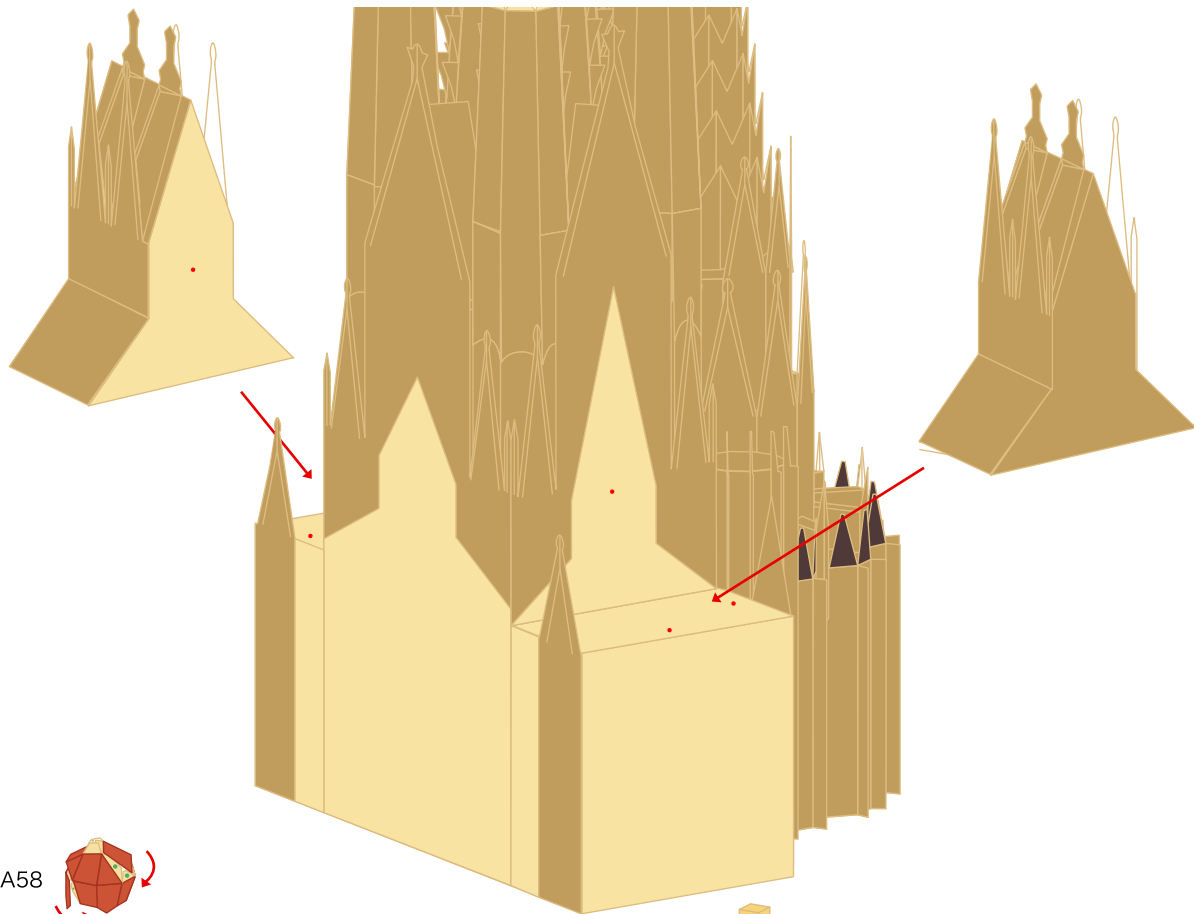

A. Tower of the Virgin Mary/Tower of Jesus Christ/Crossing

© Canon Inc. © T. Ichiyama

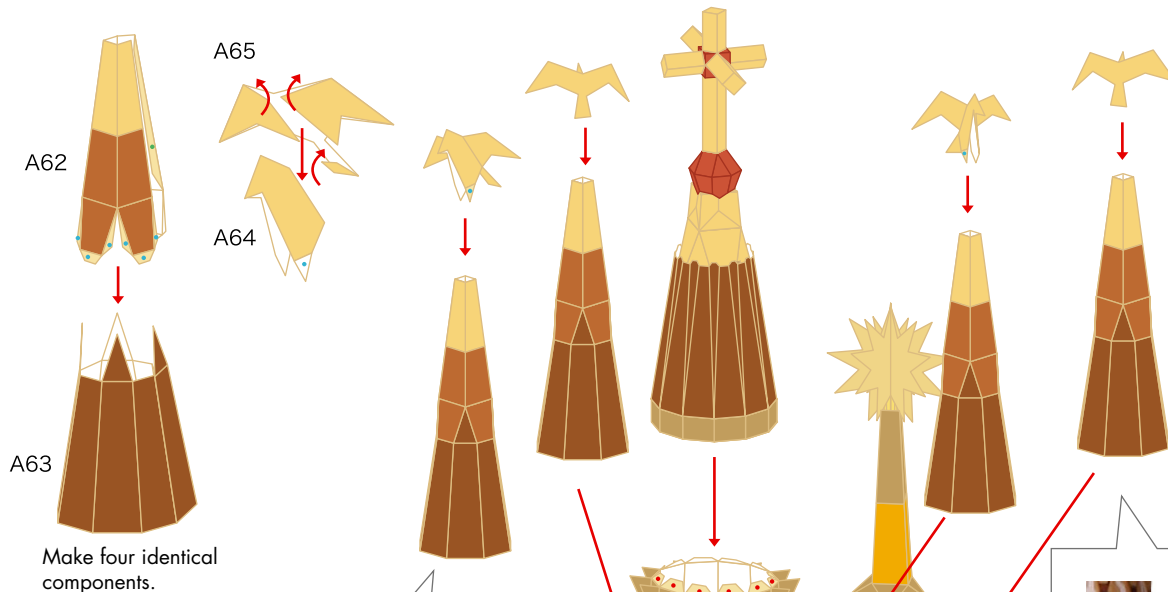

Glue in place so that the cross is at right angles to the building when viewed from above and the birds are positioned diagonally to it at 45° angles.



Position so that this pattern is located at the front of the model.

B. Chapel of the Assumption/sacristy/corridor (north)

© Canon Inc. © T. Ichiyama

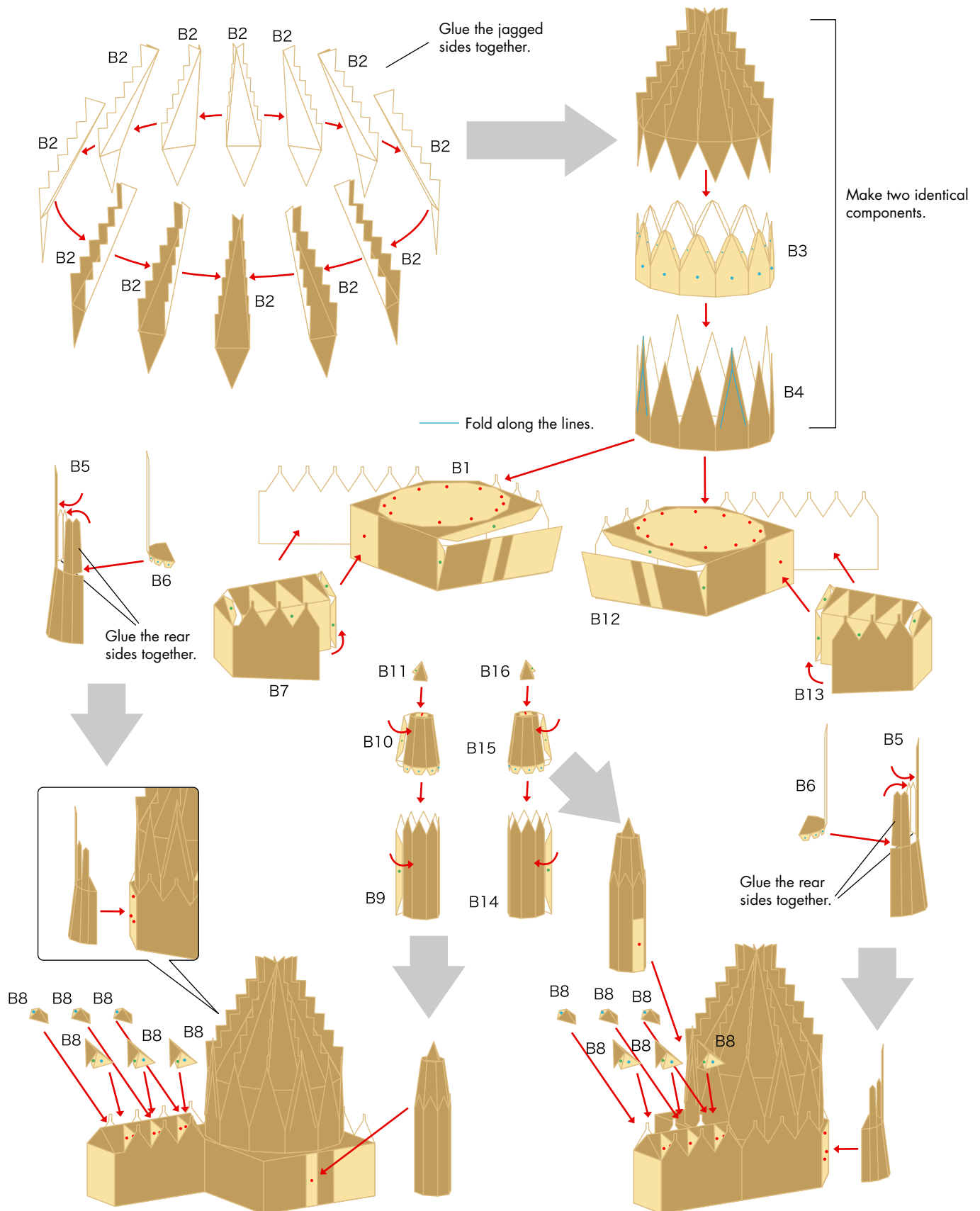

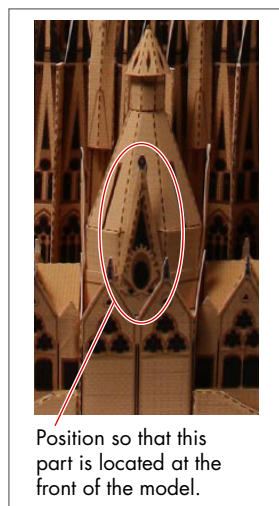

— Fold along the lines.

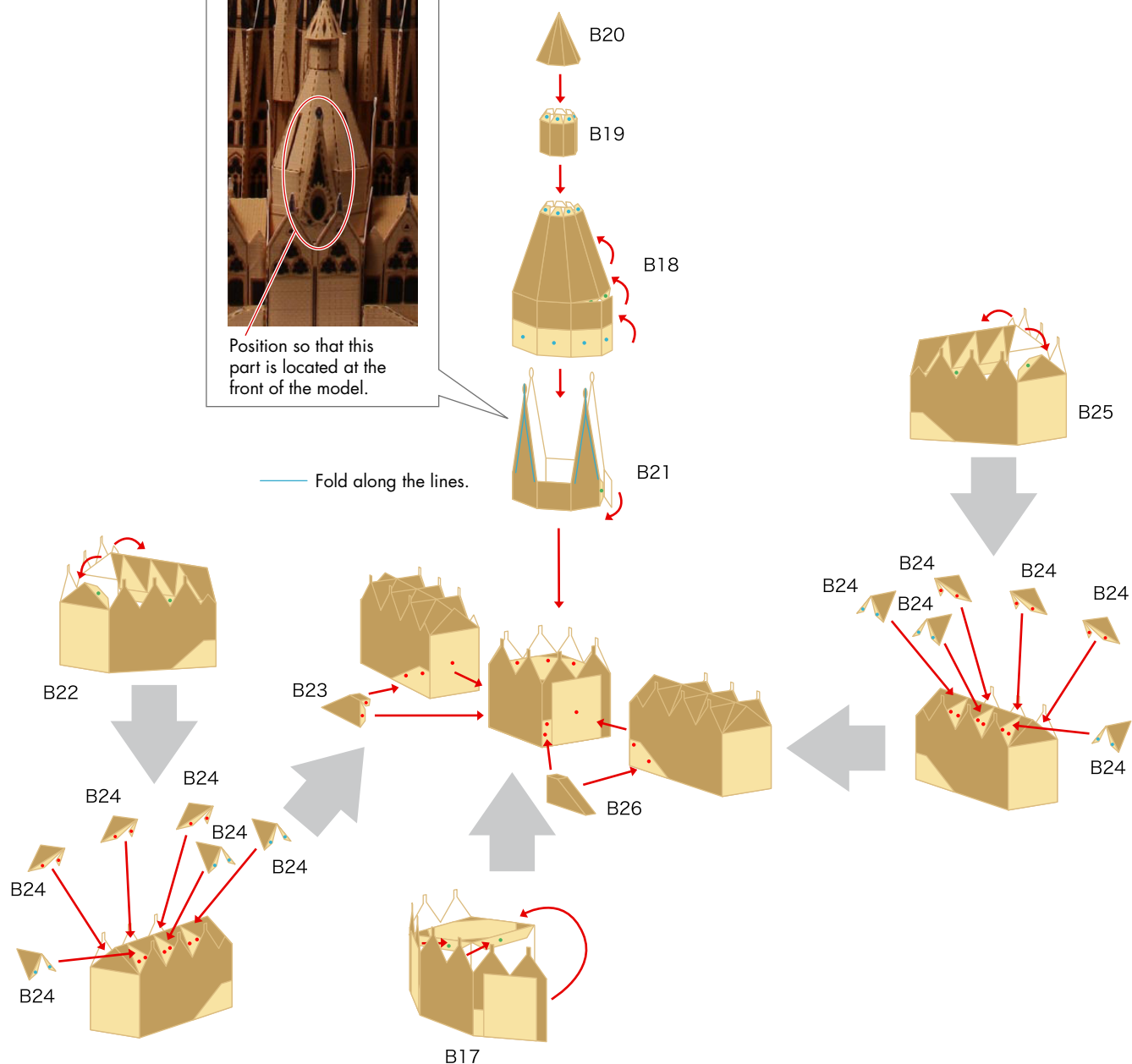

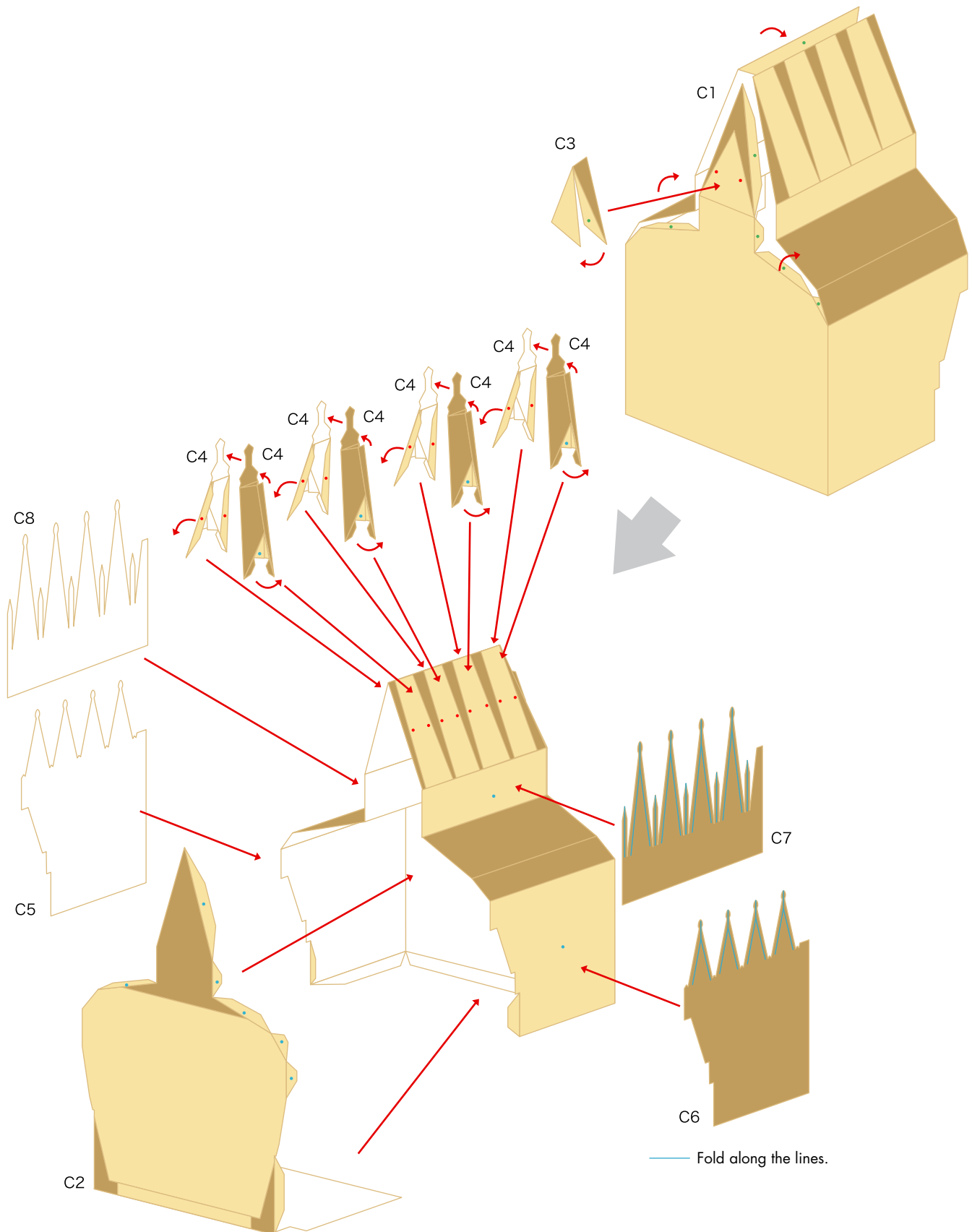

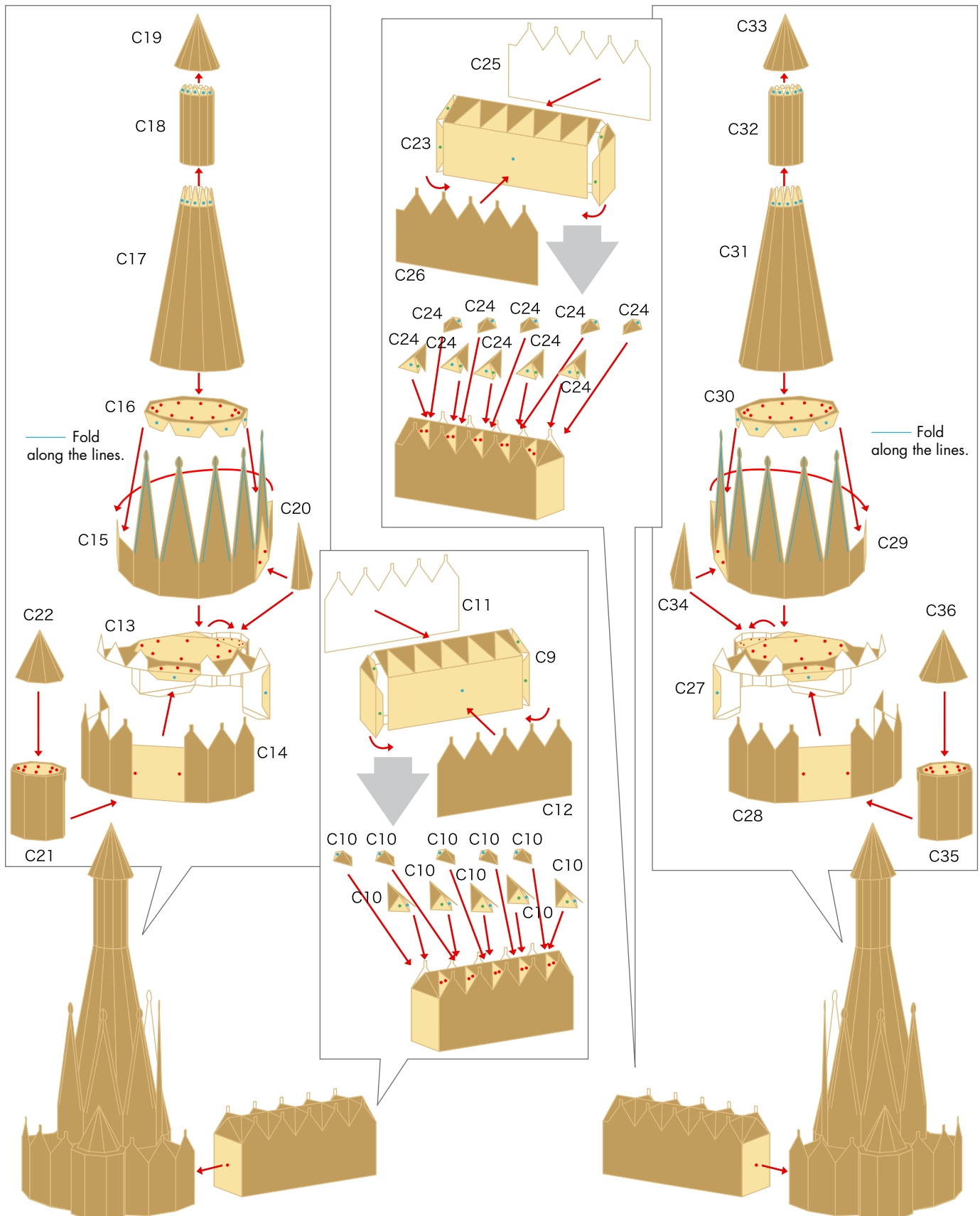

Sagrada Familia, Spain : Assembly Instructions

Canon

D. Glory Façade

© Canon Inc. © T. Ichiyama

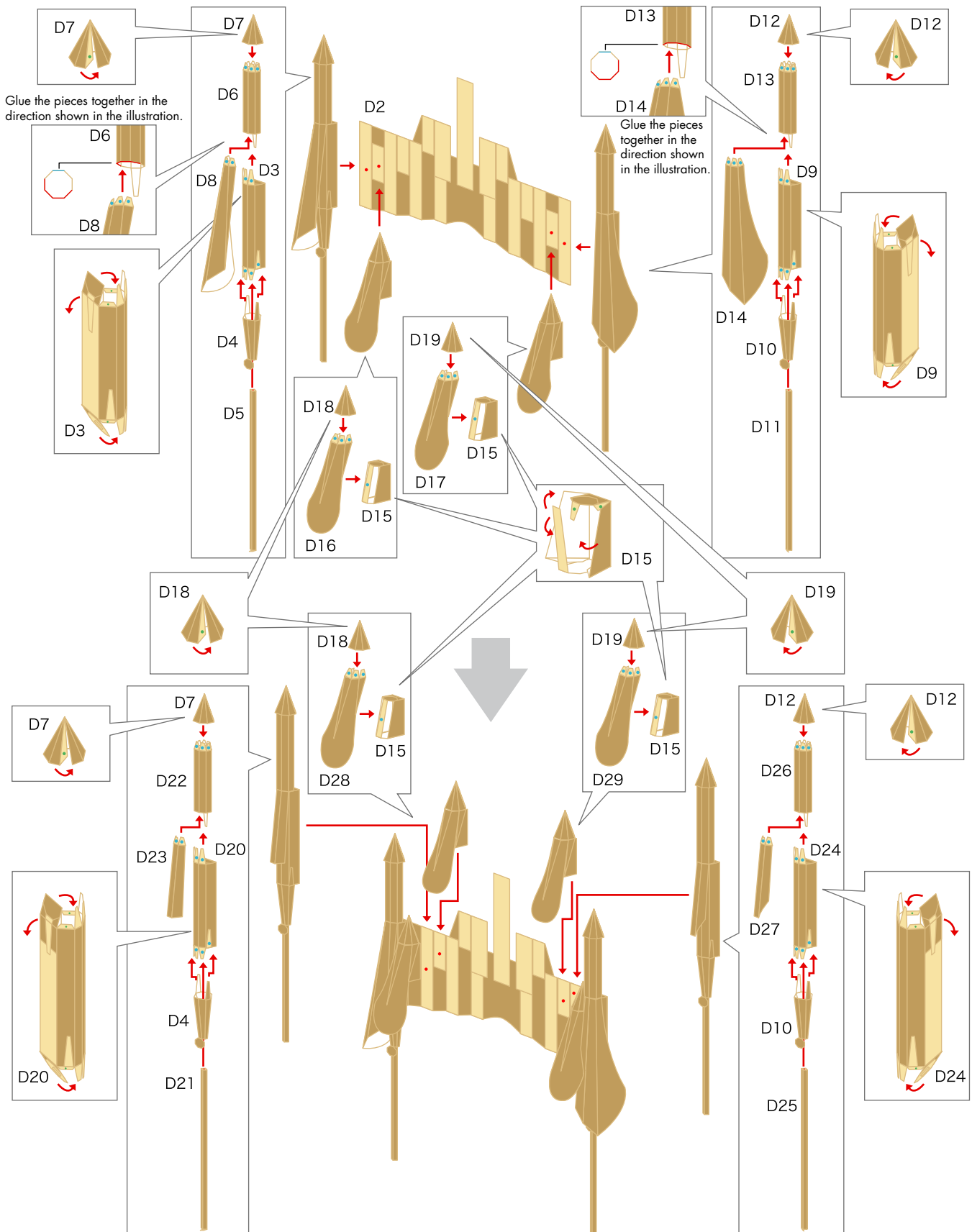

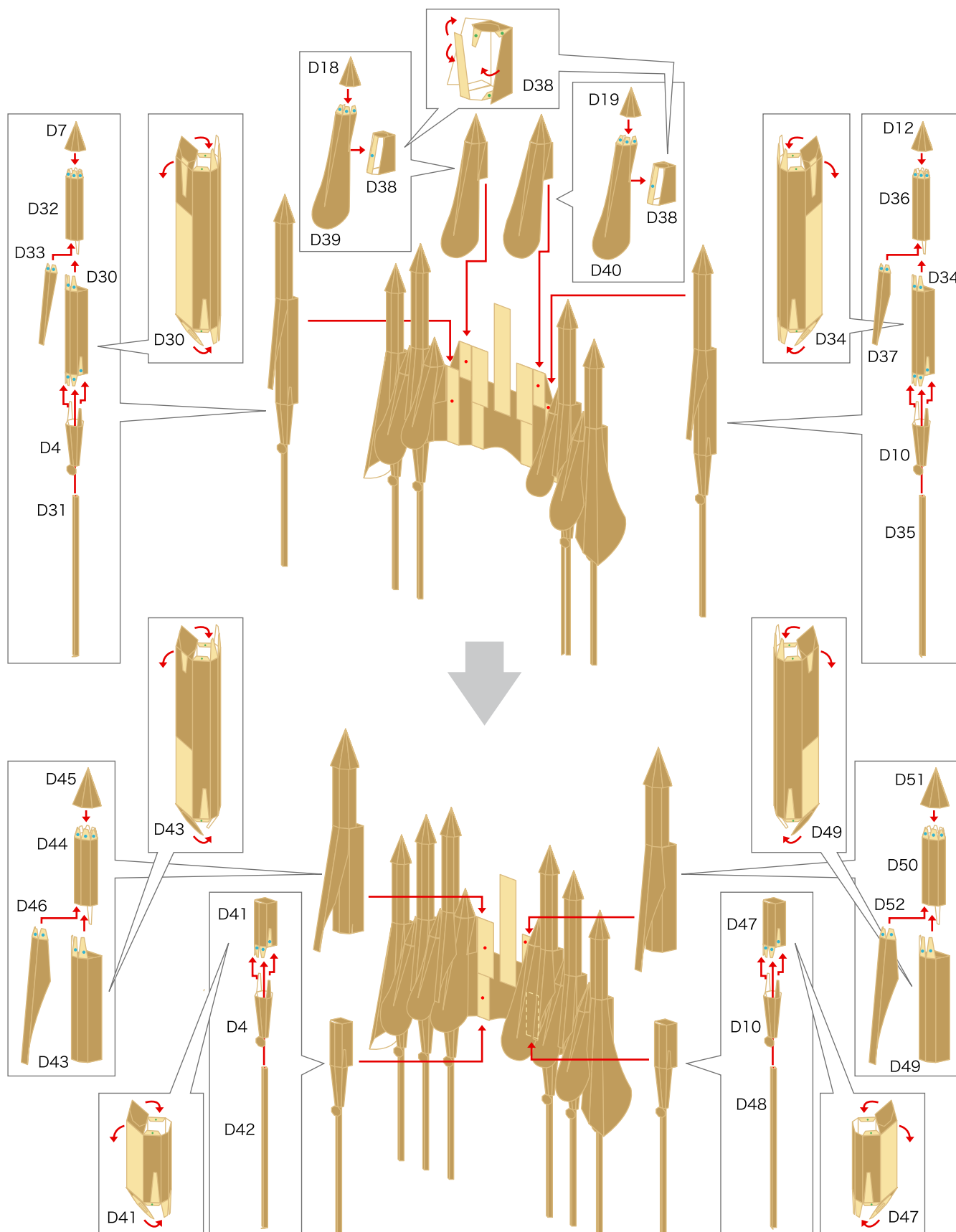

D. Glory Façade

© Canon Inc. © T. Ichiyama

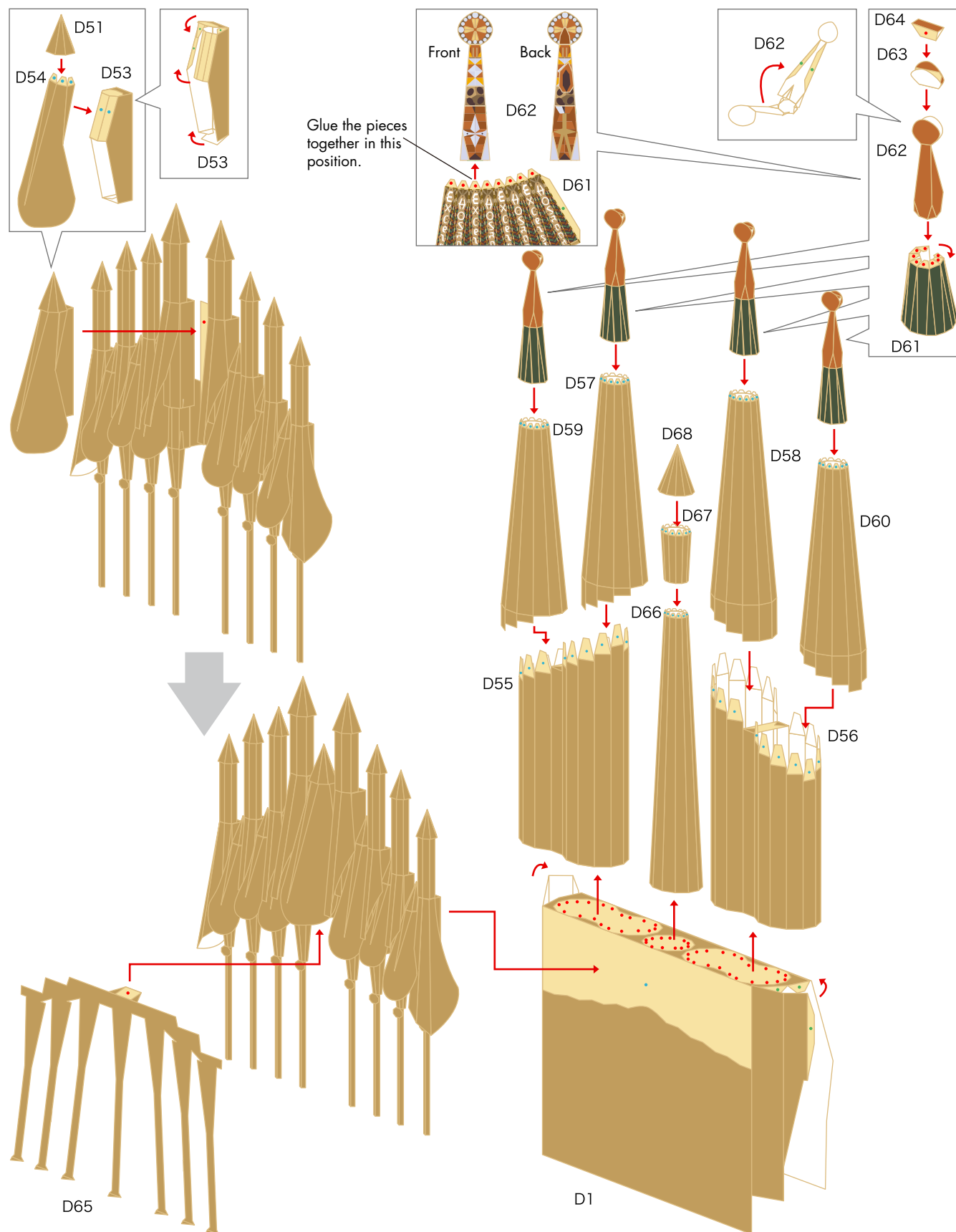

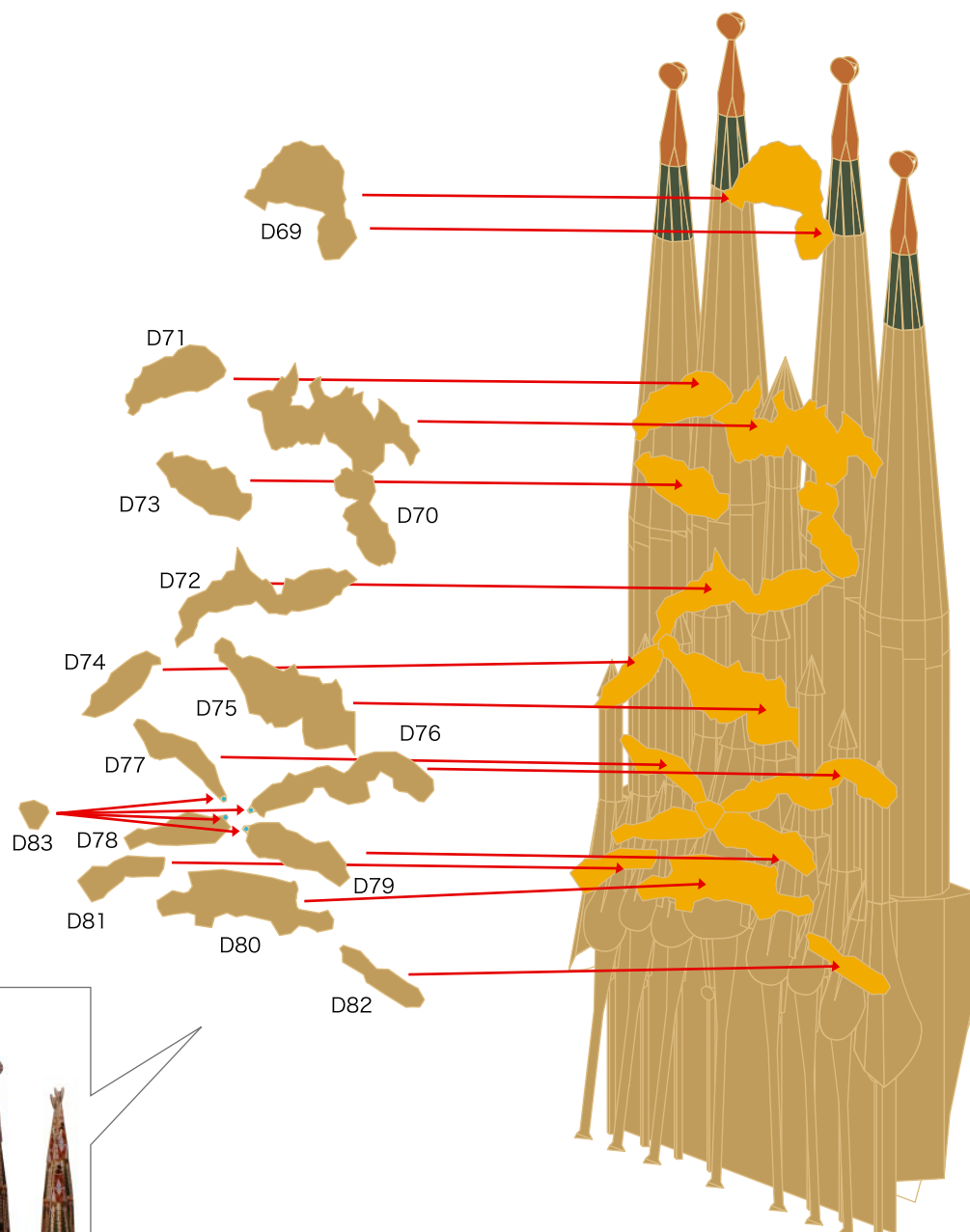

Assemble as shown
in the illustration.

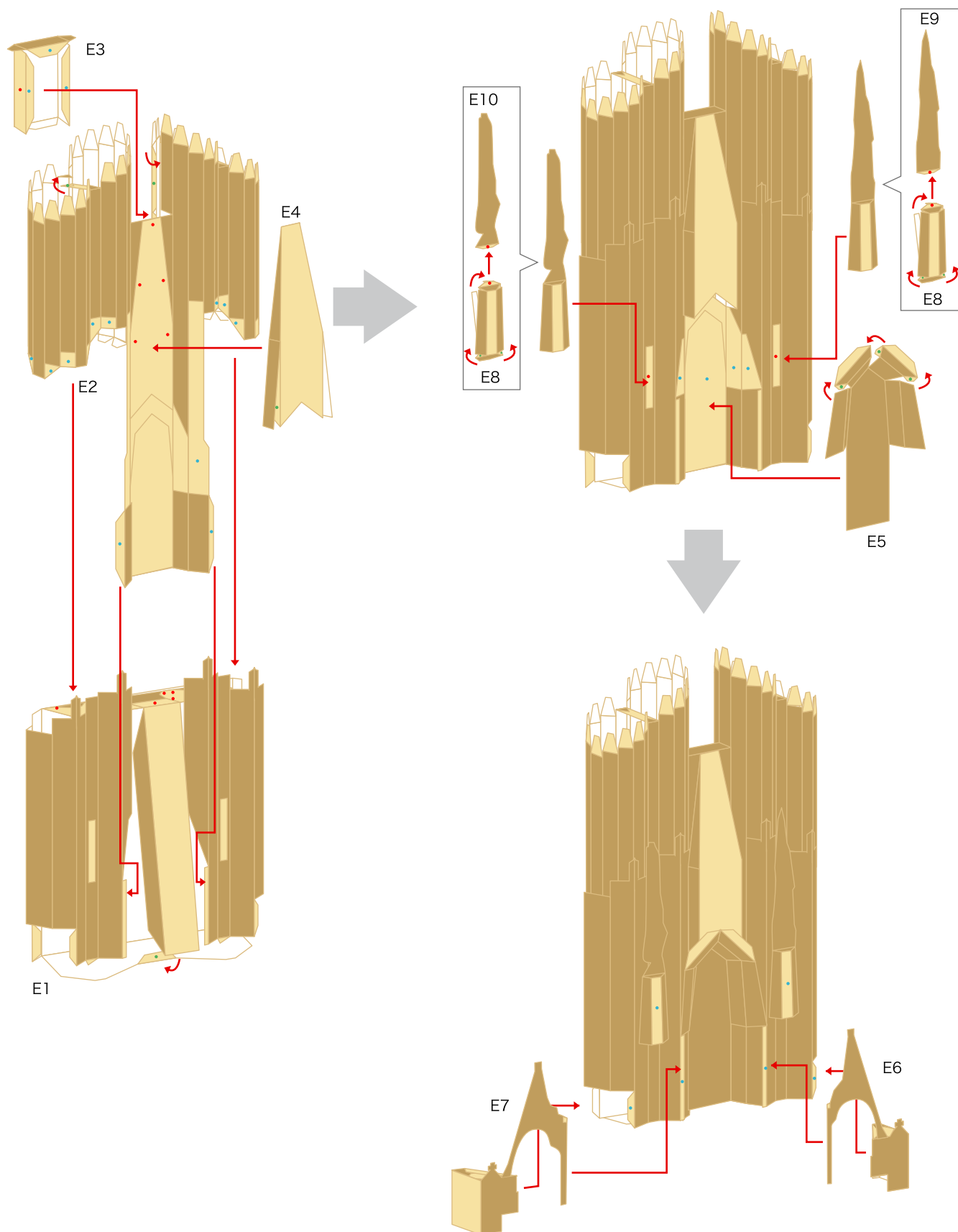

E. Nativity Façade

© Canon Inc. © T. Ichiyama

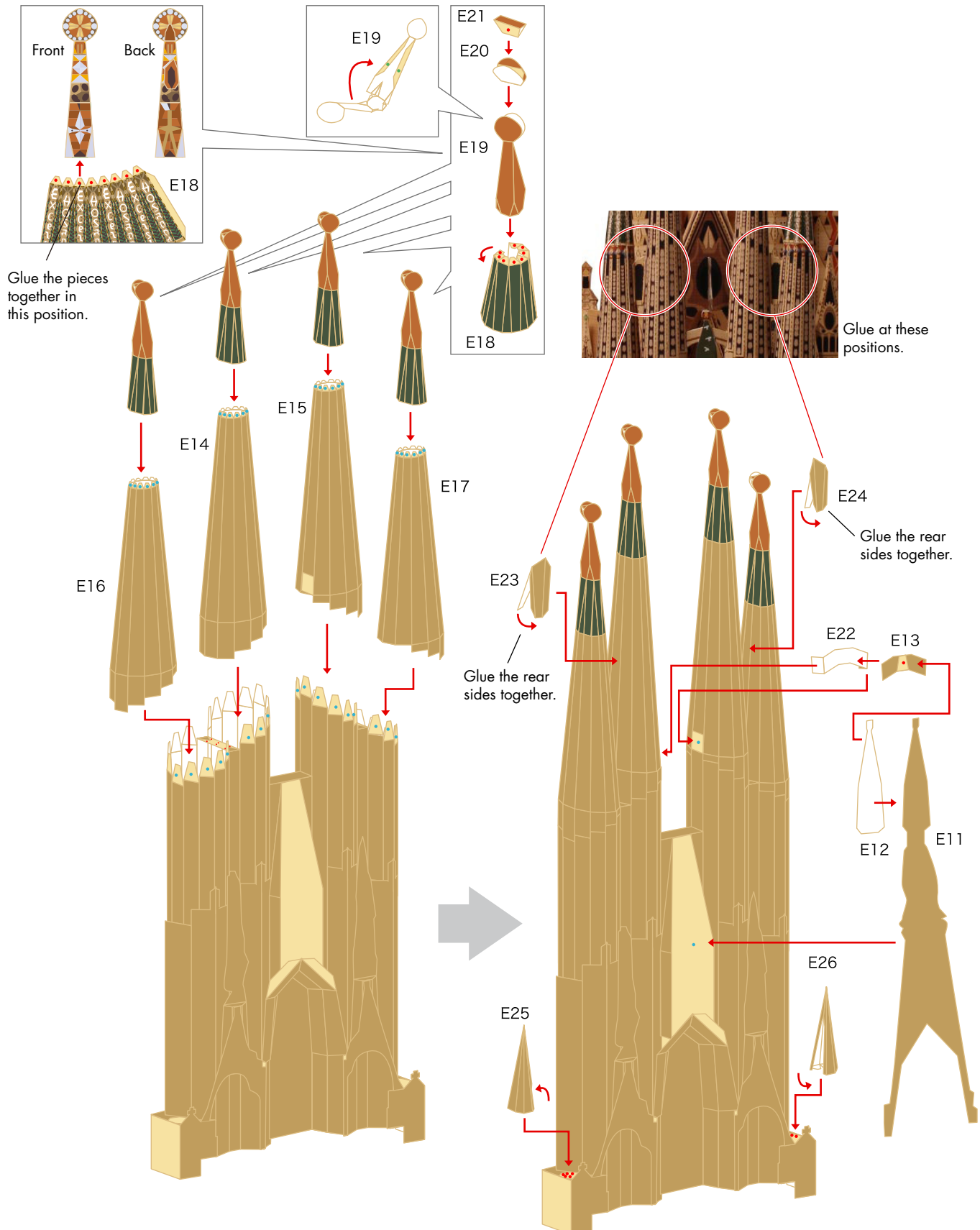

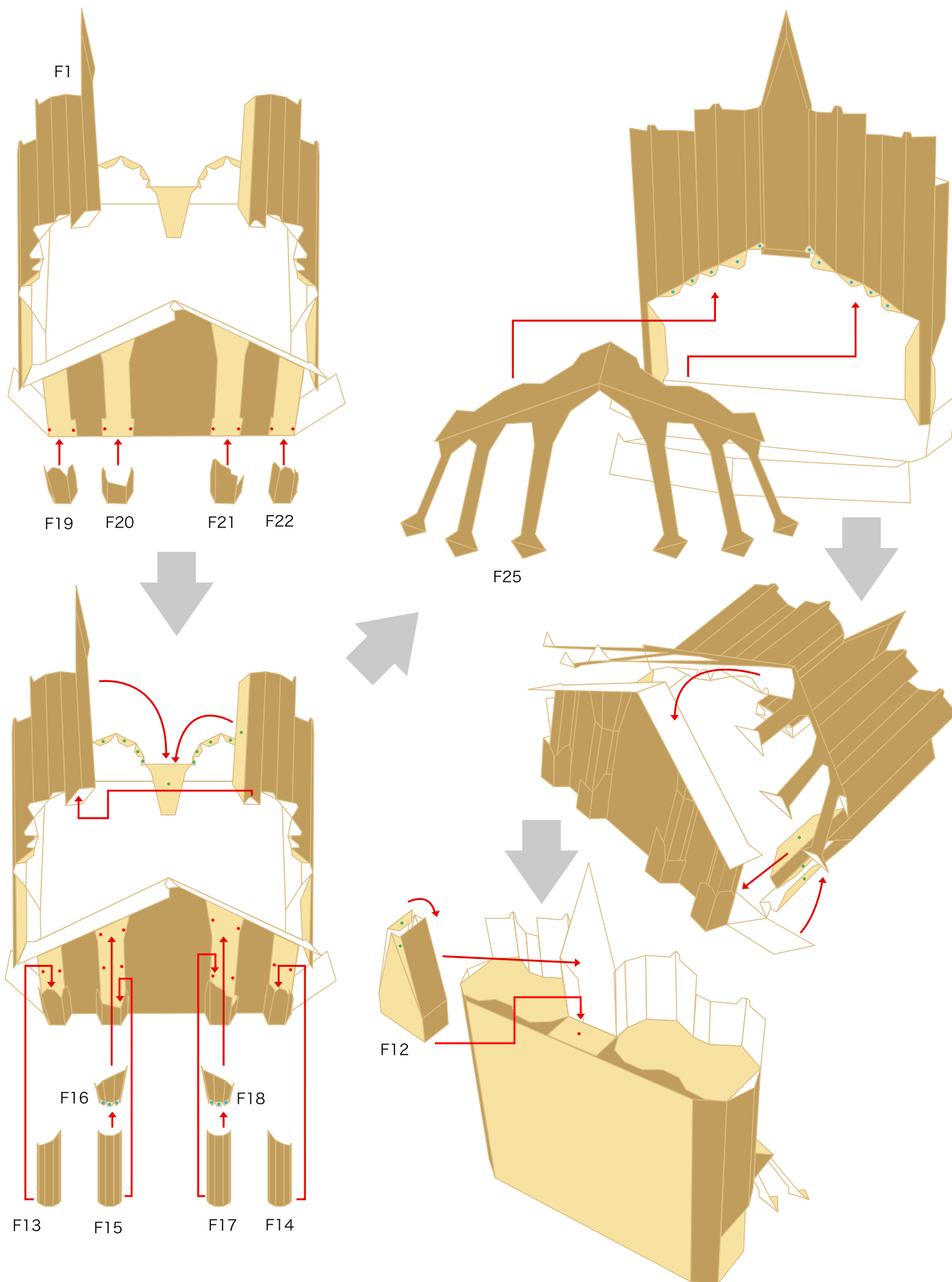

F. Passion Façade

© Canon Inc. © T. Ichiyama

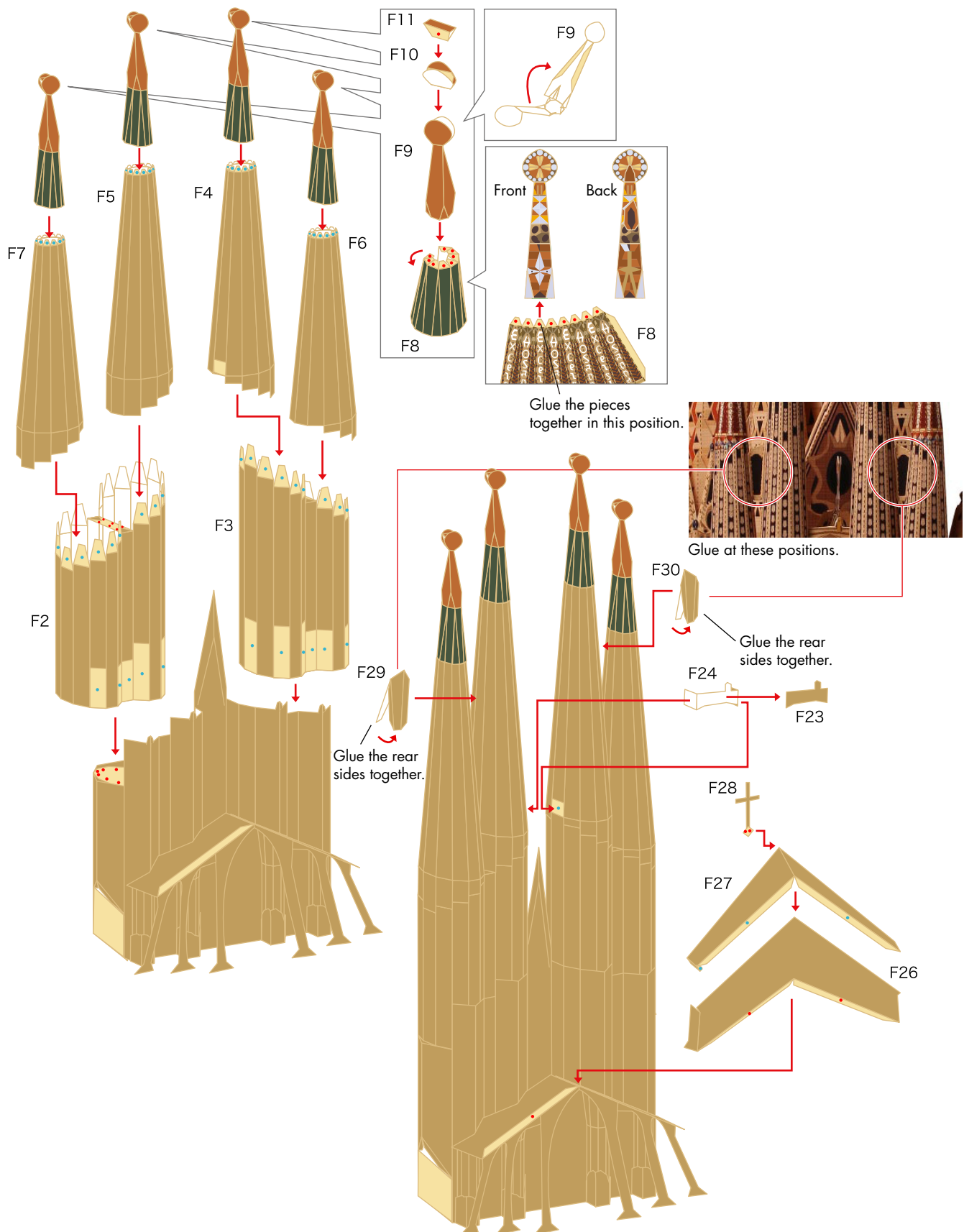

G. Stand

© Canon Inc. © T. Ichiyama

