

OOGIE BOOGIE PAPER-CRAFT INSTRUCTIONS

step 1

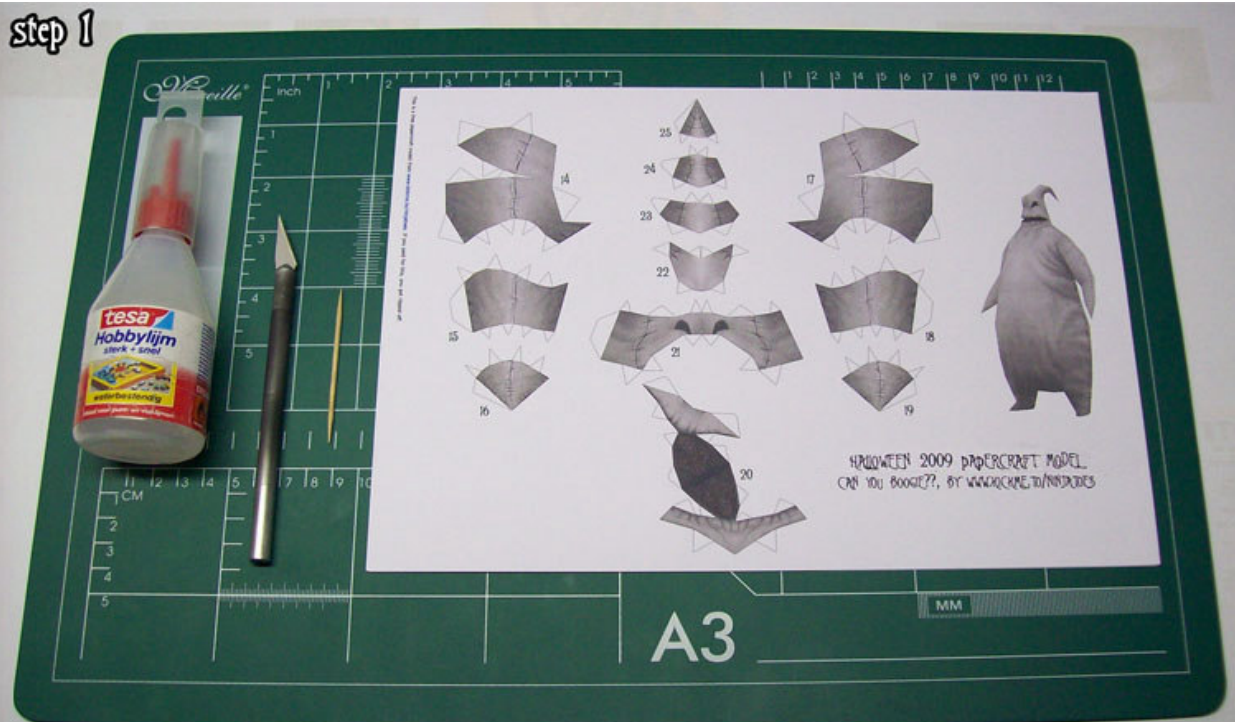

To build this papercraft model, all you need are the parts (preferably printed on thicker paper), a sharp knife or a pair of scissors and glue. A rubber cutting mat is highly recommended, and the toothpick is just there as an extra tool (the back of a spoon is also a useful tool to reach inside if your fingers prove to be thick ;o)

step 2

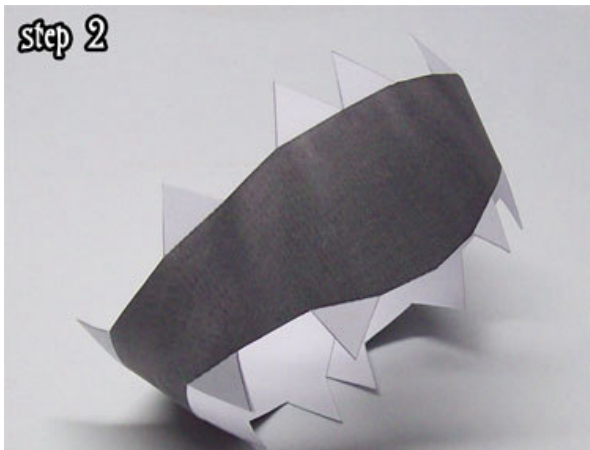

To start off with, cut out and pre-shape* part 1 and make it into a ring by glueing the two ends together.

* See: www.youtube.com/watch?v=8hGwL4HW12w

step 3

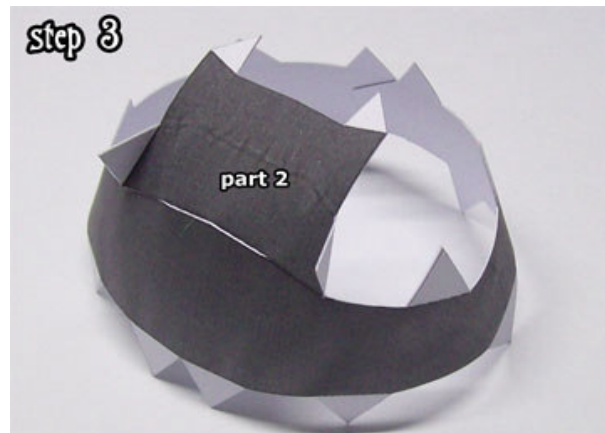

Pre-shape and glue on part 2 like so (make valley folds for the two glueing tabs as shown here).

step 4

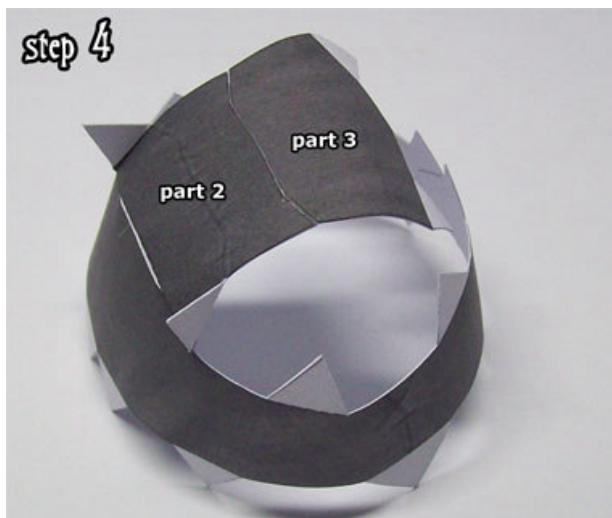

Part 3 is really easy if you pre-shape it and glue it on in two steps: first the front to part 2 as shown here...

step 5

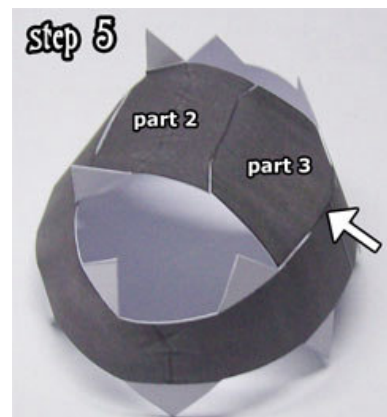

...and then the back as indicated by the arrow.

step 6



Next, we should make the legs and feet first: glue together part 4 like you see here...

step 7



...cut out part 5 and glue the ends together again...

step 8

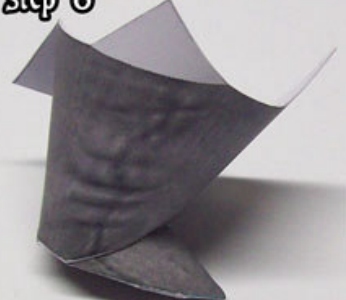

...and then glue the two parts together like so.

step 9



Glueing the leg to the body can be a bit tricky, so be sure to take your time to get a nice result:

When you hold the leg next to the hole where you should glue it, you can see how the glueing tabs kinda "hook" into eachother like a zipper.

Apply glue to the glueing tabs, and position the leg in place. Then work the glueing tabs one by one, folding them over and pressing them down on the inside of your model to make them stick.

step 10



Do the same for the other leg. At this point, you should already be able to put Oogie Boogie on his feet, and he shouldn't fall over. If he does fall over, try adjusting the feet a bit by gently pushing and bending them.

If you can't make it work, you can but a little bit of weight in his feet now, or you can glue him on top of a simple stand later.

step 11

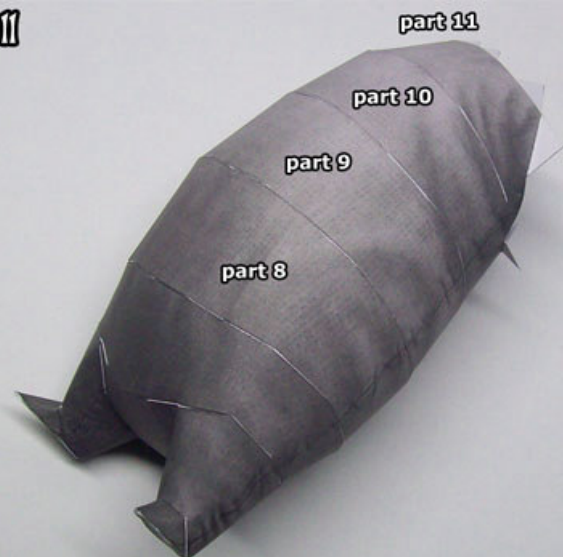

The next few parts are pretty easy again: make them into rings by glueing the ends together (well, except for part 11 of course ;o) and glue them to Oogie Boogie's body one by one.

step 12

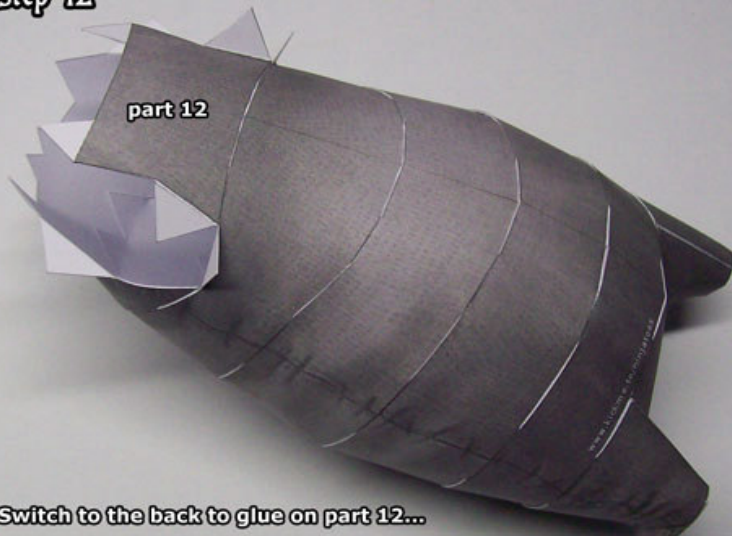

Switch to the back to glue on part 12...

step 13



...and for part 13, use the same method you used for part 3, meaning: glue the one end to part 12 first...

step 14

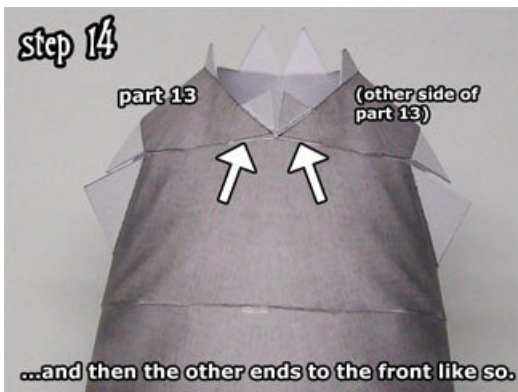

...and then the other ends to the front like so.

step 15

shape the top using the glueing tabs

glue the ends together

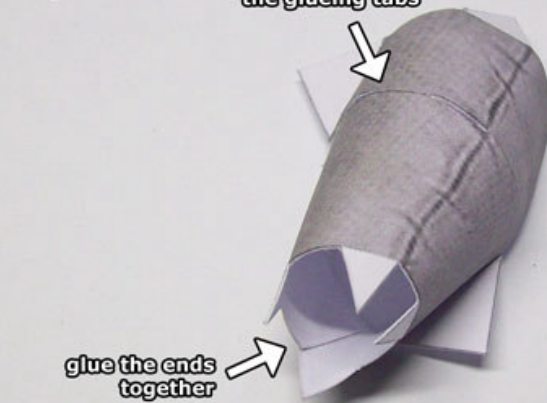

After pre-shaping part 14, first glue the bottom part into a cylinder by glueing the ends together, and then shape the top part using the glueing tabs.

step 16

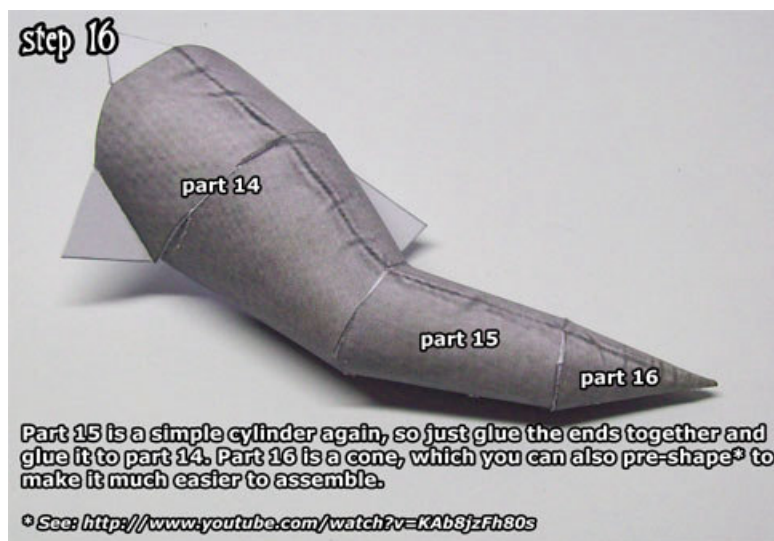

Part 15 is a simple cylinder again, so just glue the ends together and glue it to part 14. Part 16 is a cone, which you can also pre-shape* to make it much easier to assemble.

* See: <http://www.youtube.com/watch?v=KAbSjzFh80s>

step 17

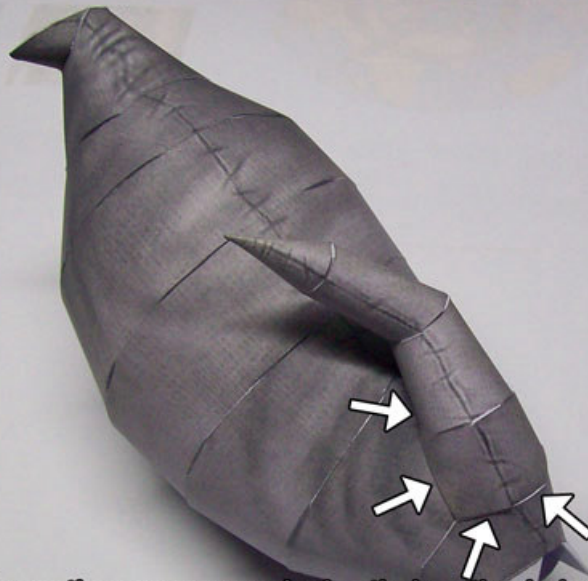

Glue on the arm the same way you glued on the legs: the glueing tabs on the arm and on the body "hook" into eachother like a zipper.

Apply glue to the glueing tabs, and position the arm in place, folding over the glueing tabs (the ones on the arm need to be folded over to the inside of the body of course, and the ones on the body need to be folded over to the inside of the arm).

Then take your time to work each glueing tab one at a time to get the best result. While the glue is not completely dry yet, you can keep manipulating the arm to have as little white showing as possible.

step 18

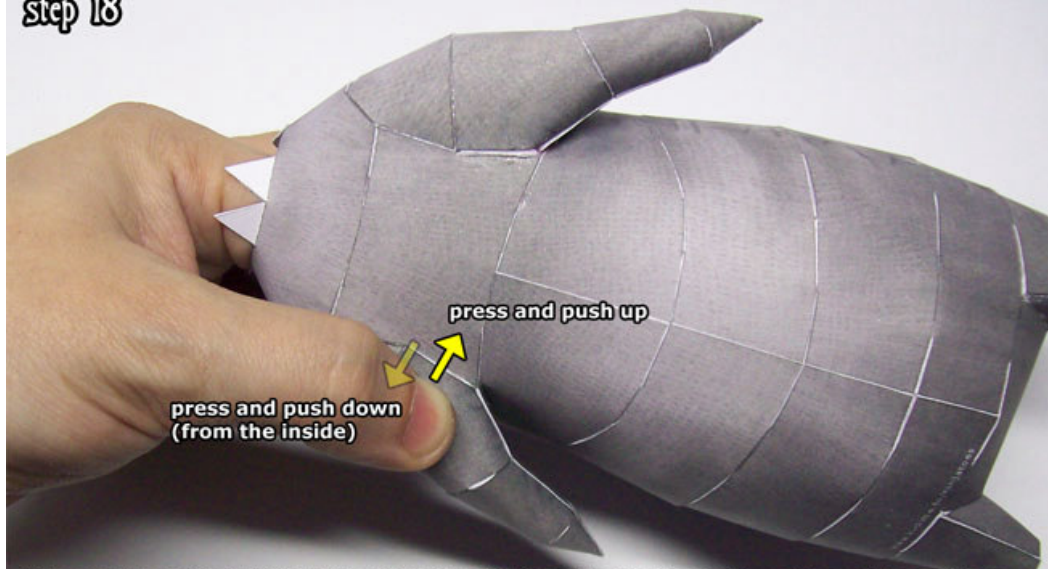

The way I usually do this, is to press the glueing tab and the part together with one finger inside the model, and one on the outside, and then while pressing my fingers together, push my fingers in opposites directions.

In this case, I will push the finger outside the model *upwards*, and the finger inside the model *downwards*.

That way, the part of the arm will slide over the glueing tab of the body, covering up the white that was showing.

Practice and patience makes perfect, so take take your time to get it as good as you like! ;o)

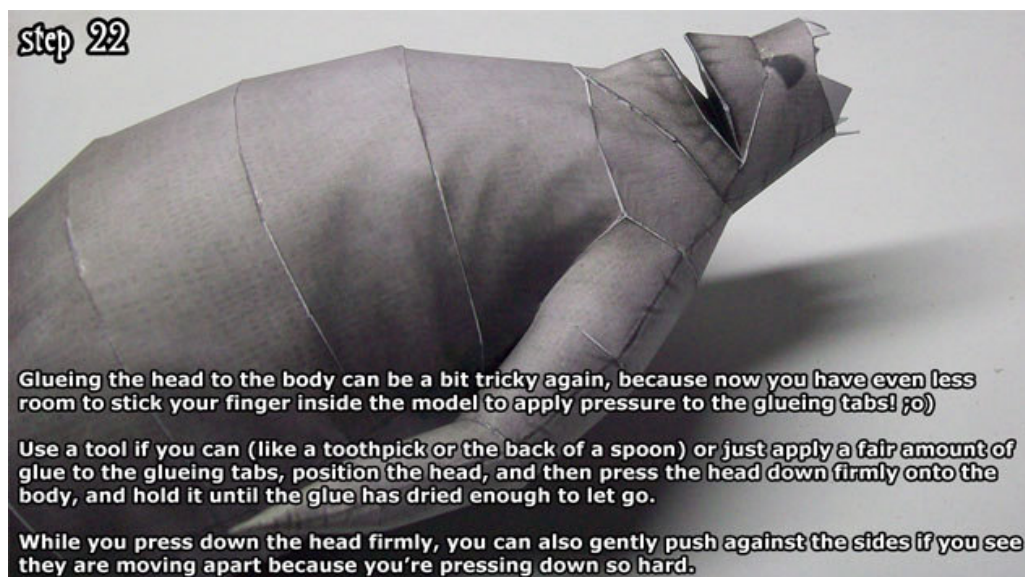

step 23

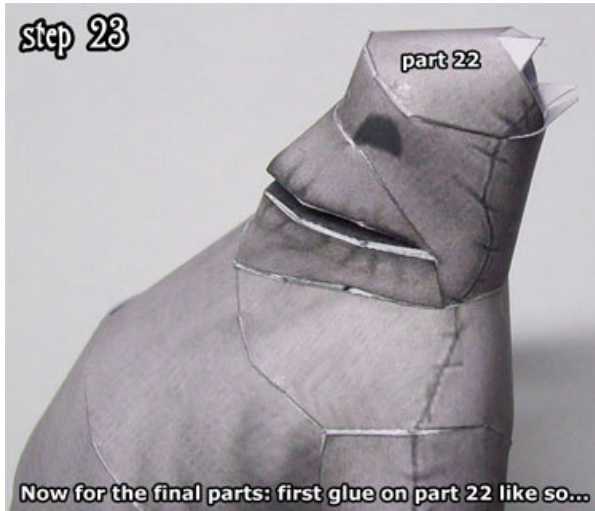

Now for the final parts: first glue on part 22 like so...

step 24



...and then finally parts 23-25*.

* See <http://www.youtube.com/watch?v=KAb8jzFh80s>
again for tips on making small cones

step 25



Now that wasn't so scary, was it?

Thank you for building a Ninjatoes' papercraft model!

www.kickme.to/ninjatoes
ninjatoes.blogspot.com