

# FINAL FANTASY X LULU

## instructions

### step 1



### step 2



### step 3



### step 4



### step 5



### step 6



### step 7



### step 8



### step 9





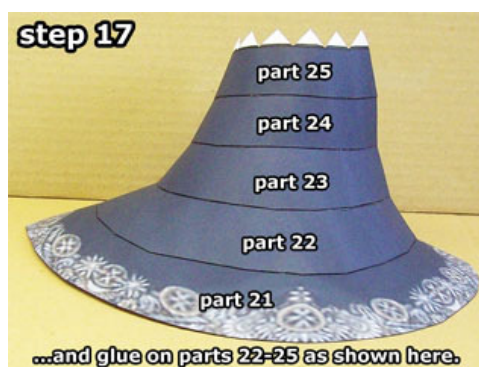
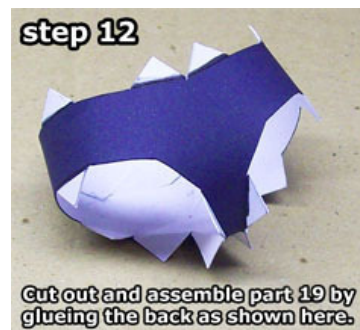
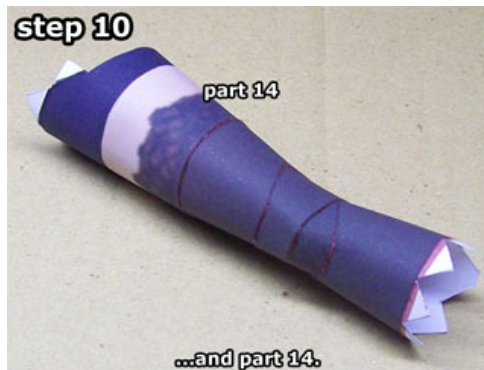



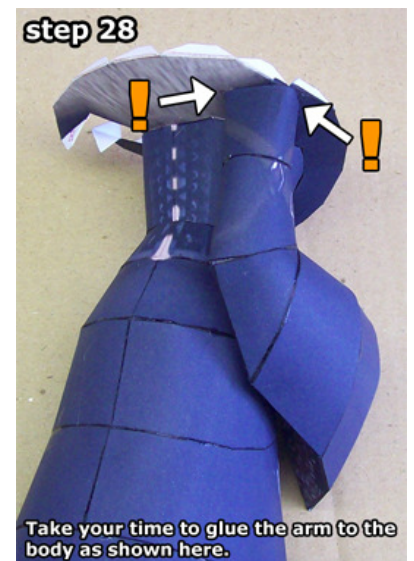
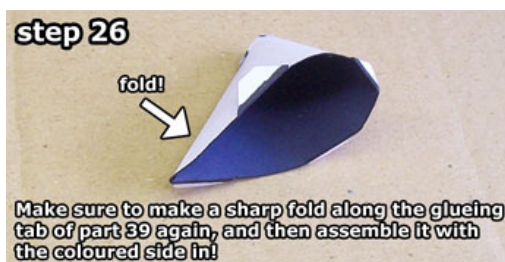
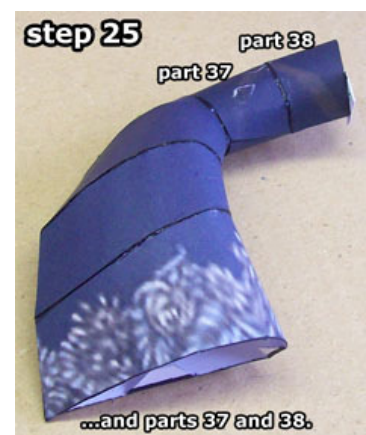
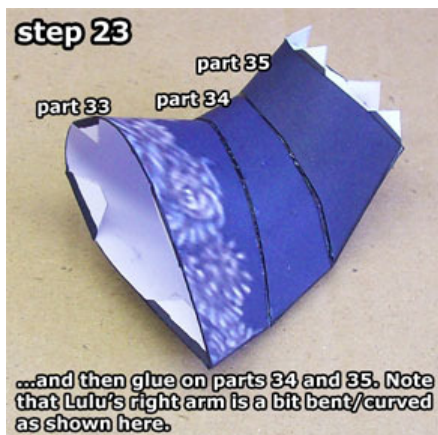
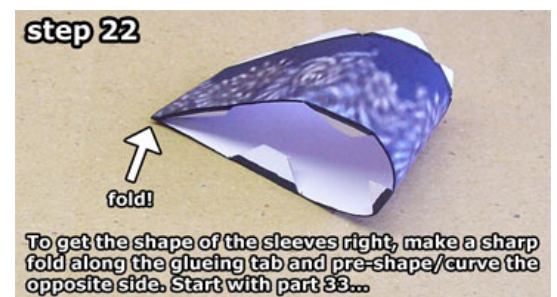
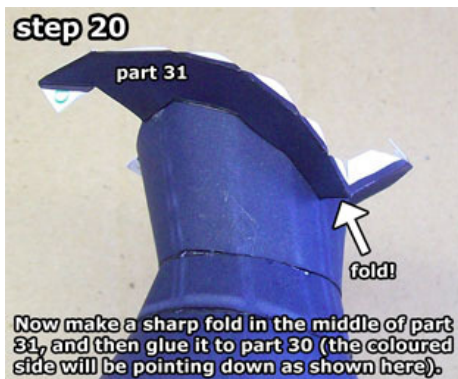
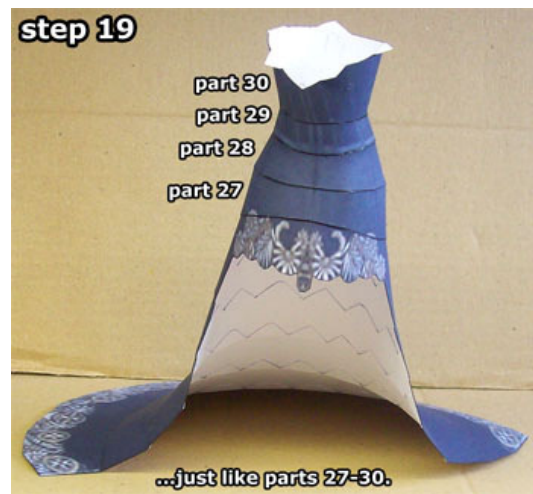



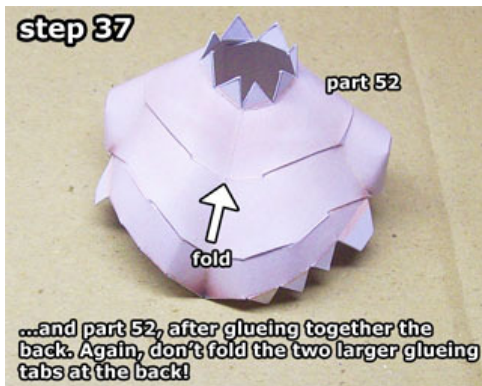
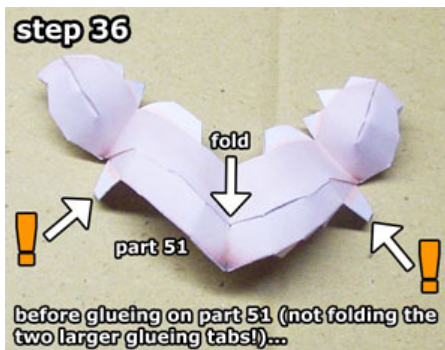
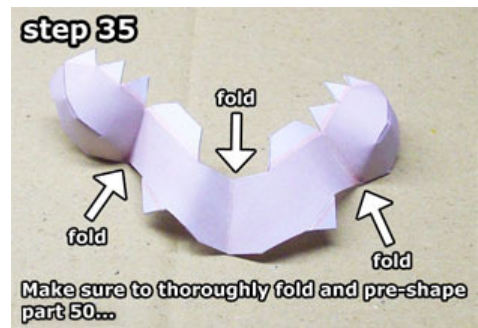
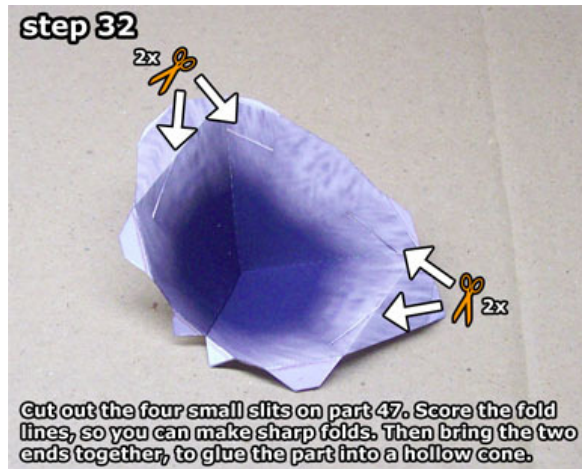



### step 39



Now glue chest on top of the fur collar, by pushing the larger glueing tabs through the slits. Keep the chest in shape until the glue has dried.

### step 40



Now glue the fur collar+chest over the top of the dress. Take your time to position it correctly to your liking.

### step 41



Now you can glue the legs inside the body, and then it's time to glue on the belts!

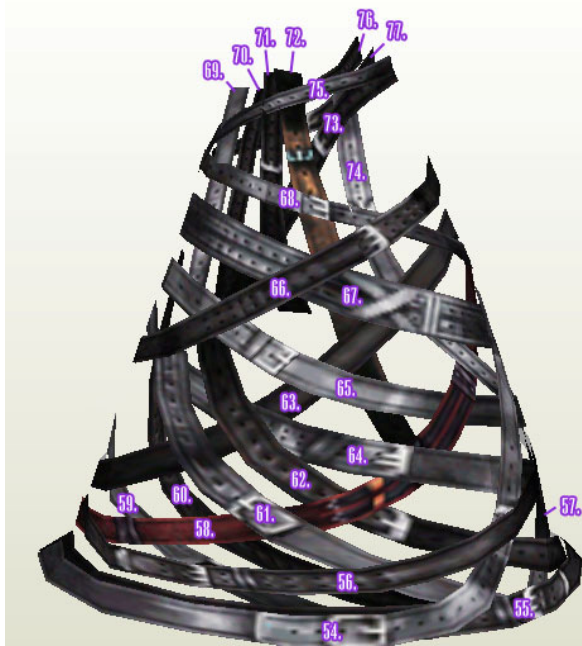

FINAL FANTASY X LULU BELT PATTERN  
WWW.KICKME.TO/NINJATOES

### step 42



You can use the schematic I made to follow the pattern the game as close as possible, or (to some extent) you can glue them on in a pattern to your own liking.



### step 43



### step 44



### step 45



### step 46



### step 47



### step 48



### step 49

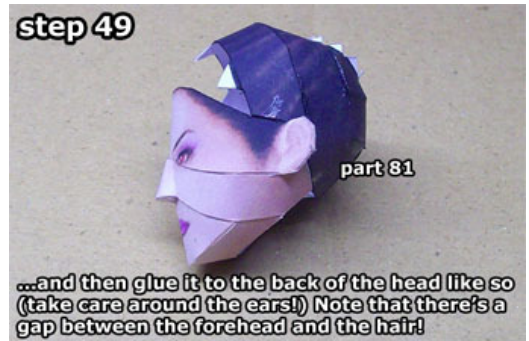

### step 50



### step 51



### step 52



### step 53



### step 54

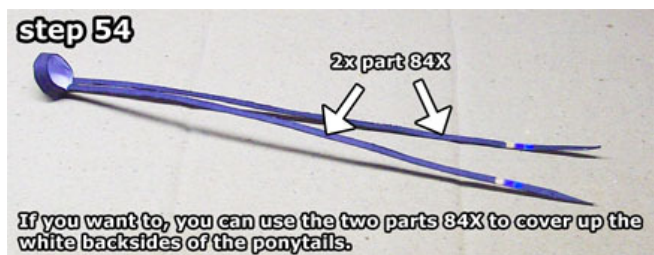



### step 55

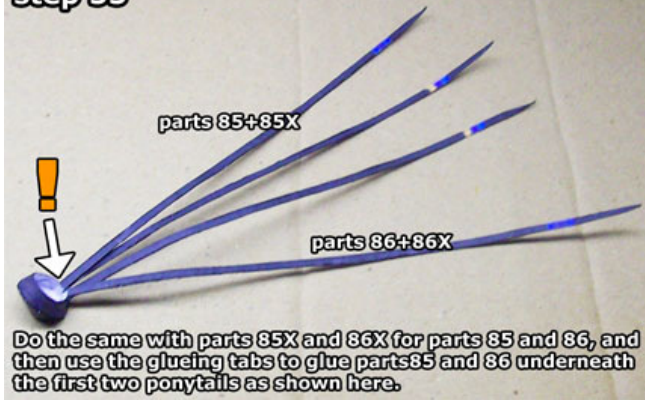

### step 56



### step 57



### step 58

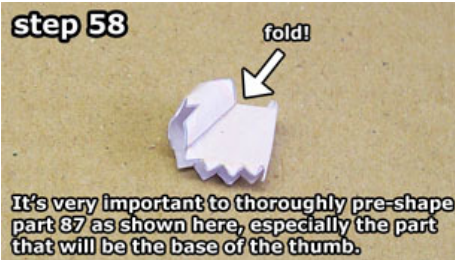

### step 59

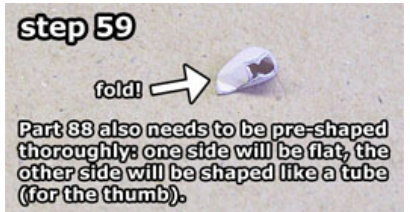

### step 60



### step 61

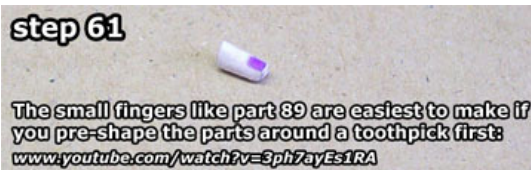

### step 62



### step 63



### step 64



### step 65



### step 66



### step 67





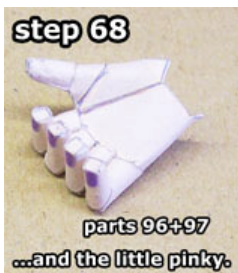



### step 75

parts 114  
+114X

Next, glue her earrings to her ears as shown here (parts 115 and 115X go on the other ear of course).

### step 76

parts 116+116X

parts 119+119X

parts 117+117X

parts 120+120X

parts 118+118X

parts 121  
+121X

parts 122  
+122X

Glue the backsides to the parts for the hairpins...

### step 78

### step 77

4x

...and then carefully cut 4 small slits into the knot above the ponytails so you can stick the hairpins through as shown here.

And that's it! Thank you for building a Ninjatoes' papercraft model!  
[www.kickme.to/ninjatoes](http://www.kickme.to/ninjatoes)