

Kingdom Hearts 2 Sora instructions

step 1

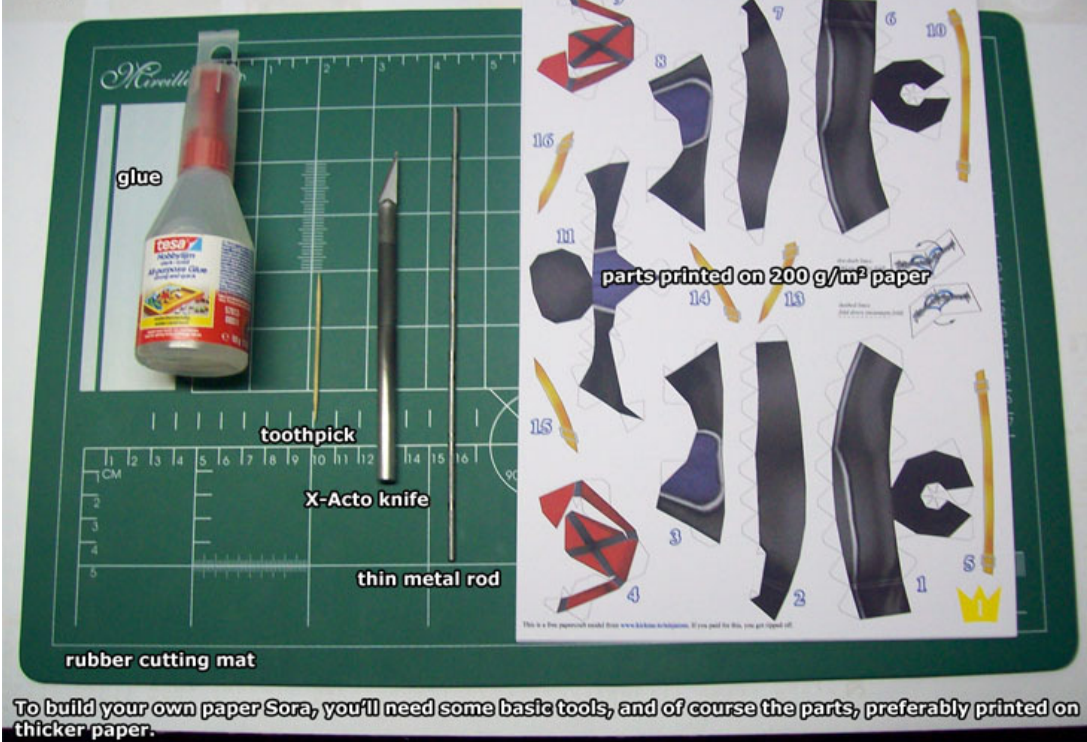

step 2



step 3



step 4

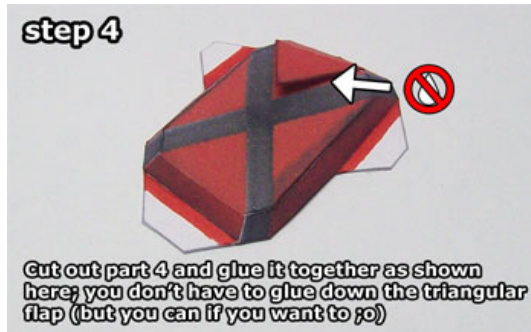

step 5

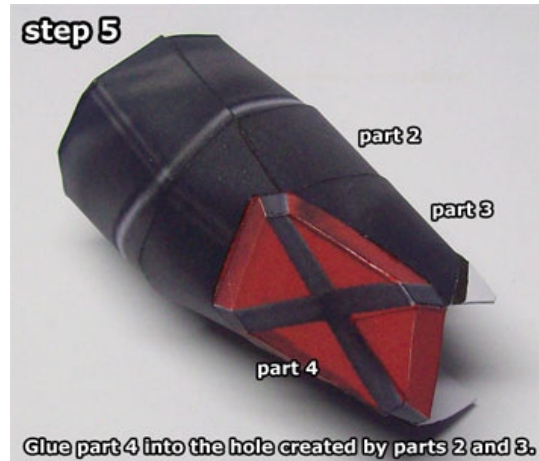

step 6



step 7



step 8

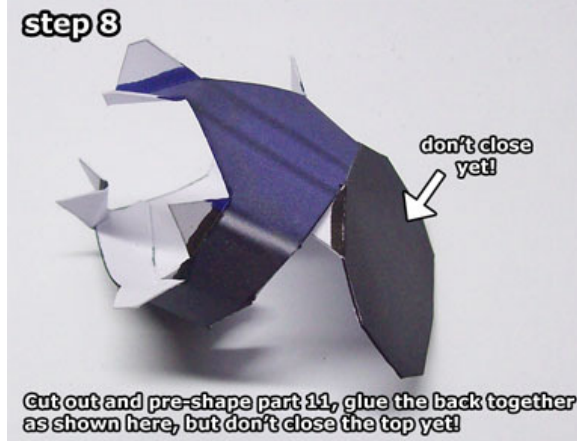

step 9

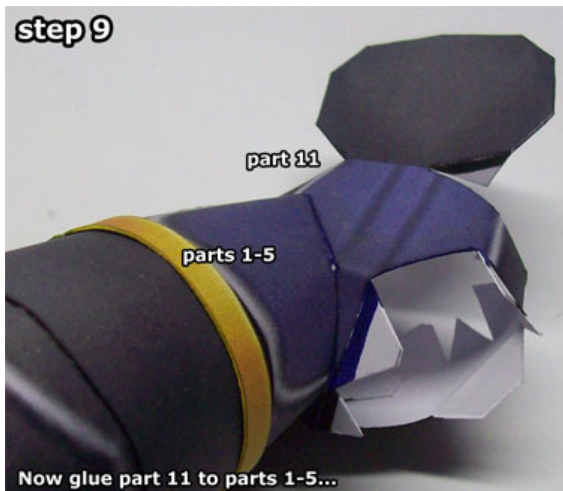

step 10



step 11



Now cut out and glue together part 12: the belt buckle sticks out a little underneath the belt itself, and the needn't be glued down.

step 12



Then glue the belt on top of the pants as shown here. It is a little wider than the pants, so divide the difference equally on all sides.

step 13

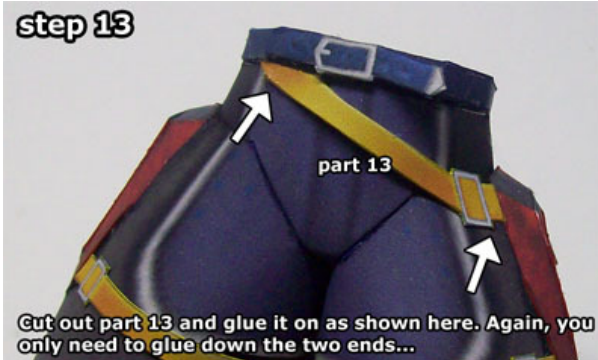

Cut out part 13 and glue it on as shown here. Again, you only need to glue down the two ends...

step 14

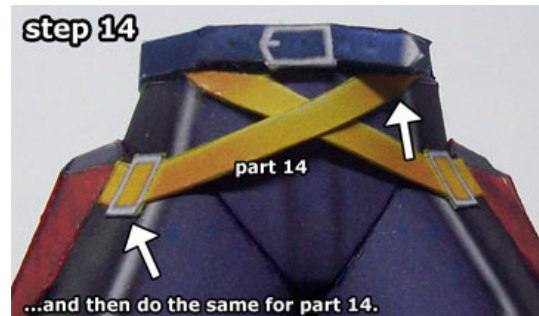

...and then do the same for part 14.

step 15



Then do the same for parts 15 and 16 on the back.

step 16



Start on the shoes by cutting out and glueing together part 17.

step 17



Assemble and glue on part 18...

step 18



...then pre-shape part 19, glue the ends together and glue it on as well...

step 19



...and then part 20 (leave the top open until last).

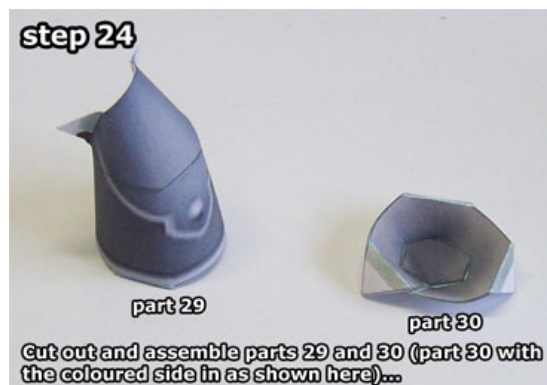

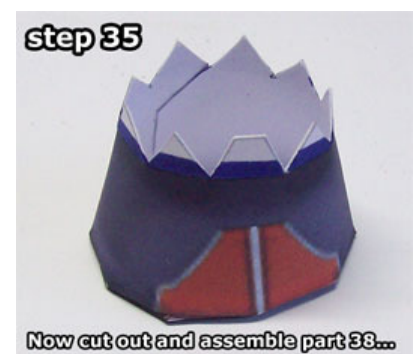
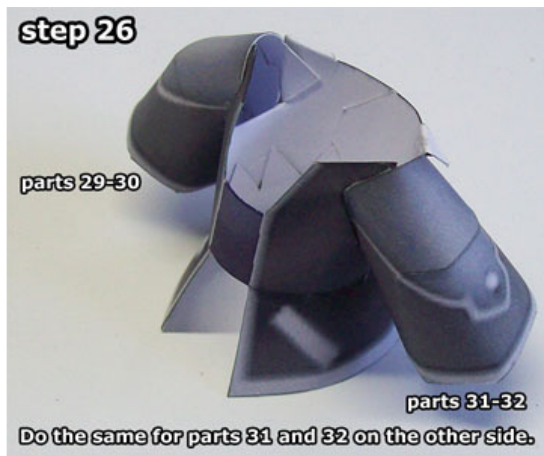

step 36



step 37

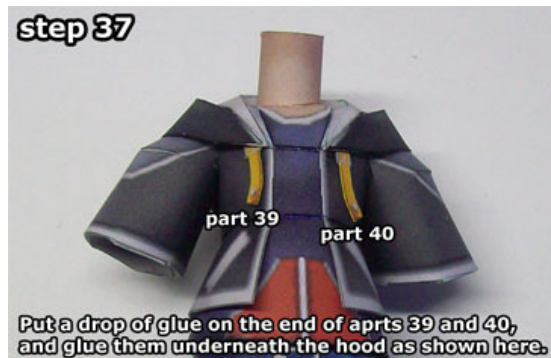

step 38

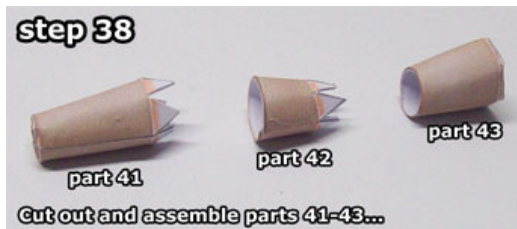

step 39



step 40



step 41



step 42

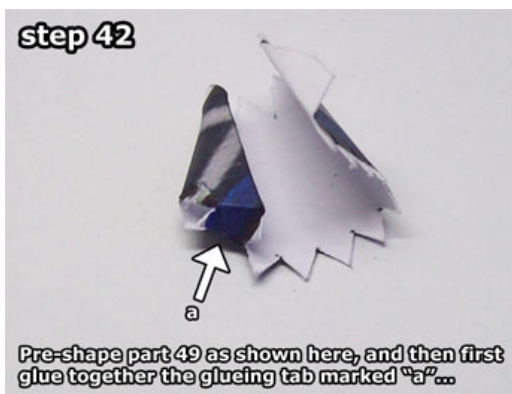

step 43



step 44



step 45



part 50

Now glue the thumb (part 50) to the hand as shown here.

step 46



part 51

part 52

The other fingers are all made up out of two parts (like parts 51 and 52) so glue them together first and fold over the small glueing tab as shown here...

step 47



parts 51-52

...before glueing it to the hand like so.

step 48



parts 53-54

Then do the same for parts 53 and 54...

step 49



parts 55-56

...parts 55 and 56...

step 50



parts 57-58

...and parts 57 and 58.

step 51



part 59

Then assemble and glue on part 59...

step 52



parts 49-59

parts 60-70

...and then glue the hand to the arm. Do the same for parts 60-70 on the other side.

step 53



Cut out and glue together part 71 as shown here.

step 54

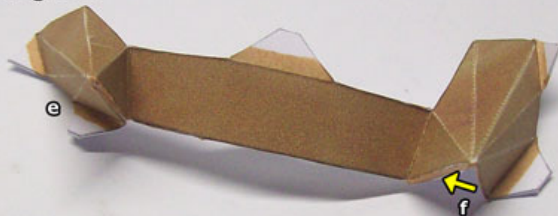

On part 72, glue together the two spikes first following the arrows marked "e" and "f"...

step 55

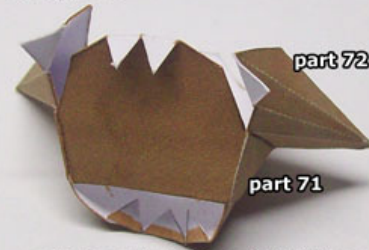

part 72

part 71

...and then glue it to part 71 like so.

step 56

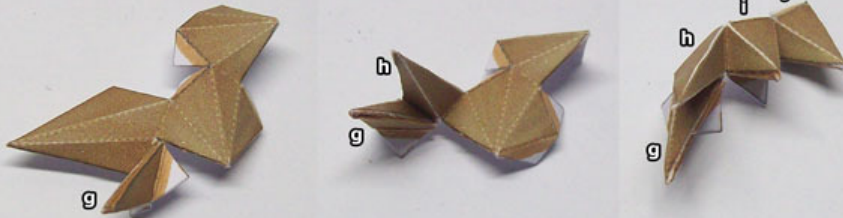

The hair may look intimidating at first, but if you score all the fold lines properly and make all the "spikes" one by one following the arrows and valley folding in between the spikes as indicated by the fold lines, it will become much easier.

step 57

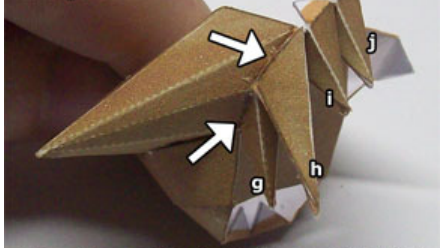

Now glue part 73 to the front of the hair as shown here.

step 58

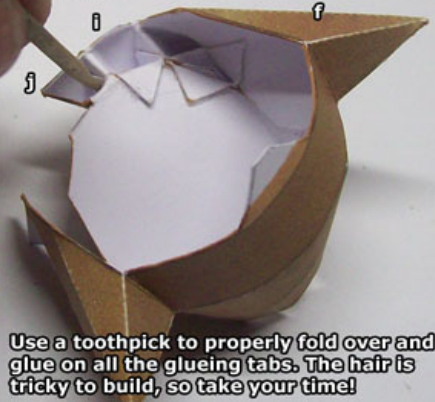

Use a toothpick to properly fold over and glue on all the glueing tabs. The hair is tricky to build, so take your time!

step 59

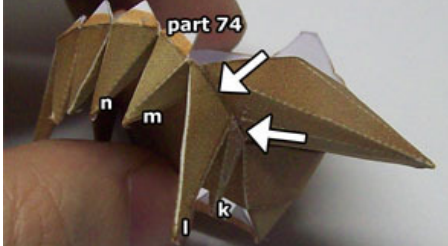

Now glue on part 74 the same way on the other side.

step 60



Cut out and assemble part 75 (one spike at a time!)...

step 61

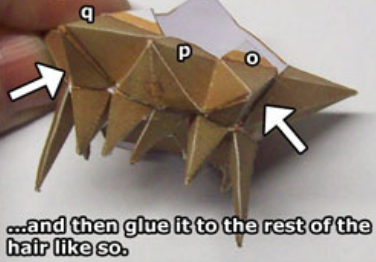

...and then glue it to the rest of the hair like so.

step 62

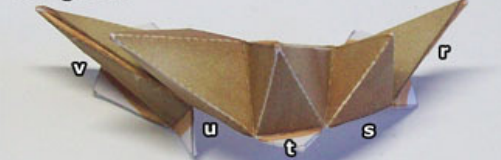

Do the same for part 76, glueing together the spikes one by one...

step 63

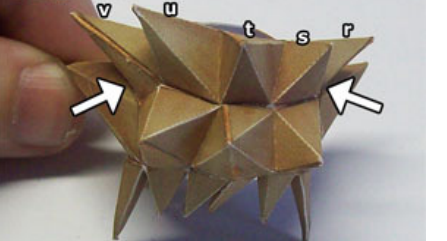

...and then glue it to the rest of the hair.

step 64



Now pre-shape and glue on part 77. Take your time, and use a toothpick from the underside to glue on all the glueing tabs.

step 65



Cut out and glue together part 78...

step 66

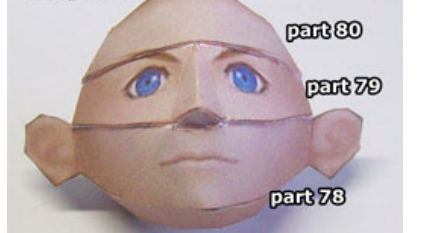

...and then glue on parts 79 and 80.

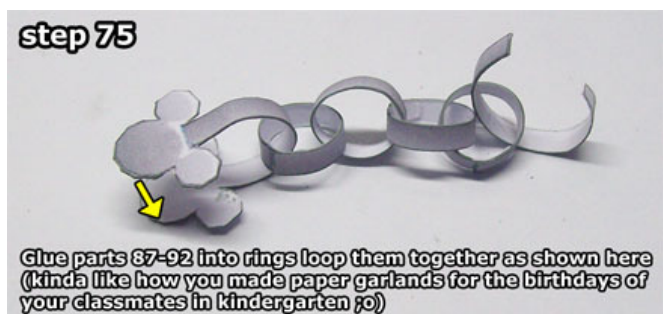
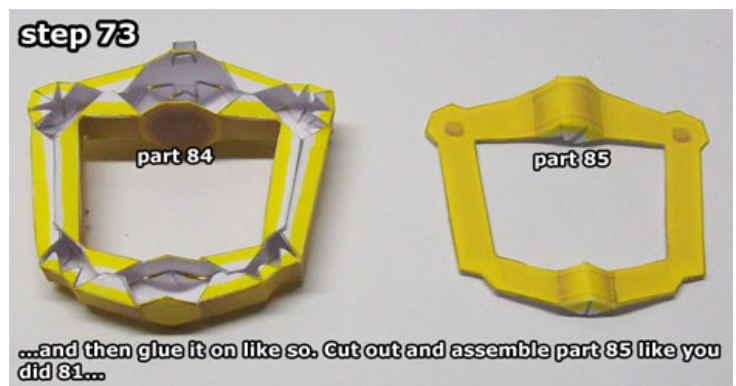
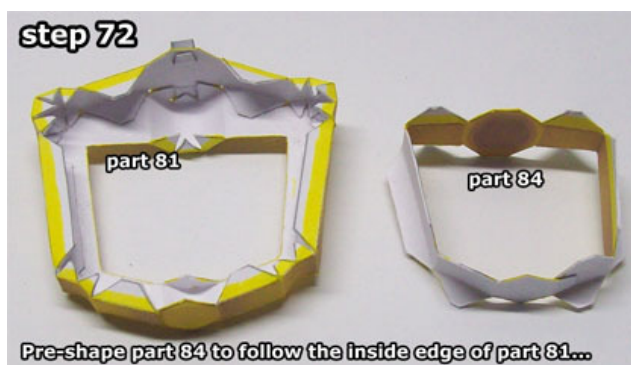
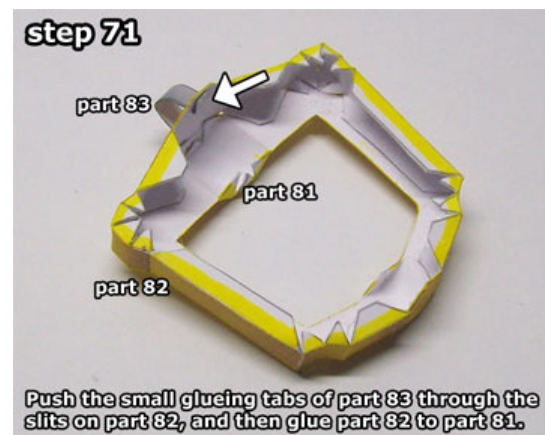
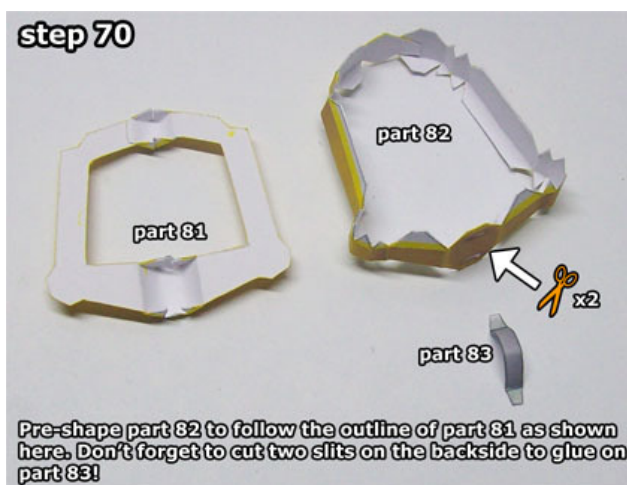

step 76

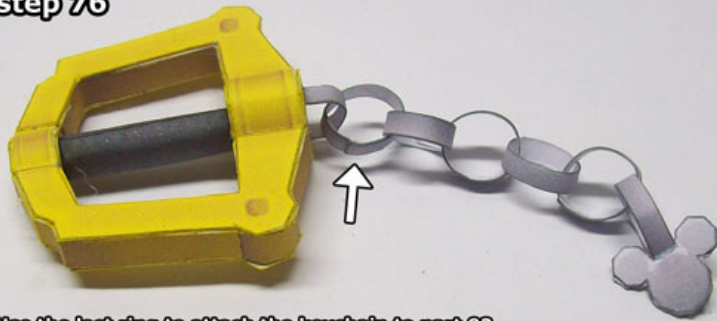

Use the last ring to attach the keychain to part 83.

step 77



part 93

Next, assemble and glue on part 93.

step 78



Cut the two slits on part 94, and then assemble it as shown here.

step 79

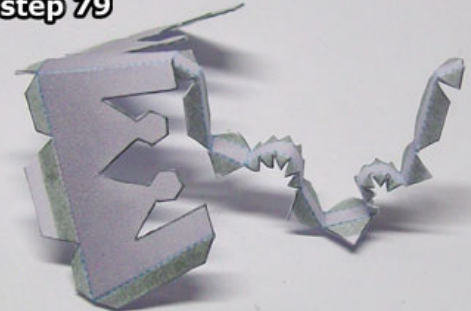

Pre-shape the long strip on part 95 to follow the key-shape...

step 80

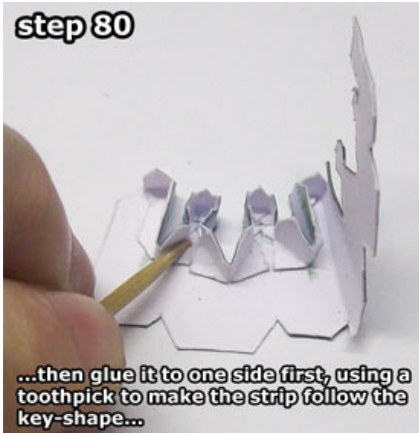

...then glue it to one side first, using a toothpick to make the strip follow the key-shape...

step 81

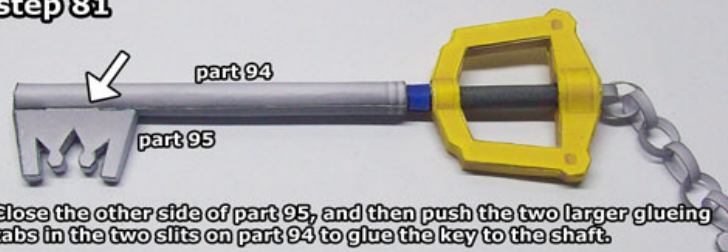

Close the other side of part 95, and then push the two larger glueing tabs in the two slits on part 94 to glue the key to the shaft.

step 82



Place the Keyblade in Sora's hand;
Thank you for building a
Ninjatoes' papercraft model!