

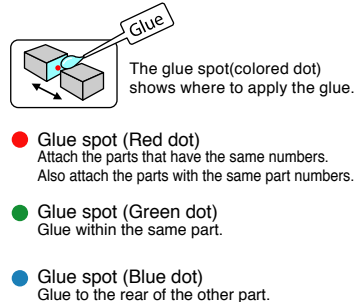

The Temple of Heaven is a historic site located in Beijing, China, at which the emperor used to conduct religious ceremonies. Its grounds cover approximately 2,730,000 square meters, and in the center of them stands a structure used to call for abundant crops, known as the Hall of Prayer for Good Harvests. The hall is really an altar, and is bigger than any other altar in current existence in China. It has a diameter of 32 m and is 38 m high. The wooden pillars feature brightly colored carvings of phoenixes and dragons, the entire structure features gold plating, and the three-tiered roof is tiled in lapis lazuli, its blue color representing the heavens. In 1998 the Temple of Heaven's preciousness was officially recognized with its listing as a UNESCO World Heritage Site. This paper craft is based on the Temple of Heaven's Hall of Prayer for Good Harvests.

*This model was designed for Papercraft and may differ from the original in some respects.

Assembly Instructions

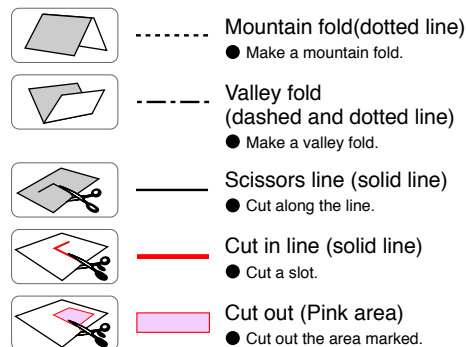

● Front



● Side



● Back



● Side



■ Parts sheet (Pattern) : Twenty Nine A4 sheets

■ Assembly Instructions : Six A4 sheets

■ No. of Parts : 136 parts

* Build the model by carefully reading the Assembly Instructions, in the parts sheet page order.

Handy Hint

- ☆ Write down the number on the back of each part as you cut them out.
- ☆ Since many of the parts are complicated and very small, do a trial assembly before actually attaching them together.
- ☆ The finished piece will look more realistic if you paint the edges of the parts with colors similar to the parts.

Tools and materials



Scissors, set square, glue (We recommend stick glue), pencil, used ballpoint pen, toothpicks, tweezers, (useful for handling small parts)

Assembly tip



Before gluing, crease the paper along mountain fold and valley fold lines and make sure rounded sections are nice and stiff.

Caution



Glue, scissors and other tools may be dangerous to young children so be sure to keep them out of the reach of young children.

Assembling the third floor section.

⑦ Glue these parts to 3A in the following order: 5A, 5B, 5C, 5D (6A, 6B, 6C, 6D), [5E, 6E].

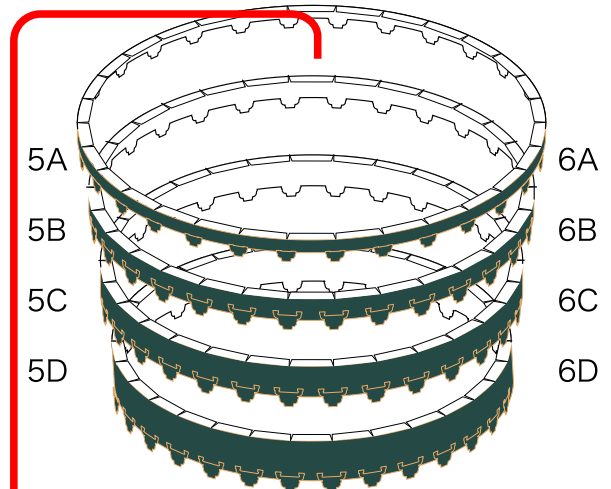
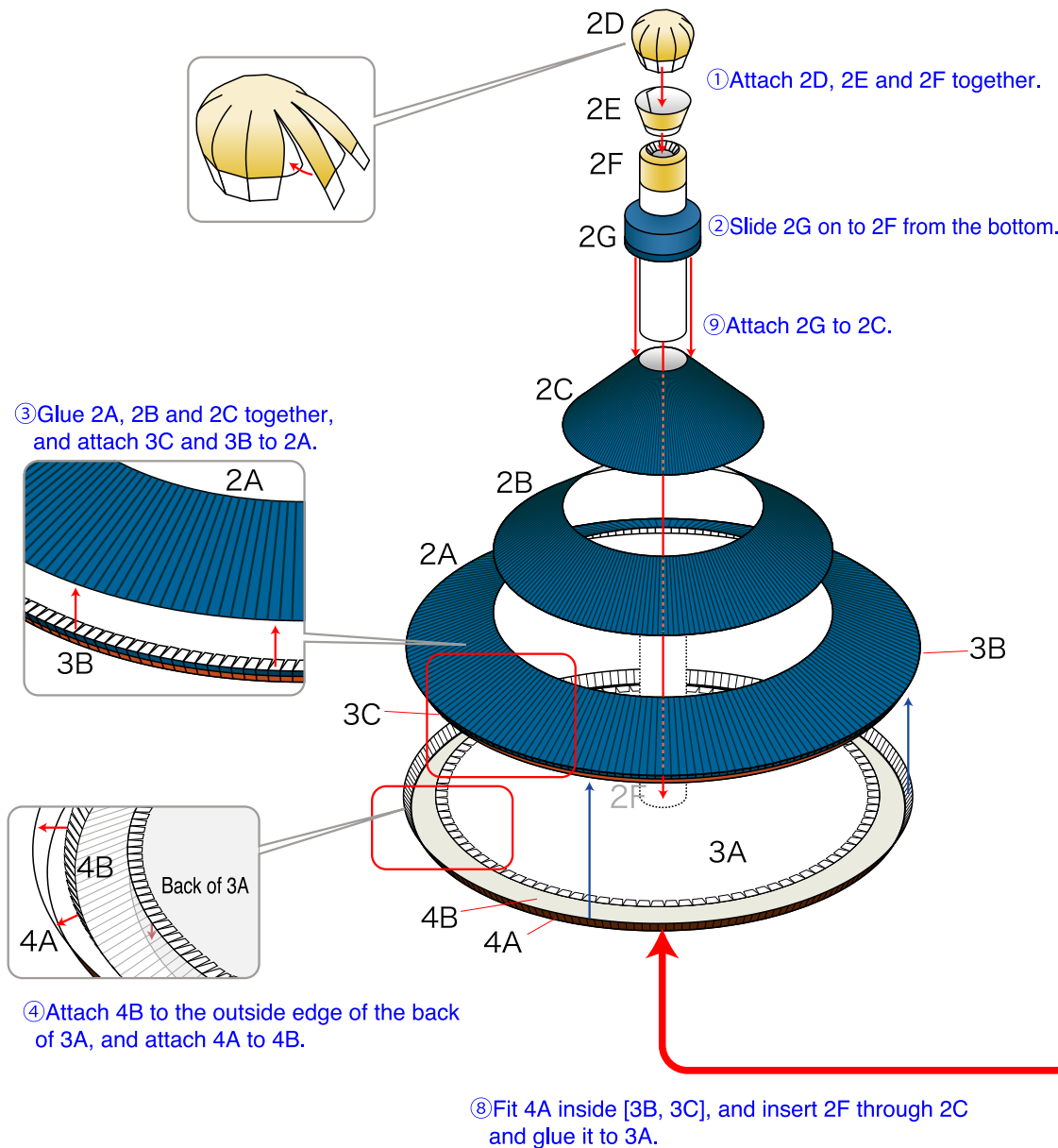

⑤ After gluing 5E and 6E together, insert 5E (6E) into 5G (6F) as shown by the arrows, and attach.

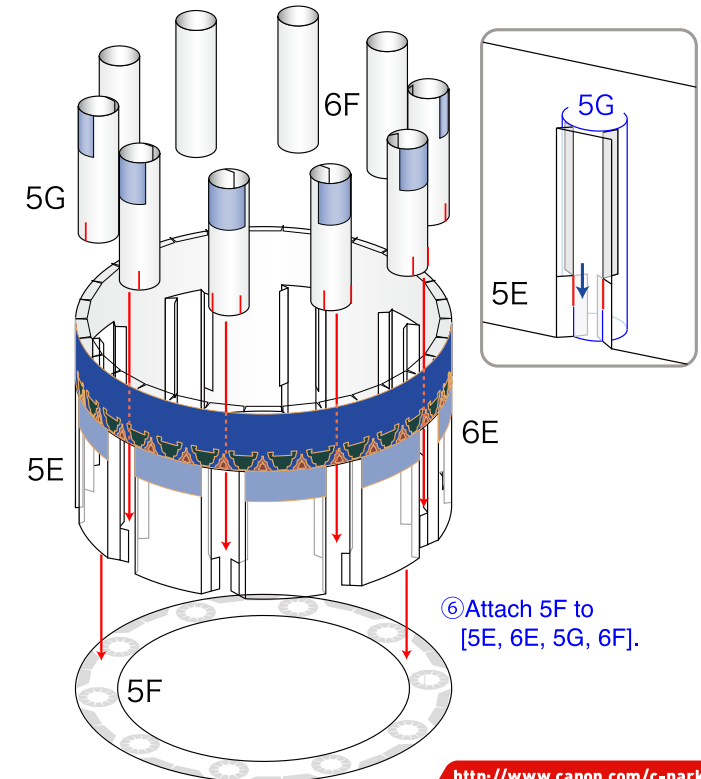

Assembling the second floor section.

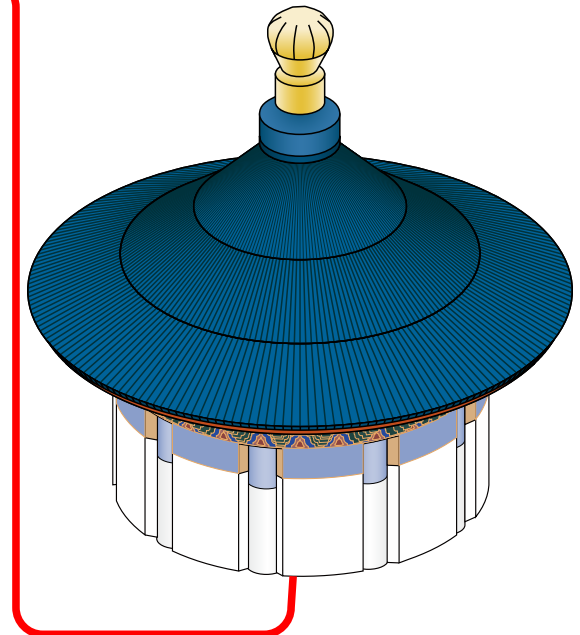
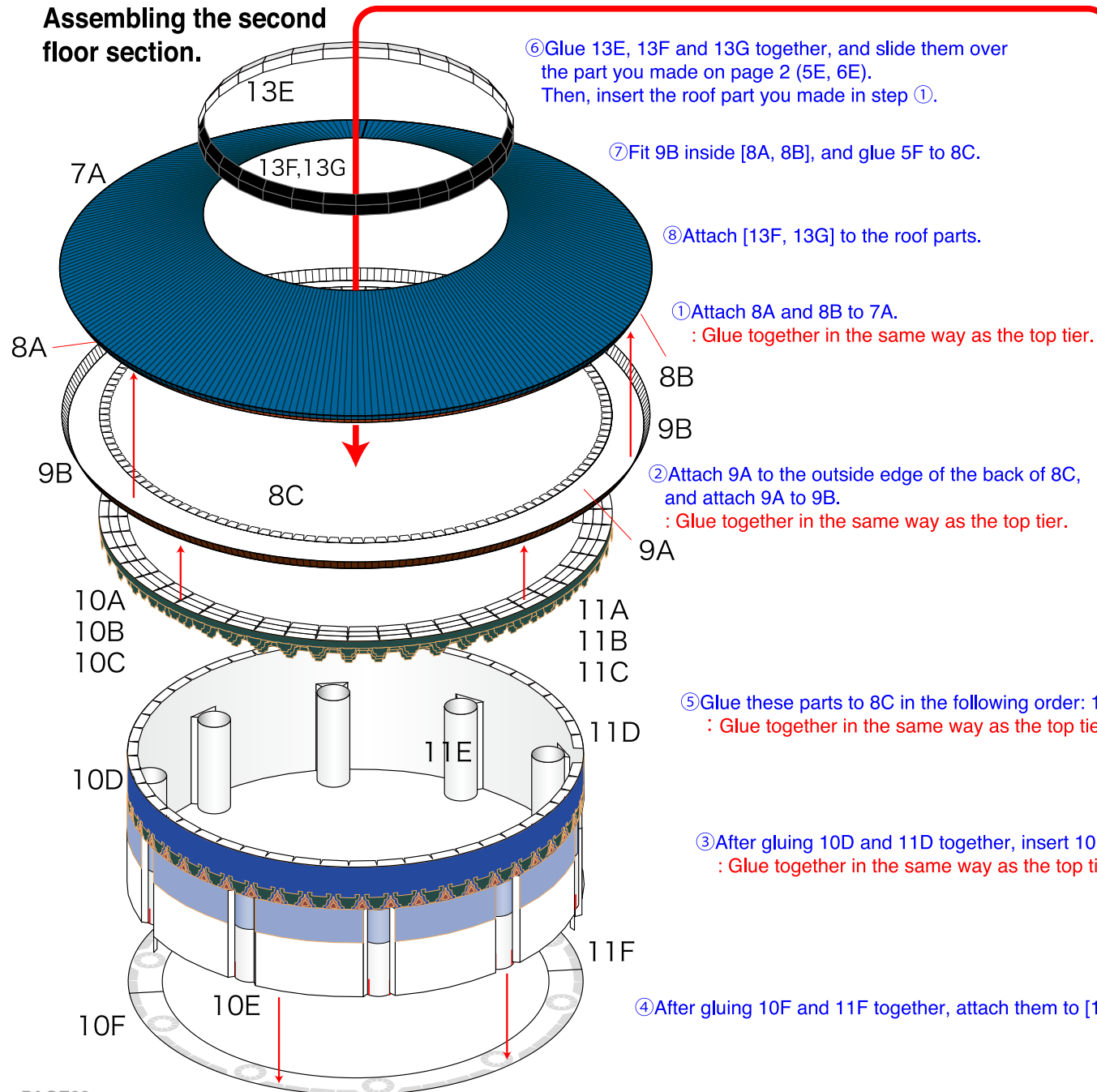

Part you made on page 2

Assembling the first section.

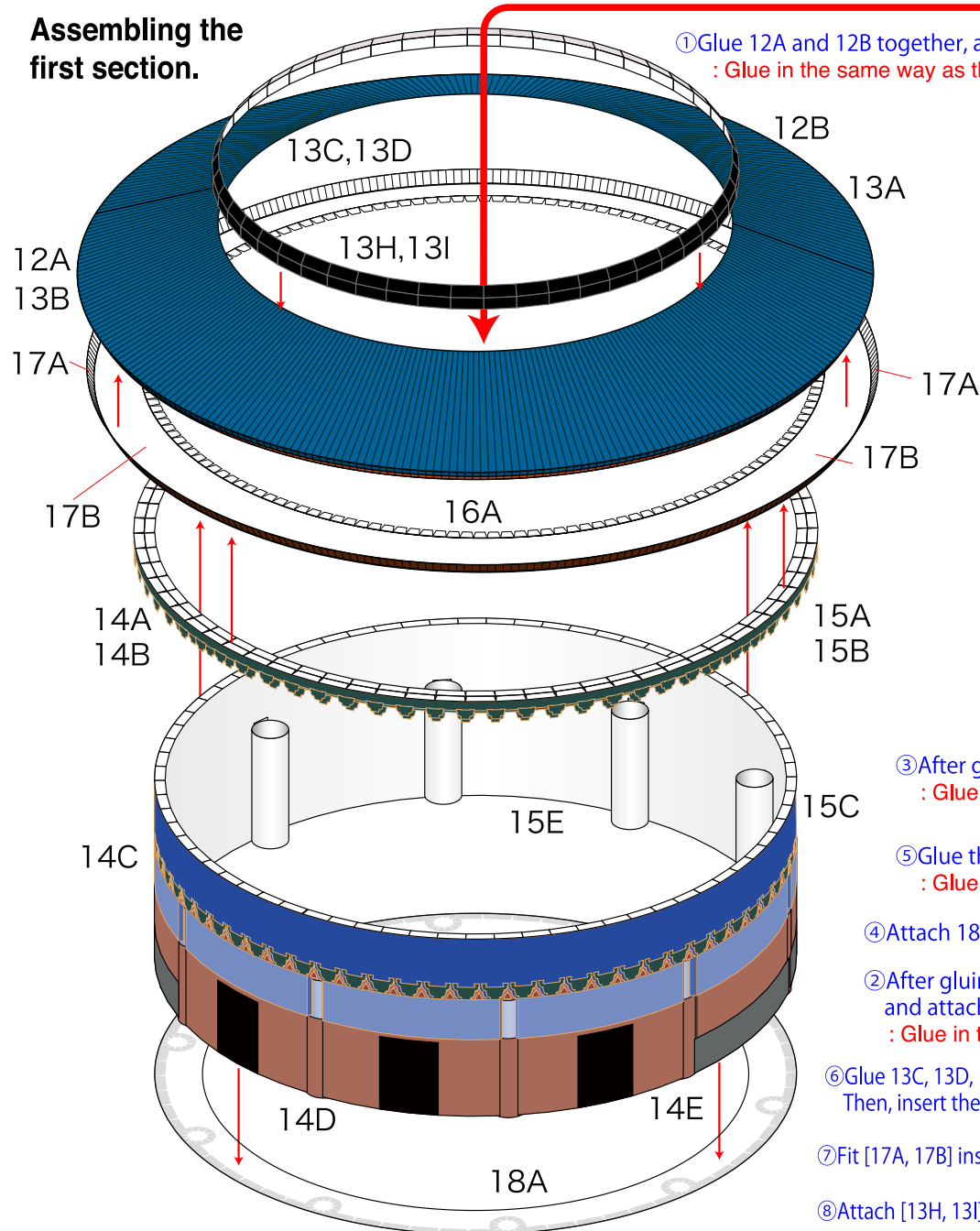

- ① Glue 12A and 12B together, and glue together 13A and 13B.
: Glue in the same way as the top two tiers.

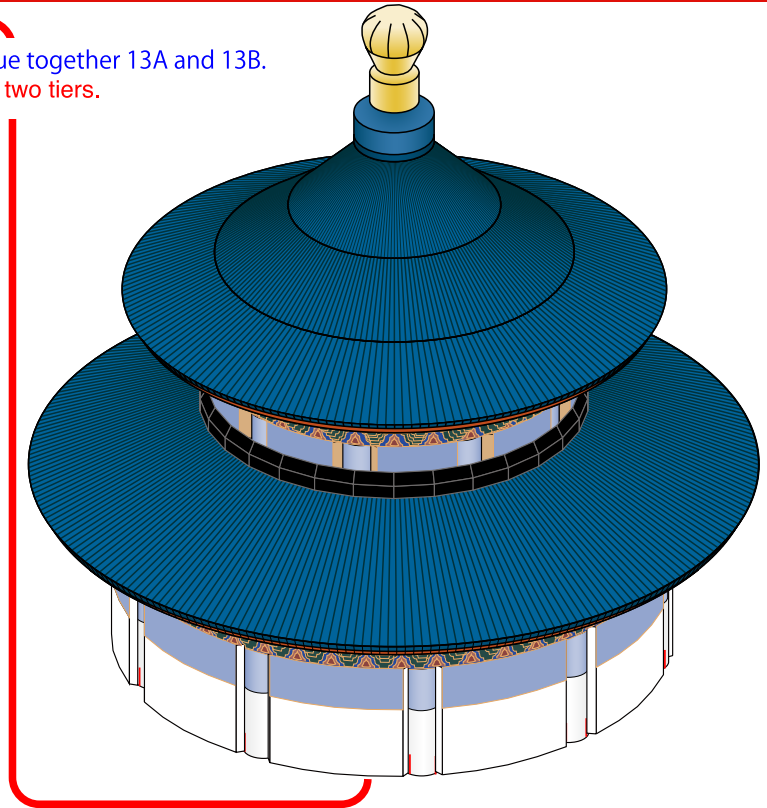

- ③ After gluing 14C and 15C together, insert 14C (15C) into 14E, 14D (15D) and attach.
: Glue in the same way as the top two tiers.

- ⑤ Glue these parts to 16A in the following order: 14A, 14B (15A, 15B), [14C, 15C].
: Glue in the same way as the top two tiers.

- ④ Attach 18A to [14C, 15C, 14D, 14E, 15D].

- ② After gluing 17B together, attach it to the outside edge of the back of 16A, and attach 17B to 17A.
: Glue in the same way as the top two tiers.

- ⑥ Glue 13C, 13D, 13H and 13I together, and slide them over the part you made on page 3 [10D, 11D]. Then, insert the roof part you made in step ①.

- ⑦ Fit [17A, 17B] inside [13A, 13B], and glue [10F, 11F] to 16A.

- ⑧ Attach [13H, 13I] to the roof parts.

Assembling the base.

Glue 19A and 20A together, and glue all the parts to them, starting from the inside and working out.

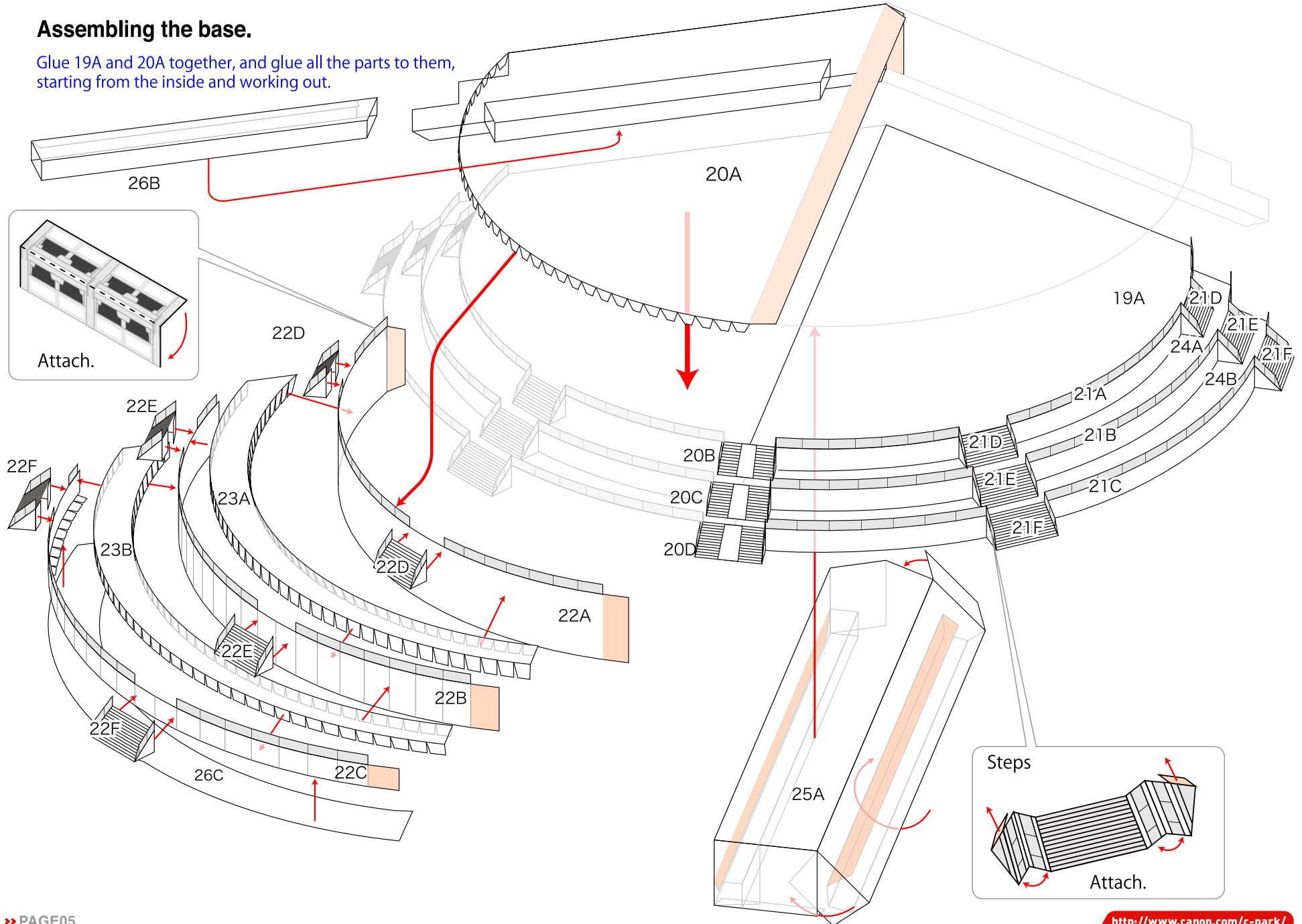

Assemble the entire structure together.

④ To the base, attach 27A, 28A and 29A from underneath, in order, glue the completed hall on top and you're done!

- ① Insert a, b, c and d and glue them to the back.
- ② Fold and glue down e, f, g and h.

