

step 1

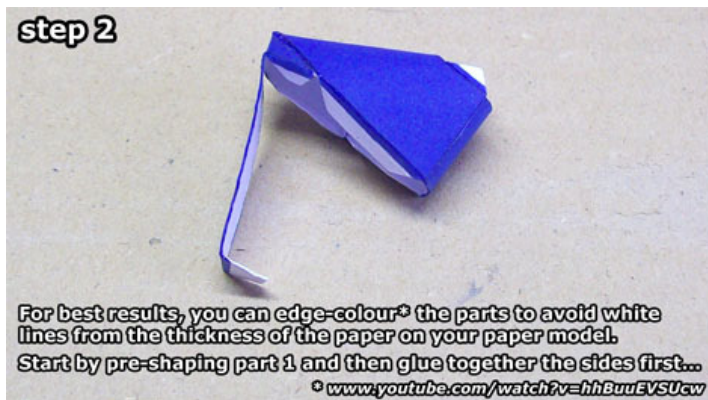

step 2



step 3

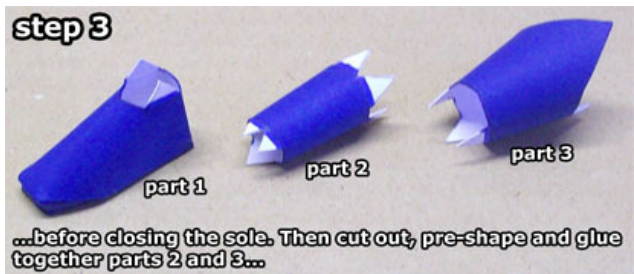

step 4

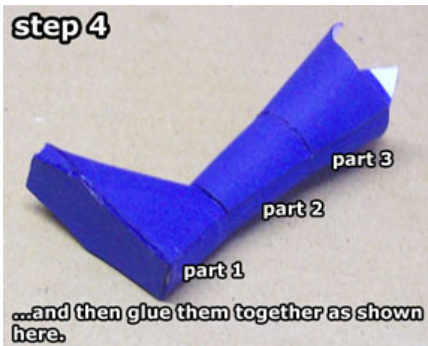

step 5

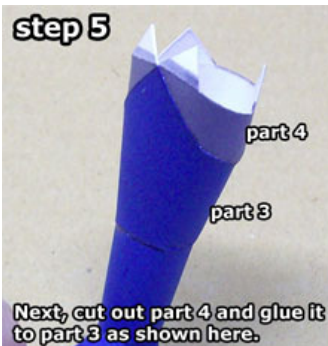

step 6

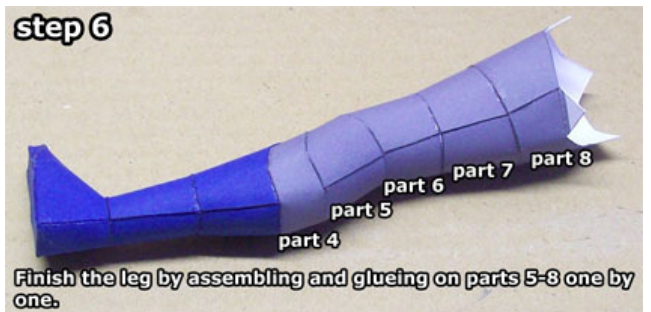

step 7



step 8

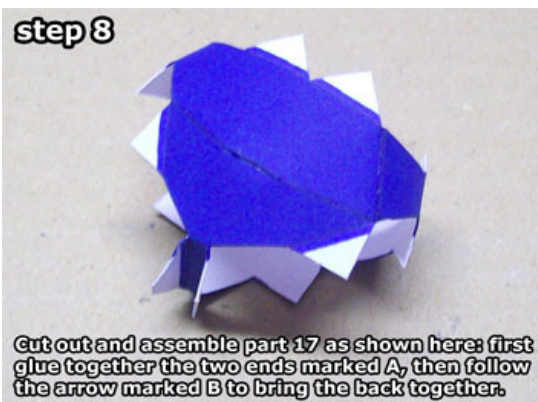

step 9



step 10



step 11



step 12



step 13

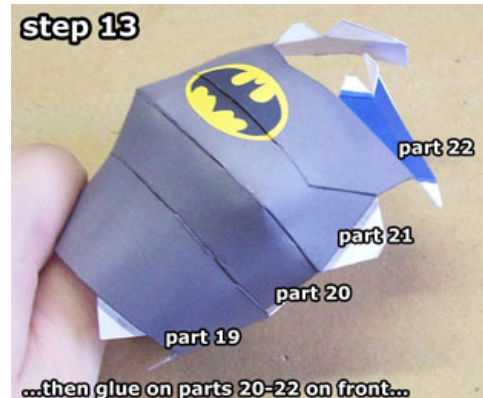

step 14

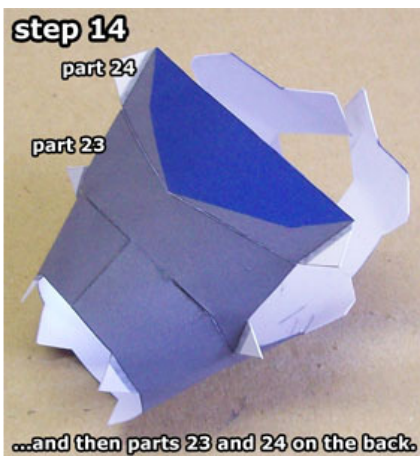

step 15

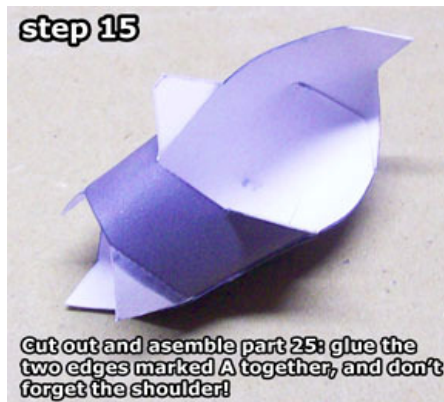

step 16



step 17

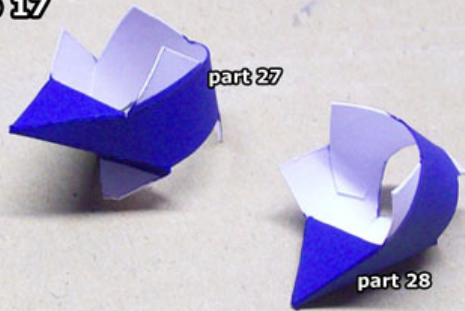

Score and fold the three fold lines on part 27 to create the triangular shapes and then glue the two ends together and the little triangle on top.
Do the same for part 28...

step 18

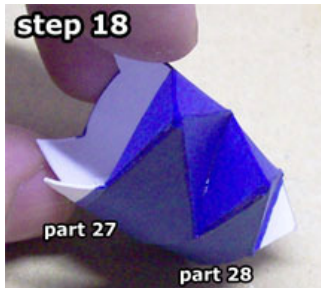

...and then glue them together as shown here.

step 19



Assemble part 29 the same way and then glue it on as well.

step 20



Now glue parts 27-29 to the arm like so.

step 21



FRONT VIEW

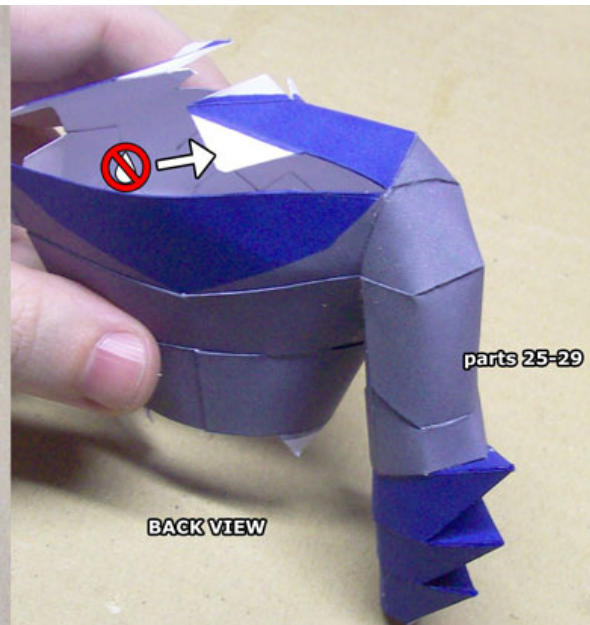

BACK VIEW

Take your time to glue the arm to the torso: I found it easiest to do the bottom and the front first (the armpit and the chest) and then the top (the shoulder).

This brings together the shoulders/neck and the back, but don't glue those together!!

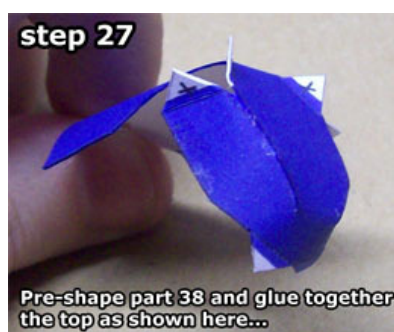
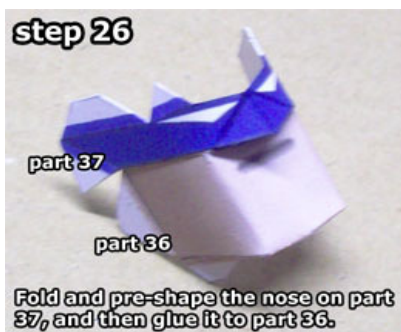
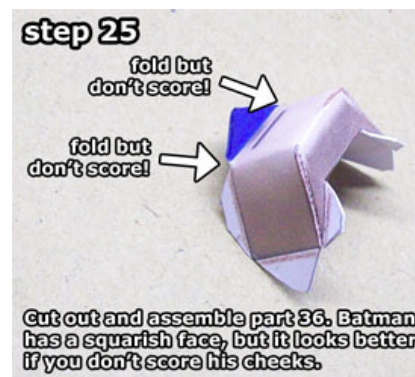
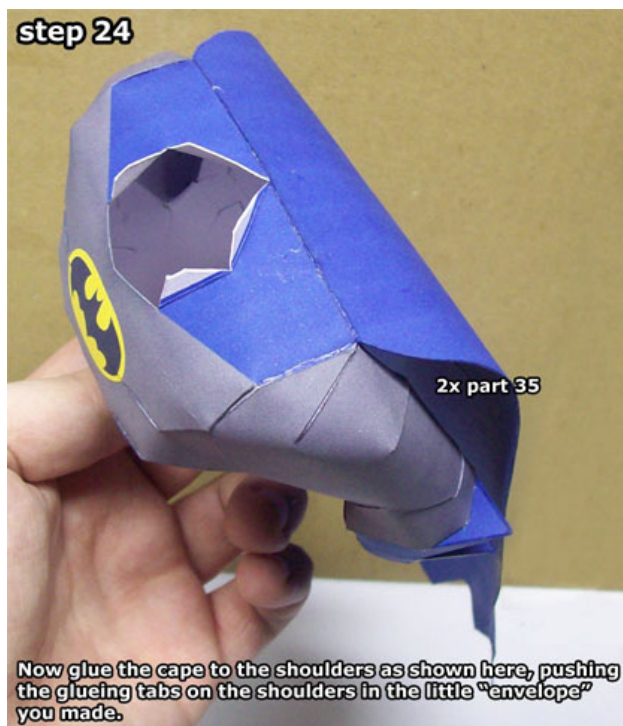
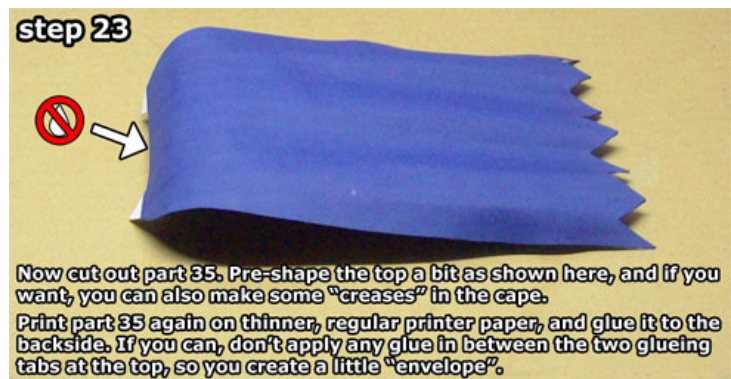

step 29



step 30



step 31



step 32



Now glue the torso to the legs. Push the glueing tabs out a bit, so they will press themselves against the inside of the torso/belt.

step 33

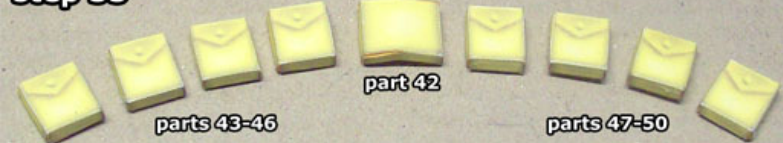

Now cut out and assemble parts 42-50. Only part 42 is different, the others are all the same.

step 34



Glue part 42 in the middle of Batman's belt, and divide parts 43-50 evenly around his waist.

step 35

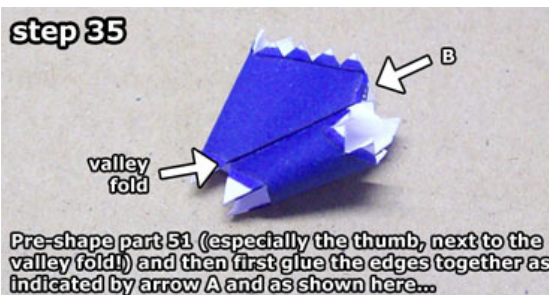

step 36

valley fold

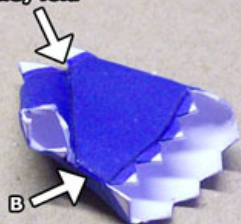

...and then glue together the small glueing tab marked B, to close the palm of the end and shape the "tunnel" for the thumb as shown here.

step 37



The fingers (or in this case part 52, the thumb) are not so difficult to assemble anymore if you pre-shape them around a toothpick first:

www.youtube.com/watch?v=3ph7ayEs1RA

step 38

part 52



Glue part 52 to the base of the thumb on part 51.

step 39

part 54

part 53



It's easiest to glue on each finger one at a time. Each finger consists of two parts, in this case parts 53 and 54. Glue them into small cylinder-like shapes...

step 40

part 53

part 54



...and then glue them together like so. Batman's fingers are all bent, to make a fist.

step 41

parts 53+54

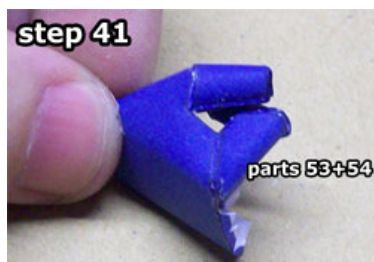

Take your time glueing the finger to the hand. This one goes on closest to the thumb. Use one small glueing tab at the top of the hand, one at the bottom, and the slightly bigger one on the side.

parts 53+54



step 42

parts 55-56



Now continue glueing on the fingers one by one, starting with parts 55 and 56 as shown here. Use one of the small glueing tabs on top of the hand and one at the bottom, and the slightly bigger one on part 53.

step 43

parts 57-58



Next, glue on parts 57 and 58 (use one small glueing tab at the top of the hand and one at the bottom again, and the slightly bigger one on part 55)...

step 44

parts 59-60



...and finally parts 59 and 60 to the remaining four glueing tabs.

step 45



parts 51-60

Once the fingers have dried, shape the open end of the hand into a circular shape, so you can glue the hand to Batman's wrist.

step 46



parts 51-60

parts 61-70

Do the same for the other hand (parts 61-70) and your papercraft Batman will be finished!

Thank you for building a Ninjatoes' papercraft model!
www.kickme.to/ninjatoes