

# **Clock Town Schnauzer** instructions

**step 1**

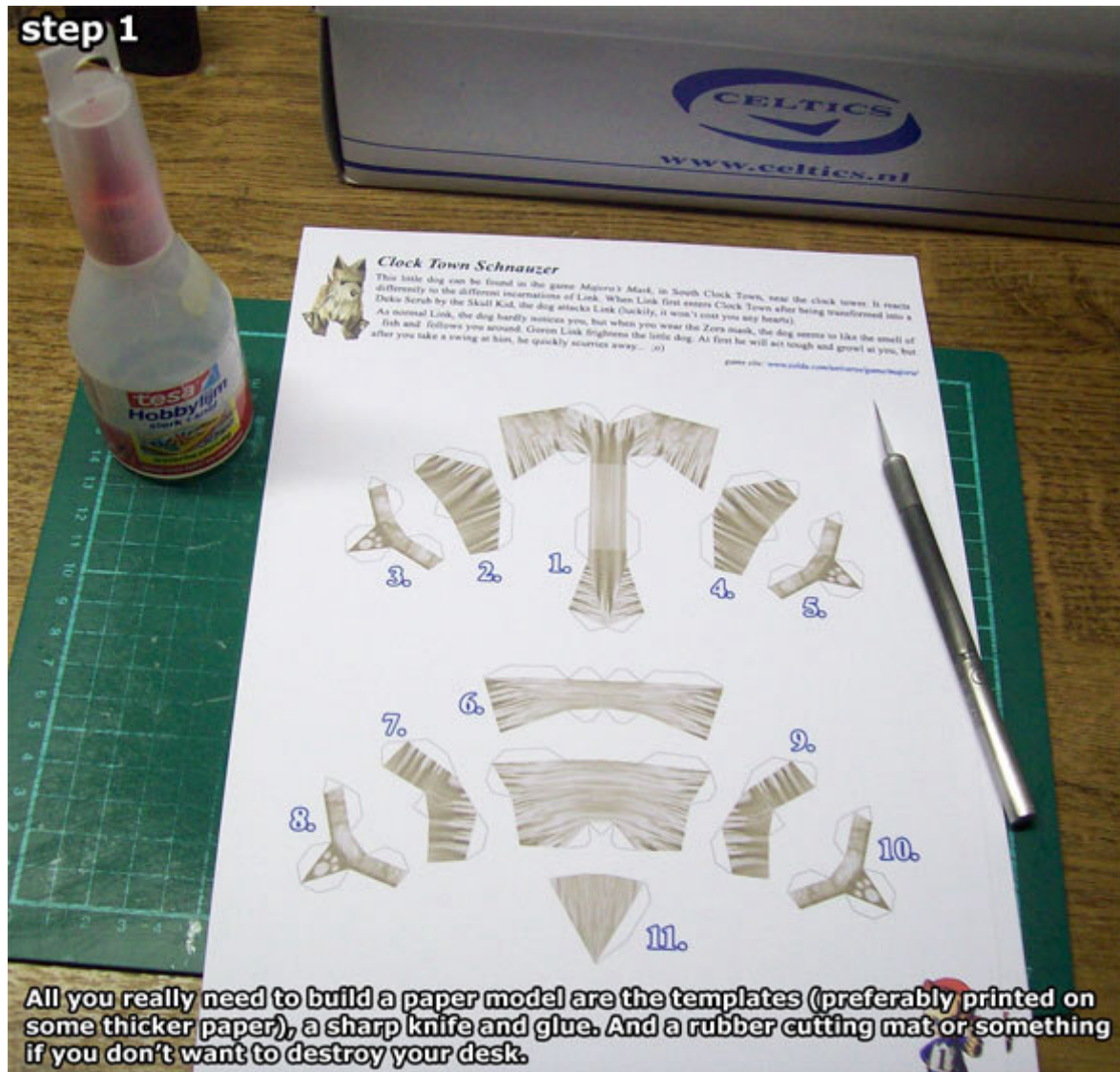

All you really need to build a paper model are the templates (preferably printed on some thicker paper), a sharp knife and glue. And a rubber cutting mat or something if you don't want to destroy your desk.

**step 2**



**step 3**

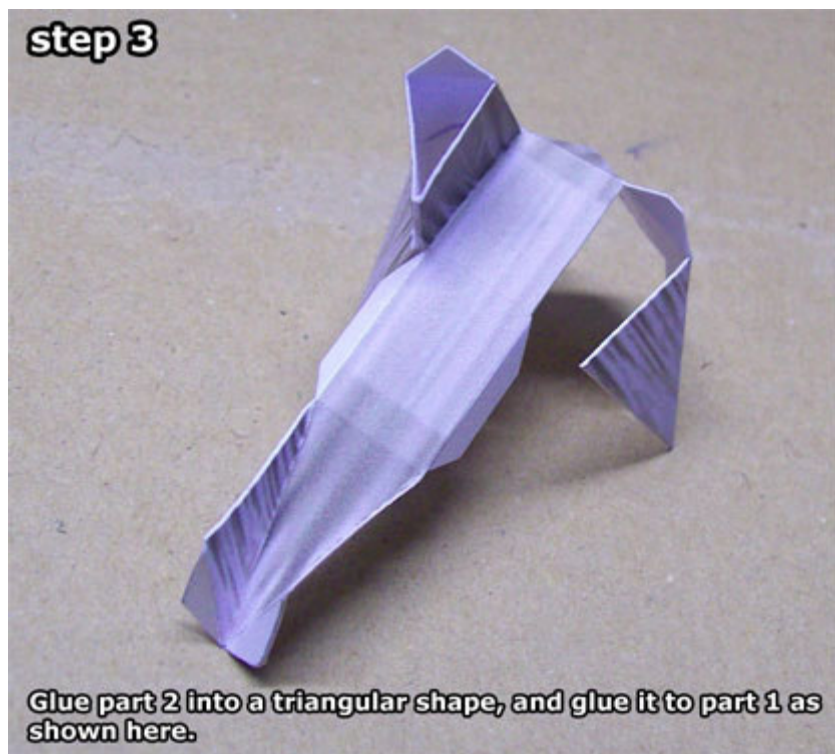



### step 4



Now assemble and glue on part 3.

### step 5

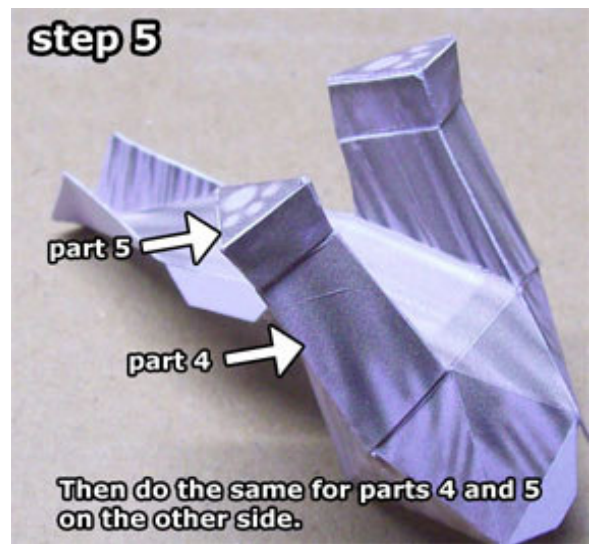

Then do the same for parts 4 and 5 on the other side.

### step 6

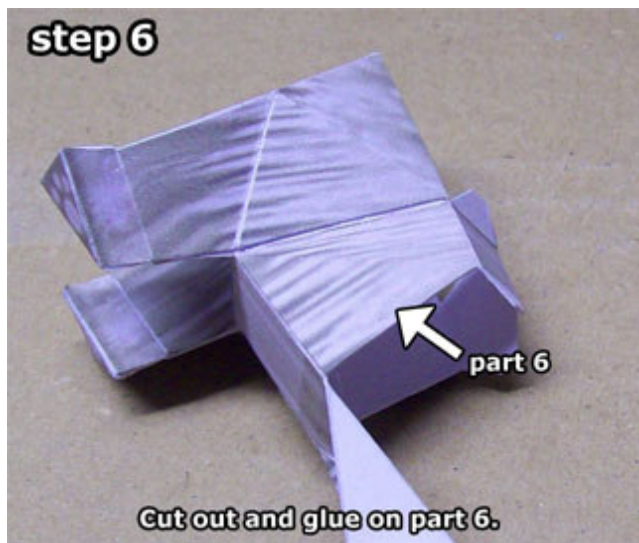

Cut out and glue on part 6.

### step 7



Cut out and assemble part 7 like you did the front paws, and then glue it to the body (with just one glue tab for now).

### step 8

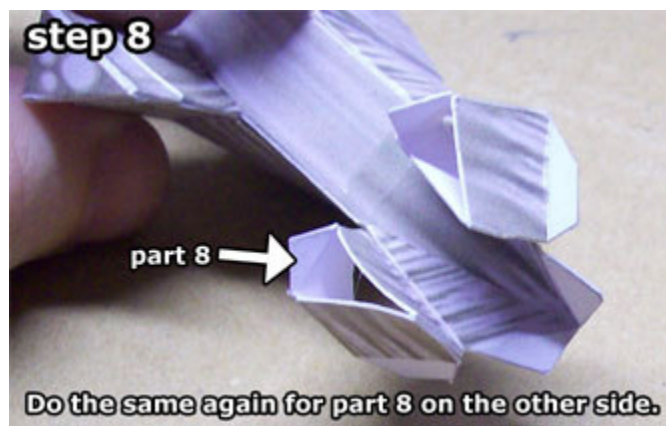

Do the same again for part 8 on the other side.

### step 9



Then cut out, pre-shape and glue on part 9 (this can be a bit fiddly, so take your time!)

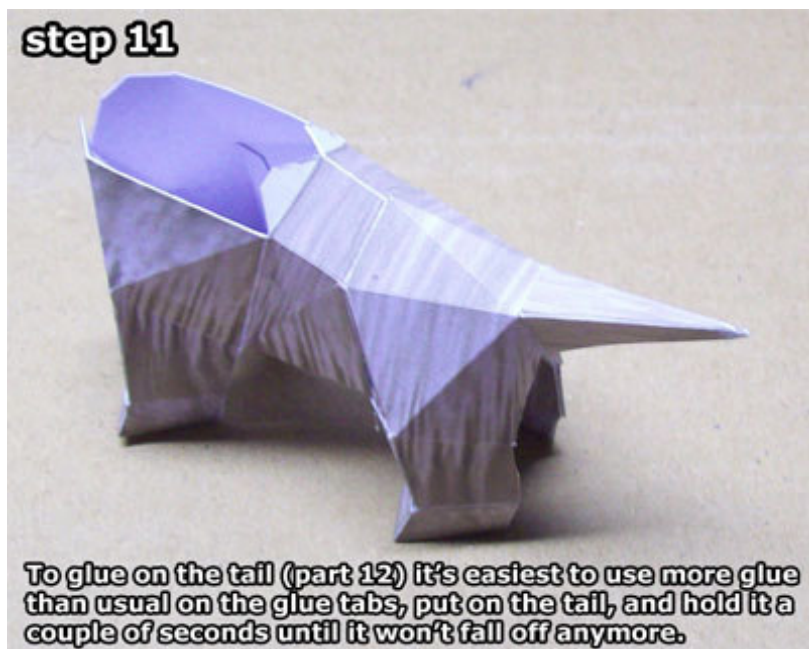
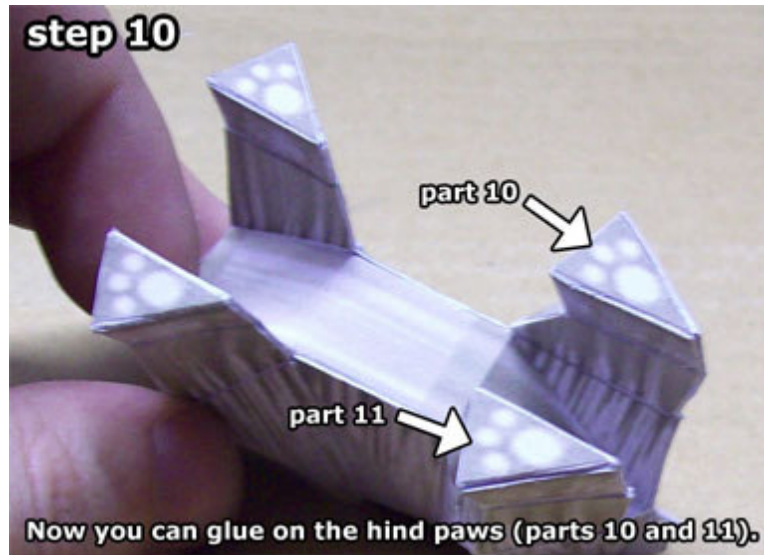



### step 13

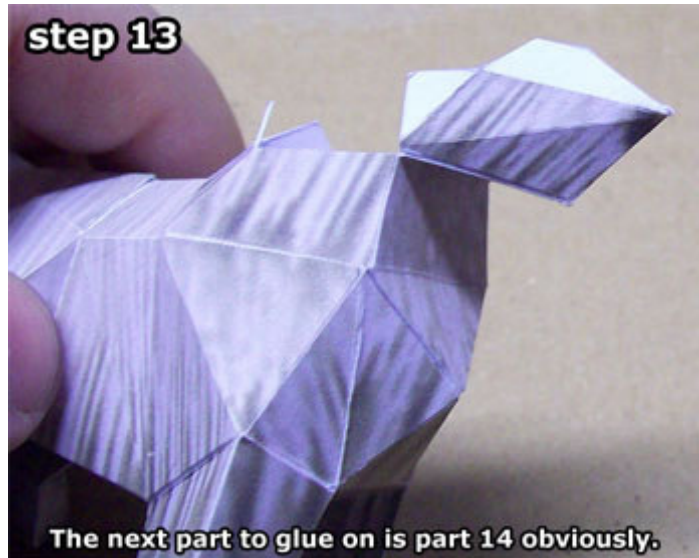

The next part to glue on is part 14 obviously.

### step 14



And then part 15. The glue tabs on part 14 need to be glued from the tip of the nose right underneath the fold lines on part 15 (indicated here by an orange line - don't worry, it sounds more difficult than it is ;o)

The sides of the "moustache" are not to be glued to another part yet.

### step 15

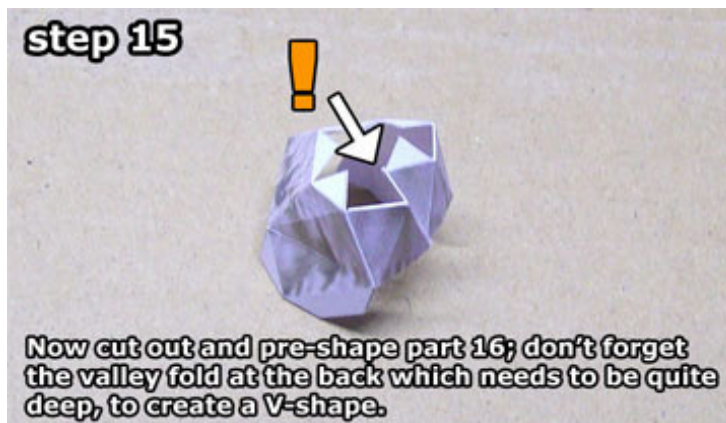

Now cut out and pre-shape part 16; don't forget the valley fold at the back which needs to be quite deep, to create a V-shape.



### step 16

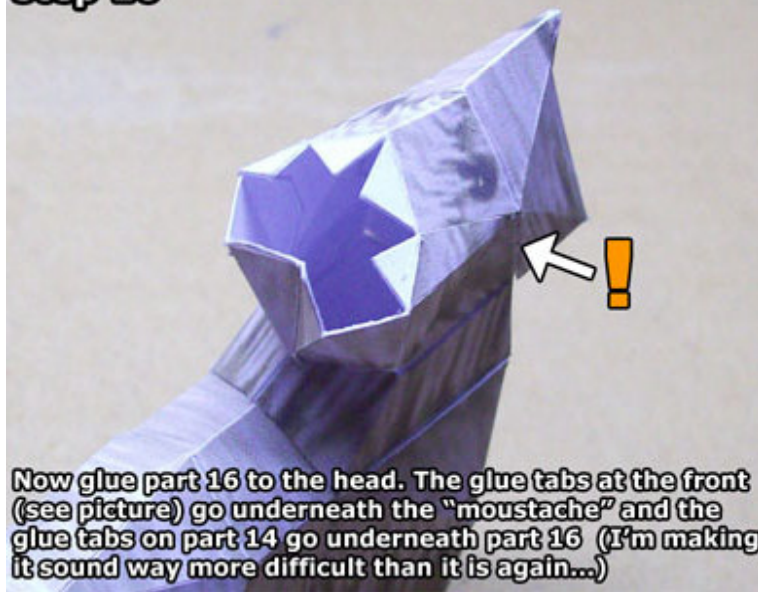

### step 17



### step 18

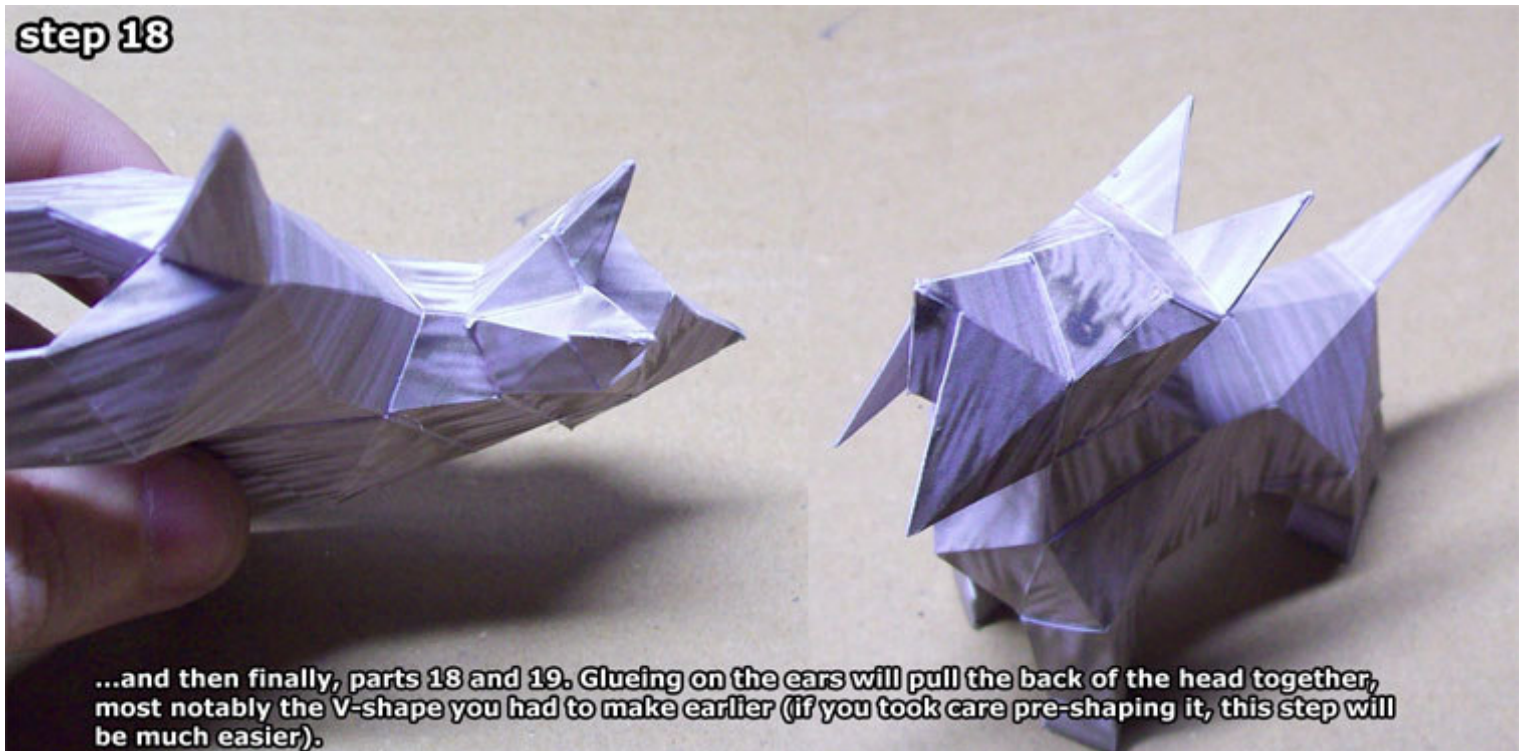

### step 19

